

NO. OF COPIES RECEIVED	5
DISTRIBUTION	
SANTA FE	1
FILE	1
U.S.G.S.	2
LAND OFFICE	
OPERATOR	1

NEW MEXICO OIL CONSERVATION COMMISSION

Form C-101
Revised 1-1-65

5A. Indicate Type of Lease	
STATE <input type="checkbox"/>	FEE <input checked="" type="checkbox"/>
5. State Oil & Gas Lease No.	

APPLICATION FOR PERMIT TO DRILL, DEEPEN, OR PLUG BACK

1a. Type of Work		7. Unit Agreement Name	
b. Type of Well OIL WELL <input type="checkbox"/> GAS WELL <input checked="" type="checkbox"/> OTHER <input type="checkbox"/>		Callegos Canyon Unit	
DRILL <input checked="" type="checkbox"/> DEEPEN <input type="checkbox"/> PLUG BACK <input type="checkbox"/>		8. Farm or Lease Name	
SINGLE ZONE <input checked="" type="checkbox"/> MULTIPLE ZONE <input type="checkbox"/>		9. Well No.	
2. Name of Operator PAN AMERICAN PETROLEUM CORPORATION		199	
3. Address of Operator P. O. Box 480, Farmington, New Mexico		10. Field and Pool, or Wildcat Basin Dakota	
4. Location of Well UNIT LETTER 0 LOCATED 1000 FEET FROM THE South LINE 2510 FEET FROM THE East LINE OF SEC. 34 TWP. 29-N RGE. 12-W NMPM		12. County San Juan	
19. Proposed Depth 6200'		19A. Formation Dakota	
21. Elevations (Show whether DF, RT, etc.) Report Later		20. Rotary or C.T. Rotary	
21A. Kind & Status Plug. Bond Statewide		21B. Drilling Contractor JCM	
22. Approx. Date Work will start October 1, 1965			

23.

PROPOSED CASING AND CEMENT PROGRAM

SIZE OF HOLE	SIZE OF CASING	WEIGHT PER FOOT	SETTING DEPTH	SACKS OF CEMENT	EST. TOP
12-1/4"	8-5/8"	24#	350'	250	Surface
7-7/8"	4-1/2"	10.5#	6200'	1500*	Surface*
*Stage cementing tool at base of Neuvorbs.					

Completion will be as indicated upon reaching total depth.
Copies of location plat are attached.
Copies of any logs run will be furnished upon completion of well.



IN ABOVE SPACE DESCRIBE PROPOSED PROGRAM: IF PROPOSAL IS TO DEEPEN OR PLUG BACK, GIVE DATA ON PRESENT PRODUCTIVE ZONE AND PROPOSED NEW PRODUCTIVE ZONE, GIVE BLOWOUT PREVENTER PROGRAM, IF ANY.

I hereby certify that the information above is true and complete to the best of my knowledge and belief.

Signed G. W. Eaton, Jr. Title Area Engineer Date September 27, 1965
(This space for State Use)

APPROVED BY Emory C. Clavel TITLE Sec. Dist. Mgr. DATE 9-29-65
CONDITIONS OF APPROVAL, IF ANY: APPROVAL VALID FOR 90 DAYS UNLESS DRILLING COMMENCED,

EXPIRES 12-29-65

**NEW MEXICO OIL CONSERVATION COMMISSION
WELL LOCATION AND ACERAGE DEDICATION PLAT**

All distances must be from the outer boundaries of the Section

Operator PAN AMERICAN PETROLEUM CORPORATION			Lease GALLEGOS CANYON UNIT		Well No. 199
Unit Letter 0	Section 34	Township 29 NORTH	Range 12 WEST	County SAN JUAN	
Actual Footage Location of Well: 1000 feet from the SOUTH line and 2510 feet from the EAST line					
Ground Level Elev. Report Later	Producing Formation Dakota		Pool Basin Dakota		Dedicated Acreage: 320 Acres

- Outline the acreage dedicated to the subject well by colored pencil or hachure marks on the plat below.
- If more than one lease is dedicated to the well, outline each and identify the ownership thereof (both as to working interest and royalty),
- If more than one lease of different ownership is dedicated to the well, have the interests of all owners been consolidated by communitization, unitization, force-pooling, etc?

(X) Yes () No If answer is "yes," type of consolidation Unitization

If answer is "no," list the owners and tract descriptions which have actually consolidated. (Use reverse side of this form if necessary.)

No allowable will be assigned to the well until all interests have been consolidated (by communitization, unitization, forced-pooling, or otherwise) or until a non standard unit, eliminating such interests, has been approved by the Commission.

Ref: GLO Plat dated April 7, 1881.

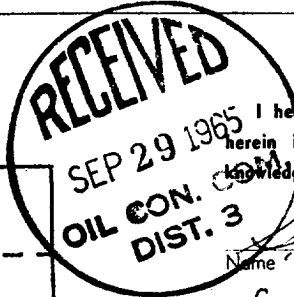
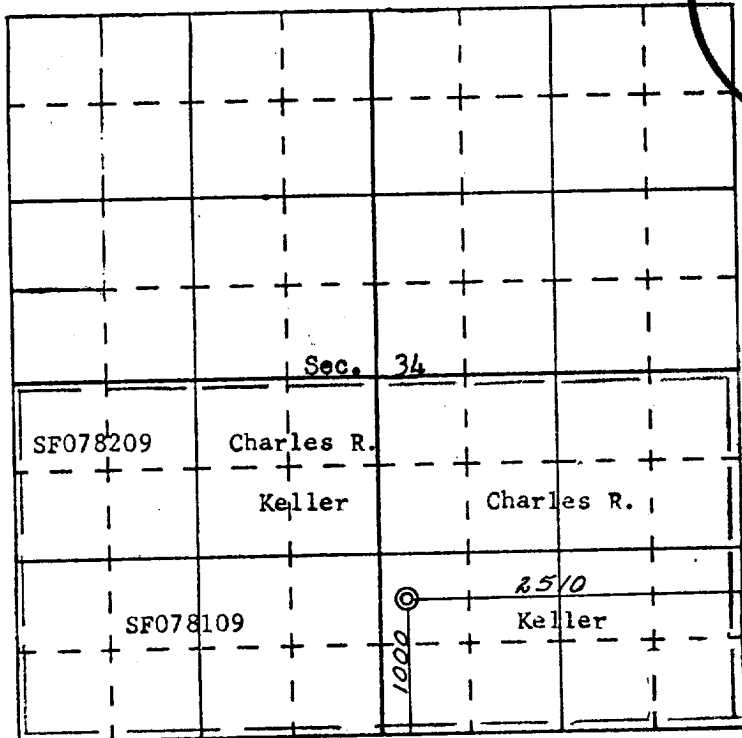

CERTIFICATION

I hereby certify that the information contained herein is true and complete to the best of my knowledge and belief.

Name G. W. Eaton, Jr.
Position Area Engineer
Company Pan American Petroleum Corp.
Date September 27, 1965

I hereby certify that the well location shown on this plat was plotted from field notes of actual surveys made by me or under my supervision, and that the same is true and correct to the best of my knowledge and belief.

Date Surveyed September 21, 1965
Registered Professional Engineer and/or Land Surveyor
James P. Leese
San Juan Engineering Company
Certificate No. 1463