

EL PASO FIELD SERVICES PRODUCTION PIT CLOSURE

OK

San Jacinto No. 5
Meter/Line ID – 72386

SITE DETAILS

Legals - Twn: 29N	Rng: 10W	Sec: 21	Unit: E
NMOCD Hazard Ranking: 20		Land Type: BLM	
Operator: Meridian		Pit Closure Date: 06/20/94	

RATIONALE FOR CLOSURE

The pit noted above was assessed and ranked according to the criteria in the New Mexico Oil Conservation Division's (NMOCD) Unlined Surface Impoundment Closure Guidelines.

A test pit was excavated on June 20, 1994, to 12 feet below ground surface and a soil sample was collected for field headspace analysis and laboratory analysis for TPH. Groundwater was not encountered in the test pit. The pit was backfilled and graded in a manner to direct surface runoff away from the pit area. Headspace analysis indicated an organic vapor content of 244 ppm; laboratory analysis indicated a TPH concentration of 2220 mg/kg. TPH was above required remediation levels for the Hazard Ranking Score.

On January 21, 1998, a Phase II drill borehole was drilled to a depth of 23 feet where auger refusal was encountered and a soil sample was collected for field headspace analysis and laboratory analysis of benzene, total BTEX, and TPH. Headspace analysis indicated a concentration of 586 ppm; laboratory analysis indicated a benzene concentration of <0.5 mg/kg, a total BTEX concentration of <3.0, and a TPH concentration of 220 mg/kg. Again, TPH was above required remediation levels for the Hazard Ranking Score.

A Phase III excavation was conducted on October 22, 1998 to the practical extent of the trackhoe 21 feet below ground surface. Groundwater was not encountered in the excavation. Approximately 343 cubic yards of excavated material was removed for landfarming and sent to an OCD approved centralized site. The pit was backfilled and graded in a manner to direct surface runoff away from the pit area. Headspace analysis indicated an organic vapor content of 0 ppm; laboratory analysis indicated a benzene concentration of <1.0 mg/kg, a total BTEX concentration of 73.3 mg/kg, and a TPH concentration of 824 mg/kg.

El Paso Field Services Company (EPFS) requests closure of the above mentioned production pit location for the following reasons:

- The primary source, discharge to the pit, has been removed for almost six years.
- The test pit was backfilled and the former pit area graded to direct surface runoff away from the former pit.
- Groundwater was not encountered in the excavations.
- Residual hydrocarbons in the soil will degrade naturally with minimal risk to the environment.
- Based on the Hazard Ranking Score, benzene and total BTEX were below required remediation levels for the Hazard Ranking Score.

FIELD PIT SITE ASSESSMENT FORM

GENERAL	Meter: <u>72386</u> Location: <u>SAN JACINTO #5</u> Operator #: <u>2999</u> Operator Name: <u>MERIDIAN P/L</u> District: <u>BLOOMFIELD</u> Coordinates: Letter: <u>E</u> Section <u>21</u> Township: <u>29</u> Range: <u>10</u> Or Latitude _____ Longitude _____ Pit Type: Dehydrator _____ Location Drip: <u>X</u> Line Drip: _____ Other: _____ Site Assessment Date: <u>5-20-94</u> Area: <u>10</u> Run: <u>93</u>
	NMOCD Zone: (From NMOCD Maps) Inside <input type="checkbox"/> (1) Outside <input checked="" type="checkbox"/> (2) Land Type: BLM <input checked="" type="checkbox"/> (1) State <input type="checkbox"/> (2) Fee <input type="checkbox"/> (3) Indian _____ Depth to Groundwater Less Than 50 Feet (20 points) <input type="checkbox"/> (1) 50 Ft to 99 Ft (10 points) <input type="checkbox"/> (2) Greater Than 100 Ft (0 points) <input checked="" type="checkbox"/> (3) Wellhead Protection Area : Is it less than 1000 ft from wells, springs, or other sources of fresh water extraction? , or ; Is it less than 200 ft from a private domestic water source? <input checked="" type="checkbox"/> (1) YES (20 points) <input type="checkbox"/> (2) NO (0 points) Horizontal Distance to Surface Water Body Less Than 200 Ft (20 points) <input type="checkbox"/> (1) 200 Ft to 1000 Ft (10 points) <input type="checkbox"/> (2) Greater Than 1000 Ft (0 points) <input checked="" type="checkbox"/> (3) Name of Surface Water Body _____ (Surface Water Body : Perennial Rivers,Major Wash,Streams,Creeks, Irrigation Canals,Ditches,Lakes,Ponds) Distance to Nearest Ephemeral Stream <input type="checkbox"/> (1) < 100'(Navajo Pits Only) <input type="checkbox"/> (2) > 100' TOTAL HAZARD RANKING SCORE: <u>20</u> POINTS
REMARKS	Remarks : <u>ONLY PIT ON LOCATION. PIT IS DRY. LOCATION IS ON A HILL NEXT TO SOME TRAILERS NORTH OF HWY. 64. REDLINE SHOWS LOCATION INSIDE V.Z. BUT TOPD SHOWS LOCATION IS OUTSIDE V.Z.</u> <div style="text-align: right;"><u>PUSH IN</u></div>

ORIGINAL PIT LOCATION

ORIGINAL PIT LOCATION

Original Pit : a) Degrees from North 181° Footage from Wellhead 94'
b) Length : 20' Width : 19' Depth : 3'

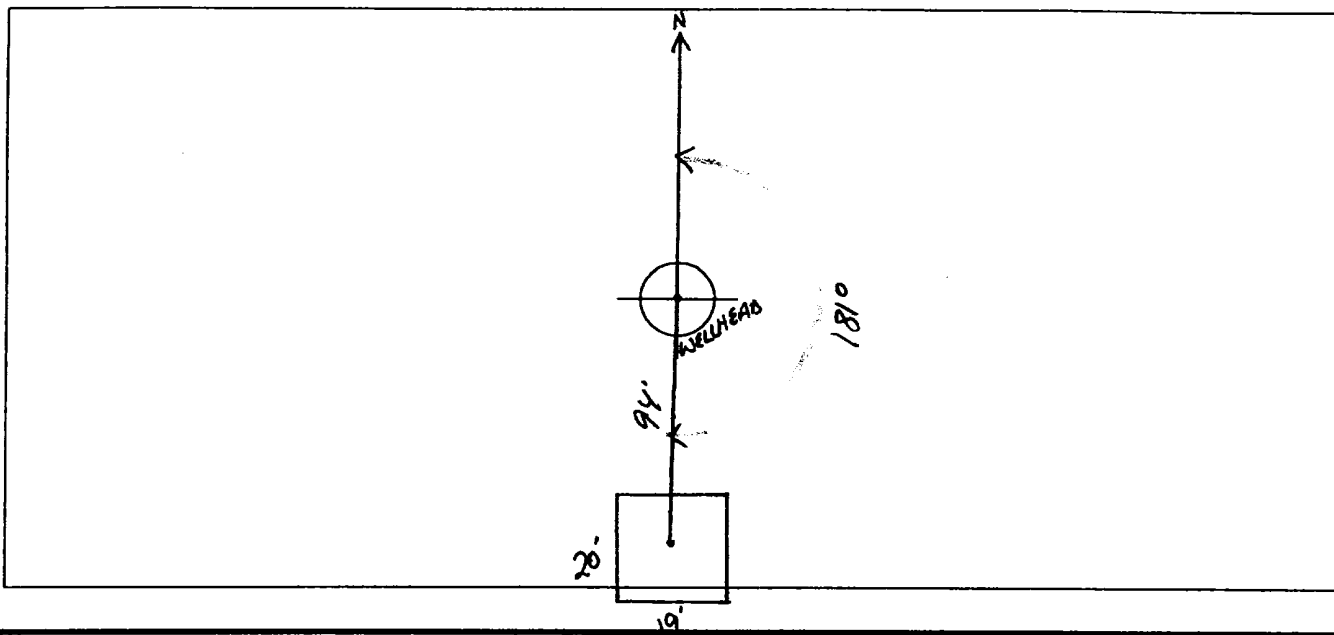

REMARKS

Remarks :

TOOK PICTURES AT 12:16 P.M.

END DUMP

Completed By:

Robert Thompson

Signature

5.20.94

Date

FIELD PIT REMEDIATION/CLOSURE FORM

GENERAL	<p>Meter: <u>72386</u> Location: <u>San Jacinto #5</u></p> <p>Coordinates: Letter: <u>E</u> Section <u>21</u> Township: <u>29</u> Range: <u>10</u></p> <p>Or Latitude _____ Longitude _____</p> <p>Date Started : <u>6-20-94</u> Area: <u>10</u> Run: <u>93</u></p>
FIELD OBSERVATIONS	<p>Sample Number(s): <u>VW 224</u></p> <p>Sample Depth: <u>12'</u> Feet</p> <p>Final PID Reading <u>244</u> PID Reading Depth <u>12'</u> Feet</p> <p style="text-align: center;">Yes No</p> <p>Groundwater Encountered <input type="checkbox"/> (1) <input checked="" type="checkbox"/> (2) Approximate Depth _____ Feet</p>
CLOSURE	<p>Remediation Method :</p> <p>Excavation <input type="checkbox"/> (1) Approx. Cubic Yards _____</p> <p>Onsite Bioremediation <input type="checkbox"/> (2)</p> <p>Backfill Pit Without Excavation <input checked="" type="checkbox"/> (3)</p> <p>Soil Disposition:</p> <p>Envirotech <input type="checkbox"/> (1) <input type="checkbox"/> (3) Tierra</p> <p>Other Facility <input type="checkbox"/> (2) Name: _____</p> <p>Pit Closure Date: <u>6-20-94</u> Pit Closed By: <u>BEI</u></p>
REMARKS	<p>Remarks : <u>NO ^{EPNL} find markers Layer of clay at Bottom of P.t.</u></p> <p><u>6-20-94</u></p>
	<p>Signature of Specialist: <u>Vale Wilson</u></p>



FIELD SERVICES LABORATORY
ANALYTICAL REPORT
PIT CLOSURE PROJECT - Soil

SAMPLE IDENTIFICATION

	Field ID	Lab ID
SAMPLE NUMBER:	VW 224	945483
MTR CODE SITE NAME:	72386	N/A
SAMPLE DATE TIME (Hrs):	6-20-94	1310
SAMPLED BY:	N/A	
DATE OF TPH EXT. ANAL.:	6-21-94	6/21/94
DATE OF BTEX EXT. ANAL.:	N/A	N/A
TYPE DESCRIPTION:	VG	GLY / FINE SAND / CLAY

REMARKS:

RESULTS

PARAMETER	RESULT	UNITS	QUALIFIERS			
			DF	Q	M(g)	V(ml)
BENZENE		MG/KG				
TOLUENE		MG/KG				
ETHYL BENZENE		MG/KG				
TOTAL XYLENES		MG/KG				
TOTAL BTEX		MG/KG				
TPH (418.1)	2200	MG/KG			2.02	28
HEADSPACE PID	244	PPM				
PERCENT SOLIDS	75.8	%				

— TPH is by EPA Method 418.1 and BTEX is by EPA Method 8020 —

The Surrogate Recovery was at N/A % for this sample All QA/QC was acceptable.
Narrative:

DF = Dilution Factor Used

7/14/94



CHAIN OF CUSTODY RECORD

Page _____ of _____

PROJECT NUMBER		PROJECT NAME		PROJECT ANALYSIS		REQUESTED ANALYSIS		REMARKS	
LAB ID		DATE	TIME	MATRIX	SAMPLE TYPE	TPH EPA 418.1	BTEX EPA 8020		
94	5479	6-20-94	9:20	Soil	VW	X		196	
94	5480	6-20-94	10:25	Soil	VW	X		197	
94	5481	6-20-94	11:20	Soil	VW	X		198	
94	5482	6-20-94	12:30	Soil	VW	X		199	
94	5483	6-20-94	13:10	Soil	VW	X		200	
94	5484	6-20-94	14:30	Soil	VW	X		201	
94	5485	6-20-94	14:30	Soil	LD	X			
94	5486	6-20-94	14:35	Soil	LB	X			
94	5487	6-20-94	15:45	Soil	VW	X		202	
RELINQUISHED BY: (Signature)		DATE/TIME		RECEIVED BY: (Signature)		DATE/TIME		RECEIVED BY: (Signature)	
Vale Wilson		6-20-94 17:30		Penda Lince		6-20-94 18:00		Kim K	
RELINQUISHED BY: (Signature)		DATE/TIME		RECEIVED BY: (Signature)		DATE/TIME		RECEIVED BY: (Signature)	
REQUESTED TURNAROUND TIME:		ROUTINE <input type="checkbox"/> RUSH <input type="checkbox"/>		SAMPLE RECEIPT REMARKS		RESULTS & INVOICES TO:			
CARRIER CO.						FIELD SERVICES LABORATORY			
BILL NO.:						EL PASO NATURAL GAS COMPANY			
						P.O. BOX 4990			
						FARMINGTON, NEW MEXICO 87499			
						505-599-2144		FAX: 505-599-2261	

RECORD OF SUBSURFACE EXPLORATION

PHILIP SERVICES CORP.

.000 Monroe Road
Farmington, New Mexico 87401
(505) 326-2262 FAX (505) 326-2388

Borehole # BH-1
Well # _____
Page 1 of _____

Project Number: 19007 Phase: 1001.77

Project Name: EPFS 5 Wellhead Protection Pits

Project Location: SAN JACINTO #5

72386

T29, R10, Sec 21, E

Elevation: _____

Borehole Location: _____

GWL Depth: _____

Drilled By: K. Padilla

Well Logged By: S. Pope

Date Started: 1/21/98 1500

Date Completed: 1/21/98 1600

Drilling Method: 4 1/4 ID HSA

Air Monitoring Method: PID

Depth (feet)	Sample Number	Sample Interval	Sample Type & Recover (inches)	Sample Description Classification System: USCS	USCS Symbol	Depth Lithology Change (feet)	Air Monitoring Units: PPM			Drilling Conditions & Blow Counts
							BZ	BH	S	
0										
5	1	5 7	12	Brown Medium - Coarse SAND Trace Silt and Clay, Loose Dry			0	0	0	15 10 No Head space
10	2	10 12	13	Gray CLAY trace silt and sand med - Still Moist, Med Plastic		9 11	0	0	710	HCODOR 15 15 HS = 780ppm
15	3	15 17	12	Gray CLAY trace silt some Med to Sand, Med plastic, Still, Moist		15	0	28	413	HS = 32 HS = 648ppm
20	4	20 22	18	SHA Brownish Gray Cobble in bottom of spoon		21	0	30	759	1545 HS = 850ppm Refusal @ 22" Cobble @ 21'
25	5	23 25		Brown Cobble in SAND and clay Matrix, Med - Coarse Sand, Moist Very hard.			0	38	586	Auger Refusal @ 23' Sample Refusal @ 12" 1550 HS = 727ppm
30				TOB - 24						
35										
40										

Comments: AUGER REFUSAL @ 23' due to Abundant Cobbles, Collect SAMPLE AT 23-24'
FOR RTEX AND TPH STP-35. Bore hole grouted to SURFACE

Geologist Signature

S. T. Pope

CHAIN OF CUSTODY RECORD

PROJECT NUMBER # 24324		PROJECT NAME Pit Closure Project		DATE: 1/21/98		CONTRACT LABORATORY P. O. NUMBER	
SAMPLERS: (Signature) <i>James T. Price</i>		DATE: 1/21/98		TOTAL NUMBER OF CONTAINERS		REQUESTED ANALYSIS	
LAB ID	DATE	TIME	MATRIX	FIELD ID	SAMPLE TYPE	TPH EPA 418.1	BTEX EPA 8020
980078	1/21/98	1230	Soil	STP-34	1	V6	X
980079	1/21/98	1550	Soil	STP-35	1	V6	X
<i>STP-34 1/21/98</i>							
<i>STP-35 1/21/98</i>							
<i>STP-36 1/21/98</i>							
<i>STP-37 1/21/98</i>							
<i>STP-38 1/21/98</i>							
<i>STP-39 1/21/98</i>							
<i>STP-40 1/21/98</i>							
<i>STP-41 1/21/98</i>							
<i>STP-42 1/21/98</i>							
<i>STP-43 1/21/98</i>							
<i>STP-44 1/21/98</i>							
<i>STP-45 1/21/98</i>							
<i>STP-46 1/21/98</i>							
<i>STP-47 1/21/98</i>							
<i>STP-48 1/21/98</i>							
<i>STP-49 1/21/98</i>							
<i>STP-50 1/21/98</i>							
<i>STP-51 1/21/98</i>							
<i>STP-52 1/21/98</i>							
<i>STP-53 1/21/98</i>							
<i>STP-54 1/21/98</i>							
<i>STP-55 1/21/98</i>							
<i>STP-56 1/21/98</i>							
<i>STP-57 1/21/98</i>							
<i>STP-58 1/21/98</i>							
<i>STP-59 1/21/98</i>							
<i>STP-60 1/21/98</i>							
<i>STP-61 1/21/98</i>							
<i>STP-62 1/21/98</i>							
<i>STP-63 1/21/98</i>							
<i>STP-64 1/21/98</i>							
<i>STP-65 1/21/98</i>							
<i>STP-66 1/21/98</i>							
<i>STP-67 1/21/98</i>							
<i>STP-68 1/21/98</i>							
<i>STP-69 1/21/98</i>							
<i>STP-70 1/21/98</i>							
<i>STP-71 1/21/98</i>							
<i>STP-72 1/21/98</i>							
<i>STP-73 1/21/98</i>							
<i>STP-74 1/21/98</i>							
<i>STP-75 1/21/98</i>							
<i>STP-76 1/21/98</i>							
<i>STP-77 1/21/98</i>							
<i>STP-78 1/21/98</i>							
<i>STP-79 1/21/98</i>							
<i>STP-80 1/21/98</i>							
<i>STP-81 1/21/98</i>							
<i>STP-82 1/21/98</i>							
<i>STP-83 1/21/98</i>							
<i>STP-84 1/21/98</i>							
<i>STP-85 1/21/98</i>							
<i>STP-86 1/21/98</i>							
<i>STP-87 1/21/98</i>							
<i>STP-88 1/21/98</i>							
<i>STP-89 1/21/98</i>							
<i>STP-90 1/21/98</i>							
<i>STP-91 1/21/98</i>							
<i>STP-92 1/21/98</i>							
<i>STP-93 1/21/98</i>							
<i>STP-94 1/21/98</i>							
<i>STP-95 1/21/98</i>							
<i>STP-96 1/21/98</i>							
<i>STP-97 1/21/98</i>							
<i>STP-98 1/21/98</i>							
<i>STP-99 1/21/98</i>							
<i>STP-100 1/21/98</i>							



FIELD SERVICES LABORATORY
ANALYTICAL REPORT

SAMPLE IDENTIFICATION

	Field ID	Lab ID
SAMPLE NUMBER:	STP-35	980079
MTR CODE SITE NAME:	72386	San Jacinto #5
SAMPLE DATE TIME (Hrs):	1/21/98	1550
PROJECT:	Phase II Drilling	
DATE OF TPH EXT. ANAL.:	1/26/98	1/26/98
DATE OF BTEX EXT. ANAL.:	1/30/98	2/2/98
TYPE DESCRIPTION:	VG	Brown Sand

Field Remarks:

RESULTS

PARAMETER	RESULT	UNITS	QUALIFIERS			
			DF	Q	M(g)	V(ml)
BENZENE	<0.5	MG/KG				
TOLUENE	<0.5	MG/KG				
ETHYL BENZENE	<0.5	MG/KG				
TOTAL XYLENES	<1.5	MG/KG				
TOTAL BTEX	<3.0	MG/KG				
TPH (M8015)	11	MG/KG				
TPH (418.1)	220	MG/KG				
HEADSPACE PID	586	PPM				
PERCENT SOLIDS	96.2	%				

-- TPH is by EPA Method 418.1 and BTEX is by EPA Method 8020 --

The Surrogate Recovery was at 103 % for this sample All QA/QC was acceptable.

Narrative:

T M8015 run by AEN Labs.

Approved By:

Date:

3/16/98

980079 Phase II Drill, 3/15/98



Paragon Analytics, Inc.

Total Extractable Hydrocarbons (Diesel) Case Narrative

El Paso Field Services

Pit Closure 24324

Order Number - 9802002

1. This report consists of 2 soil samples received by Paragon on 02/03/98.
2. The soil samples were extracted by adding a methanol /water solution to the soil followed by hexane. This mixture is shaken and the hexane portion of the two-phase solution is removed for analysis.
3. The extracts were then analyzed using GC with a DB-5.625 capillary column and a flame ionization detector (FID) according to protocols generally based on SW-846 Method 8000. The procedures are based on this general method because SW-846 does not have a specific method for TEPH or diesel range organics. The only true modification from this method is that TEPH(diesel) is a multicomponent mixture and is quantitated by summing the entire range, rather than individual peaks. All positive results were quantitated using the responses from the initial calibration curve using the external standard technique. Also, a confirmation column is not used, because the analyte is a multicomponent mixture and the specific carbon range of the peaks detected are specified on the individual sample reporting forms.
4. All samples were extracted and analyzed within the established holding times.
5. The method blank associated with this project was below the reporting limits for all analytes.
6. All matrix spike and matrix spike duplicate recoveries and RPDs were within acceptance criteria.
7. All blank spike and blank spike duplicate recoveries and RPDs were within the acceptance criteria.

PARAGON ANALYTICS, INC.



8. All surrogate recoveries were within acceptance criteria.
9. All initial and continuing calibration criteria were within acceptance criteria.

The data contained in the following report have been reviewed and approved by the personnel listed below. In addition, Paragon Analytics, Inc. certifies that the analyses reported herein are true, complete and correct within the limits of the methods employed.

Wesley S. Mayfield
Wesley S. Mayfield
GC Analyst

2/6/98
Date

RSZ
Reviewer's Initials

2/11/98
Date

Paragon Analytics, Incorporated

Sample Number(s) Cross-Reference Table

Paragon OrderNum: 9802002

Client Name: El Paso Field Services

Client Project Name: 24324

Client Project Number: Pit Closure

Client PO Number:

Client Sample	Lab Sample Number	COC Number	Matrix	Date Collected	Time Collected
980079	9802002-1		Soil	1/21/98	15:50
980082	9802002-2		Soil	1/22/98	14:00

TPH(418.1) = 220 mg/kg

Phase II Drill

SAN JACINTO #5

Meter Code 72386

Total Extractable Petroleum Hydrocarbons

Modified Method 8015

Sample ID

980079

Lab Name: Paragon Analytics, Inc.
Client Name: El Paso Field Services
Client Project ID: Pit Closure 24324

Lab Sample ID: 9802002-1

Date Collected: 1/21/98
Date Extracted: 2/04/98
Date Analyzed: 2/05/98

Sample Matrix: Soil

Cleanup: N/A

% Moisture: 0 %

Results based on wet weight

Sample Weight: 20 g
Final Volume: 5 mL
Dilution Factor: 1

Analyte	Conc (mg/kg)	Reporting Limit (mg/kg)
TEPH ¹	11 #	5.0

SURROGATE RECOVERY

Analyte	% Recovery	% Rec Limits
Hexacosane	93	54 - 146

ND = Not Detected at or above client requested reporting limit.

TEPH¹ = Any combination of diesel and other hydrocarbons within the range of C8 - C36 quantitated as diesel.

- The chromatogram indicates hydrocarbons in the range of C8 - C30

$$TPH(418.1) = 136 \text{ mg/kg}$$

Phase II Drill

Flourance 6

Meter Code 75253

Total Extractable Petroleum Hydrocarbons

Modified Method 8015

Sample ID

980082

Lab Name: Paragon Analytics, Inc.

Client Name: El Paso Field Services

Client Project ID: Pit Closure 24324

Lab Sample ID: 9802002-2

Date Collected: 1/22/98

Date Extracted: 2/04/98

Date Analyzed: 2/05/98

Sample Matrix: Soil

Cleanup: N/A

% Moisture: 0 %

Results based on wet weight

Sample Weight: 20 g

Final Volume: 5 mL

Dilution Factor: 1

Analyte	Conc (mg/kg)	Reporting Limit (mg/kg)
TEPH ¹	10 #	5.0

SURROGATE RECOVERY

Analyte	% Recovery	% Rec Limits
Hexacosane	95	54 - 146

ND = Not Detected at or above client requested reporting limit.

TEPH¹ = Any combination of diesel and other hydrocarbons within the range of C8 - C36 quantitated as diesel.

- The chromatogram indicates hydrocarbons in the range of C16 - C36

Total Extractable Petroleum Hydrocarbons Matrix Spike

Modified Method 8015

Sample ID

980082

Lab Name: Paragon Analytics, Inc.

Client Name: El Paso Field Services

Client Project ID: Pit Closure 24324

Date Collected: 1/22/98

Date Extracted: 2/04/98

Date Analyzed: 2/05/98

Lab Sample ID: 9802002-2MS

Sample Matrix: Soil

Sample Weight: 20 g

Final Volume: 5 mL

Dilution Factor: 1

% Moisture: 0 %

Results based on wet weight

Analyte	Spike Added (mg/kg)	Sample Concentration (mg/kg)	MS Concentration (mg/kg)	MS Percent Recovery	QC Limits % Rec
Diesel	25.0	10.2	35.1	100	43 - 139

Analyte	Spike Added (mg/kg)	MSD Concentration (mg/kg)	MSD Percent Recovery	RPD	QC Limits RPD
Diesel	25.0	37.6	110	7	20

SURROGATE RECOVERY MS/MSD

Analyte	% Recovery MS	% Recovery MSD	% Rec Limits
Hexacosane	107	106	54 - 146

D = Not Detected

Accepted
3/4/98
87



PARAGON ANALYTICS, INC.

225 Commerce Drive ♦ Fort Collins, CO 80524 ♦ (800) 443-1511 ♦ (970) 490-1511 ♦ FAX (970) 490-1522

February 12, 1998

Mr. John Lambdin
El Paso Field Services
770 W. Navajo
Farmington, NM 87401



RE: Paragon Workorder: 98-02-002
Client Project Name: Pit Closure
Client Project Number: 24324

Dear Mr. Lambdin:

Two soil samples were received from El Paso Field Services on February 3, 1998. The samples were scheduled for Total Extractable Hydrocarbons (Diesel) analysis. The results for this analysis are contained in the enclosed report pages 1-8.

Thank you for your confidence in Paragon Analytics, Inc. Should you have any questions, please call.

Sincerely,

Paragon Analytics, Inc.
Victoria Bayly
Project Manager

VB/arp
Enclosure: Report



(800) 443-1511 or (970) 490-1511
(970) 490-1522 • Fax

CHAIN OF CUSTODY

DATE 2-2-77 Page of

REPORT TO: JOHN CAMERON
COMPANY: EL PASO FIELD SERVICE CO.
ADDRESS: 614 REILLY AVENUE
FARMINGTON, NM 87401
AMPLER: SCOTT PAGE
(505) 597-2144 (505) 599-2261
PHONE NO. FAX NO.

[illegible][illegible]

PROJECT INFORMATION									
PROJECT NUMBER: 34334									
PROJECT NAME: PIT CLOSURE									
I.D. NUMBER:									
AT: (1) STANDARD (X) RUSH DUE									
AMPLE DISPOSAL: HALF WASTE \$5.00 ea. RAD CHEM \$15.00 ea. RETURN									
COMMENTS:									

RELINQUISHED BY:		RELINQUISHED BY:		RELINQUISHED BY:	
1	2	3	1	2	3
Sign.	Sign.	Sign.	Sign.	Sign.	Sign.
Time	Time	Time	Time	Time	Time
Date	Date	Date	Date	Date	Date
Print	Print	Print	Print	Print	Print
Company	Company	Company	Company	Company	Company

RELINQUISHED BY:		RELINQUISHED BY:		RELINQUISHED BY:	
1	2	3	1	2	3
Sign.	Sign.	Sign.	Sign.	Sign.	Sign.
Time	Time	Time	Time	Time	Time
Date	Date	Date	Date	Date	Date
Print	Print	Print	Print	Print	Print
Company	Company	Company	Company	Company	Company

*** DO NOT WRITE IN SHADED AREAS**

DISTRIBUTION: White, Canary • PARAGON ANALYTICS, INC. Pink • Originator

CONDITION OF SAMPLE UPON RECEIPT

CLIENT: El Paso Field SvcsSHIPPING CONTAINER #: coolerWORKORDER NO. 9802002INITIALS: FBDATE: 4/3/98

1.	Does this project require special handling according to NEESA, Level 3, or CLP protocols? If yes, complete a. and b. a. Cooler Temperature _____ b. Lot No's. _____ c. Airbill Number _____	Yes	<u>No</u>
2.	Are custody seals on the cooler intact? If so, how many	<u>N/A</u>	Yes No
3.	Are custody seals on sample containers intact?	<u>N/A</u>	Yes No
4.	Is there a Chain of Custody (COC) or other representative documents, letters or shipping memos?	<u>Yes</u>	Yes No
5.	Is the COC complete? Relinquished: Yes <input checked="" type="checkbox"/> No Requested Analysis: Yes <input checked="" type="checkbox"/> No	<u>N/A</u>	Yes No
6.	Is the COC in agreement with the samples received? No. of Samples: Yes <input checked="" type="checkbox"/> No Sample ID's: Yes <input checked="" type="checkbox"/> No Matrix: Yes <input checked="" type="checkbox"/> No No. of Containers: Yes <input checked="" type="checkbox"/> No	<u>Yes</u>	Yes No
7.	Are the samples requiring chemical preservation preserved correctly?	<u>N/A</u>	Yes No
8.	Is there enough sample? If so, are they in the proper containers?	<u>Yes</u>	Yes No
9.	Are all samples within holding times for the requested analyses?	<u>Yes</u>	Yes No
10.	Were the sample(s) shipped on ice?	<u>N/A</u>	Yes No
11.	Were all sample containers received intact? (not broken or leaking, etc.)	<u>Yes</u>	Yes No
12.	Are samples requiring no headspace, headspace free?	<u>N/A</u>	Yes No
13.	Do the samples require quarantine?	<u>Yes</u>	Yes No
14.	Do samples require Paragon disposal?	<u>Yes</u>	Yes No
15.	Did the client return any unused bottles?	<u>Yes</u>	Yes No

Describe "NO" items (except No's 1, 13, & 14):

* only 1-2 days left on hold time

Was the client contacted? Yes _____ No _____

If yes, Date: _____ Name of person contacted: _____

Describe actions taken or client instructions: _____

Group Leader's Signature: _____

Date: _____

Cooler Temperature: 4°C
(Temp Blk)

BTEX SOIL SAMPLE WORKSHEET

File	:	980079	Date Printed	:	2/4/98
Soil Mass (g)	:	5.31	Multiplier (L/g)	:	0.00094
Extraction vol. (mL)	:	10	CAL FACTOR (Analytical):		200
Shot Volume (uL)	:	50	CAL FACTOR (Report):		0.18832
			DILUTION FACTOR:	1	Det. Limit
Benzene (ug/L)	:	0.00	Benzene (mg/Kg):	0.000	0.471
Toluene (ug/L)	:	0.00	Toluene (mg/Kg):	0.000	0.471
Ethylbenzene (ug/L)	:	0.00	Ethylbenzene (mg/Kg):	0.000	0.471
p & m-xylene (ug/L)	:	0.00	p & m-xylene (mg/Kg):	0.000	0.942
o-xylene (ug/L)	:	0.00	o-xylene (mg/Kg):	0.000	0.471
			Total xylenes (mg/Kg):	0.000	1.412
			Total BTEX (mg/Kg):	0.000	



SITE SKETCH

Serial No. SS- _____

Title _____

Project Name EPFS Swellhead Pits

Project No. 19007

Project Manager S. Pope

Phase/Task No. 1001.77

Client Company EPFS

Site Name SAN JACINTO #5 72386 T 29, R 10, Sec 21, E

Site Address _____ HWY 64 (New)

(Include north arrow and scale or dimensions. If available, preprint CAD drawing of site on this form.)

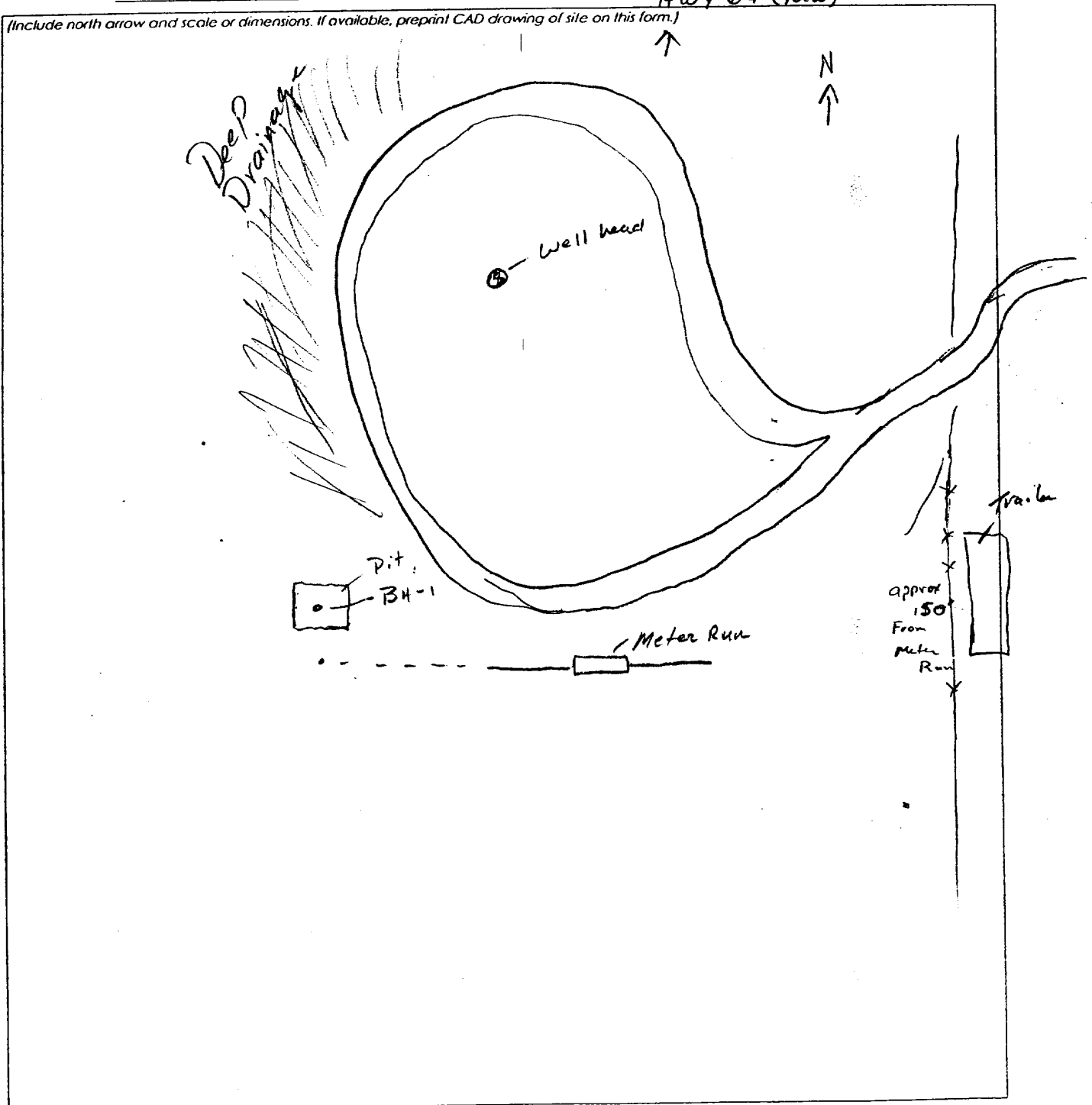

Sketch by (signature)

T. Pope

Date 1/21/98



CHAIN OF CUSTODY RECORD

Phase III Excavation

12-11-98 Ated.

12-11-98 Closure

PROJECT NUMBER # 24324 PROJECT NAME Pit Closure Project

SAMPLERS: (Signature)

PAV1 & Archuleta DATE: 10/20/98

LAB ID DATE TIME MATRIX FIELD ID

980745 10/20 1300 50:1 PRA-2

980746 10/20 1355 50:1 PRA-3

TOTAL NUMBER OF CONTAINERS

SAMPLE TYPE

TPH EPA 418.1

BTEX EPA 8020

LAB PID

Headspace

DID

SEQUENCE #

REMARKS

CONTRACT LABORATORY P. O. NUMBER

Page 1 of 1

RELINQUISHED BY: (Signature)

DATE/TIME

RECEIVED BY: (Signature)

DATE/TIME

RELINQUISHED BY: (Signature)

DATE/TIME

RECEIVED BY: (Signature)

RELINQUISHED BY: (Signature)

DATE/TIME

RECEIVED BY: (Signature)

RELINQUISHED BY: (Signature)

DATE/TIME

RECEIVED OF LABORATORY BY: (Signature)

REQUESTED TURNAROUND TIME:

☒ ROUTINE ☐ RUSH

CARRIER CO.

SAMPLE RECEIPT REMARKS

COOL + Turret

360°F

RESULTS & INVOICES TO:

FIELD SERVICES LABORATORY
EL PASO NATURAL GAS COMPANY
P.O. BOX 4990
FARMINGTON, NEW MEXICO 87499

BILL NO.:

CHARGE CODE

505-599-2144

FAX

599-2261



**FIELD SERVICES LABORATORY
ANALYTICAL REPORT
PIT CLOSURE PROJECT**

SAMPLE IDENTIFICATION

	Field ID	Lab ID
SAMPLE NUMBER:	PRA-2	980745
MTR CODE SITE NAME:	72386	San Jacinto #5
SAMPLE DATE TIME (Hrs):	10/20/98	1300
PROJECT:	Phase III Excavation	
DATE OF TPH EXT. ANAL.:	10/27/98	10/27/98
DATE OF BTEX EXT. ANAL.:	10/22/98	10/27/98
TYPE DESCRIPTION:	VG	SOIL

Field Remarks: Sample Depth - 21'

RESULTS

PARAMETER	RESULT	UNITS	QUALIFIERS			
			DF	Q	M(g)	V(ml)
BENZENE	< 1.0	MG/KG				
TOLUENE	6.28	MG/KG				
ETHYL BENZENE	2.23	MG/KG				
TOTAL XYLENES	32.4	MG/KG				
TOTAL BTEX	73.3	MG/KG				
TPH (MOD.8015)	824	MG/KG				
HEADSPACE PID	2999	PPM				
PERCENT SOLIDS	83.1	%				

-- TPH is by EPA Method 418.1 and BTEX is by EPA Method 8020 --

The Surrogate Recovery was at 109.1 % for this sample All QA/QC was acceptable.
ative:

DF = Dilution Factor Used

Approved By: _____

Date: _____



**FIELD SERVICES LABORATORY
ANALYTICAL REPORT
PIT CLOSURE PROJECT**

SAMPLE IDENTIFICATION

	Field ID	Lab ID
SAMPLE NUMBER:	PRA-3	980746
MTR CODE SITE NAME:	72386	San Jacinto #5
SAMPLE DATE TIME (Hrs):	10/20/98	1355
PROJECT:	Phase III Excavation	
DATE OF TPH EXT. ANAL.:	10/27/98	10/27/98
DATE OF BTEX EXT. ANAL.:	10/22/98	10/26/98
TYPE DESCRIPTION:	Blank	SOIL

Field Remarks: Blank

RESULTS

PARAMETER	RESULT	UNITS	QUALIFIERS			
			DF	Q	M(g)	V(ml)
BENZENE	<0.5	MG/KG				
TOLUENE	<0.5	MG/KG				
ETHYL BENZENE	<0.5	MG/KG				
TOTAL XYLENES	<1.5	MG/KG				
TOTAL BTEX	<3	MG/KG				
TPH (MOD.8015)	66	MG/KG				
HEADSPACE PID	0	PPM				
PERCENT SOLIDS	100.0	%				

-- TPH is by EPA Method 418.1 and BTEX is by EPA Method 8020 --

The Surrogate Recovery was at 103.4 % for this sample All QA/QC was acceptable.
I active:

The TPH is thought to be due to cross contamination.

DF = Dilution Factor Used

Approved By: _____

Date: _____

PINNACLE
LABORATORIES

2709-D Pan American Freeway NE
Albuquerque, New Mexico 87107
Phone (505) 344-3777
Fax (505) 344-4412



Pinnacle Lab ID number 810087
November 04, 1998

EL PASO FIELD SERVICES
770 WEST NAVAJO
FARMINGTON, NM 87401

Project Name PHASE III EXC.
Project Number (none)

Attention: JOHN LAMBDIN

On 10/23/98 Pinnacle Laboratories, Inc. Inc., (ADHS License No. AZ0592), received a request to analyze **non-aq** samples. The samples were analyzed with EPA methodology or equivalent methods. The results of these analyses and the quality control data, which follow each set of analyses, are enclosed.

If you have any questions or comments, please do not hesitate to contact us at (505)344-3777.

Kimberly D. McNeill
Project Manager

H. Mitchell Rubenstein, Ph. D.
General Manager

MR: mt

Enclosure

Reviewed and Accepted
11/6/98
J.T.



2709-D Pan American Freeway NE
Albuquerque, New Mexico 87107
Phone (505) 344-3777
Fax (505) 344-4413

CLIENT : EL PASO FIELD SERVICES
PROJECT # : (none)
PROJECT NAME : PHASE III EXC.

PINNACLE ID : 810087
DATE RECEIVED : 10/23/98
REPORT DATE : 11/4/98

AEN			DATE
ID. #	CLIENT DESCRIPTION	MATRIX	COLLECTED
01	980745	NON-AQ	10/20/98
02	980746	NON-AQ	10/20/98

2709-D Pan American Freeway NE
 Albuquerque, New Mexico 87107
 Phone (505) 344-3777
 Fax (505) 344-4413

**PINNACLE
 LABORATORIES**

GAS CHROMATOGRAPHY RESULTS

TEST : EPA 8015 MODIFIED (DIRECT INJECT)
 CLIENT : EL PASO FIELD SERVICES
 PROJECT # : (none)
 PROJECT NAME : PHASE III EXC.

PINNACLE I.D.: 810087

SAMPLE		MATRIX	DATE	DATE	DATE	DIL.
ID. #	CLIENT I.D.		SAMPLED	EXTRACTED	ANALYZED	FACTOR
01	980745	AQUEOUS	10/20/98	10/27/98	10/27/98	1
02	980746	AQUEOUS	10/20/98	10/27/98	10/27/98	1
PARAMETER		DET. LIMIT	UNITS	01	02	
FUEL HYDROCARBONS, C6-C10		2/0	MG/KG	800	66	
FUEL HYDROCARBONS, C10-C22		1.0	MG/KG	24	< 1.0	
FUEL HYDROCARBONS, C22-C36		1.0	MG/KG	< 1.0	< 1.0	
CALCULATED SUM:				824	66	

SURROGATE:

O-TERPHENYL (%)

SURROGATE LIMITS

(66 - 151)

105

92

CHEMIST NOTES:

N/A

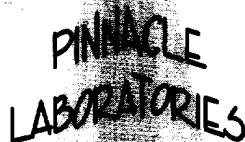

2709-D Pan American Freeway NE
Albuquerque, New Mexico 87107
Phone (505) 344-3777
Fax (505) 344-4413

GAS CHROMATOGRAPHY RESULTS
REAGENT BLANK

TEST	: EPA 8015 MODIFIED (DIRECT INJECT)	PINNACLE I.D.	: 810087
BLANK I.D.	: 102798	DATE EXTRACTED	: 10/27/98
CLIENT	: EL PASO FIELD SERVICES	DATE ANALYZED	: 10/27/98
PROJECT #	: (none)	SAMPLE MATRIX	: NON-AQ
PROJECT NAME	: PHASE III EXC.		

PARAMETER	UNITS	
FUEL HYDROCARBONS, C6-C10	MG/KG	< 10
FUEL HYDROCARBONS, C10-C22	MG/KG	< 5.0
FUEL HYDROCARBONS, C22-C36	MG/KG	< 5.0

SURROGATE:

O- 3PHENYL (%)

105

SURROGATE LIMITS (80 - 151)

CHEMIST NOTES:

N/A

CHAIN OF CUSTODY

DATE: 10/22/98 PAGE: 1 OF 1

AEN(NM) Accession #:

810087

SHADED AREAS ARE FOR LAB USE ONLY.

PLEASE FILL THIS FORM IN COMPLETELY.

PROJECT MANAGER: John Lambdin		COMPANY: EL PASO Field Services		ADDRESS: 770 West Navajo Farmington, NM 87401		PHONE: (505) 399-2144		FAX: (505) 599-2261		BILL TO: Above		COMPANY: ADDRESS:	
SAMPLE ID		DATE		TIME		MATRIX		LAB ID		Petroleum Hydrocarbons (418.1) TRPH		ANALYSIS REQUEST	
980745		10/20/98		1300		Soil				X		(MOD.8015) Diesel/Direct Inject	
980746		10/20/98		1355		Soil						(M8015) Gas/Purge & Trap	
												8021 (BTEX)/8015 (Gasoline)	
												8021 (BTEX) <input type="checkbox"/> MTBE <input type="checkbox"/> TMB <input type="checkbox"/> PCE	
												8021 (TCL)	
												8021 (EDX)	
												8021 (HALO)	
												8021 (CUST)	
												504.1 EDB <input type="checkbox"/> / DBCP <input type="checkbox"/>	
												8260 (TCL) Volatile Organics	
												8260 (Full) Volatile Organics	
												8260 (CUST) Volatile Organics	
												8260 (Landfill) Volatile Organics	
												Pesticides /PCB (608/8081)	
												Herbicides (615/8151)	
												Base/Neutral/Acid Compounds GC/MS (625/8270)	
												Polynuclear Aromatics (610/8310)	
												General Chemistry:	
												Priority Pollutant Metals (13)	
												Target Analyte List Metals (23)	
												RCRA Metals (8)	
												RCRA Metals by TCLP (Method 1311)	
												Metals:	
												NUMBER OF CONTAINERS	
PROJECT INFORMATION		PRIOR AUTHORIZATION IS REQUIRED FOR RUSH PROJECTS		RELINQUISHED BY:		RELINQUISHED BY:							
PROJ. NO.:		(RUSH) <input type="checkbox"/> 24hr <input type="checkbox"/> 48hr <input type="checkbox"/> 72hr <input type="checkbox"/> 1 WEEK		Signature: <u>Marion Hopper</u> Time: <u>0800</u>		Signature: _____ Time: _____							
PROJ. NAME: <u>Phase III Exc.</u>		CERTIFICATION REQUIRED: <input type="checkbox"/> NM <input type="checkbox"/> SDWA <input type="checkbox"/> OTHER		Printed Name: <u>Marion Hopper</u> Date: <u>10/23/98</u>		Printed Name: _____ Date: _____							
P.O. NO.:		METHANOL PRESERVATION <input type="checkbox"/>		Company: <u>EPES</u>		Company: _____							
SHIPPED VIA: <u>Fed Ex</u>		COMMENTS: FIXED FEE <input type="checkbox"/>		RECEIVED BY: _____ Time: _____		RECEIVED BY: (LAB) _____ Time: _____							
SAMPLE RECEIPT				Signature: <u>Monica Jimenez</u> Time: <u>1030</u>		Signature: _____ Time: _____							
NO. CONTAINERS: <u>2</u>				Printed Name: <u>Monica Jimenez</u> Date: <u>10/23/98</u>		Printed Name: _____ Date: _____							
CUSTODY SEALS: <u>Q/N/NA</u>				Company: <u>American Environmental Network (NM), Inc.</u>		Company: _____							
RECEIVED INTACT: <u>Yes</u>													
CECE: <u>30c</u>													

FIELD PIT REMEDIATION/CLOSURE FORM Phase III Exc.

GENERAL	<p>Meter: <u>72386</u> Location: <u>SAN JACINTO #5</u></p> <p>Coordinates: Letter: <u>E</u> Section <u>21</u> Township: <u>29</u> Range: <u>10</u></p> <p>Or Latitude _____ Longitude _____</p> <p>Date Started : <u>10-20-98</u> Area: <u>10</u> Run: <u>23</u></p>
FIELD OBSERVATIONS	<p>Sample Number(s): <u>PRA-2 PRA-3</u></p> <p>Sample Depth: <u>21'</u> Feet</p> <p>Final PID Reading <u>2999 ppm</u> PID Reading Depth <u>21'</u> Feet</p> <p style="text-align: center;">Yes No</p> <p>Groundwater Encountered <input type="checkbox"/> (1) <input checked="" type="checkbox"/> (2) Approximate Depth _____ Feet</p>
CLOSURE	<p>Remediation Method :</p> <p>Excavation <input checked="" type="checkbox"/> (1) Approx. Cubic Yards <u>343</u></p> <p>Onsite Bioremediation <input type="checkbox"/> (2)</p> <p>Backfill Pit Without Excavation <input type="checkbox"/> (3)</p> <p>Soil Disposition:</p> <p>Envirotech <input checked="" type="checkbox"/> (1) <input type="checkbox"/> (3) Tierra</p> <p>Other Facility <input type="checkbox"/> (2) Name: _____</p> <p>Pit Closure Date: <u>10-22-98</u> Pit Closed By: <u>Philip Services</u></p>
REMARKS	<p>Remarks : <u>PID reading (N-2999 ppm) (S-2999 ppm)</u></p> <p><u>(E-2430 ppm) (W-2999 ppm) (B-1735 ppm) (C-2999 ppm)</u></p> <p><u>Pit Size 21X21X21 Black contaminated</u></p> <p><u>soil at 8'</u></p>
	<p>Signature of Specialist: <u>Paul Archuleta</u></p>

PROJECT _____

Cont. _____d From Page _____

Sample . Pan wt - Smp wt . Pan + Dry . Dry wt . % Solid

11/7/98

980648	2.64 - 12.30 =	9.66	11.70	9.06	93.8 %
980649	2.64 - 11.37 =	8.73	10.82	8.18	93.7
980649 _{dup}	2.63 - 11.20 =	8.57	10.70	8.07	94.2
980650	2.64 - 11.10 =	8.46	10.16	7.52	88.9
980651	2.63 - 12.48 =	9.85	12.14	9.51	96.5
980652	2.62 - 11.47 =	8.85	10.84	8.22	92.9

9/23/98

980660	2.64 - 11.41 =	8.77	10.67	8.03	91.6 %
980661	2.64 - 11.09 =	8.45	10.62	7.98	94.4
980661 _{dup}	2.63 - 11.14 =	8.51	10.64	8.01	94.1
980662	2.63 - 11.28 =	8.65	10.92	8.29	95.8
980663	2.63 - 12.87 =	10.24	12.44	9.81	95.8
980664	2.63 - 13.19 =	10.56	13.16	10.53	99.7
980665	2.65 - 11.45 =	8.80	10.65	8.00	90.9
980666	2.64 - 11.23 =	8.59	10.54	7.90	92.0
980667	2.64 - 11.66 =	9.02	11.32	8.68	96.2
980668	2.63 - 11.43 =	8.80	10.63	8.00	90.9

10/12/98

980689	2.63 - 11.55 =	8.92	10.75	8.12	91.0 %
980689 _{dup}	2.63 - 11.39 =	8.76	10.53	7.90	90.2
980690	2.63 - 11.45 =	8.82	10.90	8.27	93.8
980732	2.64 - 11.22 =	8.58	9.96	7.32	85.3

10/22/98

980744	2.61 - 13.60 =	10.99	12.22	9.61	89.9 87.4 %
980744 _{dup}	2.60 - 13.11 =	10.51	11.74	9.14	87.0
980745	2.64 - 12.47 =	9.83	10.81	8.17	83.1
980746	2.64 - 15.95 =	13.31	15.95	13.31	100
980747	2.61 - 12.15 =	9.54	11.71	9.10	95.4
980749	2.62 - 16.76 =	14.14	16.75	14.13	99.9
980750	2.63 - 15.45 =	12.82	14.50	11.87	92.1

Continued on Page _____

Read and Understood By _____

Signed _____

Date _____

Signed _____

Date _____

BTEX SOIL SAMPLE WORKSHEET

File	:	980745	Date Printed	:	10/27/98
Soil Mass (g)	:	5.07	Multiplier (L/g)	:	0.00099
Extraction vol. (mL)	:	20	CAL FACTOR (Analytical):		400
Shot Volume (uL)	:	50	CAL FACTOR (Report):		0.39448

		DILUTION FACTOR:	2	Det. Limit	
Benzene (ug/L)	:	<0.5	Benzene (mg/Kg): #VALUE!	0.986	
Toluene (ug/L)	:	15.91	Toluene (mg/Kg):	6.275	0.986
Ethylbenzene (ug/L)	:	5.66	Ethylbenzene (mg/Kg):	2.234	0.986
p & m-xylene (ug/L)	:	63.05	p & m-xylene (mg/Kg):	24.873	1.972
o-xylene (ug/L)	:	19.04	o-xylene (mg/Kg):	7.511	0.986
			Total xylenes (mg/Kg):	32.384	2.959
			Total BTEX (mg/Kg):	73.276	

BTEX SOIL SAMPLE WORKSHEET

File	:	980746	Date Printed	:	10/27/98
Soil Mass (g)	:	5.61	Multiplier (L/g)	:	0.00089
Extraction vol. (mL)	:	10	CAL FACTOR (Analytical)		200
Shot Volume (uL)	:	50	CAL FACTOR (Report)		0.17825

		DILUTION FACTOR:	1	Det. Limit
Benzene (ug/L)	:	<0.5	Benzene (mg/Kg): #VALUE!	0.446
Toluene (ug/L)	:	<0.5	Toluene (mg/Kg): #VALUE!	0.446
Ethylbenzene (ug/L)	:	<0.5	Ethylbenzene (mg/Kg): #VALUE!	0.446
p & m-xylene (ug/L)	:	<1.0	p & m-xylene (mg/Kg): #VALUE!	0.891
o-xylene (ug/L)	:	<0.5	o-xylene (mg/Kg): #VALUE!	0.446
			Total xylenes (mg/Kg): #VALUE!	1.337
			Total BTEX (mg/Kg): #VALUE!	



Remit to: Pinnacle Laboratories, Inc.
P.O. Box 36720
Albuquerque, NM 87176-6720
Phone: (505) 344-3777 Fax: (505) 344-4413



Bill To: El Paso Field Service Co.
770 West Navajo
Farmington, NM 87401

EPPS Sample #'s
980745
and 980746

Date	Invoice
11/ 4/98	78272

Client #: 850-020

Project Name: Phase III Exc.

Mc# 72386 SAN JACINTO #5

Original
BALANCE DUE: 95.23

PO Number	Terms	Project
	Net 30	PIN ALB-810

Quantity	Description	Rate	Amount
2	EPA Method 8015 Diesel (Direct Inject)	45.00	90.00
APPROVED FOR PAYMENT DATE <u>11/10/98</u> CHARGE <u>729622-3410-2048 - OPN MAINT - CONTR - CTRF</u> SIGNATURE <u>John Lambdin</u> John Lambdin 599-2144			
	NM Gross Receipts Tax	5.8125%	5.23
Accession #: 810087 Authorized By: John Lambdin		TOTAL:	95.23

A finance charge of 11/2% will be charged on balances 30 days past due
DISTRIBUTION: White-Customer, Yellow-File, Pink-Accounting