

## NOTICE OF INTENTION TO DRILL

Notice must be given to the District Office of the Oil Conservation Commission and approval obtained before drilling or recompletion begins. If changes in the proposed plan are considered advisable, a copy of this notice showing such changes will be returned to the sender. Submit this notice in QUINTUPPLICATE. One copy will be retained following approval. See additional instructions in Rules and Regulations of the Commission. If State Land submit 6 Copies. Attach Form G-128 in triplicate to first 3 copies of form G-101

**Farmington, New Mexico**  
(Place)

**December 22, 1960**  
(Date)

OIL CONSERVATION COMMISSION  
SANTA FE, NEW MEXICO

Gentlemen:

You are hereby notified that it is our intention to commence the Drilling of a well to be known as

**Artec Oil and Gas Company**

(Company or Operator)

**Morgan B**  
(Lease)

Well No. **B-1**

**P**

(Unit)

The well is

located **890** feet from the **South** line and **990** feet from the

**East**

1/4 of Section **32**

**29N**

**11W**

NMPM.

(GIVE LOCATION FROM SECTION LINE)

**Basin Dakota**

Pool,

**San Juan**

County

If State Land the Oil and Gas Lease is No. **100**

If patented land the owner is

Address

We propose to drill well with drilling equipment as follows:

**Rotary tools to**

**approximate total depth of 6300 ft.**

The nature of pitting mud is **Blackbit**

Drilling Contractor

**Artec Drilling Co., Box 2060  
Farmington, New Mexico**

We intend to complete this well in the **Dakota**

formation at an approximate depth of **6300 ft.** feet.

## CASING PROGRAM

We propose to use the following strings of casing and to cement them as indicated:

Size of Hole	Size of Casing	Weight per Foot	New or Second Hand	Depth	Sacks Cement
<b>12 1/4"</b>	<b>8 5/8"</b>	<b>24.4</b>	<b>New</b>	<b>100</b>	<b>150</b>
<b>7 7/8"</b>	<b>4 1/2"</b>	<b>11.6 &amp; 12.5</b>	<b>New</b>	<b>6300</b>	<b>400</b>
	<b>2 3/8"</b>	<b>4.7</b>	<b>New</b>	<b>6300</b>	

If changes in the above plans become advisable we will notify you immediately.

ADDITIONAL INFORMATION (If recompletion give full details of proposed plan of work.)

**South one-half section 32, 313 acres, dedicated to well.**

Approved

Except as follows:

*Subject to recovery of lost oil  
& further formation with cement*

OIL CONSERVATION COMMISSION

By *George C. Salmon*

Sincerely yours,

**Artec Oil and Gas Company**

(Company or Operator)

ORIGINAL SIGNED BY JOE C. SALMON

By

**Joe C. Salmon**  
Position **District Superintendent**

Send Communications regarding well to

Name **Artec Oil and Gas Company**

Address **Drawer 570, Farmington, New Mexico**

NEW MEXICO OIL CONSERVATION COMMISSION  
Well Location and Acreage Dedication Plat

Section A.

Date December 22, 1960

Operator Artec Oil and Gas Company Lease Mangum B  
Well No. 1 Unit Letter P Section 32 Township 29N Range 11W NMPM  
Located 890 Feet From South Line, 990 Feet From East Line  
County San Juan G. L. Elevation 5425 Dedicated Acreage 313 Acres  
Name of Producing Formation Dakota Pool Basin Dakota

1. Is the Operator the only owner\* in the dedicated acreage outlined on the plat below?  
Yes XX No \_\_\_\_\_
2. If the answer to question one is "no," have the interests of all the owners been consolidated by communitization agreement or otherwise? Yes \_\_\_\_\_ No \_\_\_\_\_. If answer is "yes,"  
Type of Consolidation \_\_\_\_\_
3. If the answer to question two is "no," list all the owners and their respective interests below:

Owner

Land Description



Section. B

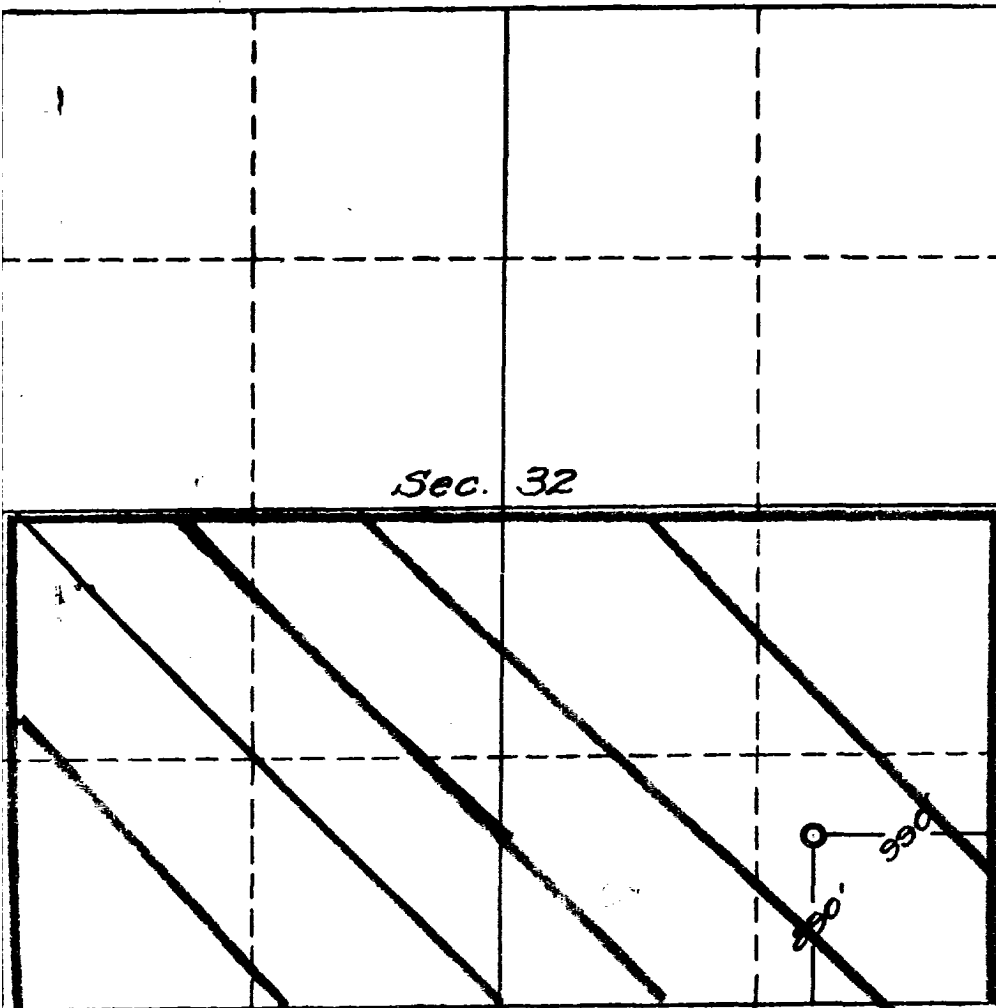

This is to certify that the information in Section A above is true and complete to the best of my knowledge and belief.

Artec Oil and Gas Company  
(Operator)

ORIGINAL SIGNED BY JOE C. S. [Signature]  
(Representative)

Braver 570, Farmington, N.M.  
Address

This is to certify that the well location shown on the plat in Section B was plotted from field notes of actual surveys made by me or under my supervision and that the same is correct to the best of my knowledge and belief.

Date Surveyed Dec 22 1960  
[Signature]  
Ernest V. [Signature]  
Registered Land Surveyor.

Certificate No. 1545 L.S.