

UNITED STATES  
DEPARTMENT OF THE INTERIOR  
GEOLOGICAL SURVEY

30-447-20079

## APPLICATION FOR PERMIT TO DRILL, DEEPEN, OR PLUG BACK

## 1a. TYPE OF WORK

DRILL ☒DEEPEN ☐PLUG BACK ☐

## b. TYPE OF WELL

OIL  
WELL ☐GAS  
WELL ☒

OTHER

SINGLE  
ZONE ☐MULTIPLE  
ZONE ☒

## 2. NAME OF OPERATOR

Aztec Oil and Gas Company

## 3. ADDRESS OF OPERATOR

Drawer 570, Farmington, New Mexico

## 4. LOCATION OF WELL (Report location clearly and in accordance with any State requirements.)\*

At surface

1120 FNL &amp; 970 FEL Sec 13-29N-10W

At proposed prod. zone

Same

## 14. DISTANCE IN MILES AND DIRECTION FROM NEAREST TOWN OR POST OFFICE\*

5823 Gr

## 15. DISTANCE FROM PROPOSED\*

LOCATION TO NEAREST  
PROPERTY OR LEASE LINE, FT.  
(Also to nearest drig. unit line, if any)

## 16. NO. OF ACRES IN LEASE

2340.01

17. NO. OF ACRES ASSIGNED  
TO THIS WELL

320

18. DISTANCE FROM PROPOSED LOCATION\*  
TO NEAREST WELL, DRILLING, COMPLETED,  
OR APPLIED FOR, ON THIS LEASE, FT.

## 19. PROPOSED DEPTH

6870

## 20. ROTARY OR CABLE TOOLS

rotary

## 21. ELEVATIONS (Show whether DF, RT, GR, etc.)

5823 Gr

## 22. APPROX. DATE WORK WILL START\*

## 23.

## PROPOSED CASING AND CEMENTING PROGRAM

SIZE OF HOLE	SIZE OF CASING	WEIGHT PER FOOT	SETTING DEPTH	QUANTITY OF CEMENT
12-1/4"	8-5/8"		300'	225 SX
7-7/8"	5-1/2"		6870'	250 SX (650 SX IN STAGES)

Propose to:

Set 300' 8-5/8" surface casing and cement with 225 sx

Set 6870' 5-1/2" production casing and cement with 250 sx

DV tools to be set at base of Mesaverde and Pictured Cliffs

and cemented to cover each formation (approx. 650 sx)

Perforate Dakota section and sand-water frac.

Set Bridge Plug above Dakota

Perforate Point Lookout and sand-water frac

Run 1 1/2" tubing with sliding sleeve and produce Dakota through tubing

and Point Lookout through casing

Proration unit E/2 of Sec. 13-29N-10W

IN ABOVE SPACE DESCRIBE PROPOSED PROGRAM: If proposal is to deepen or plug back, give data on present productive zone and proposed new productive zone. If proposal is to drill or deepen directionally, give pertinent data on subsurface locations and measured and true vertical depths. Give blowout preventer program, if any.

24.

SIGNED

Joe C. Salmon

TITLE District Superintendent

DATE May 25, 1967

(This space for Federal or State office use)

PERMIT NO.

APPROVAL DATE

APPROVED BY

TITLE

CONDITIONS OF APPROVAL, IF ANY:

Okal

\*See Instructions On Reverse Side

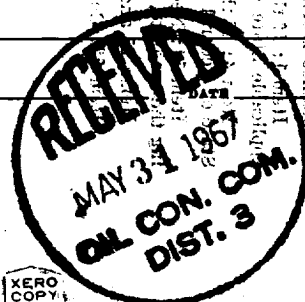
XERO  
COPYXERO  
COPYXERO  
COPYXERO  
COPY



# NEW MEXICO OIL CONSERVATION COMMISSION

## WELL LOCATION AND ACERAGE DEDICATION PLAT

All distances must be from the outer boundaries of the Section

Operator <b>AZTEC OIL &amp; GAS COMPANY</b>			Lease <b>Reid</b>		Well No. <b>2</b>
Unit Letter <b>A</b>	Section <b>13</b>	Township <b>29 North</b>	Range <b>10 West</b>	County <b>San Juan</b>	
Actual Footage Location of Well: <b>1120</b> feet from the <b>North</b> line and <b>970</b> feet from the <b>East</b> line					
Ground Level Elev. <b>5823</b>	Producing Formation <b>Mosier-De-Sabota</b>	Pool <b>Blanco Mosier-De-Sabota</b>	Dedicated Acreage: <b>380</b>		Acres

1. Outline the acreage dedicated to the subject well by colored pencil or hachure marks on the plat below.
2. If more than one lease is dedicated to the well, outline each and identify the ownership thereof (both as to working interest and royalty).
3. If more than one lease of different ownership is dedicated to the well, have the interests of all owners been consolidated by communitization, unitization, force-pooling, etc?

☒ Yes    ☐ No    If answer is "yes," type of consolidation Communitization

If answer is "no," list the owners and tract descriptions which have actually consolidated. (Use reverse side of this form if necessary.)

No allowable will be assigned to the well until all interests have been consolidated (by communitization, unitization, forced-pooling, or otherwise) or until a non standard unit, eliminating such interests, has been approved by the Commission.

### CERTIFICATION

I hereby certify that the information contained herein is true and complete to the best of my knowledge and belief.

ORIGINAL SIGNED BY **JOE C. SALMON**

Name  
**Joe C. Salmon**  
 Position  
**District Superintendent**  
 Company  
**Aztec Oil and Gas**  
 Date  
**May 25, 1967**

STATE OF NEW MEXICO  
 I hereby certify that the well location shown on this plat was plotted from field notes of actual surveys made by me or under my supervision, and that the same is true and correct to the best of my knowledge and belief.  
 NO. 3602  
 REGISTERED PROFESSIONAL ENGINEER AND LAND SURVEYOR  
**May 17, 1967**  
 Registered Professional Engineer and/or Land Surveyor

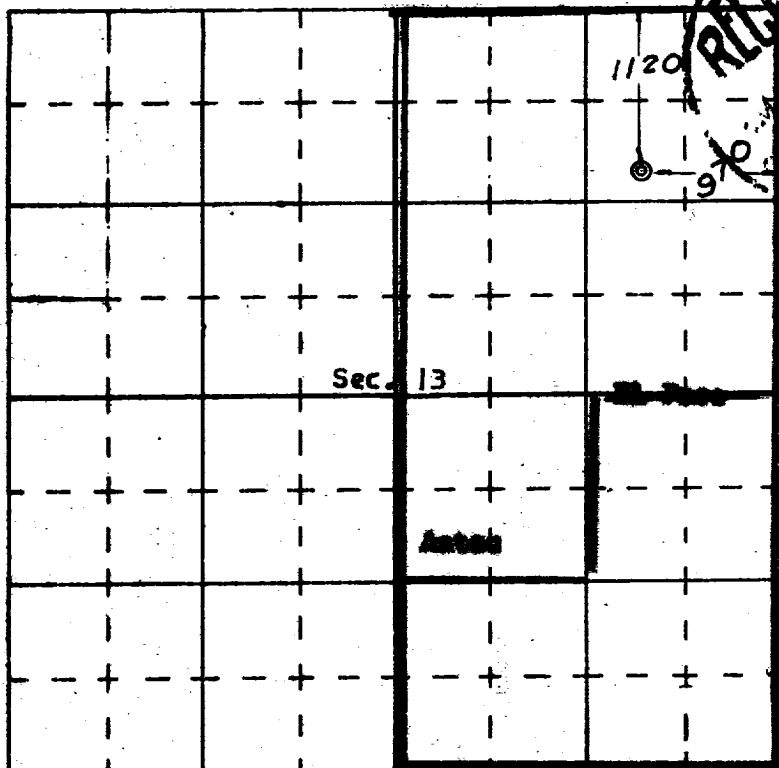

**3602**  
Certificate No.