

NEW MEXICO OIL CONSERVATION COMMISSION
Santa Fe, New Mexico

Form C-101
Revised (12/1/55)

NOTICE OF INTENTION TO DRILL

Notice must be given to the District Office of the Oil Conservation Commission and approval obtained before drilling or recompletion begins. If changes in the proposed plan are considered advisable, a copy of this notice showing such changes will be returned to the sender. Submit this notice in QUINTUPLICATE. One copy will be returned following approval. See additional instructions in Rules and Regulations of the Commission. If State Land submit 6 Copies Attach Form C-128 in triplicate to first 3 copies of form C-101

Farmington, San Juan County, New Mexico

April 18, 1960

(Place)

(Date)

OIL CONSERVATION COMMISSION
SANTA FE, NEW MEXICO

Gentlemen:

You are hereby notified that it is our intention to commence the Drilling of a well to be known as

Kay Kimbell Company Box 1540 Fort Worth, Texas

(Company or Operator)

Creek-Bloomfield

(Lease)

Well No. 2, in N (Unit) The well is

located 830 feet from the South line and 1850 feet from the West line of Section 22, T. 29 N, R. 11 W, NMPM.

(GIVE LOCATION FROM SECTION LINE)

Astee Pool, San Juan County

If State Land the Oil and Gas Lease is No.

If patented land the owner is Kay Kimbell

Address P. O. Box 1540 Fort Worth, Texas

We propose to drill well with drilling equipment as follows: Rotary Tools

The status of plugging bond is On File in Santa Fe, New Mexico

Drilling Contractor Empire States Drilling Corp. Box 891,
Farmington, New Mexico.

We intend to complete this well in the Fruitland Formation
formation at an approximate depth of 1600 feet.

CASING PROGRAM

We propose to use the following strings of Casing and to cement them as indicated:

Size of Hole	Size of Casing	Weight per Foot	New or Second Hand	Depth	Sacks Cement
12"	8 5/8"	26	New	200'	150 Reg.
7 7/8"	5 1/2"	15.5	New	1600'	100 Reg.

If changes in the above plans become advisable we will notify you immediately.

ADDITIONAL INFORMATION (If recompletion give full details of proposed plan of work.)

Well will be drilled to Total Depth with rotary tools. Completion will be by
perforations in Fruitland section and sand, water frac.

APR 18 1960

Approved....., 19.....
Except as follows:

Sincerely yours,

Kay Kimbell Company

(Company or Operator)

By N. A. Neely

Position Field Representative

Send Communications regarding well to

Name N. A. Neely, 1041 Zuni Drive

Address Farmington, New Mexico

OIL CONSERVATION COMMISSION

By A. R. Hendrick

PETROLEUM ENGINEER DIST. NO. 3



NEW MEXICO OIL CONSERVATION COMMISSION

Well Location and Acreage Dedication Plat

Section A.

Date 4-18-60

Operator Kay Kimbell Lease Cook-Bloomfield
Well No. 2 Unit Letter N Section 22 Township 29 North Range 11 West NMPM
Located 830 Feet From South Line, 1850 Feet From West Line
County San Juan G. L. Elevation 5432 Dedicated Acreage 1.60 Acres
Name of Producing Formation FRUITLAND Pool AZTEC

1. Is the Operator the only owner* in the dedicated acreage outlined on the plat below?
Yes X No
2. If the answer to question one is "no," have the interests of all the owners been consolidated by communitization agreement or otherwise? Yes No . If answer is "yes,"
Type of Consolidation
3. If the answer to question two is "no," list all the owners and their respective interests below:

Owner

Land Description

Section B

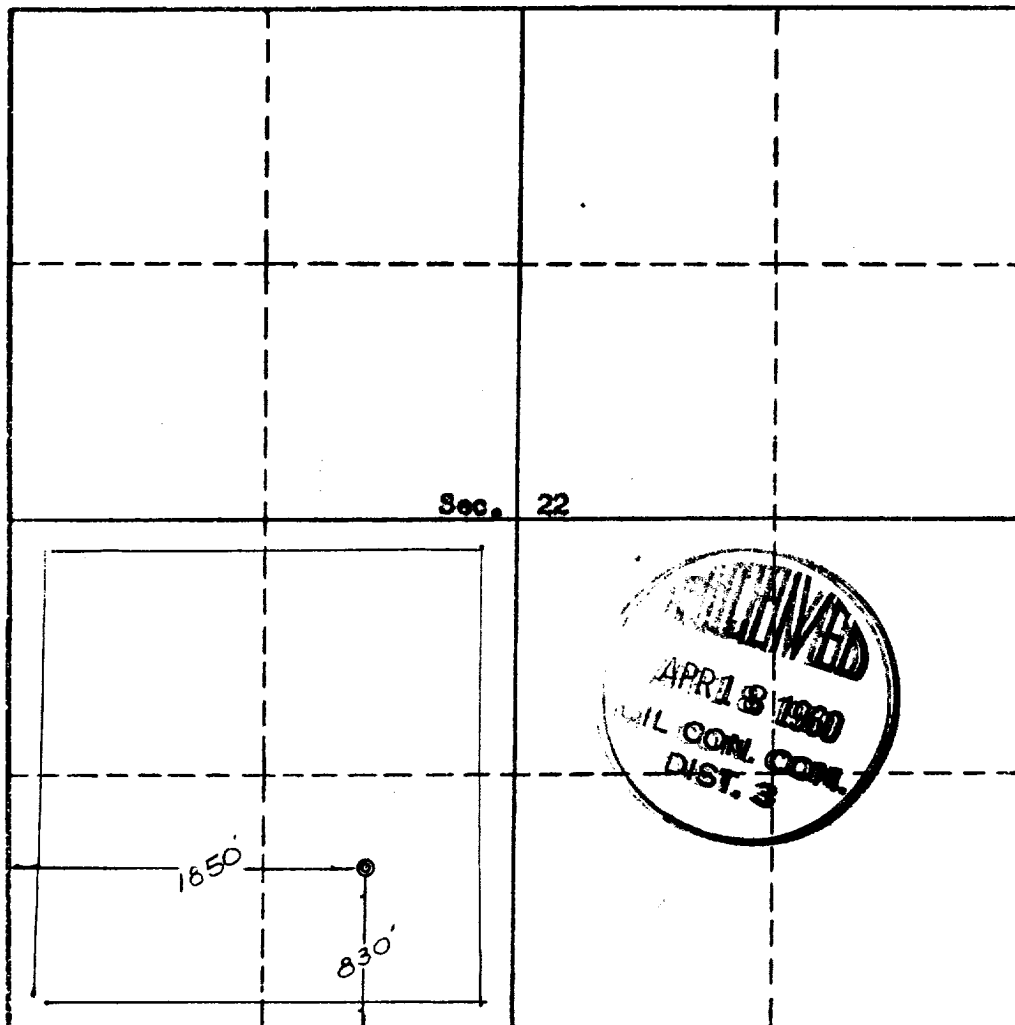

This is to certify that the information in Section A above is true and complete to the best of my knowledge and belief.

Kay Kimbell
(Operator)

N.A. Neely
(Representative)

1041 Zuni Dr
Address Garrison, New Mex

This is to certify that the well location shown on the plat in Section A was obtained from field notes of actual surveys made by me or under my supervision and that the same is true to the best of my knowledge and belief.

Date Surveyed April 12, 1960

Ernest V. Echoshawk
Ernest V. Echoshawk
Registered Land Surveyor.

Certificate No. 1545

STATE OF NEW MEXICO		
OIL CONSERVATION COMMISSION		
AZTEC DISTRICT OFFICE		
NUMBER OF COPIES RECEIVED		5
DISTRIBUTION		
SANTA FE		1
FILE		1
U.S.G.S.		2
LAND OFFICE		
TRANSPORTER	OIL	
	GAS	
PRODUCTION OFFICE		
OPERATOR		1