

NEW MEXICO OIL CONSERVATION COMMISSION

Well Location and Acreage Dedication Plat

SECTION A.

Date April 14, 1961

Operator Artec Oil and Gas Company Lease Smith
 Well No. 1-6 Unit Letter 0 Section 18 Township 29N Range 13W NMPM
 Located 705 Feet From South Line, 2110 Feet From East Line
 County San Juan G. L. Elevation 5235 Dedicated Acreage 85.52 Acres
 Name of Producing Formation Gallup Pool Total

1. Is the Operator the only owner* in the dedicated acreage outlined on the plat below? Yes XX No
 2. If the answer to question One is "No," have the interests of all the owners been consolidated by communitization agreement or otherwise? Yes _____ No _____. If answer is "Yes," Type of Consolidation _____
 3. If the answer to question Two is "No," list all the owners and their respective interests below:

OWNER

LAND DESCRIPTION



SECTION B.

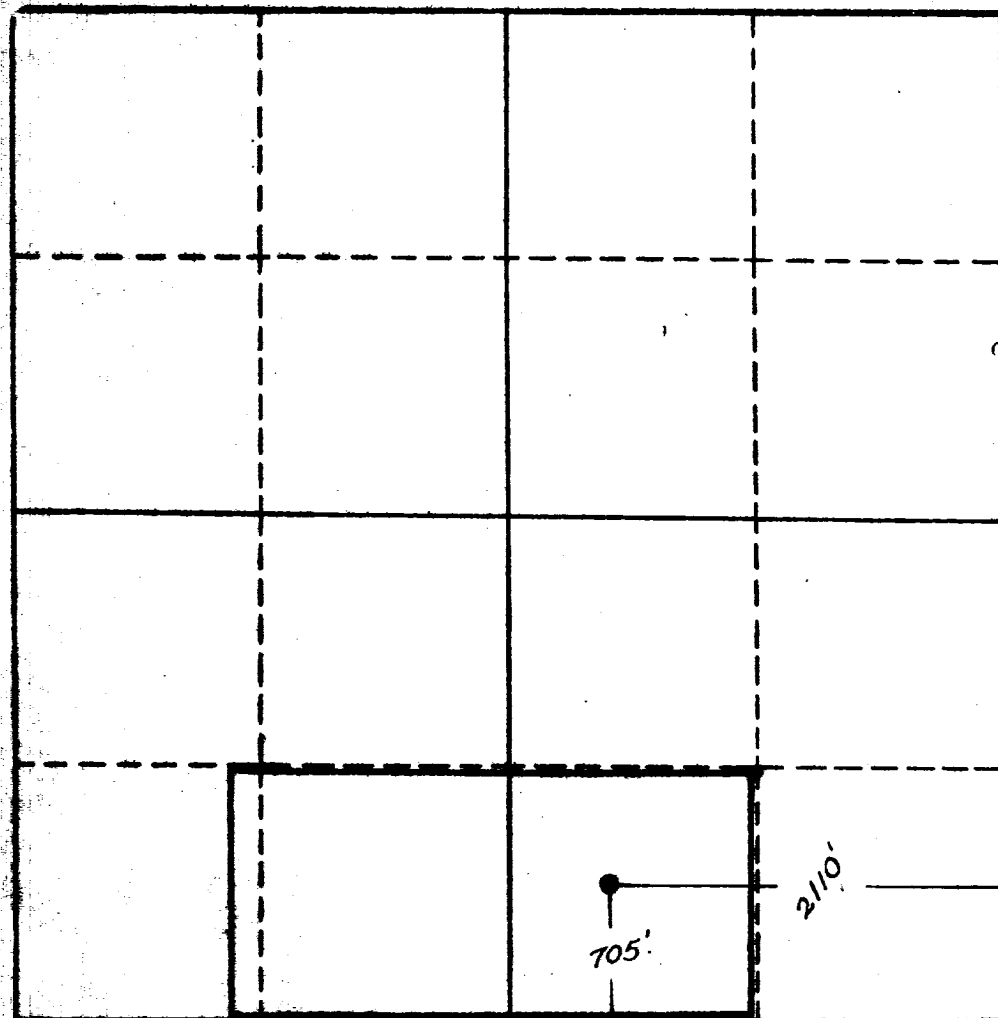

This is to certify that the information in Section A above is true and complete to the best of my knowledge and belief.

Artec Oil and Gas Company
(OPERATOR)

ORIGINAL SIGNED BY JOE C. SALMON
(REPRESENTATIVE)

Drawer 570, Farmington, N.M.

(ADDRESS)

This is to certify that the information shown on the plat was plotted from actual survey and that my supervision and work is true and correct to the best of my knowledge and belief.

Date Surveyed April 11, 1961

Four States Engineering Co.
FARMINGTON, NEW MEXICO

E. L. Poter
REGISTERED ENGINEER OR
LAND SURVEYOR

Certificate No. 3084