

(SUBMIT IN TRIPLICATE)

UNITED STATES
DEPARTMENT OF THE INTERIOR
GEOLOGICAL SURVEY

Land Office Santa Fe
Lease No. SP 078931-1
Unit _____

SUNDRY NOTICES AND REPORTS ON WELLS

NOTICE OF INTENTION TO DRILL.....	<input checked="" type="checkbox"/>	SUBSEQUENT REPORT OF WATER SHUT-OFF.....	
NOTICE OF INTENTION TO CHANGE PLANS.....		SUBSEQUENT REPORT OF SHOOTING OR ACIDIZING.....	
NOTICE OF INTENTION TO TEST WATER SHUT-OFF.....		SUBSEQUENT REPORT OF ALTERING CASING.....	
NOTICE OF INTENTION TO RE-DRILL OR REPAIR WELL.....		SUBSEQUENT REPORT OF RE-DRILLING OR REPAIR.....	
NOTICE OF INTENTION TO SHOOT OR ACIDIZE.....		SUBSEQUENT REPORT OF ABANDONMENT.....	
NOTICE OF INTENTION TO PULL OR ALTER CASING.....		SUPPLEMENTARY WELL HISTORY.....	
NOTICE OF INTENTION TO ABANDON WELL.....			

(INDICATE ABOVE BY CHECK MARK NATURE OF REPORT, NOTICE, OR OTHER DATA)

October 23, 1961

USA Glenn H. Callow
Well No. 20 is located 2070 ft. from N line and 2070 ft. from E line of sec 33
NE/4 Sec. 33 29 N 13 W H.M.P.M.
(1/4 Sec. and Sec. No.) (Twp.) (Range) (Meridian)
Total San Juan New Mexico
(Field) (County or Subdivision) (State or Territory)

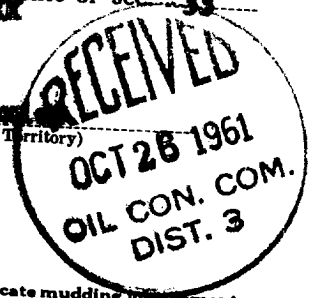

The elevation of the ground level ~~surface~~ above sea level is 5823 ft.

DETAILS OF WORK

(State names of and expected depths to objective sands; show sizes, weights, and lengths of proposed casings; indicate mudding jobs, cementing points, and all other important proposed work)

Drill and complete subject well as follows:

1. Drill 12-1/4" hole to 150'. Set 8-5/8" OD, 2 3/4", J-55, STAC casing at 150' and circulate cement to surface. WOC 12 hours and pressure test casing after WOC 8 hours.
2. Drill 7-7/8" hole to TD approximately 5710'.
3. Run EM-Resistivity and Gamma Ray-Sonic logs.
4. Run 4-1/2" OD, 9.5#, J-55, STAC casing through deepest pay. Set stage collar 50' below base of Pictured Cliff and cement in two stages. First stage: 100 sacks 50-50 Pozmix 2% gal. Second stage: 50 sacks 50-50 Pozmix 6% gal. WOC. Pressure test casing.
5. Perforate, fracture, and clean up well. Run potential test and clean location.

I understand that this plan of work must receive approval in writing by the Geological Survey before operations may be commenced.

Company Tenneco Corporation, acting by and through its managing agent, Tenneco Oil Co

Address P. O. Box 1714

Durango, Colorado

By [Signature] L. B. Flumb

Title District Production Superintendent

NUMBER OF COPIES RECEIVED	
DISTRIBUTION	
SANTA FE	
FILE	
U.S.G.S.	
LAND OFFICE	
TRANSPORTER	OIL
	GAS
PRODUCTION OFFICE	
OPERATOR	

NEW MEXICO OIL CONSERVATION COMMISSION
WELL LOCATION AND ACREAGE DEDICATION PLAT
 SEE INSTRUCTIONS FOR COMPLETING THIS FORM ON THE REVERSE SIDE

FORM C-128
 Revised 5/1/57

SECTION A

Operator TEDESCO OIL COMPANY		Lease CALLOW		Well No. 20	
Unit Letter G.	Section 33	Township 29 North	Range 13 West	County San Juan	
Actual Footage Location of Well: 2070 feet from the North line and 2070 feet from the East line					
Ground Level Elev. 5823 ungraded	Producing Formation Callow		Pool Total	Dedicated Acreage: 80 Acres	

1. Is the Operator the only owner in the dedicated acreage outlined on the plat below? YES NO ("Owner" means the person who has the right to drill into and to produce from any pool and to appropriate the production either for himself or for himself and another. (65-3-29 (e) NMSA 1935 Comp.)
2. If the answer to question one is "no," have the interests of all the owners been consolidated by communization agreement or otherwise? YES NO . If answer is "yes," Type of Consolidation _____
3. If the answer to question two is "no," list all the owners and their respective interests below:

Owner	Land Description

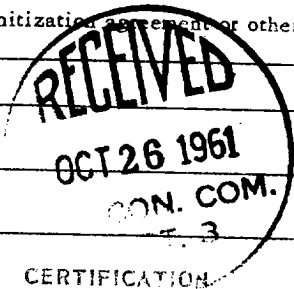

SECTION B

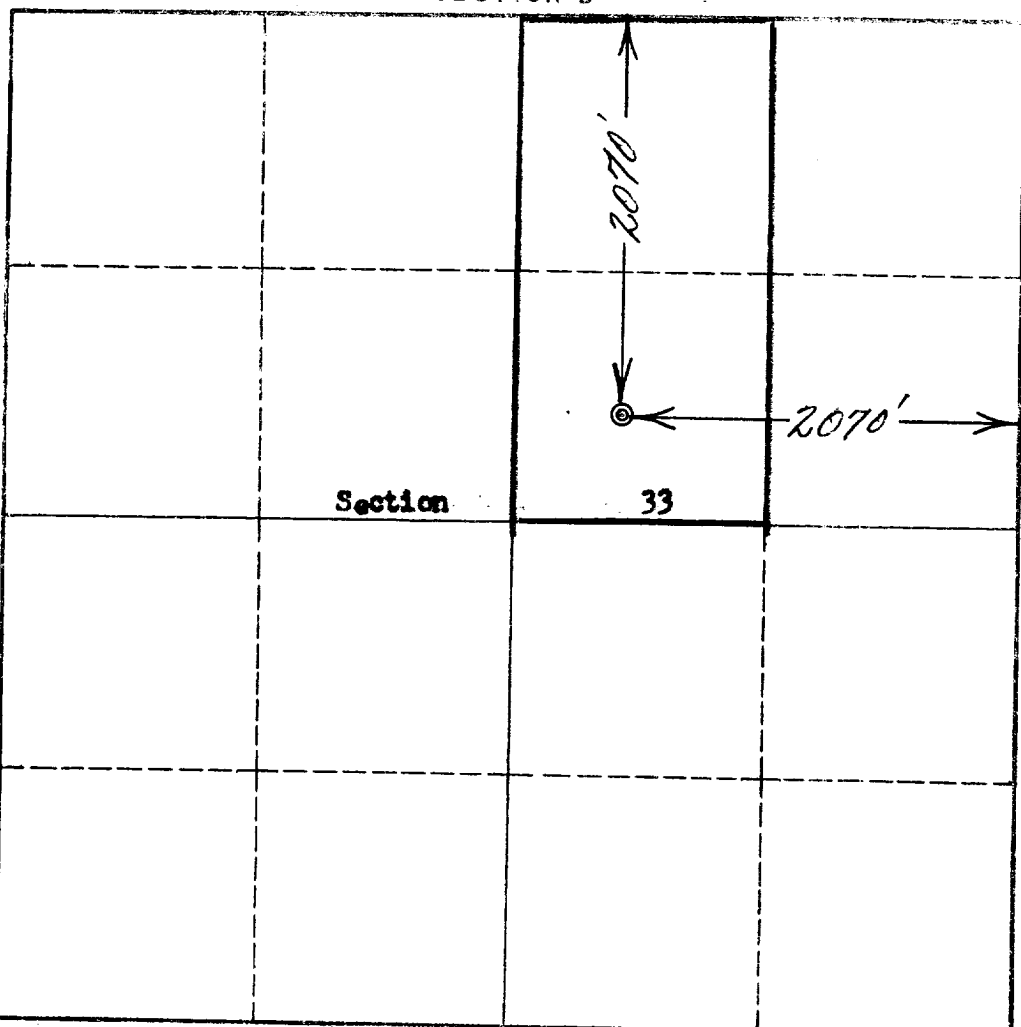

I hereby certify that the information in SECTION A above is true and complete to the best of my knowledge and belief.

Name <i>L. B. Flinn</i>
Position Dist. Production Mgr.
Company Texaco Corp. acting by & thru its managing agent,
Date Texaco Oil Company October 23, 1961

I hereby certify that the well location shown on the plat in SECTION B was plotted from field notes of actual surveys made by me or under my supervision, and that the same is true and correct to the best of my knowledge and belief.

Date 19 October 1961
Registered Professional Engineer and Surveyor <i>Robert E. Ernst</i> Robert E. Ernst

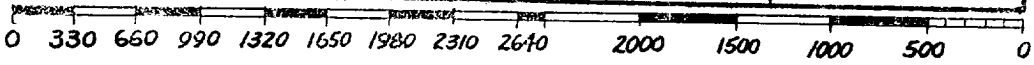

Certification No. **15 2463**

INSTRUCTIONS FOR COMPLETION OF FORM C-128

1. Operator shall furnish and certify to the information called for in Section A.
2. Operator shall outline the dedicated acreage for *both* oil and gas wells on the plat in Section B.
3. A registered professional engineer or land surveyor registered in the State of New Mexico or approved by the Commission shall show on the plat the location of the well and certify this information in the space provided.
4. All distances shown on the plat must be from the outer boundaries of the Section.
5. If additional space is needed for listing owners and their respective interests as required in question 3 of Section A, please use space below.