

NEW MEXICO OIL CONSERVATION COMMISSION

NOTICE OF INTENTION TO DRILL

See Rules 101 and 1104.

If changes in the proposed plan are considered advisable, a copy of this notice showing such changes will be returned to the sender. Submit this notice in triplicate. One copy will be returned following approval.

Astec, New Mexico**January 17, 1952**

Place

Date

Notice hereby is given that it is our intention to commence the drilling of a well to be known as.....

Francis L. Harvey **Garrett Pooled Unit** well No. **3** in **NE 1/4**
Company or Operator Lease

of Sec. **12**, T. **29N**, R. **18W**, N. M., P. M. Pool, **San Juan** County.

The well is **1660'** feet from (N.) (S.) line and **1510'** feet from (E.) (W.) line of the above section.

(Give location from section lines. Cross out wrong directions.)

If state land the oil and gas lease is No. Assignment No.

If patented land the owner is **Blanch M. Garrett (W. NE 1/4)**

Address

If government land the permittee is **G. T. Lackey, assigned to Francis L.**

Address **(W. NE 1/4)** **Harvey**

The lessee is **Francis L. Harvey**

Address **Box 990, Wichita Falls, Texas**

We propose to drill well with drilling equipment as follows: **Rotary Rig**

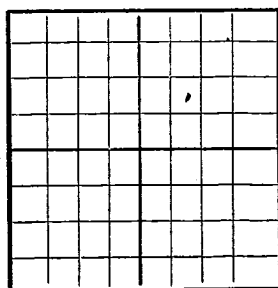

AREA 640 ACRES

LOCATE WELL CORRECTLY

The status of a bond for this well in conformance with Rule 101 of the General Rules and Regulations of the Commission is as follows: **\$10,000.00 blanket bond (National Surety Corporation)**

We propose to use the following strings of casing and to land or cement them as indicated:

Size of Hole	Size of Casing	Weight Per Foot	New or Second Hand	Depth	Landed or Cemented	Sacks Cement
14" 8-5/8"	10" 5 1/2"	32# 14#	New "	100' 2100'	Cemented "	Surface 100'

If changes in the above plans become advisable we will notify you before cementing or landing casing. We estimate that the first productive oil or gas sand should occur at a depth of about **2050'** feet.

Additional information:

It is intended to drill this well according to the following plans: Set approximately 100' of 10" surface casing cemented to surface. Drill through the Pictured Cliffs formation, cement 5 1/2" casing in the top of the sand, shoot with approximately 3 qts. solidified nitroglycerin to the foot, clean out and if gas is encountered, run 1" syphon line to the bottom and complete as gas well.

Approved **January 17**, 19**52**

except as follows:

Permission to shift the rig 50 feet west of Garrett Pooled Unit #2 to this location was obtained and approved on form C-102 January 17, 1952.

OIL CONSERVATION COMMISSION,

By **Al. Green**

Title **Oil & Gas Inspector, Dist. #3**

Francis L. Harvey Company or Operator

By **Francis L. Harvey**

Position **Co-owner**

Send communications regarding well to:

Name **Francis L. Harvey**

Address **Box 990, Wichita Falls, Texas**

Correction

OCT 23 AM 11

Company Francis Harvey

Lease GARRETT COM Well No. 3

Sec. 12 T. 29 N. R. 11 W. N.M.P.M.

Location 1660 from the North line and 1510 from the East line.

CHANGE
OK .. *al*

San Juan County

New Mexico

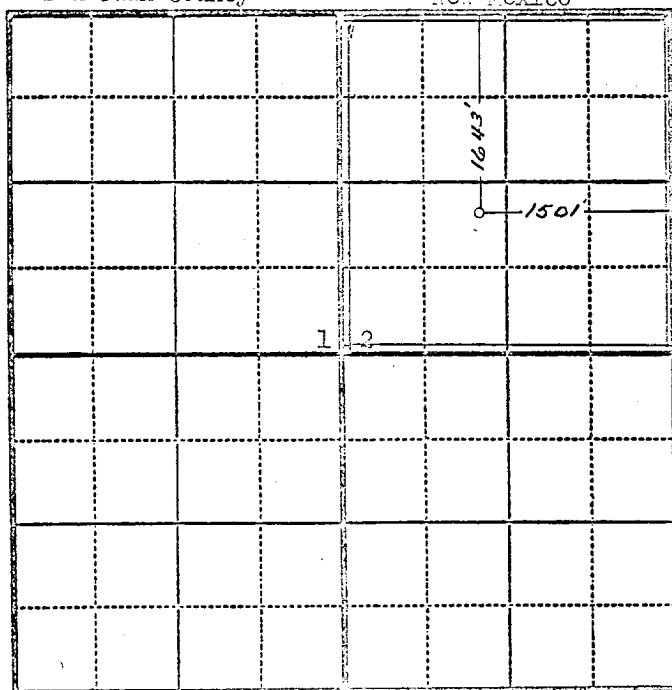

Scale—4 inches equals 1 mile.

This is to certify that the above plat was prepared from field notes of actual surveys made by me or under my supervision and that the same are true and correct to the best of my knowledge and belief.

Charles J. Finklea

Seal:

Registered Professional
Engineer and Land Surveyor.

Charles J. Finklea
N. Mex. Reg. No. 1302

Surveyed April 3, 1952

Company Francis Harvey

Lease GARRETT COM Well No. 3

Sec. 12 T. 29 N., R. 11 W., S.M.P.M.

Location 1643' from the North line and 1501' from
the East line.

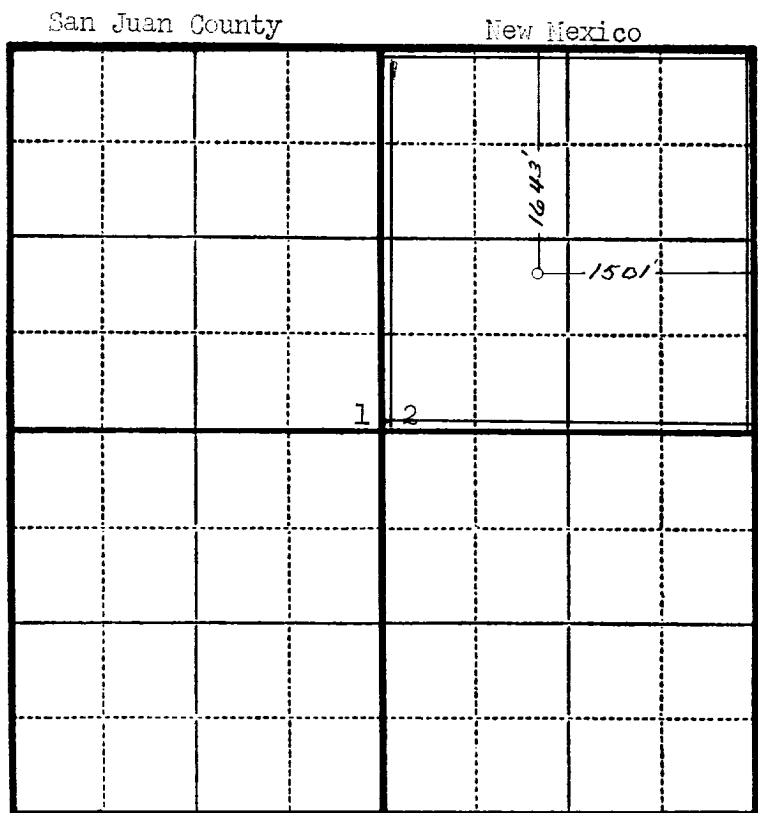

Scale—4 inches equals 1 mile.

This is to certify that the above plat was prepared from field notes of actual surveys made by me or under my supervision and that the same are true and correct to the best of my knowledge and belief.

Charles J. Finklea

Seal:

Registered Professional
Engineer and Land Surveyor.

Charles J. Finklea
N. Mex. Reg. No. 1302

Surveyed April 3, 1952.