

UNITED STATES
DEPARTMENT OF THE INTERIOR
GEOLOGICAL SURVEY

APPLICATION FOR PERMIT TO DRILL, DEEPEN, OR PLUG BACK

1a. TYPE OF WORK DRILL <input checked="" type="checkbox"/> DEEPEN <input type="checkbox"/> PLUG BACK <input type="checkbox"/>		5. LEASE DESIGNATION AND SERIAL NO. I-69-100-56
b. TYPE OF WELL OIL WELL <input checked="" type="checkbox"/> GAS WELL <input type="checkbox"/> OTHER <input type="checkbox"/> SINGLE ZONE <input type="checkbox"/> MULTIPLE ZONE <input type="checkbox"/>		6. IF INDIAN, ALLOTTEE OR TRIBE NAME Navajo Tribe
2. NAME OF OPERATOR Eastern Petroleum Company		7. UNIT AGREEMENT NAME
3. ADDRESS OF OPERATOR P. O. Box 291, Cermi, Illinois 62821		8. FARM OR LEASE NAME Navajo
4. LOCATION OF WELL (Report location clearly and in accordance with any State requirements.)* At surface 358' from North line, 814' from East line At proposed prod. zone Same		9. WELL NO. 3
14. DISTANCE IN MILES AND DIRECTION FROM NEAREST TOWN OR POST OFFICE* Five miles west of Shiprock, New Mexico		10. FIELD AND POOL, OR WILDCAT Rattlesnake
15. DISTANCE FROM PROPOSED* LOCATION TO NEAREST PROPERTY OR LEASE LINE, FT. (Also to nearest drig. unit line, if any) 3200'	16. NO. OF ACRES IN LEASE 4000	11. SEC., T., R., M., OR BLK. AND SURVEY OR AREA Sec. 2, T29N, R19W
18. DISTANCE FROM PROPOSED LOCATION* TO NEAREST WELL, DRILLING, COMPLETED, OR APPLIED FOR, ON THIS LEASE, FT. 3700'	19. PROPOSED DEPTH 900'	12. COUNTY OR PARISH San Juan
21. ELEVATIONS (Show whether DF, RT, GR, etc.) 5278 Ground		13. STATE New Mex.
23. PROPOSED CASING AND CEMENTING PROGRAM		17. NO. OF ACRES ASSIGNED TO THIS WELL 40
22. APPROX. DATE WORK WILL START* September 5, 1967		20. ROTARY OR CABLE TOOLS Rotary

23. PROPOSED CASING AND CEMENTING PROGRAM				
SIZE OF HOLE	SIZE OF CASING	WEIGHT PER FOOT	SETTING DEPTH	QUANTITY OF CEMENT
12"	8 5/8"	32.75	20'	10 BX
7 7/8"	5 1/2"	15	900'	50 BX

Propose to drill and test the Dakota sandstone.
If productive will set and cement 5 1/2" casing.

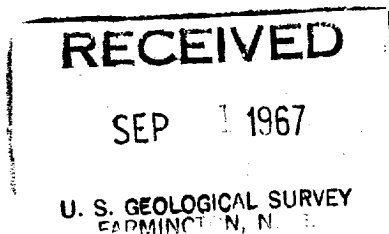

IN ABOVE SPACE DESCRIBE PROPOSED PROGRAM: If proposal is to deepen or plug back, give data on present productive zone and proposed new productive zone. If proposal is to drill or deepen directionally, give pertinent data on subsurface locations and measured and true vertical depths. Give blowout preventer program, if any.

24. SIGNED RE Lanth TITLE Geologist-Agent DATE 8-30-67

(This space for Federal or State office use)

PERMIT NO. _____ APPROVAL DATE _____

APPROVED BY _____ TITLE _____ DATE _____

CONDITIONS OF APPROVAL, IF ANY:

Instructions

General: This form is designed for submitting proposals to perform certain well operations, as indicated, on all types of lands and leases for appropriate action by either a Federal or a State agency, or both, pursuant to applicable Federal and/or State laws and regulations. Any necessary special instructions concerning the use of this form and the number of copies to be submitted, particularly with regard to local, area, or regional procedures and practices, either are shown below or will be issued by, or may be obtained from, the local Federal and/or State office.

Item 1: If the proposal is to redrill to the same reservoir at a different subsurface location or to a new reservoir, use this form with appropriate notations. Consult applicable State or Federal regulations concerning subsequent work proposals or reports on the well.

Item 4: If there are no applicable State requirements, locations on Federal or Indian land should be described in accordance with Federal requirements. Consult local State or Federal office for specific instructions.

Item 14: Needed only when location of well cannot readily be found by road from the land or lease description. A plat, or plats, separate or on this reverse side, showing the roads to, and the surveyed location of, the well, and any other required information, should be furnished when required by Federal or State agency offices.

Items 15 and 18: If well is to be, or has been directionally drilled, give distances for subsurface location of hole in any present or objective production zone.

Item 22: Consult applicable Federal or State regulations, or appropriate officials, concerning approval of the proposal before operations are started.

NEW MEXICO OIL CONSERVATION COMMISSION
WELL LOCATION AND ACREAGE DEDICATION PLAT

Form C-102
Supersedes C-128
Effective 1-1-65

All distances must be from the outer boundaries of the Section.

Operator Eastern Petroleum Company Thomas H. Connelly			Lease Navajo		Well No. 3
Unit Letter A	Section 2	Township 29 North	Range 19 West	County San Juan	
Actual Footage Location of Well: 358 feet from the North line and 814 feet from the East line					
Ground Level Elev: 5278	Producing Formation Dakota		Pool Rattlesnake	Dedicated Acreage: 40 Acres	

1. Outline the acreage dedicated to the subject well by colored pencil or hachure marks on the plat below.
2. If more than one lease is dedicated to the well, outline each and identify the ownership thereof (both as to working interest and royalty).
3. If more than one lease of different ownership is dedicated to the well, have the interests of all owners been consolidated by communitization, unitization, force-pooling, etc?

☐ Yes ☐ No If answer is "yes," type of consolidation One lease

If answer is "no," list the owners and tract descriptions which have actually been consolidated. (Use reverse side of this form if necessary.)

No allowable will be assigned to the well until all interests have been consolidated (by communitization, unitization, forced-pooling, or otherwise) or until a non-standard unit, eliminating such interests, has been approved by the Commission.

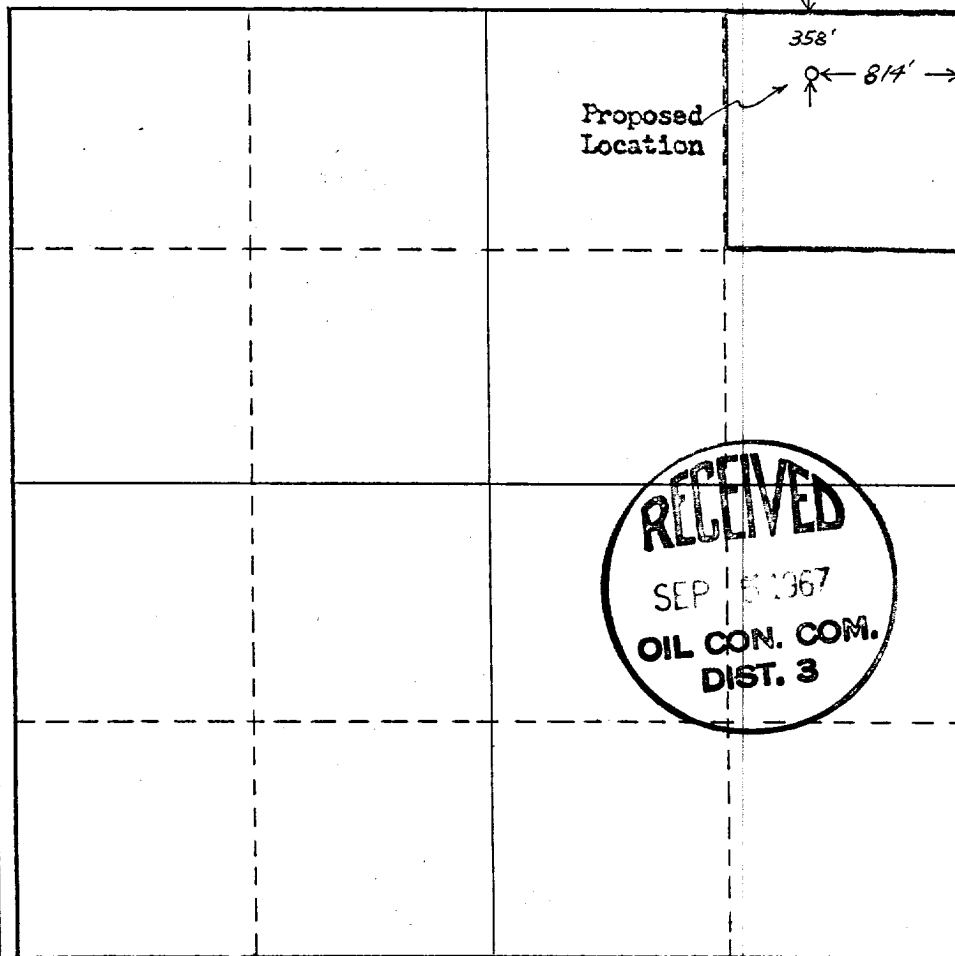

CERTIFICATION

I hereby certify that the information contained herein is true and complete to the best of my knowledge and belief.

Name

R. E. Lauth

Position

Geologist-Agent

Company **Eastern Petroleum Co.**
~~Thomas H. Connelly~~

Date **August 30, 1967**
~~February 1, 1967~~

I hereby certify that the well location shown on this plat was plotted from field notes of actual surveys made by me or under my supervision, and that the same is true and correct to the best of my knowledge and belief.

Date Surveyed

January 31, 1967

Registered Professional Engineer
and/or Land Surveyor

Frederick H. Reed

Certificate No.

0 330 660 990 1320 1650 1980 2310 2640 2000 1500 1000 500 0