

UNITED STATES
DEPARTMENT OF THE INTERIOR
GEOLOGICAL SURVEY

30-245-20067

APPLICATION FOR PERMIT TO DRILL, DEEPEN, OR PLUG BACK

1. TYPE OF WORK

DRILL ☒DEEPEN ☐PLUG BACK ☐

2. TYPE OF WELL

OIL

☐

GAS

☒

OTHER

SINGLE

☒

MULTIPLE

ZONE

☐

3. NAME OF OPERATOR

Aztec Oil and Gas Company

4. ADDRESS OF OPERATOR

Drawer 570, Farmington, New Mexico

5. LOCATION OF WELL (Report location clearly and in accordance with any State requirements.)*

At surface

1120 FSL & 1690 FEL - Sec 11-29N-12W

At proposed prod. zone

6. DISTANCE IN MILES AND DIRECTION FROM NEAREST TOWN OR POST OFFICE*

7. DISTANCE FROM PROPOSED*

LOCATION TO NEAREST
PROPERTY OR LEASE LINE, FT.
(Also to nearest drilg. unit line, if any)

8. NO. OF ACRES IN LEASE

800 ac

9. DISTANCE FROM PROPOSED LOCATION*
TO NEAREST WELL, DRILLING, COMPLETED,
OR APPLIED FOR, ON THIS LEASE, FT.

10. PROPOSED DEPTH

6475

11. ELEVATIONS (Show whether DF, RT, GR, etc.)

5687 GR

12.

PROPOSED CASING AND CEMENTING PROGRAM

SIZE OF HOLE	SIZE OF CASING	WEIGHT PER FOOT	SETTING DEPTH	QUANTITY OF CEMENT
12-1/4"	8-5/8"		300 feet	225 sx
7-7/8"	4-1/2"		6475 feet	250 sx (650 sx in stages)

Propose to:

Set 300' 8-5/8" surface casing and cement to surface with 225 sacks.
Run 6475' 4 1/2" production casing and cement with 250 sx. DV tool to be
set at base of Mesaverde and Pictured Cliffs and cemented to cover
each formation (approximately 650 sx)
Perforate Dakota section and sand-water frac. Run 1 1/2" tubing and put
on production.

IN ABOVE SPACE DESCRIBE PROPOSED PROGRAM: If proposal is to deepen or plug back, show location of well, productive zone and proposed new productive zone. If proposal is to drill or deepen directionally, give pertinent data on subsurface locations and measured and true vertical depths. Give blowout preventer program, if any.

24.

SIGNED

TITLE District Superintendent

DATE May 3, 1967

(This space for Federal or State office use)

PERMIT NO.

APPROVAL DATE

APPROVED BY

CONDITIONS OF APPROVAL, IF ANY:

TITLE

*See Instructions On Reverse Side

U. S. GEOLOGICAL SURVEY
FARMINGTON, N. M.XERO
COPYXERO
COPYXERO
COPYXERO
COPY



**NEW MEXICO OIL CONSERVATION COMMISSION
WELL LOCATION AND ACERAGE DEDICATION PLAT**

All distances must be from the outer boundaries of the Section

Operator AZTEC OIL & GAS COMPANY			Lease Federal PRI		Well No. 1
Unit Letter 0	Section 11	Township 29 North	Range 12 West	County San Juan	
Actual Footage Location of Well: 1120 feet from the South line and 1690 feet from the East line					
Ground Level Elev. 5687	Producing Formation Dakota		Pool Basin Dakota	Dedicated Acreage: 320 Acres	

1. Outline the acreage dedicated to the subject well by colored pencil or hachure marks on the plat below.
2. If more than one lease is dedicated to the well, outline each and identify the ownership thereof (both as to working interest and royalty),
3. If more than one lease of different ownership is dedicated to the well, have the interests of all owners been consolidated by communitization, unitization, force-pooling, etc?

☒ Yes ☐ No If answer is "yes," type of consolidation **communitization**

If answer is "no," list the owners and tract descriptions which have actually consolidated. (Use reverse side of this Form if necessary.)

No allowable will be assigned to the well until all interests have been consolidated by communitization, unitization, forced-pooling, or otherwise) or until a non standard unit, eliminating such interests has been approved by the Commission.

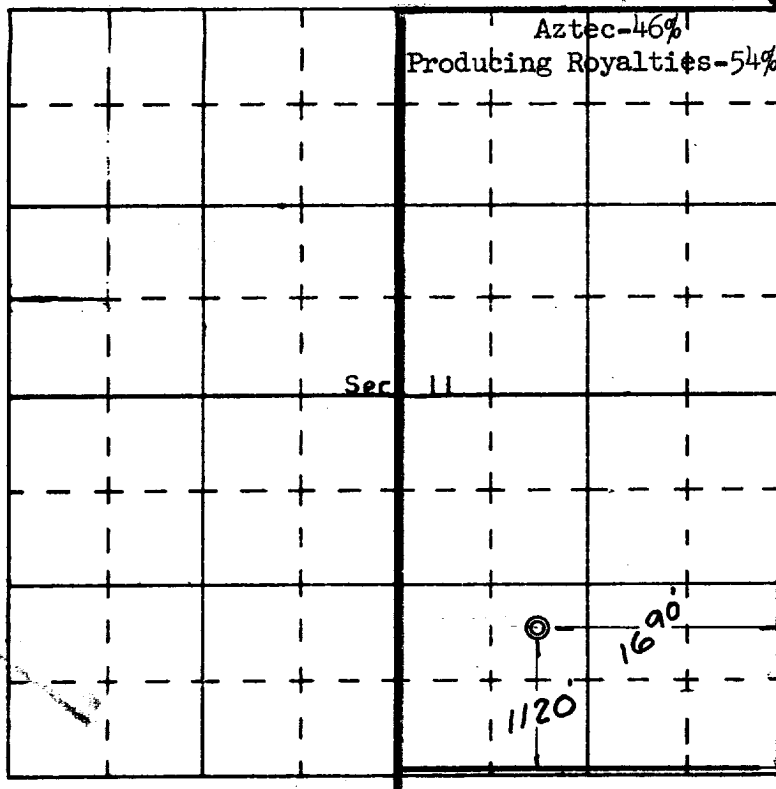
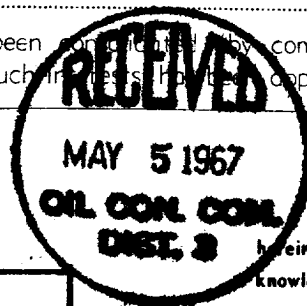

CERTIFICATION

I hereby certify that the information contained herein is true and complete to the best of my knowledge and belief.

ORIGINAL SIGNED BY JOE C. SALMON

Name **Joe C. Salmon**
 Position **District Superintendent**
 Company **Aztec Oil and Gas**
 Date **May 3, 1967**

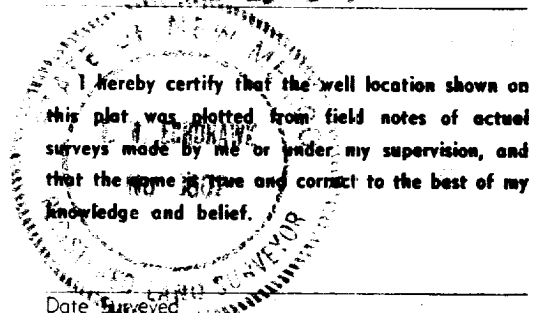

Date Surveyed **April 29, 1967**
 Registered Professional Engineer
 and/or Land Surveyor

E. J. [Signature]
 Certificate No. **3602**

