

UNITED STATES  
DEPARTMENT OF THE INTERIOR  
GEOLOGICAL SURVEY

## APPLICATION FOR PERMIT TO DRILL, DEEPEN, OR PLUG BACK

30-0445-20071

1a. TYPE OF WORK DRILL <input checked="" type="checkbox"/> DEEPEN <input type="checkbox"/> PLUG BACK <input type="checkbox"/>				5. LEASE DESIGNATION AND SERIAL NO. 14-20-0603-9591	
b. TYPE OF WELL OIL WELL <input checked="" type="checkbox"/> GAS WELL <input type="checkbox"/> OTHER <input type="checkbox"/>				6. IF INDIAN, ALLOTTEE OR TRIBE NAME Navajo Tribal	
2. NAME OF OPERATOR WALTER DUNCAN				7. UNIT AGREEMENT NAME	
3. ADDRESS OF OPERATOR Box 137, Durango, Colorado 81301				8. FARM OR LEASE NAME North Hogback 1	
4. LOCATION OF WELL (Report location clearly and in accordance with any State requirements.)* At surface 2466' South of North Line and 2310' At proposed prod. zone West of East Line, Sec. 1, T29N-R17W				9. WELL NO. 5	
14. DISTANCE IN MILES AND DIRECTION FROM NEAREST TOWN OR POST OFFICE* 6 miles east of Shiprock, New Mexico				10. FIELD AND POOL, OR WILDCAT Dakota - undesigned	
15. DISTANCE FROM PROPOSED* LOCATION TO NEAREST PROPERTY OR LEASE LINE, FT. (Also to nearest drlg. unit line, if any) 2310'		16. NO. OF ACRES IN LEASE 660		17. NO. OF ACRES ASSIGNED TO THIS WELL 40	
18. DISTANCE FROM PROPOSED LOCATION* TO NEAREST WELL, DRILLING, COMPLETED, OR APPLIED FOR, ON THIS LEASE, FT. #2 N. Hogback 1300' NW of		19. PROPOSED DEPTH 750		20. ROTARY OR CABLE TOOLS Cable tools to 30'; rotary to TD	
21. ELEVATIONS (Show whether DF, RT, GR, etc.) 4981 (ground)				22. APPROX. DATE WORK WILL START* 5-17-67	
23. PROPOSED CASING AND CEMENTING PROGRAM					
SIZE OF HOLE	SIZE OF CASING	WEIGHT PER FOOT	SETTING DEPTH	QUANTITY OF CEMENT	
	8-5/8		30'	10 sx	
	4-1/2		TD	75 sx	

Attached: Well Location and Acreage Dedication Plat

IN ABOVE SPACE DESCRIBE PROPOSED PROGRAM: If proposal is to deepen or plug back, give data on present productive zone and proposed new productive zone. If proposal is to drill or deepen directionally, give pertinent data on subsurface locations and measured and true vertical depths. Give blowout preventer program, if any.

24. SIGNED [Signature] XXXX for: Walter Duncan DATE May 15, 1967

(This space for Federal or State office use)

PERMIT NO. \_\_\_\_\_ APPROVAL DATE \_\_\_\_\_

APPROVED BY [Signature] TITLE \_\_\_\_\_

CONDITIONS OF APPROVAL, IF ANY:

\*See Instructions On Reverse Side

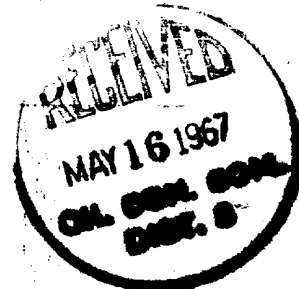

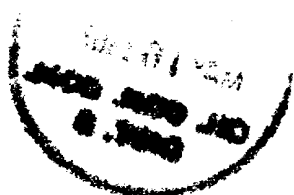

NEW MEXICO OIL CONSERVATION COMMISSION  
WELL LOCATION AND ACREAGE DEDICATION PLAT

Form C-102  
Supersedes C-128  
Effective 1-1-65

All distances must be from the outer boundaries of the Section.

Operator <b>Walter Duncan</b>			Lease <b>North Hogback</b>		Well No. <b>1-5</b>
Unit Letter <b>G</b>	Section <b>1</b>	Township <b>29 N</b>	Range <b>17 W</b>	County <b>San Juan</b>	
Actual Footage Location of Well: <b>2466</b> feet from the <b>North</b> line and <b>2310</b> feet from the <b>East</b> line					
Ground Level Elev. <b>4981</b>	Producing Formation <b>Dakota</b>		Pool <b>Undesignated</b>		Dedicated Acreage: <b>40</b> Acres

1. Outline the acreage dedicated to the subject well by colored pencil or hachure marks on the plat below.
2. If more than one lease is dedicated to the well, outline each and identify the ownership thereof (both as to working interest and royalty).
3. If more than one lease of different ownership is dedicated to the well, have the interests of all owners been consolidated by communitization, unitization, force-pooling, etc?

☐ Yes ☐ No If answer is "yes," type of consolidation \_\_\_\_\_

If answer is "no," list the owners and tract descriptions which have actually been consolidated. (Use reverse side of this form if necessary.) \_\_\_\_\_

No allowable will be assigned to the well until all interests have been consolidated (by communitization, unitization, forced-pooling, or otherwise) or until a non-standard unit, eliminating such interests, has been approved by the Commission.

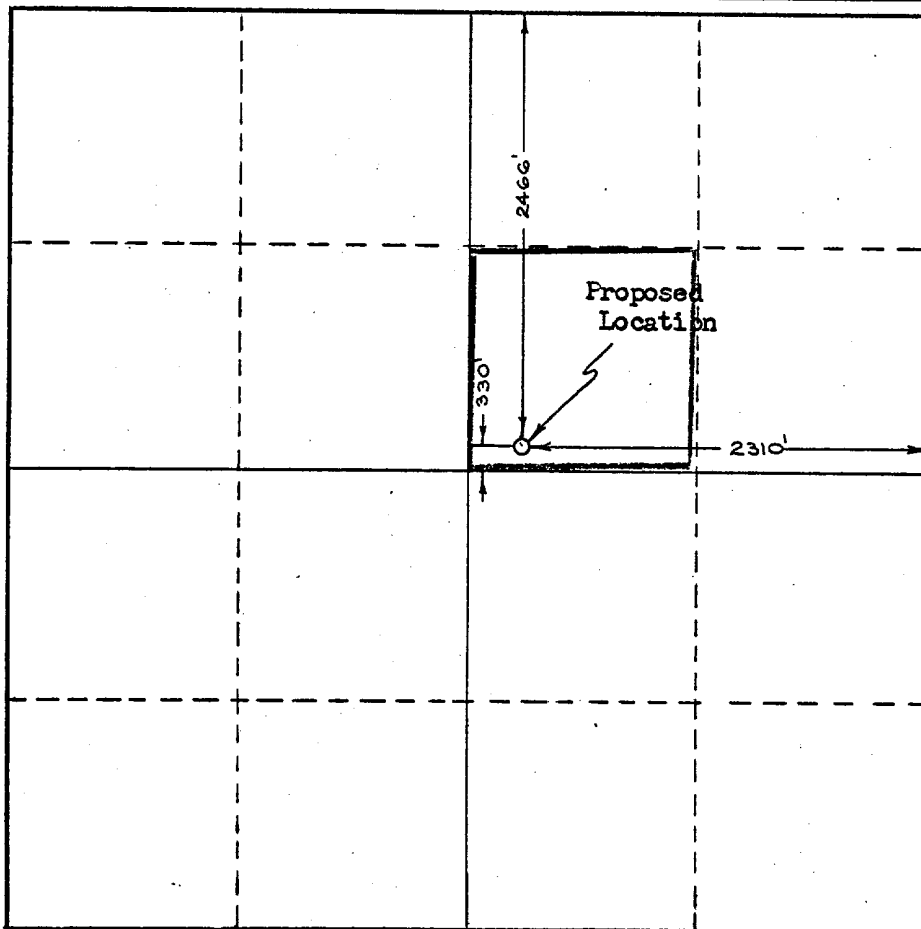

CERTIFICATION

I hereby certify that the information contained herein is true and complete to the best of my knowledge and belief.

*Raymond T. Duncan*

Name  
**Raymond T. Duncan, for**

Position  
**WALTER DUNCAN**

Company  
**Box 137, Durango, Colo.**

Date  
**May 15, 1967**

I hereby certify that the well location shown on this plat was plotted from field notes of actual surveys made by me or under my supervision, and that the same is true and correct to the best of my knowledge and belief.

Date Surveyed  
**May 11, 1967**

Registered Professional Engineer  
and/or Land Surveyor

*Richard H. Reed*

Certificate No.  
**N. M. # 3795**

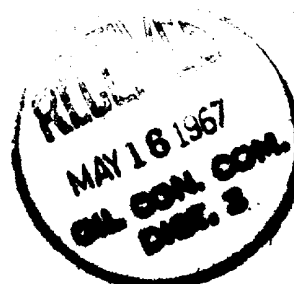
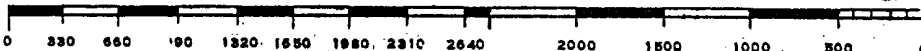

OFFICE OF THE  
ATTORNEY GENERAL

