

UNITED STATES
DEPARTMENT OF THE INTERIOR
GEOLOGICAL SURVEY

APPLICATION FOR PERMIT TO DRILL, DEEPEN, OR PLUG BACK

1a. TYPE OF WORK

DRILL ☒DEEPEN ☒ PLUG BACK ☐

b. TYPE OF WELL

OIL
WELL ☒GAS
WELL ☐OTHER ☐SINGLE
ZONE ☒MULTIPLE
ZONE ☐

2. NAME OF OPERATOR

PAN AMERICAN PETROLEUM CORPORATION

3. ADDRESS OF OPERATOR

301 Airport Drive, Farmington, New Mexico 87401

U. S. GEOLOGICAL SURVEY

4. LOCATION OF WELL (Report location clearly and in accordance with any State requirements.)

At surface

990' FNL and 2310' FNL

At proposed prod. zone

14. DISTANCE IN MILES AND DIRECTION FROM NEAREST TOWN OR POST OFFICE*

9 miles southeast of Shiprock, New Mexico

15. DISTANCE FROM PROPOSED*

LOCATION TO NEAREST
PROPERTY OR LEASE LINE, FT.
(Also to nearest drlg. unit line, if any)

990'

18. NO. OF ACRES IN LEASE

4160

18. DISTANCE FROM PROPOSED*

TO NEAREST WELL, DRILLING, COMPLETED,
OR APPLIED FOR, ON THIS LEASE, FT.

660'

19. PROPOSED DEPTH

990'

17. NO. OF ACRES ASSIGNED
TO THIS WELL

40 (joint)

21. ELEVATIONS (Show whether DF, RT, GR, etc.)

Will report later

22. APPROX. DATE WORK WILL START*

September 30, 1967

23. PROPOSED CASING AND CEMENTING PROGRAM

SIZE OF HOLE	SIZE OF CASING	WEIGHT PER FOOT	SETTING DEPTH	QUANTITY OF CEMENT
9-5/8	7"	200	60'	To surface
6-1/8	4-1/2"	10.50	990'	75 sacks

Operator plans to set 4-1/2" casing at top of Morrison, perforate and test lower and upper Dakota. Sand interval may be stimulated by sand-oil-fracture treatment if limited flow capacity indicated.

Copies of Location Plat attached.

Copies of logs will be furnished upon completion of well.

This well in accordance with NMCC Order No. R-3196 and will share allocable jointly with other wells on same 40-acre tract.

IN ABOVE SPACE DESCRIBE PROPOSED PROGRAM: If proposal is to deepen or plug back, give data on present productive zone and proposed new productive zone. If proposal is to drill or deepen directionally, give pertinent data on subsurface locations and measured and true vertical depths. Give blowout preventer program, if any.

24. Original Signed By
SIGNED G. W. EATON, JR. TITLE Area Engineer DATE August 24, 1967
G. W. Eaton, Jr.
(This space for Federal or State office use)

PERMIT NO. _____

APPROVAL DATE _____

APPROVED BY _____

TITLE _____

DATE _____

CONDITIONS OF APPROVAL, IF ANY:

NEW MEXICO OIL CONSERVATION COMMISSION

WELL LOCATION AND ACERAGE DEDICATION PLAT

All distances must be from the outer boundaries of the Section

Operator Pan American Petroleum Corporation			Lease U.S.G. Section 19		Well No. 23
Unit Letter B	Section 19	Township 29 North	Range 16 West	County San Juan	
Actual Footage Location of Well: 990 feet from the North line and 2310 feet from the East line					
Ground Level Elev. Report Later	Producing Formation Dakota		Pool Hogback Dakota	Dedicated Acreage: Joint 40 Acres	

1. Outline the acreage dedicated to the subject well by colored pencil or hachure marks on the plat below.

2. If more than one lease is dedicated to the well, outline each and identify the ownership thereof (both as to working interest and royalty),

3. If more than one lease of different ownership is dedicated to the well, have the interests of all owners been consolidated by communitization, unitization, force-pooling, etc?

() Yes () No If answer is "yes," type of consolidation

If answer is "no," list the owners and tract descriptions which have actually consolidated. (Use reverse side of this form if necessary.)

No allowable will be assigned to the well until all interests have been consolidated (by communitization, unitization, forced-pooling, or otherwise) or until a non standard unit, eliminating such interests, has been approved by the Commission.

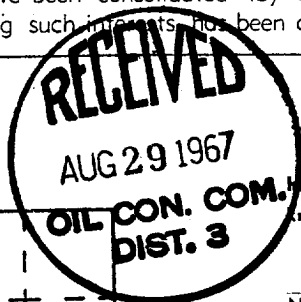

CERTIFICATION

I hereby certify that the information contained herein is true and complete to the best of my knowledge and belief.

Name

G. W. Eaton, Jr.
G. W. Eaton, Jr.

Position

Area Engineer

Company

PAN AMERICAN PETROLEUM CORP.

Date

August 24, 1967

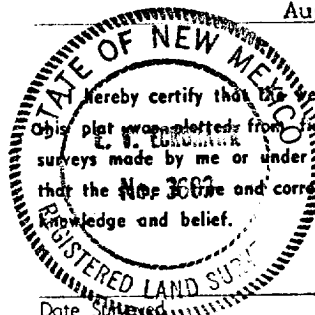

Date

June 21, 1967

Registered Professional Engineer
and/or Land Surveyor

E. J. Cochran
Certificate No. 3602

