

UNITED STATES  
DEPARTMENT OF THE INTERIOR  
GEOLOGICAL SURVEY

APPLICATION FOR PERMIT TO DRILL, DEEPEN, OR PLUG BACK

1a. TYPE OF WORK DRILL <input checked="" type="checkbox"/> DEEPEN <input type="checkbox"/> PLUG BACK <input type="checkbox"/>		5. LEASE DESIGNATION AND SERIAL NO. <b>1-89-KMB-50</b>		
b. TYPE OF WELL OIL WELL <input checked="" type="checkbox"/> GAS WELL <input type="checkbox"/> OTHER <input type="checkbox"/> SINGLE ZONE <input checked="" type="checkbox"/> MULTIPLE ZONE <input type="checkbox"/>		6. IF INDIAN, ALLOTTEE OR TRIBE NAME <b>Navajo Tribal</b>		
2. NAME OF OPERATOR <b>PAN AMERICAN PETROLEUM CORPORATION</b>		7. UNIT AGREEMENT NAME		
3. ADDRESS OF OPERATOR <b>501 Airport Drive, Farmington, New Mexico</b>		8. FARM OR LEASE NAME <b>U.S.D. Section 18</b>		
4. LOCATION OF WELL (Report location clearly and in accordance with any State requirements.)* At surface <b>165' FWL and 2475' FWL</b>  At proposed prod. zone <b>Same</b>		9. WELL NO. <b>27</b>		
14. DISTANCE IN MILES AND DIRECTION FROM NEAREST TOWN OR POST OFFICE* <b>9 miles southeast of Shiprock, New Mexico</b>		10. FIELD AND POOL, OR WILDCAT <b>Hogback Dakota</b>		
15. DISTANCE FROM PROPOSED* LOCATION TO NEAREST PROPERTY OR LEASE LINE, FT. (Also to nearest drlg. unit line, if any) <b>2475'</b>		11. SEC., T., R., M., OR BLK. AND SURVEY OR AREA <b>Section 18, T-29-N, R-16-W</b>		
18. DISTANCE FROM PROPOSED LOCATION* TO NEAREST WELL, DRILLING, COMPLETED, OR APPLIED FOR, ON THIS LEASE, FT. <b>330'</b>		12. COUNTY OR PARISH      13. STATE <b>San Juan      New Mexico</b>		
16. NO. OF ACRES IN LEASE <b>4160</b>		17. NO. OF ACRES ASSIGNED TO THIS WELL <b>40 (Joint)</b>		
19. PROPOSED DEPTH <b>660'</b>		20. ROTARY OR CABLE TOOLS <b>Rotary</b>		
21. ELEVATIONS (Show whether DF, RT, GR, etc.) <b>Will report later</b>		22. APPROX. DATE WORK WILL START* <b>October 25, 1967</b>		
23. PROPOSED CASING AND CEMENTING PROGRAM				
SIZE OF HOLE	SIZE OF CASING	WEIGHT PER FOOT	SETTING DEPTH	QUANTITY OF CEMENT
<b>8-3/4"</b>	<b>7"</b>	<b>200</b>	<b>40'</b>	<b>To surface</b>
<b>4-1/2"</b>	<b>4-1/2"</b>	<b>10.50</b>	<b>660'</b>	<b>65 sacks</b>

Operator plans to set 4-1/2" casing at top of Dakota, drill one to two feet into Dakota pay sand, and complete in open hole.

Copies of Location Plat attached.

Copies of logs, if run, will be furnished upon completion of well.

This well in accordance with MDOC Order No. R-3296 and will share allowable jointly with other well in same 40-acre tract.

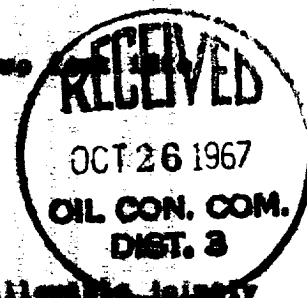

IN ABOVE SPACE DESCRIBE PROPOSED PROGRAM: If proposal is to deepen or plug back, give data on present productive zone and proposed new productive zone. If proposal is to drill or deepen directionally, give pertinent data on subsurface locations and measured and true vertical depths. Give blowout preventer program, if any.

24. Original Signed By: G. W. EATON, JR. TITLE: Area Engineer DATE: October 24, 1967  
 SIGNED: G. W. Eaton, Jr.  
 (This space for Federal or State office use)

PERMIT NO. \_\_\_\_\_ APPROVAL DATE \_\_\_\_\_  
 APPROVED BY: [Signature] TITLE: \_\_\_\_\_  
 CONDITIONS OF APPROVAL, IF ANY:

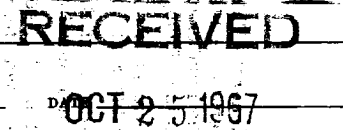

U. S. GEOLOGICAL SURVEY  
FARMINGTON, N. M.

# NEW MEXICO OIL CONSERVATION COMMISSION

## WELL LOCATION AND ACERAGE DEDICATION PLAT

All distances must be from the outer boundaries of the Section

Operator <b>Pan American Petroleum Corporation</b>			Lease <b>U.S.G. Section 18</b>		Well No. <b>27</b>
Unit Letter <b>N</b>	Section <b>18</b>	Township <b>29 North</b>	Range <b>16 West</b>	County <b>San Juan</b>	
Actual Footage Location of Well: <b>165</b> feet from the <b>South</b> line and <b>2475</b> feet from the <b>West</b> line					
Ground Level Elev. <b>Report Later</b>	Producing Formation <b>Dakota</b>		Pool <b>Hogback Dakota</b>	Dedicated Acreage: <b>40 (Joint)</b> Acres	

1. Outline the acreage dedicated to the subject well by colored pencil or hachure marks on the plat below.

2. If more than one lease is dedicated to the well, outline each and identify the ownership thereof (both as to working interest and royalty),

3. If more than one lease of different ownership is dedicated to the well, have the interests of all owners been consolidated by communitization, unitization, force-pooling, etc?

( ) Yes ( ) No If answer is "yes," type of consolidation .....

If answer is "no," list the owners and tract descriptions which have actually consolidated. (Use reverse side of this form if necessary.) .....

No allowable will be assigned to the well until all interests have been consolidated (by communitization, unitization, forced-pooling, or otherwise) or until a non standard unit, eliminating such interests, has been approved by the Commission.

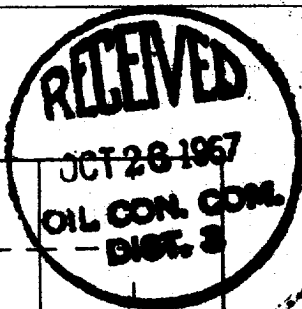
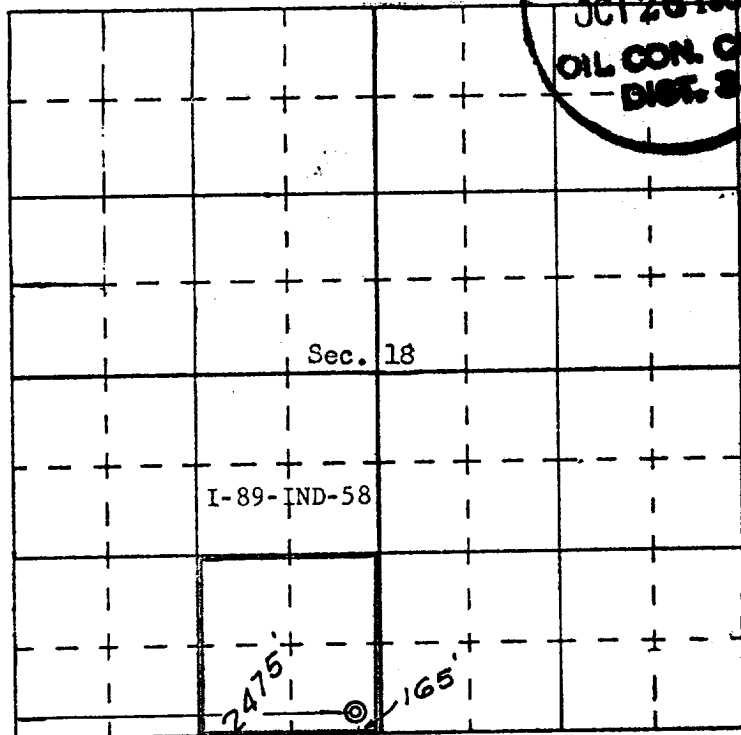

### CERTIFICATION

I hereby certify that the information contained herein is true and complete to the best of my knowledge and belief.

Name G. W. Eaton, Jr.

Position Area Engineer

Company PAN AMERICAN PETROLEUM CORP.

Date October 23, 1967

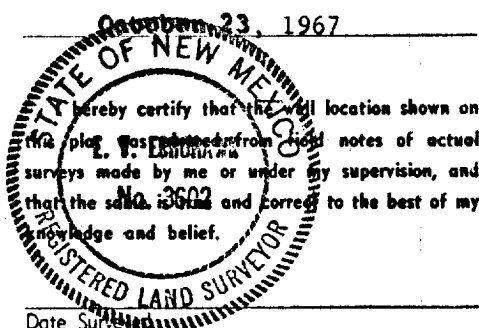

Date Surveyed June 23, 1967

Registered Professional Engineer

and/or Land Surveyor

E. V. Cepolawski  
Certificate No. 3602