

CONFIDENTIAL
 UNITED STATES
 DEPARTMENT OF THE INTERIOR
 GEOLOGICAL SURVEY

SUBMIT IN TRIPLICATE*
 (Other instructions on reverse side)

Form approved.
 Budget Bureau No. 42-R14:5.

30-~~845~~ 20232

APPLICATION FOR PERMIT TO DRILL, DEEPEN, OR PLUG BACK

1a. TYPE OF WORK
 DRILL DEEPEN PLUG BACK

b. TYPE OF WELL
 OIL WELL GAS WELL OTHER **Wildcat** SINGLE ZONE MULTIPLE ZONE

2. NAME OF OPERATOR
TEXACO INC.

3. ADDRESS OF OPERATOR
P. O. Box 810, Farmington, New Mexico 87401

4. LOCATION OF WELL (Report location clearly and in accordance with any State requirements.)*
 At surface
1980' from north line and 1920' from east line
 At proposed prod. zone
same

14. DISTANCE IN MILES AND DIRECTION FROM NEAREST TOWN OR POST OFFICE*
Approximately six miles south of Fruitland

10. FIELD AND POOL, OR WILDCAT
Wildcat

11. SEC., T., R., M., OR BLK. AND SURVEY OR AREA
34, T29N, R15W, N.M.P.M.

12. COUNTY OR PARISH 13. STATE
San Juan N.M.

16. NO. OF ACRES IN LEASE
640

17. NO. OF ACRES ASSIGNED TO THIS WELL
40

18. DISTANCE FROM PROPOSED LOCATION* TO NEAREST WELL, DRILLING, COMPLETED, OR APPLIED FOR, ON THIS LEASE, FT.
none

19. PROPOSED DEPTH
4850

20. ROTARY OR CABLE TOOLS
rotary

21. ELEVATIONS (Show whether DF, RT, GR, etc.)
208' GR

22. APPROX. DATE WORK WILL START*
3/6/68

23. PROPOSED CASING AND CEMENTING PROGRAM

SIZE OF HOLE	SIZE OF CASING	WEIGHT PER FOOT	SETTING DEPTH	QUANTITY OF CEMENT
12 1/4"	8 5/8"	24#	300'	circulate
7 7/8"	--	--	--	--

FORMATION TOPS AS EXPECTED

PICTURED CLIFFS 500'
 MESA VERDE 1400'
 POINT LOOKOUT 3100'
 NIOBRABA 4340'

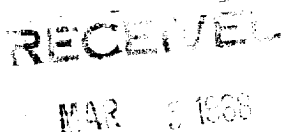

U. S. GEOLOGICAL SURVEY
 FARMINGTON, N. M.

IN ABOVE SPACE DESCRIBE PROPOSED PROGRAM: If proposal is to deepen or plug back, give data on present productive zone and proposed new productive zone. If proposal is to drill or deepen directionally, give pertinent data on subsurface locations and measured and true vertical depths. Give blowout preventer program, if any.

24. SIGNED [Signature] TITLE District Superintendent DATE 3/5/68

(This space for Federal or State office use)

PERMIT NO. _____ APPROVAL DATE _____

APPROVED BY _____ TITLE _____ DATE _____

CONDITIONS OF APPROVAL, IF ANY:

Callal

CONFIDENTIAL

NEW MEXICO OIL CONSERVATION COMMISSION
WELL LOCATION AND ACREAGE DEDICATION PLAT

Form C-102
Supersedes C- 28
Effective 1-1-65

All distances must be from the outer boundaries of the Section.

Operator TEXACO INC.		Lease Navajo Tribe "B3"		Well No. 1
Unit Letter G	Section 34	Township 29 N	Range N 15	County San Juan
Actual Footage Location of Well: 1980 feet from the North line and 1920 feet from the East line				
Ground Level Elev: 5408	Producing Formation K	Pool Wildcat	Dedicated Acreage: 40 Acres	

- Outline the acreage dedicated to the subject well by colored pencil or hachure marks on the plat below.
- If more than one lease is dedicated to the well, outline each and identify the ownership thereof (both as to working interest and royalty).
- If more than one lease of different ownership is dedicated to the well, have the interests in all leases been consolidated by communitization, unitization, force-pooling, etc?

Yes No If answer is "yes," type of consolidation _____

If answer is "no," list the owners and tract descriptions which have actually been consolidated (Use reverse side of this form if necessary.) _____

No allowable will be assigned to the well until all interests have been consolidated (by communitization, unitization, forced-pooling, or otherwise) or until a non-standard unit, eliminating such interests, has been approved by the Commission.

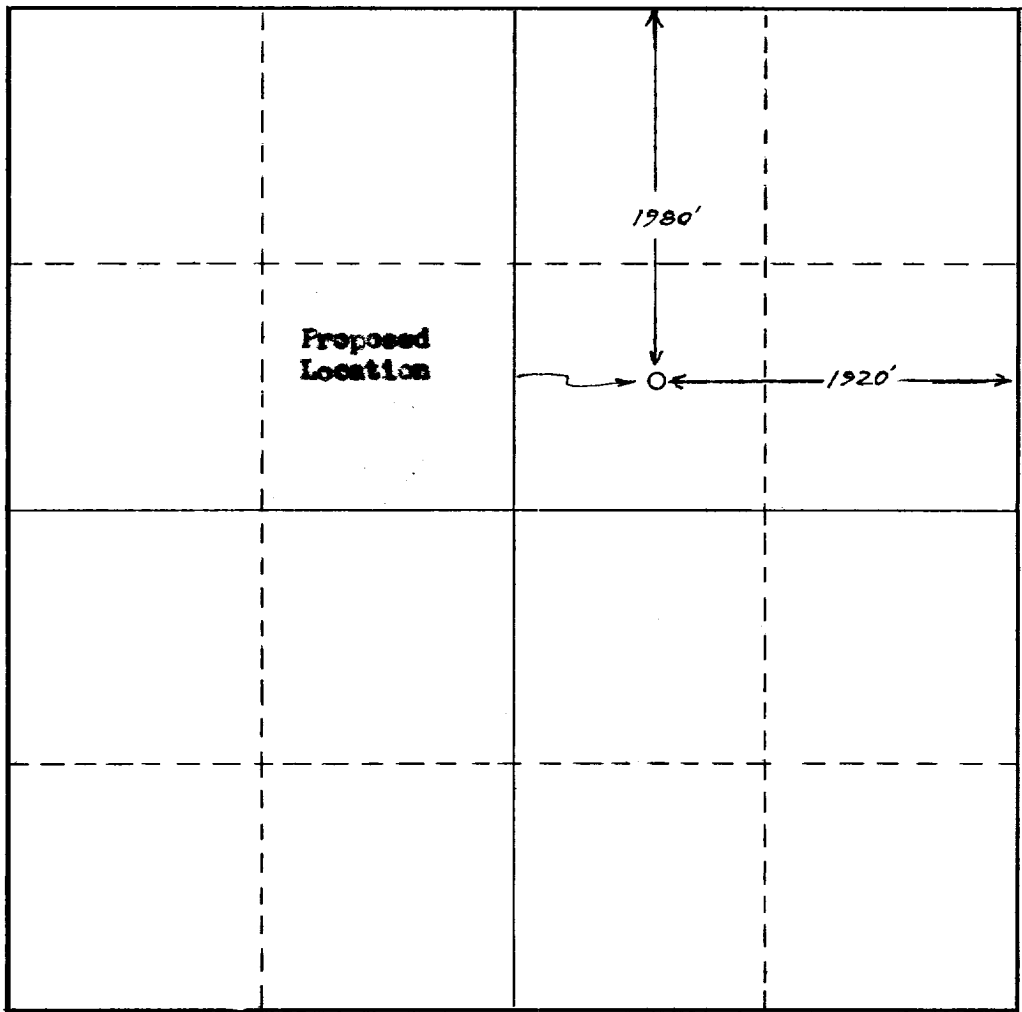

CERTIFICATION

I hereby certify that the information contained herein is true and complete to the best of my knowledge and belief.

O. B. Farmer
Name

Position
District Superintendent

Company
TEXACO INC.

Date
3/5/68

I hereby certify that the well location shown on this plat was plotted from field notes of actual surveys made by me or under my supervision, and that the same is true and correct to the best of my knowledge and belief.

Date Surveyed
2-14-68

Registered Professional Engineer and/or Land Surveyor

Fredrick H. Reed

Certificate No.
7. 9. 3795

