

NO. OF COPIES RECEIVED	5
DISTRIBUTION	
SANTA FE	/
FILE	/
U.S.G.S.	/
LAND OFFICE	/
OPERATOR	/

NEW MEXICO OIL CONSERVATION COMMISSION

Form C-101
Revised 1-1-65 30-44-20268

5A. Indicate Type of Lease	
STATE <input checked="" type="checkbox"/>	FEE <input type="checkbox"/>
5. State Oil & Gas Lease No. E - 2940*	

APPLICATION FOR PERMIT TO DRILL, DEEPEN, OR PLUG BACK

1a. Type of Work		7. Unit Agreement Name	
b. Type of Well DRILL <input checked="" type="checkbox"/> DEEPEN <input type="checkbox"/> PLUG BACK <input type="checkbox"/> OIL WELL <input type="checkbox"/> GAS WELL <input checked="" type="checkbox"/> OTHER <input type="checkbox"/> SINGLE ZONE <input checked="" type="checkbox"/> MULTIPLE ZONE <input type="checkbox"/>		8. Farm or Lease Name State E Gas Comm	
2. Name of Operator Atlantic Richfield Company		9. Well No. 1	
3. Address of Operator Box 2197 Farmington, New Mexico		10. Field and Pool, or Wildcat Basin Dakota	
4. Location of Well UNIT LETTER 0 LOCATED 820 FEET FROM THE South LINE AND 1800 FEET FROM THE East LINE OF SEC. 16 TWP. 29N RGE. 10W NMPM		12. County San Juan	
19. Proposed Depth 6800'		19A. Formation Dakota	
20. Rotary or C.T. Rotary		21. Elevations (Show whether DF, RT, etc.) G R 5589'	
21A. Kind & Status Plug. Bond Blanket		21B. Drilling Contractor Not Known	
22. Approx. Date Work will start			

PROPOSED CASING AND CEMENT PROGRAM

SIZE OF HOLE	SIZE OF CASING	WEIGHT PER FOOT	SETTING DEPTH	SACKS OF CEMENT	EST. TOP
15"	10 3/4 "	32.75#	300'	250	Circulate
7 7/8 "	4 1/2 "	10.5#	6800'	1600 Cubic ft.	Cement to cover Mesaverde and from top lewis shale to surface.

* See attached plat & below:

We propose to drill this well to test the Dakota Formation. A stage cementing tool will be used to cement from top of lewis shale to surface. Producing Zone will be perforated thru 4 1/2 " casing. A sand water fracture will probably be necessary to stimulate the producing zone.

* All Royalty: State of New Mexico 12.5%

E - 6515: W.I. 100% Atlantic Richfield Company

E - 3146-2: W.I. 100% Sunray DX Oil Company

E - 1908-2: W.I. 100% W.H. Gilmore

B - 11303-7: W.I. 100% Texas Pacific Oil Company, a division of Joseph E. Seagram & Sons, Inc.

E - 2940: W.I. 100% Pan American Petroleum Corporation

E - 2661-3: W.I. 100% Tenneco Oil Company and Continental Oil Company

APPROVAL VALID
FOR 90 DAYS UNLESS
DRILLING COMMENCED,

EXPIRES July 30, 1968

IN ABOVE SPACE DESCRIBE PROPOSED PROGRAM: IF PROPOSAL IS TO DEEPEN OR PLUG BACK, GIVE DATA ON PRESENT PRODUCTIVE ZONE AND PROPOSED NEW PRODUCTIVE ZONE. GIVE BLOWOUT PREVENTER PROGRAM, IF ANY.

I hereby certify that the information above is true and complete to the best of my knowledge and belief.

Signed B. J. Sartin Title Dir. & Prod. Supv. Date 4/30/68

(This space for State Use)

APPROVED BY Emmy Church TITLE Sup Dist TIB DATE 5-1-68
CONDITIONS OF APPROVAL IF ANY:

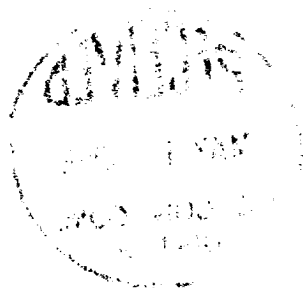

NEW MEXICO OIL CONSERVATION COMMISSION
WELL LOCATION AND ACERAGE DEDICATION PLAT



All distances must be from the outer boundaries of the Section

Operator ATLANTIC RICHFIELD COMPANY			Lease State "E" Gas Comm.			Well No. 1
Unit Letter 0	Section 16	Township 29 N RT.	Range 10 WEST	County SAN JUAN		
Actual Footage Location of Well: 820 feet from the SOUTH line and 1800 feet from the EAST line						
Ground Level Elev. 5589.0	Producing Formation Dakota	Pool Basin Dakota	Dedicated Acreage 313.76 Acres			

- Outline the acreage dedicated to the subject well by colored pencil or hatchure marks on the plat below.
- If more than one lease is dedicated to the well, outline each and identify the ownership thereof (both as to working interest and royalty), **See form C - 101 Attached**
- If more than one lease of different ownership is dedicated to the well, have the interests of all owners been consolidated by communitization, unitization, force-pooling, etc?

☒ Yes () No If answer is "yes," type of consolidation **Communitization**

If answer is "no," list the owners and tract descriptions which have actually consolidated. (Use reverse side of this form if necessary.)

No allowable will be assigned to the well until all interests have been consolidated (by communitization, unitization, forced-pooling, or otherwise) or until a non standard unit, eliminating such interests, has been approved by the Commission.

CERTIFICATION

I hereby certify that the information contained herein is true and complete to the best of my knowledge and belief.

Name B. J. Sartain
Position Drilling & Production Supv.
Company Atlantic Richfield Co.
Date April 30, 1968

I hereby certify that the well location shown on this plat was plotted from field notes of actual surveys made by me or under my supervision, and that the same is true and correct to the best of my knowledge and belief.

Date Surveyed October 10, 1967
Registered Professional Engineer and/or Land Surveyor
JAMES P. LEESE

1463
Certificate No.

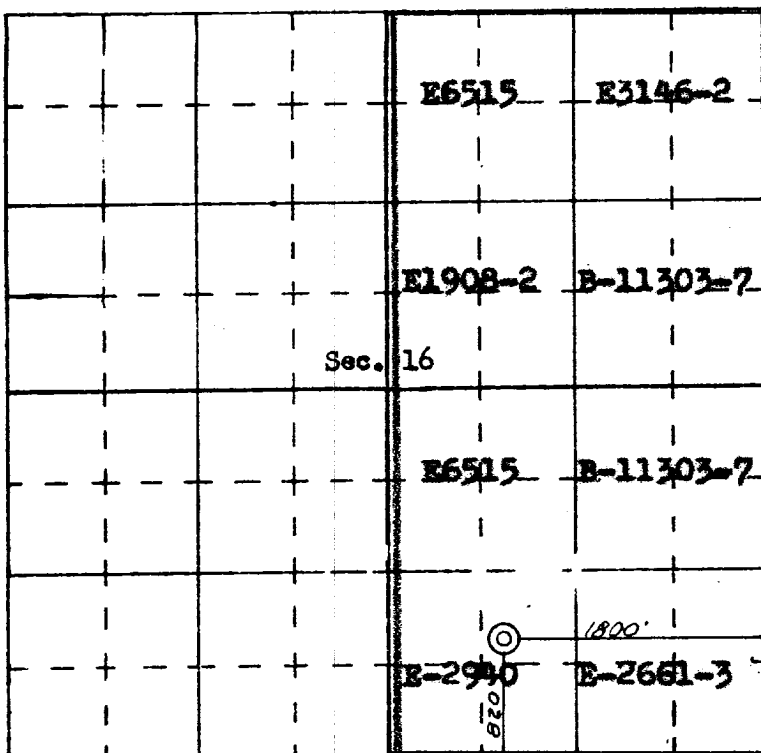

SCALE—4 INCHES EQUALS 1 MILE

SAN JUAN ENGINEERING COMPANY, FARMINGTON, N. M.