

K

Nº. OF COPIES RECEIVED	5
DISTRIBUTION	
SANTA FE	1
FILE	1
U.S.G.S.	2
LAND OFFICE	
OPERATOR	1

NEW MEXICO OIL CONSERVATION COMMISSION

Form C-101  
Revised 1-1-65 30-045-20285

5A. Indicate Type of Lease
STATE <input type="checkbox"/> FEE <input checked="" type="checkbox"/>
5. State Oil & Gas Lease No.

APPLICATION FOR PERMIT TO DRILL, DEEPEN, OR PLUG BACK

1a. Type of Work	DRILL <input checked="" type="checkbox"/> DEEPEN <input type="checkbox"/> PLUG BACK <input type="checkbox"/>	7. Unit Agreement Name	Callegos Canyon Unit
b. Type of Well	OIL WELL <input type="checkbox"/> GAS WELL <input checked="" type="checkbox"/> OTHER <input type="checkbox"/> SINGLE ZONE <input checked="" type="checkbox"/> MULTIPLE ZONE <input type="checkbox"/>	8. Farm or Lease Name	
2. Name of Operator	PAN AMERICAN PETROLEUM CORPORATION	9. Well No.	262
3. Address of Operator	501 Airport Drive, Farmington, New Mexico 87401	10. Field and Pool, or Wildcat	Basin Dakota
4. Location of Well	UNIT LETTER <b>H</b> LOCATED <b>1450</b> FEET FROM THE <b>West</b> LINE AND <b>1040</b> FEET FROM THE <b>South</b> LINE OF SEC. <b>24</b> TWP. <b>29-N</b> RGE. <b>13-W</b> NMPM	12. County	San Juan
19. Proposed Depth		19A. Formation	20. Rotary or C.T.
5860'		Dakota	Rotary
21. Elevations (Show whether DF, RT, etc.)	21A. Kind & Status Plug. Bond	21B. Drilling Contractor	22. Approx. Date Work will start
Will report later	Statewide	Loffland	May 23, 1968

23.

PROPOSED CASING AND CEMENT PROGRAM

SIZE OF HOLE	SIZE OF CASING	WEIGHT PER FOOT	SETTING DEPTH	SACKS OF CEMENT	EST. TOP
12-1/4"	8-5/8"	24#	500'	300	Surface
7-7/8"	4-1/2"	10.5#	5860'	1500	Surface

Completion will be determined upon reaching total depth.

Copies of Location Plat are attached.

Copies of all logs run will be furnished upon completion of well.

APPROVAL VALID  
FOR 90 DAYS UNLESS  
DRILLING COMMENCED,

EXPIRES Aug. 21, 1968



IN ABOVE SPACE DESCRIBE PROPOSED PROGRAM: IF PROPOSAL IS TO DEEPEN OR PLUG BACK, GIVE DATA ON PRESENT PRODUCTION ZONE AND PROPOSED NEW PRODUCTION ZONE. GIVE BLOWOUT PREVENTER PROGRAM, IF ANY.

I hereby certify that the information above is true and complete to the best of my knowledge and belief.

G. W. Eaton, ORIGINAL SIGNED BY

Signed G. W. Eaton, Jr. Title Area Engineer Date May 22, 1968

(This space for State Use)

APPROVED BY *Emory C. ...* TITLE *Supt. Dist. III* DATE 5-23-68

CONDITIONS OF APPROVAL, IF ANY:

# NEW MEXICO OIL CONSERVATION COMMISSION

## WELL LOCATION AND ACERAGE DEDICATION PLAT

All distances must be from the outer boundaries of the Section

Operator <b>PAN AMERICAN PETROLEUM CORPORATION</b>		Lease <b>GALLEGOS CANYON UNIT</b>		Well No. <b>262</b>
Unit Letter <b>N</b>	Section <b>24</b>	Township <b>29 NORTH</b>	Range <b>13 WEST</b>	County <b>SAN JUAN</b>
Actual Footage Location of Well: <b>1040</b> feet from the <b>SOUTH</b> line and <b>1450</b> feet from the <b>WEST</b> line				
Ground Level Elev.	Producing Formation <b>Dakota</b>	Pool <b>Basin Dakota</b>	Dedicated Acreage: <b>320</b> Acres	
Report Later				

1. Outline the acreage dedicated to the subject well by colored pencil or hachure marks on the plat below.
2. If more than one lease is dedicated to the well, outline each and identify the ownership thereof (both as to working interest and royalty),
3. If more than one lease of different ownership is dedicated to the well, have the interests of all owners been consolidated by communitization, unitization, force-pooling, etc?

( ) Yes ( ) No If answer is "yes," type of consolidation .....

If answer is "no," list the owners and tract descriptions which have actually consolidated. (Use reverse side of this form if necessary.) .....

No allowable will be assigned to the well until all interests have been consolidated (by communitization, unitization, forced-pooling, or otherwise) or until a non standard unit, eliminating such interests, has been approved by the Commission.

### CERTIFICATION

I hereby certify that the information contained herein is true and complete to the best of my knowledge and belief.

*G. W. Eaton, Jr.*  
 Name  
**G. W. Eaton, Jr.**  
 Position  
**Area Engineer**  
 Company  
**PAN AMERICAN PETROLEUM CORP.**  
 Date  
**May 22, 1968**

I hereby certify that the well location shown on this plat was plotted from field notes of actual surveys made by me or under my supervision, and that the same is true and correct to the best of my knowledge and belief.

**9 May, 1968**  
 Date Surveyed  
*James P. Leese*  
 Registered Professional Engineer  
 and/or Land Surveyor  
**JAMES P. LEESE**  
**1463**  
 Certificate No.

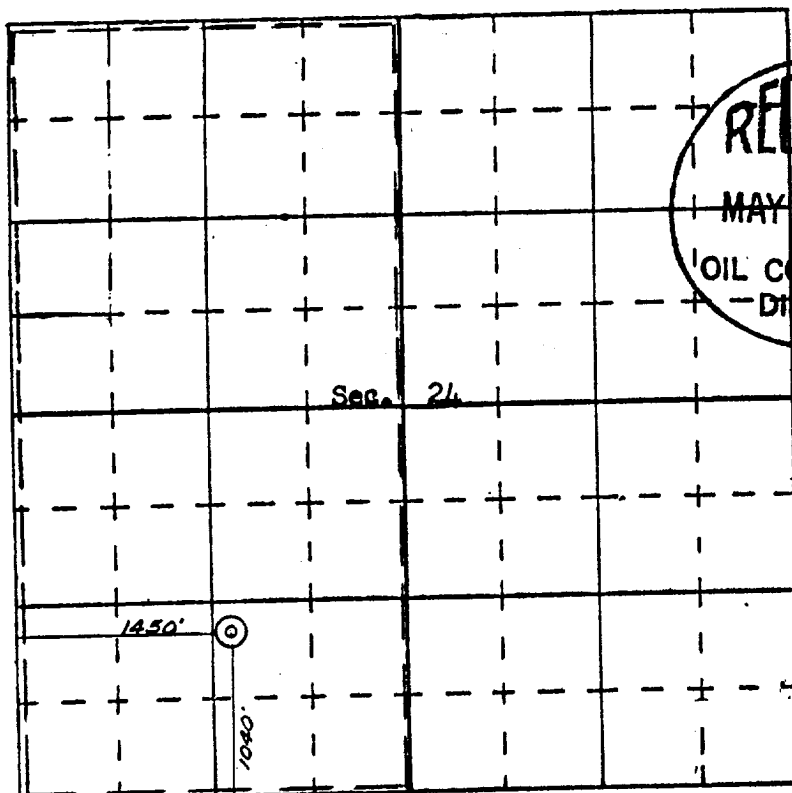

SCALE—4 INCHES EQUALS 1 MILE

SAN JUAN ENGINEERING COMPANY, FARMINGTON, N. M.