

**All distances must be from the outer boundaries of the Section**

No allowable will be assigned to the well until all interests have been consolidated (by communitization, unitization, forced-pooling, or otherwise) or until a non standard unit, eliminating such interests, has been approved by the Commission.

AUG 20 1969

U. S. GEOLOGICAL SURVEY  
FARMINGTON, N. M.

## CERTIFICATION

I hereby certify that the information contained herein is true and complete to the best of my knowledge and belief.

Name W. F. Shumaker  
Position Production Supt.  
Company Shiprock Corporation  
Date 8-19-69

I hereby certify that the well location shown on this plat was plotted from field notes of actual surveys made by me or under my supervision, and that the same is true and correct to the best of my knowledge and belief.

4 August 1969 ALC  
Date Surveyed \_\_\_\_\_  
\_\_\_\_\_  
Registered Professional Engineer  
and/or Land Surveyor

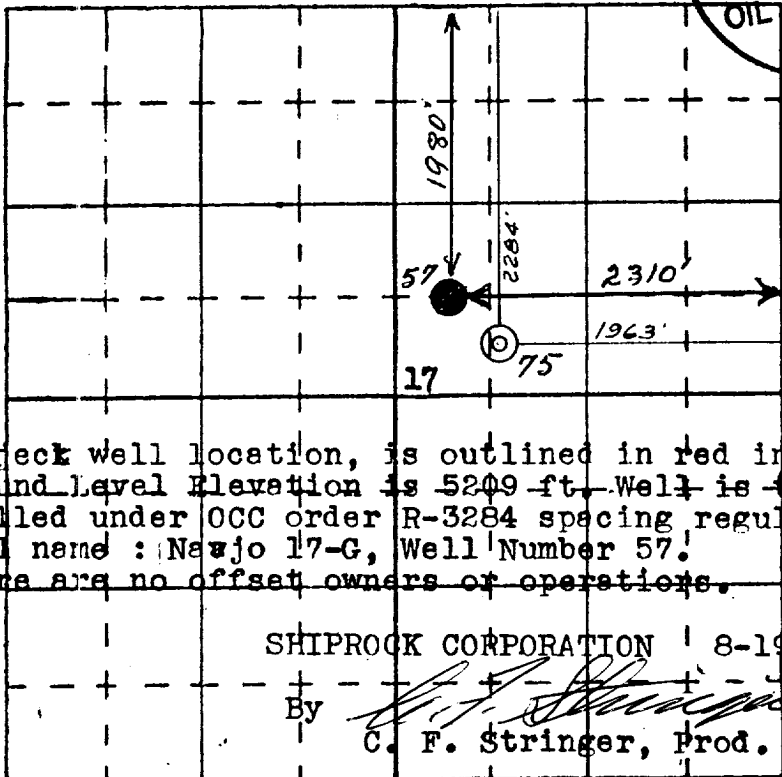

Subject well location, is outlined in red ink below.  
Ground Level Elevation is 5209 ft. Well is to be  
drilled under OCC order R-3284 spacing regulations.  
Well name : Newjo 17-G, Well Number 57.  
There are no offset owners or operators.

SHIPROCK CORPORATION 1 8-19-69

By C. F. Stringer  
C. F. Stringer, Prod. Supt.

**SCALE—4 INCHES EQUALS 1 MILE**

**SAN JUAN ENGINEERING COMPANY, FARMINGTON, N. M.**

Certificate No. 1463