

NO. OF COPIES RECEIVED	0
DISTRIBUTION	
SANTA FE	1
FILE	1
U.S.G.S.	2
LAND OFFICE	1
OPERATOR	1

NEW MEXICO OIL CONSERVATION COMMISSION

Form C-101

Revised 1-1-65

30-045-26285

5A. Indicate Type of Lease

STATE ☐

FEE ☒

5. State Oil & Gas Lease No.

7. Unit Agreement Name

8. Farm or Lease Name

Irvin Com

9. Well No.

1

10. Field and Pool, or Wildcat

Basin Dakota

12. County

San Juan

19. Proposed Depth

6075

19A. Formation

Dakota

20. Rotary or C.T.

Rotary

21. Elevations (Show whether DF, RT, etc.)

5340 GR

21A. Kind & Status Plug. Bond

21B. Drilling Contractor

22. Approx. Date Work will start

Upon Approval

23.

PROPOSED CASING AND CEMENT PROGRAM

SIZE OF HOLE	SIZE OF CASING	WEIGHT PER FOOT	SETTING DEPTH	SACKS OF CEMENT	EST. TOP
12 $\frac{1}{4}$ "	8 5/8"	24	300	Circulate to	surface
7-7/8"	5 $\frac{1}{2}$ "	15.5	6075	See below	

Well to be drilled to approximate T.D. of 6075', log, run 5 $\frac{1}{2}$ ", casing to T.D. Casing to be cemented thru deepest pay zone with setting depth to provide at least 30' from bottom of lowest perforation to float collar. Cement volume to be calculated to fill from T.D. to 4500', 2nd stage of cement to have top near 2500', 3rd stage cemented 1500' to surface. W.O.C. between stages to allow initial set of cement to avoid lost circulation, perforate 5 $\frac{1}{2}$ " casing and treat formation as necessary to establish commercial production.

Reference order No. R-3822-A, case No. 4249, approved 11/10/69 for unorthodox location.

APPROVAL VALID
FOR 90 DAYS UNLESS
DRILLING COMMENCED,

EXPIRES

IN ABOVE SPACE DESCRIBE PROPOSED PROGRAM: IF PROPOSAL IS TO DEEPEN OR PLUG BACK, GIVE DATA ON PRESENT PRODUCTIVE ZONE AND PROPOSED NEW PRODUCTIVE ZONE. GIVE BLOWOUT PREVENTER PROGRAM, IF ANY.

I hereby certify that the information above is true and complete to the best of my knowledge and belief.

Signed E. A. Ford Title Sr. Production Clerk

Date 11/18/69

(This space for State Use)

APPROVED BY

TITLE

DATE 11-20-69

CONDITIONS OF APPROVAL, IF ANY:

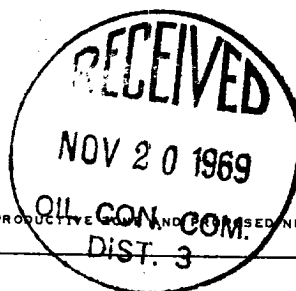

NEW MEXICO OIL CONSERVATION COMMISSION WELL LOCATION AND ACERAGE DEDICATION PLAT

All distances must be from the outer boundaries of the Section

Operator **Tenneco Oil Co.** Section **11** Township **29 North** Range **12 West** County **San Juan** Well No. **1**
 Unit Letter **11** Section **11** Township **29 North** Range **12 West** County **San Juan**
 Actual Footage Location of Well: **2390** feet from the **North** line **73** feet from the **East** line
 Ground Level Elev. **5340** Producing Formation **Dakota** Dedicated Acreage **320**
Basin Dakota

- Outline the acreage dedicated to the subject well by coloring hereon and make marks on the plat below.
 - If more than one lease is dedicated to the well, outline each and identify the ownership thereof both as to working interest and royalty.
 - If more than one lease of different ownership is dedicated to the well have the interests of all owners been consolidated by communitization, unitization, force-pooling, etc?
- ☐ Yes ☐ No If answer is "Yes," type of consolidation _____

If answer is "No," list the owners and tract descriptions which have actually consolidated. (Use reverse side of this form if necessary.) _____

No allowable well be assigned to the well until all interests have been consolidated (by communitization, unitization, forced-pooling, or otherwise) or until a non standard unit, eliminating such interests has been approved by the Commission.

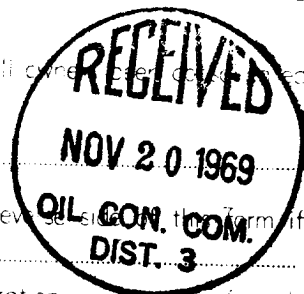

CERTIFICATION

I hereby certify that the information contained herein is true and complete to the best of my knowledge and belief.

Name G. A. Ford
 Position Sr. Production Clerk
 Company Tenneco Oil Company
 Date 10/28/69

I hereby certify that the well location shown on this plat was plotted from field notes of actual surveys made by me or under my supervision, and that the same is true and correct to the best of my knowledge and belief.

Date Surveyed 19 September 1969
Robert H. Ernst
 Registered Professional Engineer
 and/or Land Surveyor

ROBERT H. ERNST
L. Mon. 11-1-12 2463
 Certificate No. _____

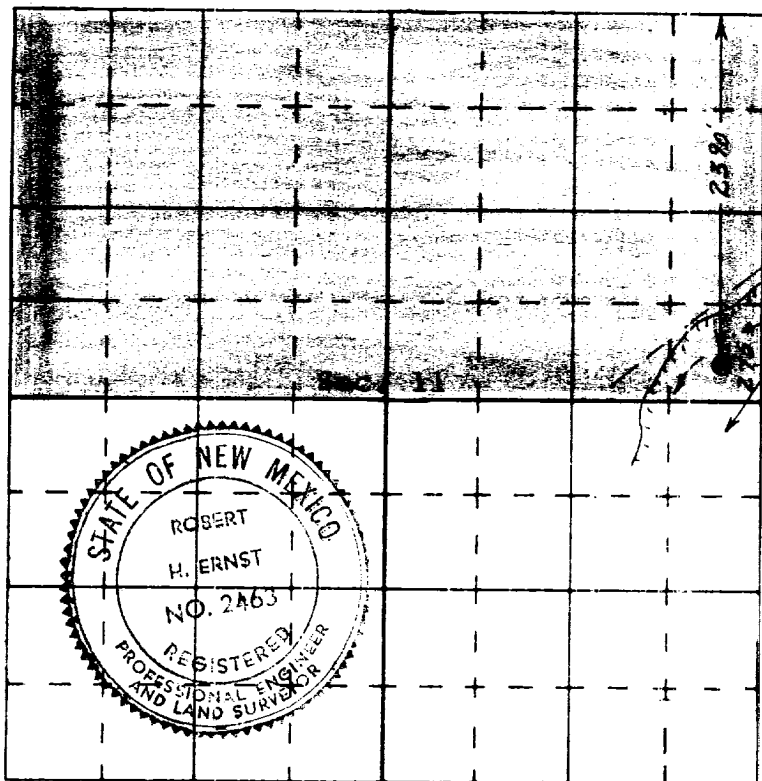

ERNST ENGINEERING CO.
 DURANGO, COLORADO 81301