

UNITED STATES
DEPARTMENT OF THE INTERIOR
GEOLOGICAL SURVEY

APPLICATION FOR PERMIT TO DRILL, DEEPEN, OR PLUG BACK

1a. TYPE OF WORK

DRILL ☒DEEPEN ☐PLUG BACK ☐

b. TYPE OF WELL

OIL
WELL ☒GAS
WELL ☐OTHER ☐SINGLE
ZONE ☒MULTIPLE
ZONE ☐

2. NAME OF OPERATOR

Eastern Petroleum Co.

3. ADDRESS OF OPERATOR

P.O. Box 291, Carmi, Illinois 62821

4. LOCATION OF WELL (Report location clearly and in accordance with any State requirements.*)

At surface

2440' FSL, 230' FEL

At proposed prod. zone

Same

DISTANCE IN MILES AND DIRECTION FROM NEAREST TOWN OR POST OFFICE*

Five Miles west of Shiprock, New Mexico

10. DISTANCE FROM PROPOSED*

LOCATION TO NEAREST
PROPERTY OR LEASE LINE, FT.
(Also to nearest drlg. unit line, if any)

230'

16. NO. OF ACRES IN LEASE

4080

17. NO. OF ACRES ASSIGNED
TO THIS WELL

40

18. DISTANCE FROM PROPOSED LOCATION*
TO NEAREST WELL, DRILLING, COMPLETED,
OR APPLIED FOR, ON THIS LEASE, FT.

195'

19. PROPOSED DEPTH

900'

20. ROTARY OR CABLE TOOLS

Rotary

21. ELEVATIONS (Show whether DF, RT, GR, etc.)

5322 GL

22. APPROX. DATE WORK WILL START*

May 25, 1970

23.

PROPOSED CASING AND CEMENTING PROGRAM

SIZE OF HOLE	SIZE OF CASING	WEIGHT PER FOOT	SETTING DEPTH	QUANTITY OF CEMENT
8 1/2"	7"	20#	15'	3 sks.
6 1/2"	4 1/2"	9.5#	850'	10 sks.

Propose to drill and test the Dakota Sandstone. If productive, will set and cement 4 1/2" casing.

RECEIVED
MAY 15 1970
OIL CON. COM.
DIST. 3

RECEIVED

MAY 14 1970

U. S. GEOLOGICAL SURVEY

IN ABOVE SPACE DESCRIBE PROPOSED PROGRAM: If proposal is to deepen or plug back, give data on present productive zone and proposed new productive zone. If proposal is to drill or deepen directionally, give pertinent data on subsurface locations and measured and true vertical depths. Give blowout preventer program, if any.

24.

SIGNED

Robert A. Fullop

TITLE

Vice Pres.

DATE

May 11, 1970

(This space for Federal or State office use)

PERMIT NO.

APPROVAL DATE

APPROVED BY

TITLE

DATE

CONDITIONS OF APPROVAL, IF ANY:

*See Instructions On Reverse Side



NEW MEXICO OIL CONSERVATION COMMISSION
WELL LOCATION AND ACREAGE DEDICATION PLAT

Form C-128
Supersedes C-128
Effective 1-1-65

All distances must be from the outer boundaries of the Section.

Operator Eastern Petroleum Co.		Lease Navajo		Well No. 61	
Unit Letter I	Section 2	Township 29N	Range 19 W	County San Juan	
Actual Location of Well: 2440 feet from the South line and 230 feet from the East line					
Ground Level Elev. 5322	Producing Formation Dakota		Pool Rattlesnake	Dedicated Acreage: 40 Joint Acres	

1. Outline the acreage dedicated to the subject well by colored pencil or hachure marks on the plat below.
2. If more than one lease is dedicated to the well, outline each and identify the ownership thereof (both as to working interest and royalty).
3. If more than one lease of different ownership is dedicated to the well, have the interests of all owners been consolidated by communitization, unitization, force-pooling, etc?

☐ Yes ☐ No If answer is "yes," type of consolidation _____

If answer is "no," list the owners and tract descriptions which have actually been consolidated (Use reverse side of this form if necessary.) _____

No allowable will be assigned to the well until all interests have been consolidated (by communitization, unitization, forced-pooling, or otherwise) or until a non-standard unit, eliminating such interests, has been approved by the Commission.

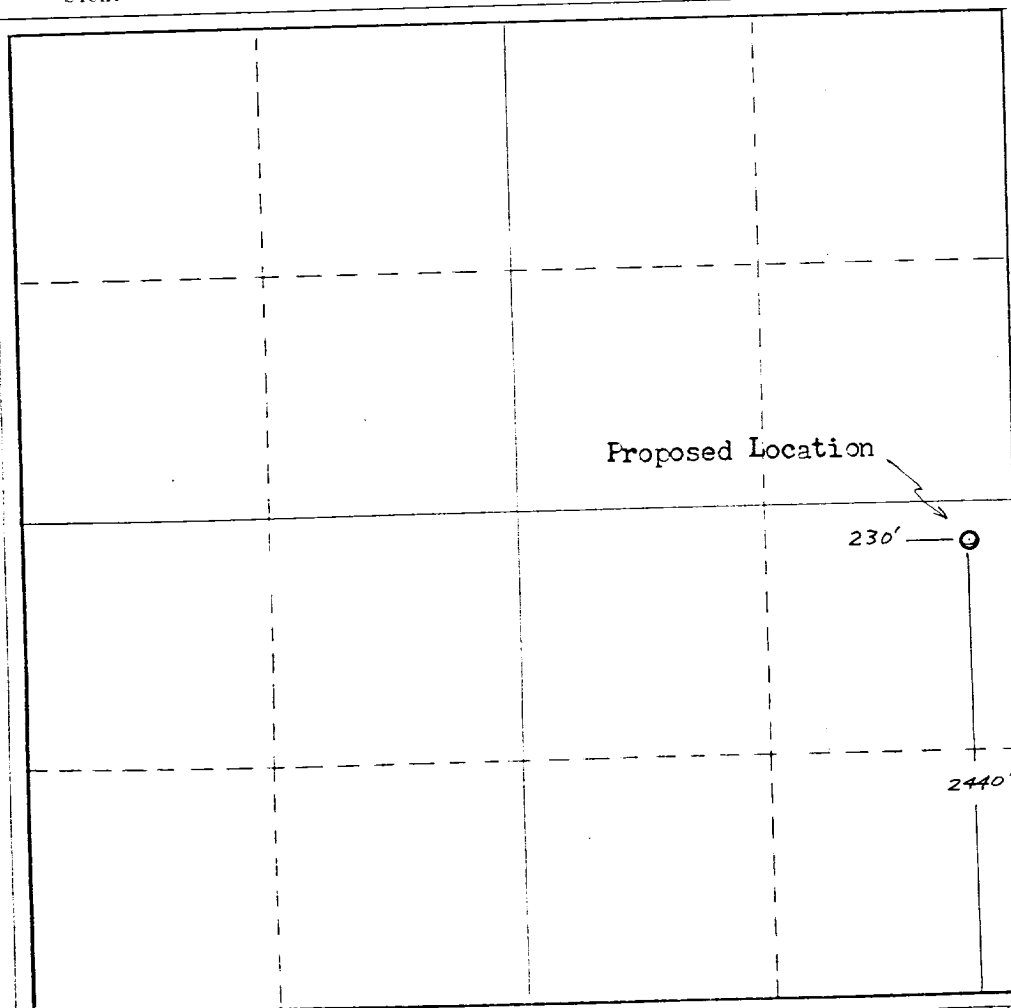
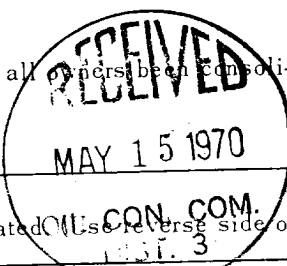

CERTIFICATION

I hereby certify that the information contained herein is true and complete to the best of my knowledge and belief.

Name
Position
Company
Date

I hereby certify that the well location shown on this plat was plotted from field notes of actual surveys made by me or under my supervision, and that the same is true and correct to the best of my knowledge and belief.

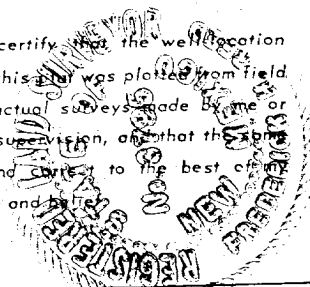

Date Surveyed April 28, 1970
Registered Professional Engineer and/or Land Surveyor <i>Frederick H. Reed</i>
Certificate No. 3795