

UNITED STATES
DEPARTMENT OF THE INTERIOR
GEOLOGICAL SURVEY

30-045-21072

APPLICATION FOR PERMIT TO DRILL, DEEPEN, OR PLUG BACK

1a. TYPE OF WORK

DRILL ☒DEEPEN ☐PLUG BACK ☐

b. TYPE OF WELL

OIL
WELL ☒GAS
WELL ☐

OTHER

SINGLE
ZONE ☐MULTIPLE
ZONE ☐

2. NAME OF OPERATOR

Eastern Petroleum Company

3. ADDRESS OF OPERATOR

P. O. Box 291 Carmi, Illinois 62821

4. LOCATION OF WELL (Report location clearly and in accordance with any State requirements.*)

At surface

725 FEL 2450 FSL

At proposed prod. zone
same

14. DISTANCE IN MILES AND DIRECTION FROM NEAREST TOWN OR POST OFFICE*

9 miles SW of Shiprock New Mexico

15. DISTANCE FROM PROPOSED*

LOCATION TO NEAREST
PROPERTY OR LEASE LINE, FT.
(Also to nearest drlg. unit line, if any)18. DISTANCE FROM PROPOSED LOCATION*
TO NEAREST WELL, DRILLING, COMPLETED,
OR APPLIED FOR, ON THIS LEASE, FT.

16. NO. OF ACRES IN LEASE

40 acres

17. NO. OF ACRES ASSIGNED
TO THIS WELL

2 1/2 acres

19. PROPOSED DEPTH

1300 ft.

20. ROTARY OR CABLE TOOLS

0-1300 ft.

21. ELEVATIONS (Show whether DF, RT, GR, etc.)

5299

22. APPROX. DATE WORK WILL START*

Sept., 1972

23.

PROPOSED CASING AND CEMENTING PROGRAM

SIZE OF HOLE	SIZE OF CASING	WEIGHT PER FOOT	SETTING DEPTH	QUANTITY OF CEMENT
83/4	7#	24#	17.5	5sx
61/8	4#	9.5	TD	as required

Propose to drill and test the Dakota Sandstone.
If productive, will run and set 4 1/2 csg. to TD.

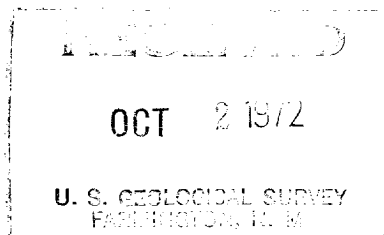

IN ABOVE SPACE DESCRIBE PROPOSED PROGRAM: If proposal is to deepen or plug back, give data on present productive zone and proposed new productive zone. If proposal is to drill or deepen directionally, give pertinent data on subsurface locations and measured and true vertical depths. Give blowout preventer program, if any.

24.

SIGNED

Sandra Nightingale

TITLE

Secretary

DATE 9-15-72

(This space for Federal or State office use)

PERMIT NO.

APPROVAL DATE

APPROVED BY

SA

TITLE

DATE

CONDITIONS OF APPROVAL, IF ANY:



NEW MEXICO OIL CONSERVATION COMMISSION
WELL LOCATION AND ACREAGE DEDICATION PLAT

Form C-122
Supersedes C-128
Effective 1-1-65

All distances must be from the outer boundaries of the Section.

Operator Eastern Petroleum Company		Lease Navajo		Well No. 207 3-6 78	
Unit Letter	Section 2	Township 29 North	Range 19 West	County San Juan	
Actual Footage Location of Well: 2450 feet from the South line and 725 feet from the East line					
Ground Level Elev. 5299	Producing Formation		Pool	Dedicated Acreage: Acres	

1. Outline the acreage dedicated to the subject well by colored pencil or hachure marks on the plat below.
2. If more than one lease is dedicated to the well, outline each and identify the ownership thereof (both as to working interest and royalty).
3. If more than one lease of different ownership is dedicated to the well, have the interests of all owners be consolidated by communitization, unitization, force-pooling, etc?

☐ Yes ☐ No If answer is "yes," type of consolidation _____

If answer is "no," list the owners and tract descriptions which have actually been consolidated (Use reverse side of this form if necessary.) _____

No allowable will be assigned to the well until all interests have been consolidated (by communitization, unitization, forced-pooling, or otherwise) or until a non-standard unit, eliminating such interests, has been approved by the Commission.

CERTIFICATION

I hereby certify that the information contained herein is true and complete to the best of my knowledge and belief.

Name **Andra Lightingle**
Position **Secretary**
Company **Eastern Petroleum**
Date **9/15/72**

I hereby certify that the well location shown on this plat was plotted from field notes of actual surveys made by me or under my supervision, and that the same is true and correct to the best of my knowledge and belief.

Sept. 13, 1972

Date Surveyed

Frederick H. Reed

Registered Professional Engineer
and/or Land Surveyor

Frederick H. Reed
3795

Certificate No.

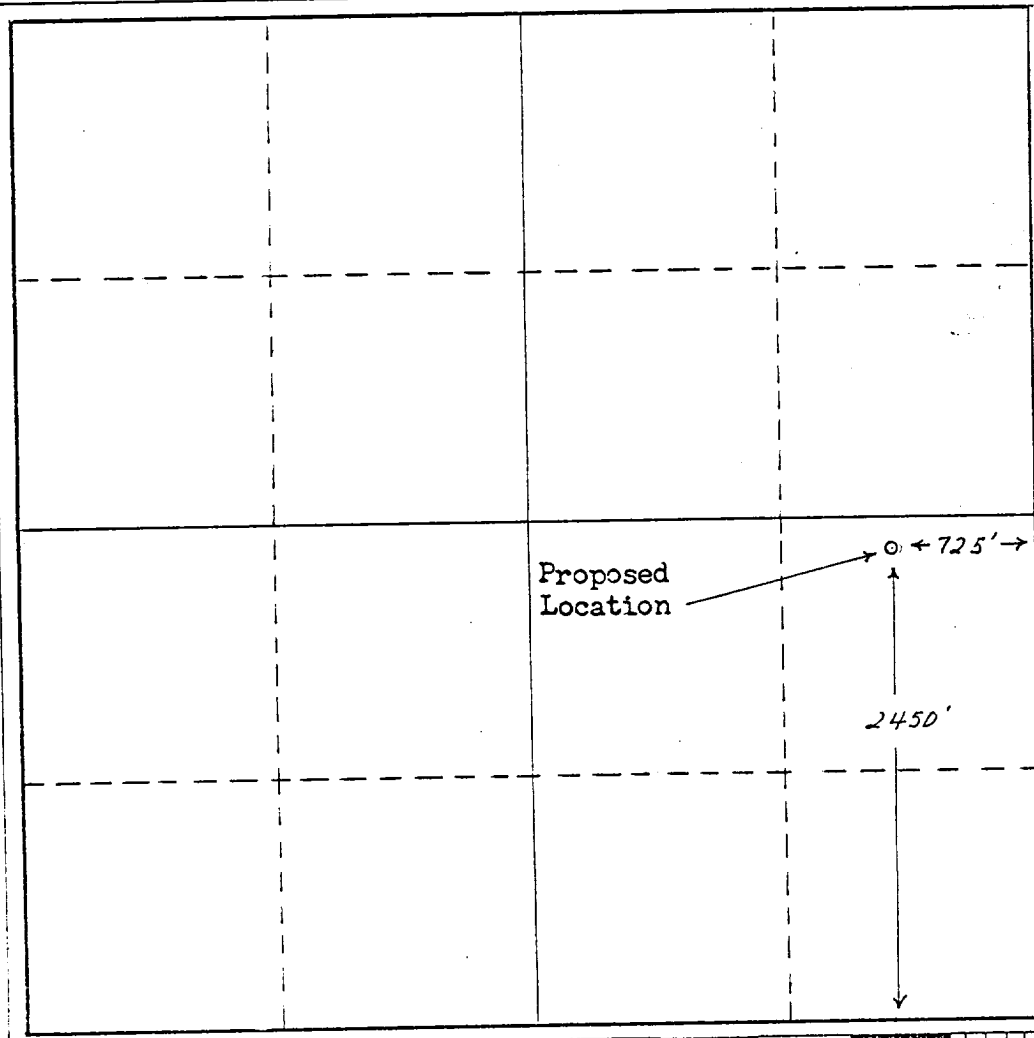

0 330 660 990 1320 1650 1980 2310 2640 2000 1500 1000 500 0