

UNITED STATES
DEPARTMENT OF THE INTERIOR
GEOLOGICAL SURVEY

APPLICATION FOR PERMIT TO DRILL, DEEPEN, OR PLUG BACK

1a. TYPE OF WORK DRILL <input checked="" type="checkbox"/> DEEPEN <input type="checkbox"/> PLUG BACK <input type="checkbox"/>			5. LEASE DESIGNATION AND SERIAL NO. SF-078716		
b. TYPE OF WELL OIL WELL <input type="checkbox"/> GAS WELL <input checked="" type="checkbox"/> OTHER <input type="checkbox"/> SINGLE ZONE <input checked="" type="checkbox"/> MULTIPLE ZONE <input type="checkbox"/>			6. IF INDIAN, ALLOTTEE OR TRIBE NAME		
2. NAME OF OPERATOR Petroleum Corporation of Texas			7. UNIT AGREEMENT NAME		
3. ADDRESS OF OPERATOR P. O. Box 911, Breckenridge, Texas 76024			8. FARM OR LEASE NAME Bunce		
4. LOCATION OF WELL (Report location clearly and in accordance with any State requirements.) At surface 790' FNL, 1080' FEL At proposed prod. zone Same			9. WELL NO. 1-Y		
14. DISTANCE IN MILES AND DIRECTION FROM NEAREST TOWN OR POST OFFICE* 6 miles			10. FIELD AND POOL, OR WILDCAT Aztec P. C.		
15. DISTANCE FROM PROPOSED* LOCATION TO NEAREST PROPERTY OR LEASE LINE, FT. (Also to nearest drlg. unit line, if any) 790'		16. NO. OF ACRES IN LEASE --		17. NO. OF ACRES ASSIGNED TO THIS WELL 160	
18. DISTANCE FROM PROPOSED LOCATION* TO NEAREST WELL, DRILLING, COMPLETED, OR APPLIED FOR, ON THIS LEASE, FT. 280'		19. PROPOSED DEPTH 2000		20. ROTARY OR CABLE TOOLS Rotary	
21. ELEVATIONS (Show whether DF, RT, GR, etc.) 5588' GR			22. APPROX. DATE WORK WILL START* 12-15-73		

23. PROPOSED CASING AND CEMENTING PROGRAM

SIZE OF HOLE	SIZE OF CASING	WEIGHT PER FOOT	SETTING DEPTH	QUANTITY OF CEMENT
12-1/4	8-5/8	24.0	100	75 sx
7-7/8	4-1/2	9.5	2200	100 sx

It is proposed to drill this well with rotary tools using drilling mud for circulation through the Pictured Cliffs Formation. All possible production intervals in the Pictured Cliffs will be completed.

The NE/4 of Section 19 is dedicated to this well.

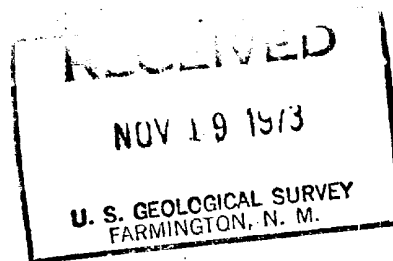
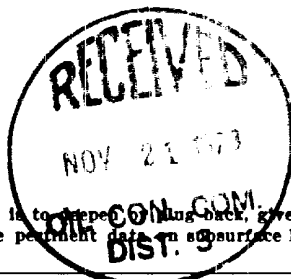

IN ABOVE SPACE DESCRIBE PROPOSED PROGRAM: If proposal is to deepen or plug back, give data on present productive zone and proposed new productive zone. If proposal is to drill or deepen directionally, give pertinent data on subsurface locations and measured and true vertical depths. Give blowout preventer program, if any.

24. For: Petroleum Corporation of Texas Petroleum Engineer
Ewell N. Walsh
TITLE Consultant
DATE Nov. 15, 1973
(This space for Federal or State office use)

PERMIT NO. APPROVAL DATE

APPROVED BY TITLE DATE

CONDITIONS OF APPROVAL, IF ANY:

Okal

*See Instructions On Reverse Side

**NEW MEXICO OIL CONSERVATION COMMISSION
WELL LOCATION AND ACERAGE DEDICATION PLAT**

All distances must be from the outer boundaries of the Section

Operator Petroleum Corporation of Texas			Lease Bunce		Well No. 1-Y
Unit Letter A	Section 19	Township 29 North	Range 10 West	County San Juan	
Actual Footage Location of Well:					
790 feet from the North line and		1080 feet from the East line			
Ground Level Elev. 5588	Producing Formation Pictured Cliffs	Pool Aztec P. C.	Dedicated Acreage: 160		Acres

1. Outline the acreage dedicated to the subject well by colored pencil or hachure marks on the plat below.
2. If more than one lease is dedicated to the well, outline each and identify the ownership thereof (including interest and royalty).
3. If more than one lease of different ownership is dedicated to the well, have the interests of all owners been consolidated by communitization, unitization, force-pooling, etc?

() Yes () No If answer is "yes," type of consolidation

If answer is "no," list the owners and tract descriptions which have actually consolidated. (Use reverse of this form if necessary.)

No allowable will be assigned to the well until all interests have been consolidated (by communitization, unitization, forced-pooling, or otherwise) or until a non standard unit, eliminating such interests, has been approved by the Commission.

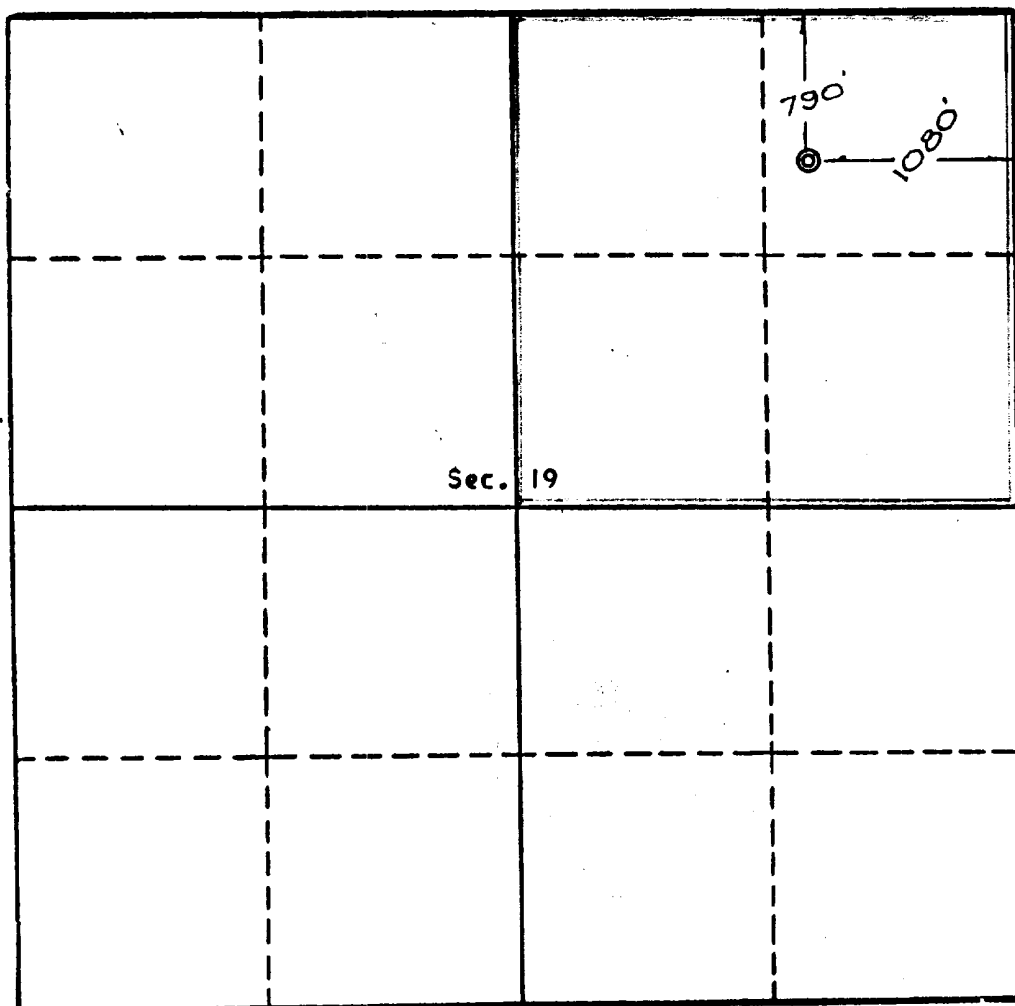
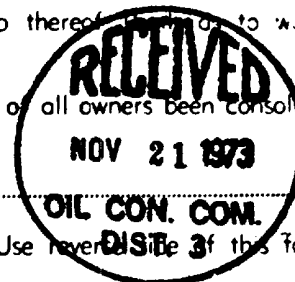

Scale, 1 inch = 1,000 feet

CERTIFICATION

I hereby certify that the information contained herein is true and complete to the best of my knowledge and belief.

Ewell N. Walsh
Name **Ewell N. Walsh**
Position **Petroleum Engr. Consultant**
for: **Petroleum Corp. of Texas**
Company

Date
November 15, 1973

I hereby certify that the well location shown on this plat was plotted from field notes of actual surveys made by me or under my supervision, and that the same is true and correct to the best of my knowledge and belief.

Date Surveyed
September 20, 1973
Registered Professional Engineer
and/or Land Surveyor

E. V. Echohawk
Certificate No. **3602**
E. V. Echohawk LS

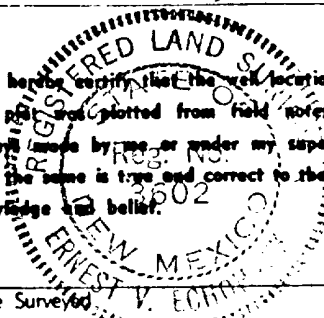

AMERICAN

LIBRARY

OF THE

CONGRESS

100000
1:250,000

UNITED STATES
DEPARTMENT OF THE INTERIOR
GEOLOGICAL SURVEY

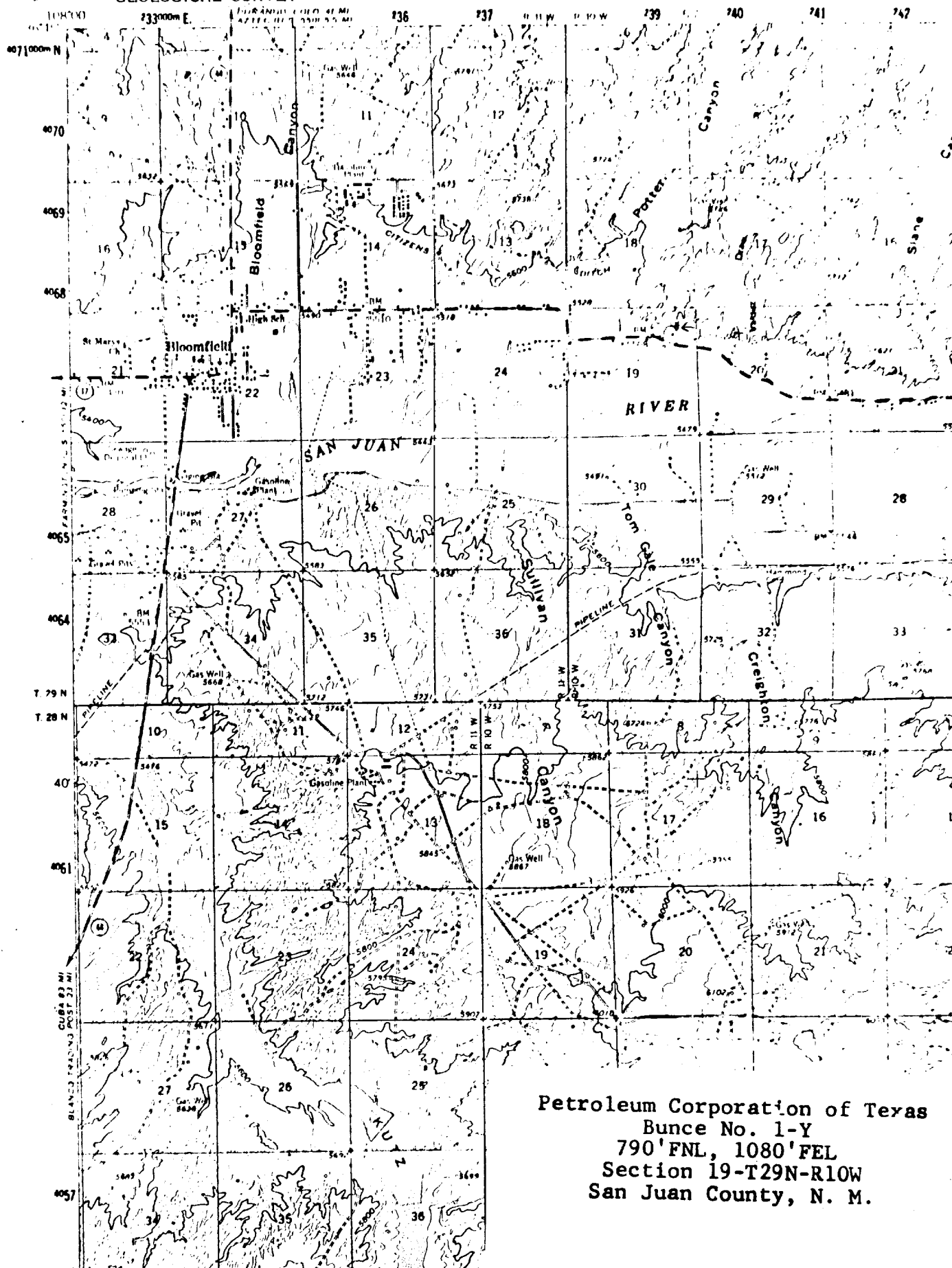

Petroleum Corporation of Texas
Buncce No. 1-Y
790' FNL, 1080' FEL
Section 19-T29N-R10W
San Juan County, N. M.

DEVELOPMENT PLAN
PETROLEUM CORPORATION OF TEXAS
BUNCE, NO. 1-Y
790'FNL, 1080'FEL, Section 19-T29N-R10W
San Juan County, N. M.

PROPOSED LOCATION LAYOUT

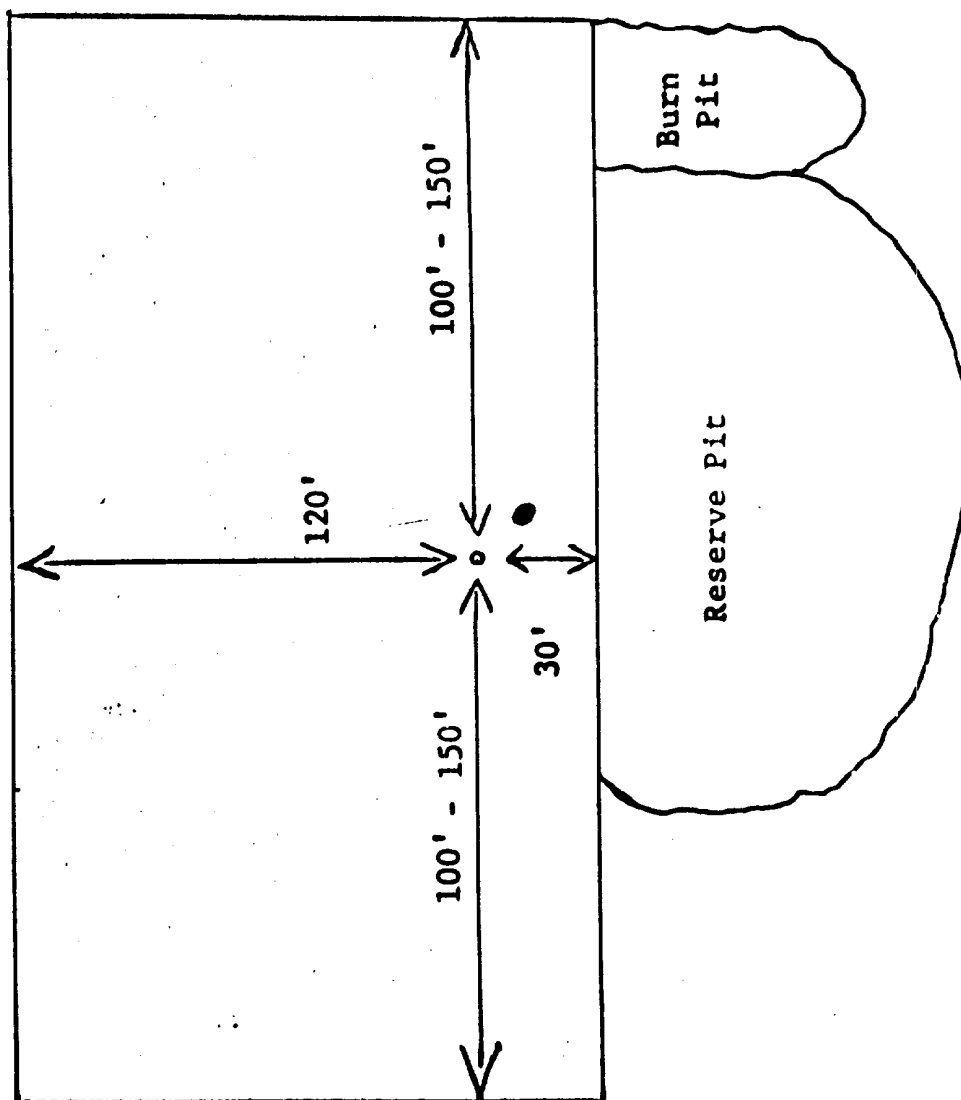

DEVELOPMENT PLAN

PETROLEUM CORPORATION OF TEXAS
BUNCE, NO. 1-Y

1. Existing roads shown on attached plat.
2. Planned access from existing road is approximately 100' to new location.
3. Location - Bunce, No. 1-Y
790' FNL, 1080' FEL
Sec. 19-T29N-R10W
San Juan County, New Mexico
4. No additional well is planned on this lease at this time.
5. Production equipment or storage facilities proposed for the well will be installed on location.
6. Water will be obtained from
San Juan River located
in NW/4 Section 27-T29N-R11W
7. Waste materials will be buried on location or in reserve pit.
8. No permanent camp is planned. A trailer house will be used on location during drilling process.
9. No airstrip proposed.
10. See attached plat for layout.
11. Pits will be filled, location cleaned up, and area not in use for producing well will be reseeded using broadcast method of planting.