

UNITED STATES
DEPARTMENT OF THE INTERIOR
GEOLOGICAL SURVEY

APPLICATION FOR PERMIT TO DRILL, DEEPEN, OR PLUG BACK

1a. TYPE OF WORK DRILL <input checked="" type="checkbox"/> DEEPEN <input type="checkbox"/> PLUG BACK <input type="checkbox"/>			5. LEASE DESIGNATION AND SERIAL NO. NM-03717-B	
b. TYPE OF WELL OIL WELL <input type="checkbox"/> GAS WELL <input checked="" type="checkbox"/> OTHER <input type="checkbox"/>			6. IF INDIAN, ALLOTTEE OR TRIBE NAME	
2. NAME OF OPERATOR Petroleum Corporation of Texas			7. UNIT AGREEMENT NAME	
3. ADDRESS OF OPERATOR P. O. Box 911, Breckenridge, Texas 76024			8. FARM OR LEASE NAME Garrett Com	
4. LOCATION OF WELL (Report location clearly and in accordance with any State requirements.)* At surface 1040' FNL, 790' FEL At proposed prod. zone Same			9. WELL NO. 3-Y	
14. DISTANCE IN MILES AND DIRECTION FROM NEAREST TOWN OR POST OFFICE* 4 miles			10. FIELD AND POOL, OR WILDCAT Aztec P. C.	
15. DISTANCE FROM PROPOSED* LOCATION TO NEAREST PROPERTY OR LEASE LINE, FT. (Also to nearest drg. unit line, if any) 790'			11. SEC., T., R., M., OR BLK. AND SURVEY OR AREA Sec. 12-T29N-R11W N.M.P.M.	
18. DISTANCE FROM PROPOSED LOCATION* TO NEAREST WELL, DRILLING, COMPLETED, OR APPLIED FOR, ON THIS LEASE, FT. 500'			12. COUNTY OR PARISH San Juan	
16. NO. OF ACRES IN LEASE --			13. STATE New Mexico	
19. PROPOSED DEPTH 2210			17. NO. OF ACRES ASSIGNED TO THIS WELL 160	
20. ROTARY OR CABLE TOOLS Rotary			21. APPROX. DATE WORK WILL START* 3-1-74	
21. ELEVATIONS (Show whether DF, RT, GR, etc.) 5845' GR				

23. PROPOSED CASING AND CEMENTING PROGRAM

SIZE OF HOLE	SIZE OF CASING	WEIGHT PER FOOT	SETTING DEPTH	QUANTITY OF CEMENT
12-1/4	8-5/8	24.0	100	75 sx.
7-7/8	4-1/2	9.5	2210	100 sx.

It is proposed to drill this well with rotary tools using drilling mud for circulation through the Pictured Cliffs Formation. All possible production intervals in the Pictured Cliffs will be completed. This well is intended to be a replacement well for the Garrett Com No. 1, SW/4NE/4 Section 12-T29N-R11W.

The NE/4 Section 12 is dedicated to this well.

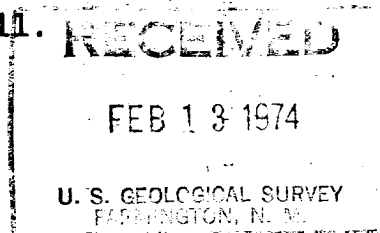
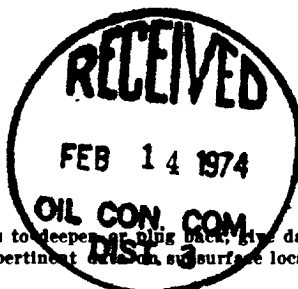

IN ABOVE SPACE DESCRIBE PROPOSED PROGRAM: If proposal is to deepen or plug back, give data on present productive zone and proposed new productive zone. If proposal is to drill or deepen directionally, give pertinent data on surface locations and measured and true vertical depths. Give blowout preventer program, if any.

24. For: Petroleum Corporation of Texas Petroleum Engineer
Consultant
SIGNED: Ewell N. Walsh TITLE: Consultant DATE: Feb. 12, 1974
(This space for Federal or State office use)

PERMIT NO. _____ APPROVAL DATE _____

APPROVED BY _____ TITLE _____ DATE _____
CONDITIONS OF APPROVAL, IF ANY:

Okal

NEW MEXICO OIL CONSERVATION COMMISSION

WELL LOCATION AND ACERAGE DEDICATION PLAT

All distances must be from the outer boundaries of the Section

Operator Petroleum Corporation of Texas			Lease Garrett Com		Well No 3-Y
Unit Letter A	Section 12	Township 29 North	Range 11 West	County San Juan	
Actual Footage Location of Well: 1040 feet from the North line and 790 feet from the East line					
Ground Level Elev. 5845	Producing Formation Pictured Cliffs		Pool Aztec P. C.	Dedicated Acreage: 160 Acres	

- Outline the acreage dedicated to the subject well by colored pencil or hachure marks on the plat below.
- If more than one lease is dedicated to the well, outline each and identify the ownership thereof (both as to working interest and royalty),
- If more than one lease of different ownership is dedicated to the well, have the interests of all owners been consolidated by communitization, unitization, force-pooling, etc?

(X) Yes () No If answer is "yes," type of consolidation Communitization Agreement

If answer is "no," list the owners and tract descriptions which have actually consolidated. (Use reverse side of this form if necessary.)

No allowable will be assigned to the well until all interests have been consolidated (by communitization, unitization, forced-pooling, or otherwise) or until a non standard unit, eliminating such interests, has been approved by the Commission.

CERTIFICATION

I hereby certify that the information contained herein is true and complete to the best of my knowledge and belief.

Ewell N. Walsh
Name

Ewell N. Walsh

Position
Petroleum Engr. Consultant

Company
for: Petroleum Corp. of Texas

Date
February 12, 1974

I hereby certify that the well location shown on this plat was plotted from field notes of actual survey made by me or under my supervision, and that the same is true and correct to the best of my knowledge and belief.

E. V. Echolaw
Date Surveyed
September 26, 1973

Registered Professional Engineer
and/or Land Surveyor

E. V. Echolaw
Certificate No. 3602
E. V. Echolaw LS

Scale, 1 inch = 1,000 feet

1:250,000
FLCRA US-24

UNITED STATES
DEPARTMENT OF THE INTERIOR
GEOLOGICAL SURVEY

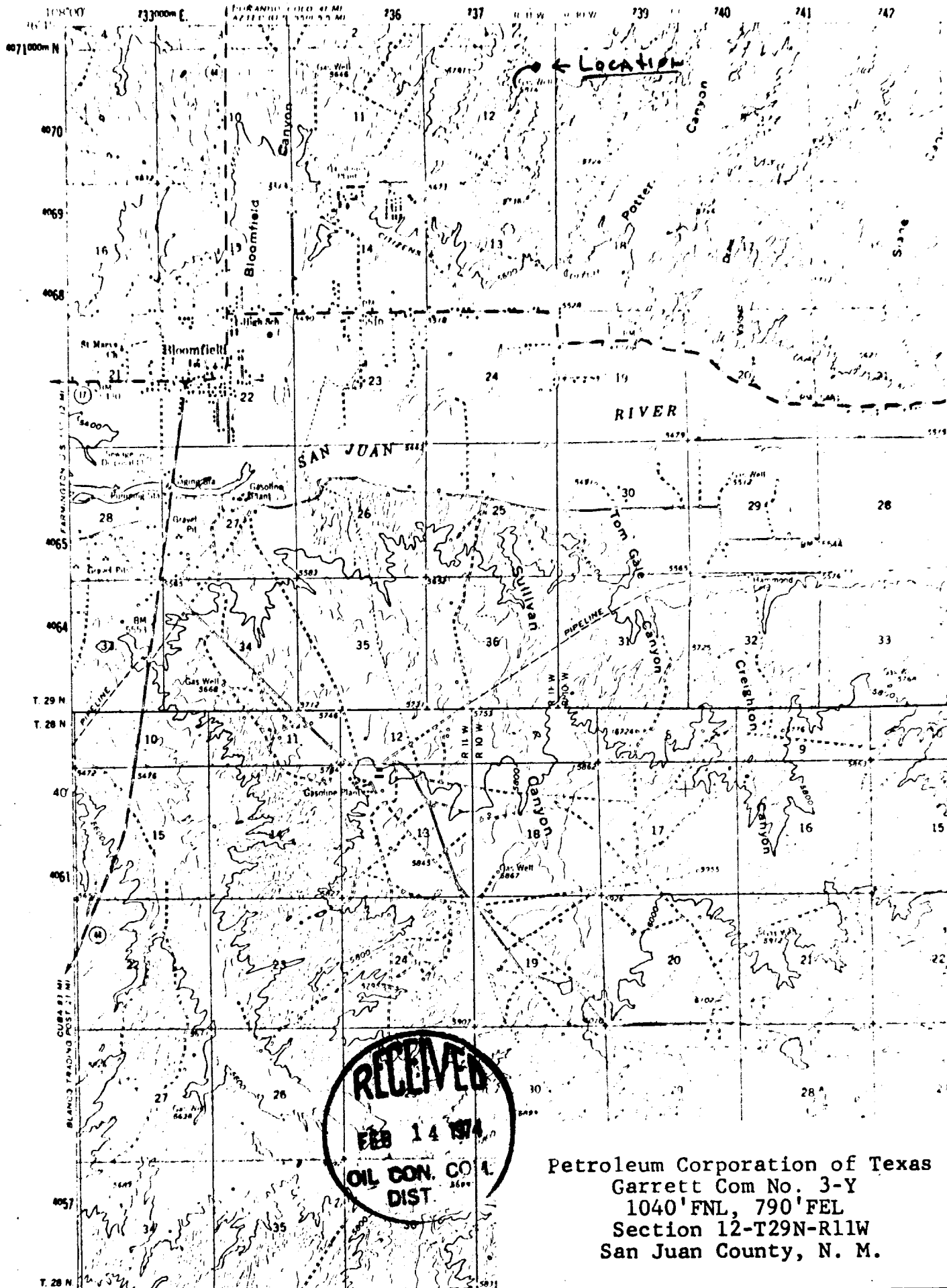

Petroleum Corporation of Texas
Garrett Com No. 3-Y
1040' FNL, 790' FEL
Section 12-T29N-R11W
San Juan County, N. M.

DEVELOPMENT PLAN
PETROLEUM CORPORATION OF TEXAS
GARRETT COM NO. 3-Y

1. Existing roads shown on attached plat.
2. Planned access from existing road is approximately 500' to new location.
3. Location - Garrett Com No. 3-Y
1040' FNL, 790' FEL
Section 12-T29N-R11W
San Juan County, New Mexico
4. It is intended for this well to be a replacement well.
5. Production equipment or storage facilities proposed for the well will be installed on location.
6. Water will be obtained from
San Juan River located in
NW/4 Sec. 27-T29N-R11W.
7. Waste materials will be buried on location or in reserve pit.
8. No permanent camp is planned. A trailer house will be used on location during drilling process.
9. No airstrip proposed.
10. See attached plat for layout.
11. Pits will be filled, location cleaned up, and area not in use for producing well will be reseeded using broadcast method of planting.



DEVELOPMENT PLAN
PETROLEUM CORPORATION OF TEXAS
GARRETT COM NO. 3-Y
1040' FNL, 790' FEL, Section 12-T29N-R11W
San Juan County, New Mexico

PROPOSED LOCATION LAYOUT

