

NO. OF COPIES RECEIVED	4
DISTRIBUTION	
SANTA FE	1
FILE	1
U.S.G.S.	2
LAND OFFICE	
OPERATOR	2

# NEW MEXICO OIL CONSERVATION COMMISSION

Form C-101  
Revised 1-1-65 30 045-21460

5A. Indicate Type of Lease	
STATE <input type="checkbox"/>	FEE <input checked="" type="checkbox"/>
5. State Oil & Gas Lease No.	

## APPLICATION FOR PERMIT TO DRILL, DEEPEN, OR PLUG BACK

1a. Type of Work		7. Unit Agreement Name	
b. Type of Well DRILL <input checked="" type="checkbox"/> DEEPEN <input type="checkbox"/> PLUG BACK <input type="checkbox"/> OIL WELL <input type="checkbox"/> GAS WELL <input checked="" type="checkbox"/> OTHER <input type="checkbox"/> SINGLE ZONE <input checked="" type="checkbox"/> MULTIPLE ZONE <input type="checkbox"/>		8. Farm or Lease Name Fifield	
2. Name of Operator El Paso Natural Gas Company		9. Well No. 3	
3. Address of Operator Post Office Box 990, Farmington, NM 87401		10. Field and Pool, or Wildcat Undesignated Chacra	
4. Location of Well UNIT LETTER O LOCATED 850 FEET FROM THE South LINE AND 1670 FEET FROM THE East LINE OF SEC. 5 TWP. 29N RGE. 11W NMPM		12. County San Juan	
19. Proposed Depth 3000'		19A. Formation Chacra	
20. Rotary or C.T. Rotary		21. Elevations (Show whether DF, RT, etc.) 5731'GL	
21A. Kind & Status Plug. Bond statewide		21B. Drilling Contractor	
22. Approx. Date Work will start			

23.

## PROPOSED CASING AND CEMENT PROGRAM

SIZE OF HOLE	SIZE OF CASING	WEIGHT PER FOOT	SETTING DEPTH	SACKS OF CEMENT	EST. TOP
12 1/4"	8 5/8"	24.0#	100'	95 sks. (112 cu. ft.)	to surface
6 3/4"	2 7/8"	6.4#	3000'	300sks. (710 cu. ft.)	630'-top of Ojo Alamo

Selectively perforate and sandwater fracture the Chacra formation.

The SE/4 of Section 5 is dedicated to this well.

APPROVAL VALID  
FOR 90 DAYS UNLESS  
DRILLING COMMENCED,

EXPIRES 6-12-74

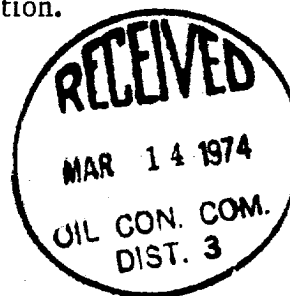

IN ABOVE SPACE DESCRIBE PROPOSED PROGRAM: IF PROPOSAL IS TO DEEPEN OR PLUG BACK, GIVE DATA ON PRESENT PRODUCTIVE ZONE AND PROPOSED NEW PRODUCTIVE ZONE. GIVE BLOWOUT PREVENTER PROGRAM, IF ANY.

I hereby certify that the information above is true and complete to the best of my knowledge and belief.

Signed A. G. Driscoll Title Drilling Clerk Date March 13, 1974

(This space for State Use)

APPROVED BY Emmy C. Linder TITLE SUPERVISOR DIST. #3 DATE 3-14-74

CONDITIONS OF APPROVAL, IF ANY:

**NEW MEXICO OIL CONSERVATION COMMISSION  
WELL LOCATION AND ACREAGE DEDICATION PLAT**

Form C-102  
Supersedes C-128  
Effective 1-1-65

All distances must be from the outer boundaries of the Section.

Operator <b>EL PASO NATURAL GAS COMPANY</b>			Lease <b>FIFIELD</b>		(FEE)	Well No. <b>3</b>
Unit Letter <b>0</b>	Section <b>5</b>	Township <b>29-N</b>	Range <b>11-W</b>	County <b>SAN JUAN</b>		
Actual Footage Location of Well; <b>850</b> feet from the <b>SOUTH</b> line and <b>1670</b> feet from the <b>EAST</b> line						
Ground Level Elev. <b>5731</b>	Producing Formation <b>CHACRA</b>		Pool <b>UNDESIGNATED CHACRA</b>		Dedicated Acreage: <b>160.00</b> Acres	

1. Outline the acreage dedicated to the subject well by colored pencil or hachure marks on the plat below.
2. If more than one lease is dedicated to the well, outline each and identify the ownership thereof (both as to working interest and royalty).
3. If more than one lease of different ownership is dedicated to the well, have the interests of all owners been consolidated by communitization, unitization, force-pooling, etc?

☒ Yes    ☐ No    If answer is "yes," type of consolidation Communitization

If answer is "no," list the owners and tract descriptions which have actually been consolidated. (Use reverse side of this form if necessary.) \_\_\_\_\_

No allowable will be assigned to the well until all interests have been consolidated (by communitization, unitization, forced-pooling, or otherwise) or until a non-standard unit, eliminating such interests, has been approved by the Commission.

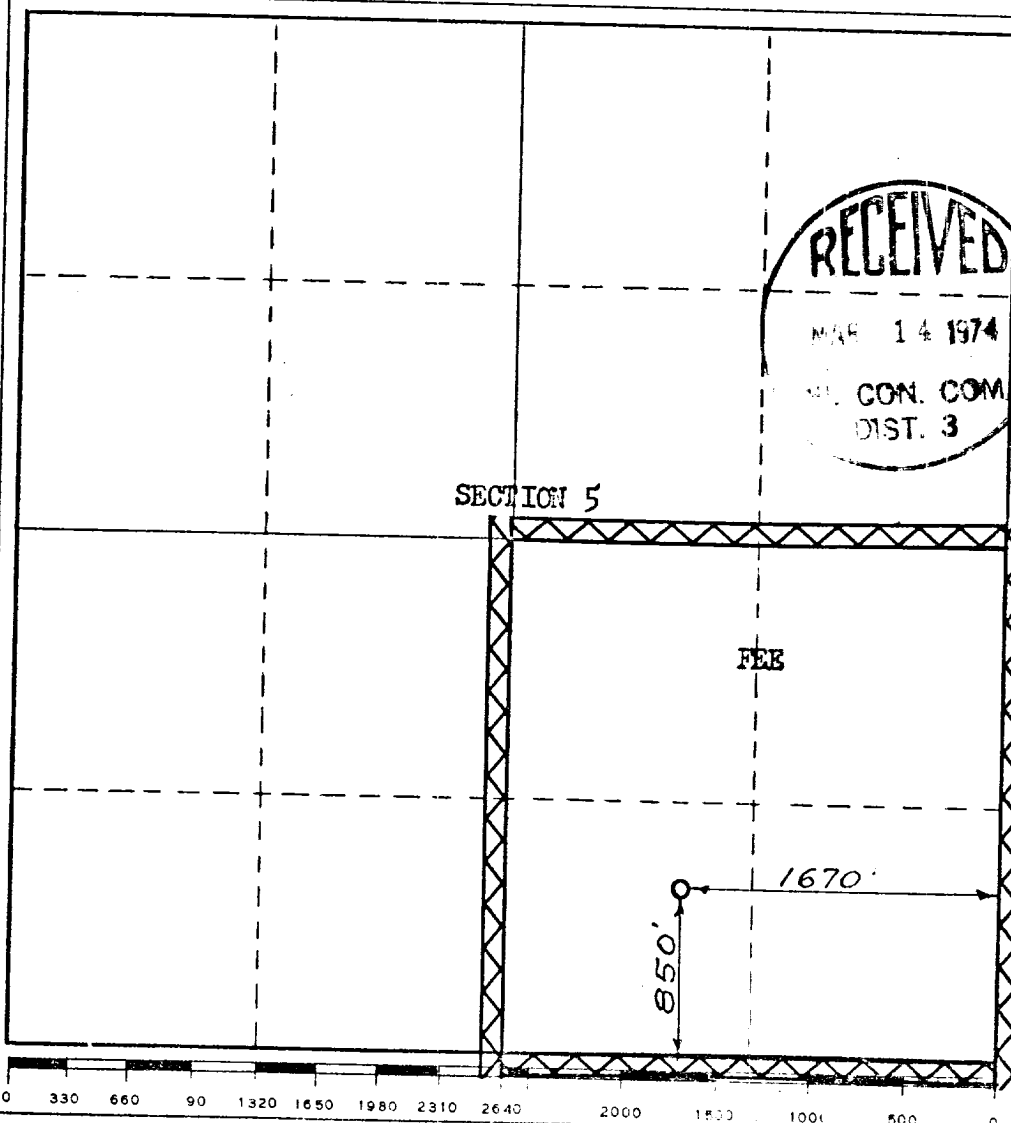

**CERTIFICATION**

I hereby certify that the information contained herein is true and complete to the best of my knowledge and belief.

Original Signed by  
**D. G. Brisson**

Name  
**Drilling Clerk**

Position

**El Paso Natural Gas Co.**

Company

**March 13, 1974**

Date

I hereby certify that the well location shown on this plat was plotted from field notes of actual surveys made by me or under my supervision, and that the same is true and correct to the best of my knowledge and belief.

Date Surveyed  
**JANUARY 23, 1974**

Registered Professional Engineer  
and/or Land Surveyor

*Paul Olsen*  
Certificate No. **1760**