

UNITED STATES
DEPARTMENT OF THE INTERIOR
GEOLOGICAL SURVEY

30-045-21619

5. LEASE DESIGNATION AND SERIAL NO.

SF 078197

6. IF INDIAN, ALLOTTEE OR TRIBE NAME

7. UNIT AGREEMENT NAME

8. FARM OR LEASE NAME

Nye

9. WELL NO.

13

10. FIELD AND POOL, OR WILDCAT

Undesignated Fruitland

11. SEC., T., R., M., OR BLK.
AND SURVEY OR AREASec. 9, T-29-N, R-10-W
NMPM

12. COUNTY OR PARISH

San Juan

13. STATE

New Mexico

APPLICATION FOR PERMIT TO DRILL, DEEPEN, OR PLUG BACK

1a. TYPE OF WORK

DRILL ☒DEEPEN ☐PLUG BACK ☐

b. TYPE OF WELL

OIL
WELL ☐GAS
WELL ☒

OTHER

SINGLE
ZONE ☒MULTIPLE
ZONE ☐

2. NAME OF OPERATOR

El Paso Natural Gas Company

3. ADDRESS OF OPERATOR

PO Box 990, Farmington, NM 87401

4. LOCATION OF WELL (Report location clearly and in accordance with any State requirements.)*

At surface

950'S, 850'W

At proposed prod. zone

14. DISTANCE IN MILES AND DIRECTION FROM NEAREST TOWN OR POST OFFICE*

15. DISTANCE FROM PROPOSED*

LOCATION TO NEAREST
PROPERTY OR LEASE LINE, FT.
(Also to nearest drlg. unit line, if any)

16. NO. OF ACRES IN LEASE

17. NO. OF ACRES ASSIGNED
TO THIS WELL

161.02

18. DISTANCE FROM PROPOSED LOCATION*
TO NEAREST WELL, DRILLING, COMPLETED,
OR APPLIED FOR, ON THIS LEASE, FT.

19. PROPOSED DEPTH

2025'

20. ROTARY OR CABLE TOOLS

Rotary

21. ELEVATIONS (Show whether DF, RT, GR, etc.)

5778'GR

22. APPROX. DATE WORK WILL START*

23.

PROPOSED CASING AND CEMENTING PROGRAM

SIZE OF HOLE	SIZE OF CASING	WEIGHT PER FOOT	SETTING DEPTH	QUANTITY OF CEMENT
12 1/4"	8 5/8"	24.0#	120'	105 cu.ft. to circulate
6 3/4"	2 7/8"	6.4#	2025'	300 cu.ft. to cover Ojo Alamo

Selectively perforate and sandwater fracture the Fruitland formation.

The SW/4 of Section 9 is dedicated to this well.

RECEIVED

DEC 13 1974

U. S. GEOLOGICAL SURVEY
WASHINGTON, D. C.

IN ABOVE SPACE DESCRIBE PROPOSED PROGRAM: If proposal is to deepen or plug back, give data on present productive zone and proposed new productive zone. If proposal is to drill or deepen directionally, give pertinent data on subsurface locations and measured and true vertical depths. Give blowout preventer program, if any.

24.

SIGNED

A. G. Brisco

TITLE

Drilling Clerk

DATE

December 12, 1974

(This space for Federal or State office use)

PERMIT NO.

APPROVAL DATE

APPROVED BY

TITLE

DATE

CONDITIONS OF APPROVAL, IF ANY:

okay

*See Instructions On Reverse Side

NEW MEXICO OIL CONSERVATION COMMISSION
WELL LOCATION AND ACREAGE DEDICATION PLAT

Form C-102
Supersedes C-128
Effective 1-1-65

All distances must be from the outer boundaries of the Section.

Operator EL PASO NATURAL GAS COMPANY		Lease NYE (SF-078197)		Well No. 13
Unit Letter M	Section 9	Township 29-N	Range 10-W	County SAN JUAN
Actual Footage Location of Well: 950 feet from the SOUTH line and 850 feet from the WEST line				
Ground Level Elev. 5778	Producing Formation FRUITLAND	Pool UNDESIGNATED FRUITLAND ✓	Dedicated Acreage: 161.02 Acres ✓	

1. Outline the acreage dedicated to the subject well by colored pencil or hachure marks on the plat below.
2. If more than one lease is dedicated to the well, outline each and identify the ownership thereof (both as to working interest and royalty).
3. If more than one lease of different ownership is dedicated to the well, have the interests of all owners been consolidated by communitization, unitization, force-pooling, etc?

☐ Yes ☐ No If answer is "yes," type of consolidation Communitization

If answer is "no," list the owners and tract descriptions which have actually been consolidated. (Use reverse side of this form if necessary.) _____

No allowable will be assigned to the well until all interests have been consolidated (by communitization, unitization, forced-pooling, or otherwise) or until a non-standard unit, eliminating such interests, has been approved by the Commission.

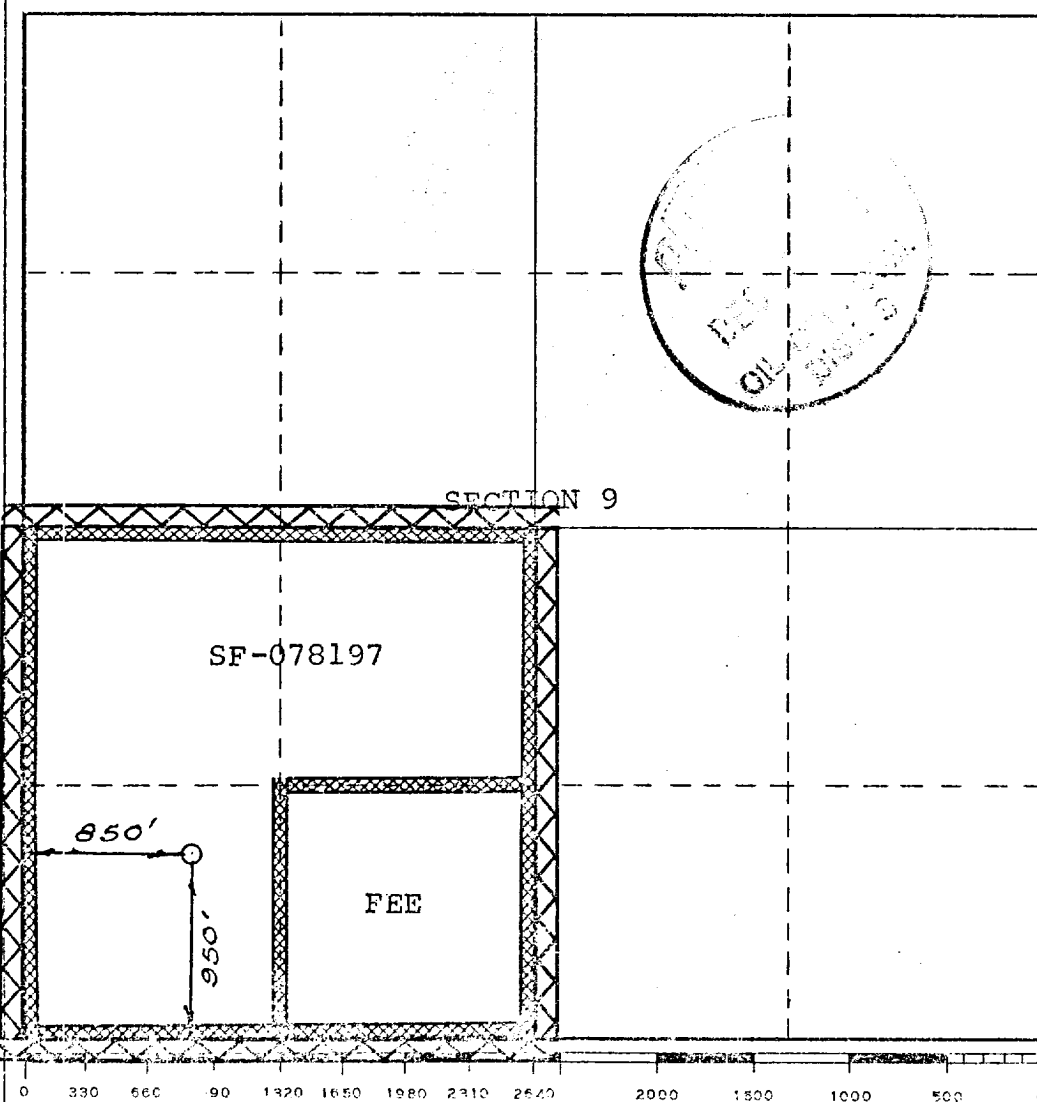

CERTIFICATION

I hereby certify that the information contained herein is true and complete to the best of my knowledge and belief.

Original Signed by

Name **D. G. Briscoe**
Position **Drilling Clerk**
El Paso Natural Gas Co.

Company
January 12, 1974

Date

I hereby certify that the well location shown on this plat was plotted from field notes of actual surveys made by me or under my supervision, and that the same is true and correct to the best of my knowledge and belief.

Date Surveyed
JULY 18, 1974

Registered Professional Engineer
and/or Land Surveyor

Certificate No. **1760**

LOCATION AND EQUIPMENT LAY-OUT

NVE No. 13

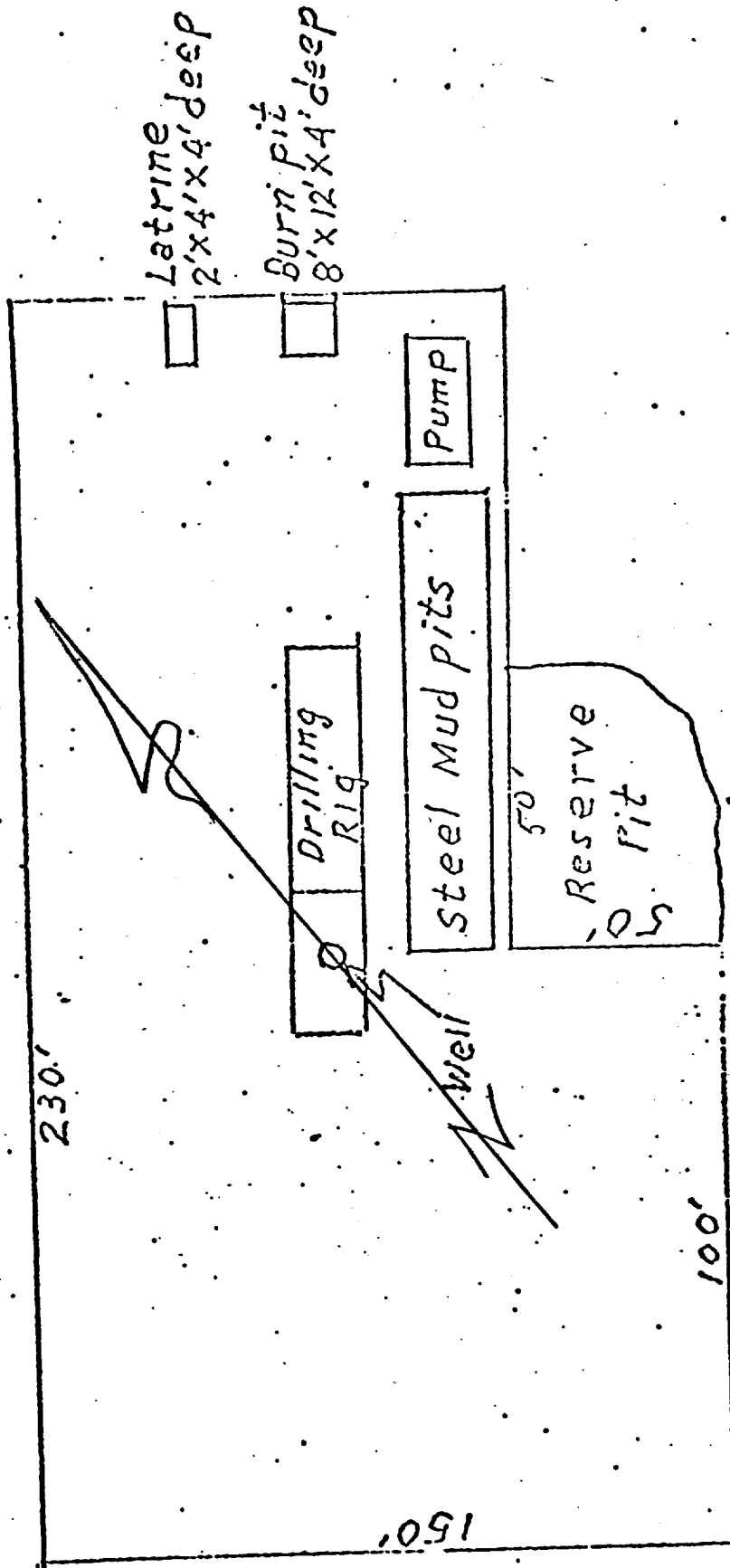

Map #13

SN SN/1 Sec. 9, T-29-N, R-10-W

K-10-N

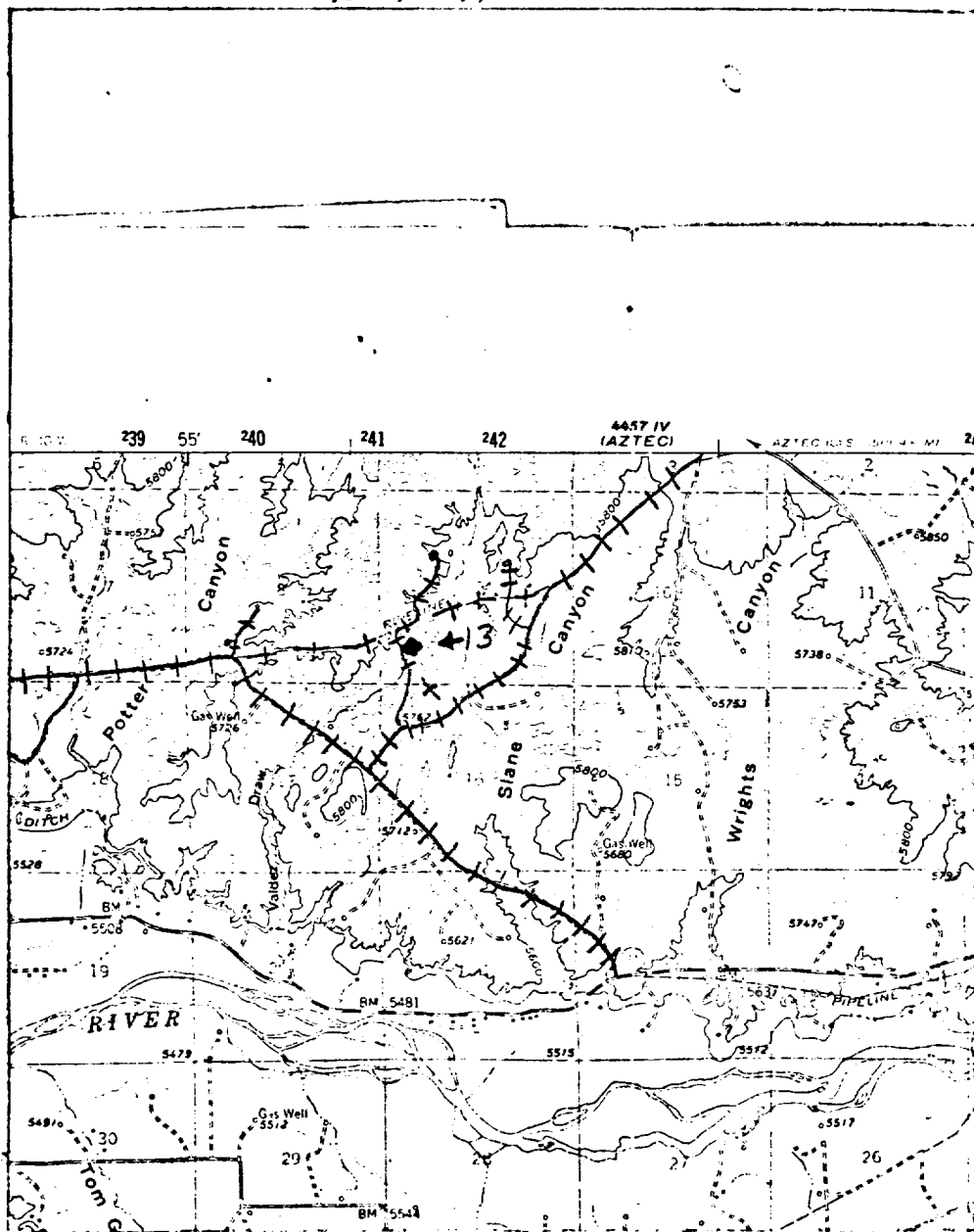

LEGEND OF RIGHT-OF-WAYS

EXISTING ROADS	_____
EXISTING PIPELINES	+ + +
EXISTING ROAD & PIPELINE	+ + + +
PROPOSED ROADS	_____
PROPOSED PIPELINES	+ + + +
PROPOSED ROAD & PIPELINE	+ + + + +

El Paso Natural Gas Company

El Paso, Texas 79978

December 12, 1974

ADDRESS REPLY TO
POST OFFICE BOX 890
FARMINGTON, NEW MEXICO 87401

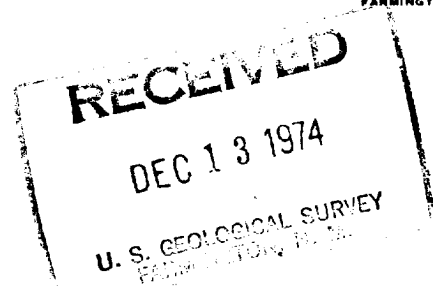

Mr. P. T. McGrath
U. S. Geological Survey
Post Office Box 959
Farmington, New Mexico 87401

Re: Application for Permit to Drill
Nye #13
SWSW/4 Section 9, T-29-N, R-10-W
Fruitland

Dear Mr. McGrath:

Details regarding existing roads, pipelines, wells, etc. relative to the above well location are included on the previously submitted base maps, "Field Road Map" and "Composite Map No. 1".

The proposed new well location, new roads and new pipeline are shown on the attached plat along with connecting existing roads and pipelines in the vicinity of the proposed new well.

Water for drilling and completion operations will be obtained from the following location: an irrigation ditch located in the SE/4, Section 13, T-29-N, R-11-W.

Waste material will be disposed of by burial in the burn pit, latrine, or reserve pit as applicable. There will be no camp nor air strip associated with drilling this well. Upon completion or abandonment of this well, the location will be cleaned and leveled and a dry hole marker placed, if applicable.

Yours very truly,

D. G. Brisco
Drilling Clerk

pb