

UNITED STATES
DEPARTMENT OF THE INTERIOR
GEOLOGICAL SURVEY

30-045-21627

APPLICATION FOR PERMIT TO DRILL, DEEPEN, OR PLUG BACK

5. LEASE DESIGNATION AND SERIAL NO.
SF 078266

6. IF INDIAN, ALLOTTEE OR TRIBE NAME

7. UNIT AGREEMENT NAME

8. FARM OR LEASE NAME
Hubbell

9. WELL NO.
17

10. FIELD AND POOL, OR WILDCAT
Aztec Fruitland

11. SEC., T., R., M., OR BLK. AND SURVEY OR AREA
Sec. 20, T-29-N, R-10-W
NMPM

12. COUNTY OR PARISH
San Juan

13. STATE
NM

14. DISTANCE IN MILES AND DIRECTION FROM NEAREST TOWN OR POST OFFICE*
At proposed prod. zone 800'N, 800'E

15. DISTANCE FROM PROPOSED* LOCATION TO NEAREST PROPERTY OR LEASE LINE, FT. (Also to nearest drlg. unit line, if any)

16. NO. OF ACRES IN LEASE

17. NO. OF ACRES ASSIGNED TO THIS WELL
160

18. DISTANCE FROM PROPOSED LOCATION* TO NEAREST WELL, DRILLING, COMPLETED, OR APPLIED FOR, ON THIS LEASE, FT.

19. PROPOSED DEPTH
1900'

20. ROTARY OR CABLE TOOLS
Rotary

21. ELEVATIONS (Show whether DF, RT, GR, etc.)
5694'

22. APPROX. DATE WORK WILL START*

23. PROPOSED CASING AND CEMENTING PROGRAM

SIZE OF HOLE	SIZE OF CASING	WEIGHT PER FOOT	SETTING DEPTH	QUANTITY OF CEMENT
12 1/4"	8 5/8"	24.0#	100'	105 cu. ft. to circulate
6 3/4"	2 7/8"	6.4#	1900'	310 cu. ft. to cover Ojo Alamo

Selectively perforate and sandwater fracture the Fruitland formation.

Surface is patented and owner approval has been secured.

The NE/4 Section 20 is dedicated to this well.

DEC 16 1974

IN ABOVE SPACE DESCRIBE PROPOSED PROGRAM: If proposal is to deepen or plug back, give data on present productive zone and proposed new productive zone. If proposal is to drill or deepen directionally, give pertinent data on subsurface locations and measured and true vertical depths. Give blowout preventer program, if any.

24. SIGNED A. J. Luico TITLE Drilling Clerk DATE December 13, 1974

(This space for Federal or State office use)

PERMIT NO. _____ APPROVAL DATE _____

APPROVED BY CU TITLE _____ DATE _____

CONDITIONS OF APPROVAL, IF ANY:

NEW MEXICO OIL CONSERVATION COMMISSION
WELL LOCATION AND ACREAGE DEDICATION PLAT

Form C-102
Supersedes C-128
Effective 1-1-65

All distances must be from the outer boundaries of the Section.

for EL PASO NATURAL GAS CO.		Lease HUBBELL (SF 078266)		Well No. 17
Unit Letter A	Section 20	Township 29-N	Range 10-W	County SAN JUAN
Actual Footage Location of Well: 800 feet from the NORTH line and 800 feet from the EAST line				
Ground Level Elev. 5694	Producing Formation FRUITLAND	Pool AZTEC FRUITLAND	Dedicated Acreage 160 Acres	

1. Outline the acreage dedicated to the subject well by colored pencil or hachure marks on the plat below.
2. If more than one lease is dedicated to the well, outline each and identify the ownership thereof (both as to working interest and royalty).
3. If more than one lease of different ownership is dedicated to the well, have the interests of all owners been consolidated by communitization, unitization, force-pooling, etc?

Yes No If answer is "yes," type of consolidation _____

If answer is "no," list the owners and tract descriptions which have actually been consolidated. (Use reverse side of this form if necessary.) _____

No allowable will be assigned to the well until all interests have been consolidated (by communitization, unitization, forced-pooling, or otherwise) or until a non-standard unit, eliminating such interests, has been approved by the Commission.

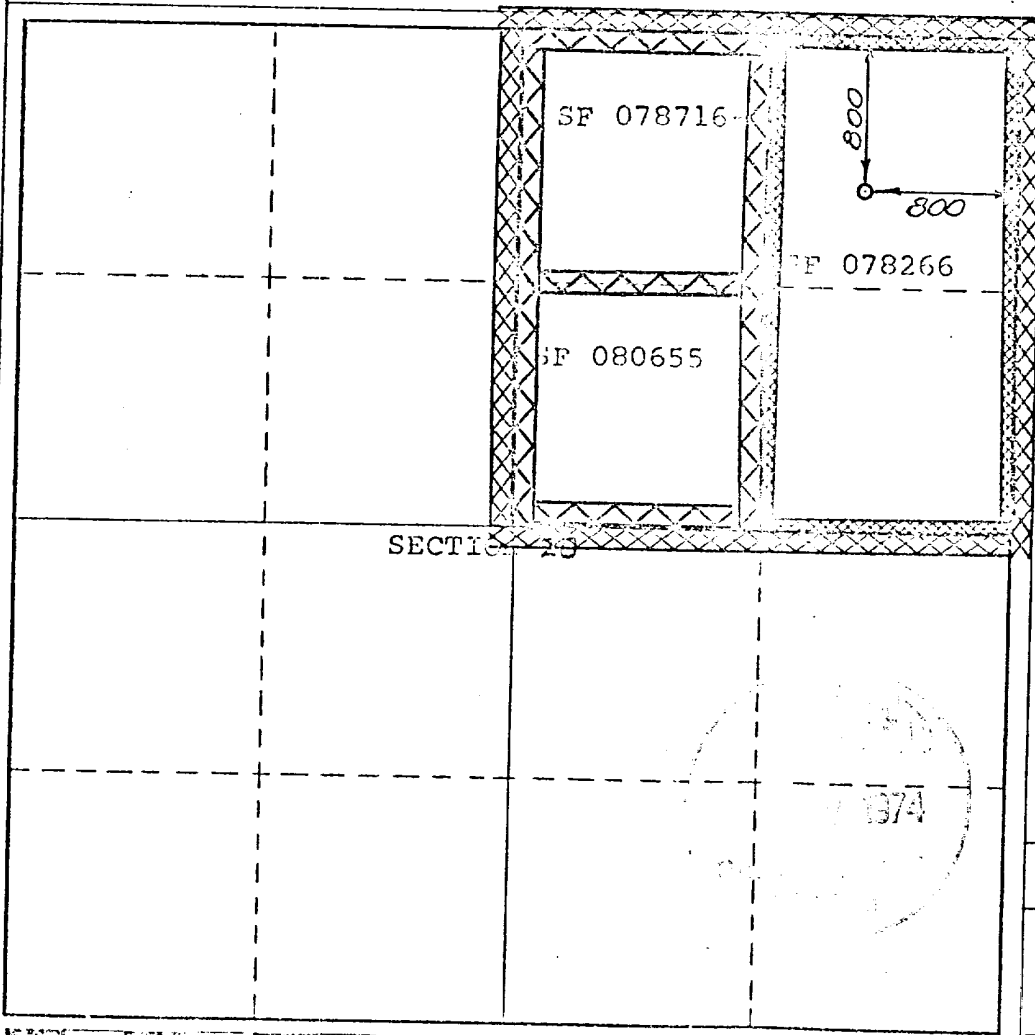

CERTIFICATION

I hereby certify that the information contained herein is true and complete to the best of my knowledge and belief.

M. G. Buias
Name
Drilling Clerk
Position
El Paso Natural Gas Co.
Company
December 13, 1974
Date

I hereby certify that the well location shown on this plat was plotted from field notes of actual surveys made by me or under my supervision, and that the same is true and correct to the best of my knowledge and belief.

Date Surveyed
AUGUST 2, 1974
Registered Professional Engineer and/or Land Surveyor

Certificate No.
1760

