

UNITED STATES  
DEPARTMENT OF THE INTERIOR  
GEOLOGICAL SURVEY

30-045-21630

## APPLICATION FOR PERMIT TO DRILL, DEEPEN, OR PLUG BACK

## 1a. TYPE OF WORK

DRILL ☒DEEPEN ☐PLUG BACK ☐

## b. TYPE OF WELL

OIL  
WELL ☒GAS  
WELL ☐

OTHER

SINGLE  
ZONE ☐MULTIPLE  
ZONE ☐

## 2. NAME OF OPERATOR

Walter Duncan

## 3. ADDRESS OF OPERATOR

Box 234, Farmington, New Mexico 87401

## 4. LOCATION OF WELL (Report location clearly and in accordance with any State requirements.\*)

At surface

2400' FSL — 2350' FEL

At proposed prod. zone

## 14. DISTANCE IN MILES AND DIRECTION FROM NEAREST TOWN OR POST OFFICE\*

8 miles east southeast of Shiprock, New Mexico

## 15. DISTANCE FROM PROPOSED\*

LOCATION TO NEAREST  
PROPERTY OR LEASE LINE, FT.  
(Also to nearest drlg. unit line, if any)

2350'

## 16. NO. OF ACRES IN LEASE

640

17. NO. OF ACRES ASSIGNED  
TO THIS WELL

2172 40

## 18. DISTANCE FROM PROPOSED LOCATION\*

TO NEAREST WELL, DRILLING, COMPLETED,  
OR APPLIED FOR, ON THIS LEASE, FT.

620' approx

## 19. PROPOSED DEPTH

700'

## 20. ROTARY OR CABLE TOOLS

Cable tool surface casing  
Rotary btm surface csq to TD

## 21. ELEVATIONS (Show whether DF, RT, GR, etc.)

4982' GR

## 22. APPROX. DATE WORK WILL START\*

1-15-75

## 23.

## PROPOSED CASING AND CEMENTING PROGRAM

SIZE OF HOLE	SIZE OF CASING	WEIGHT PER FOOT	SETTING DEPTH	QUANTITY OF CEMENT
9"	7"	20#	30'	5 sx
6-1/4"	4-1/2"	10.5#	680'	75 sx

1. Drive 7" casing thru boulders and cement with 5 sx cement.
2. Drill 6-1/4" hole to top of Dakota sand at approximately 680'.
3. Run 4-1/2" casing and cement to surface with 75 sx cement.
4. Drill 3-7/8" hole below 4-1/2" casing to approximately 700'.
5. Complete well in open hole without stimulation of Dakota sand.
6. Run 2-3/8" tubing to 695'.

IN ABOVE SPACE DESCRIBE PROPOSED PROGRAM: If proposal is to deepen or plug back, give data on present productive zone and proposed new productive zone. If proposal is to drill or deepen directionally, give pertinent data on subsurface locations and measured and true vertical depths. Give blowout preventer program, if any.

## 24.

SIGNED Original signed by T. A. Dugan TITLE Petroleum Engineer DATE 1-2-75  
Thomas A. Dugan

(This space for Federal or State office use)

PERMIT NO. \_\_\_\_\_ APPROVAL DATE \_\_\_\_\_

APPROVED BY TA TITLE \_\_\_\_\_ DATE \_\_\_\_\_  
 CONDITIONS OF APPROVAL, IF ANY:

**NEW MEXICO OIL CONSERVATION COMMISSION  
WELL LOCATION AND ACREAGE DEDICATION PLAT**

Form C-102  
Supersedes C-128  
Effective 1-1-65

All distances must be from the outer boundaries of the Section.

Operator <b>Walter Duncan</b>			Lease <b>North Hogback</b>		Well No. <b>1-10</b>
Unit Letter <b>J</b>	Section <b>1</b>	Township <b>20 North</b>	Range <b>17 West</b>	County <b>San Juan</b>	
Actual Footage Location of Well: <b>2400</b> feet from the <b>South</b> line and <b>2350</b> feet from the <b>East</b> line					
Ground Level Elev. <b>4982'</b>	Producing Formation <b>Dakota</b>		Pool <b>Slickrock</b>		Dedicated Acreage: <b>40</b> Acres

1. Outline the acreage dedicated to the subject well by colored pencil or hachure marks on the plat below.
2. If more than one lease is dedicated to the well, outline each and identify the ownership thereof (both as to working interest and royalty).
3. If more than one lease of different ownership is dedicated to the well, have the interests of all owners been consolidated by communitization, unitization, force-pooling, etc?

☐ Yes    ☐ No    If answer is "yes," type of consolidation \_\_\_\_\_

If answer is "no," list the owners and tract descriptions which have actually been consolidated. (Use reverse side of this form if necessary.) \_\_\_\_\_

No allowable will be assigned to the well until all interests have been consolidated (by communitization, unitization, forced-pooling, or otherwise) or until a non-standard unit, eliminating such interests, has been approved by the Commission.

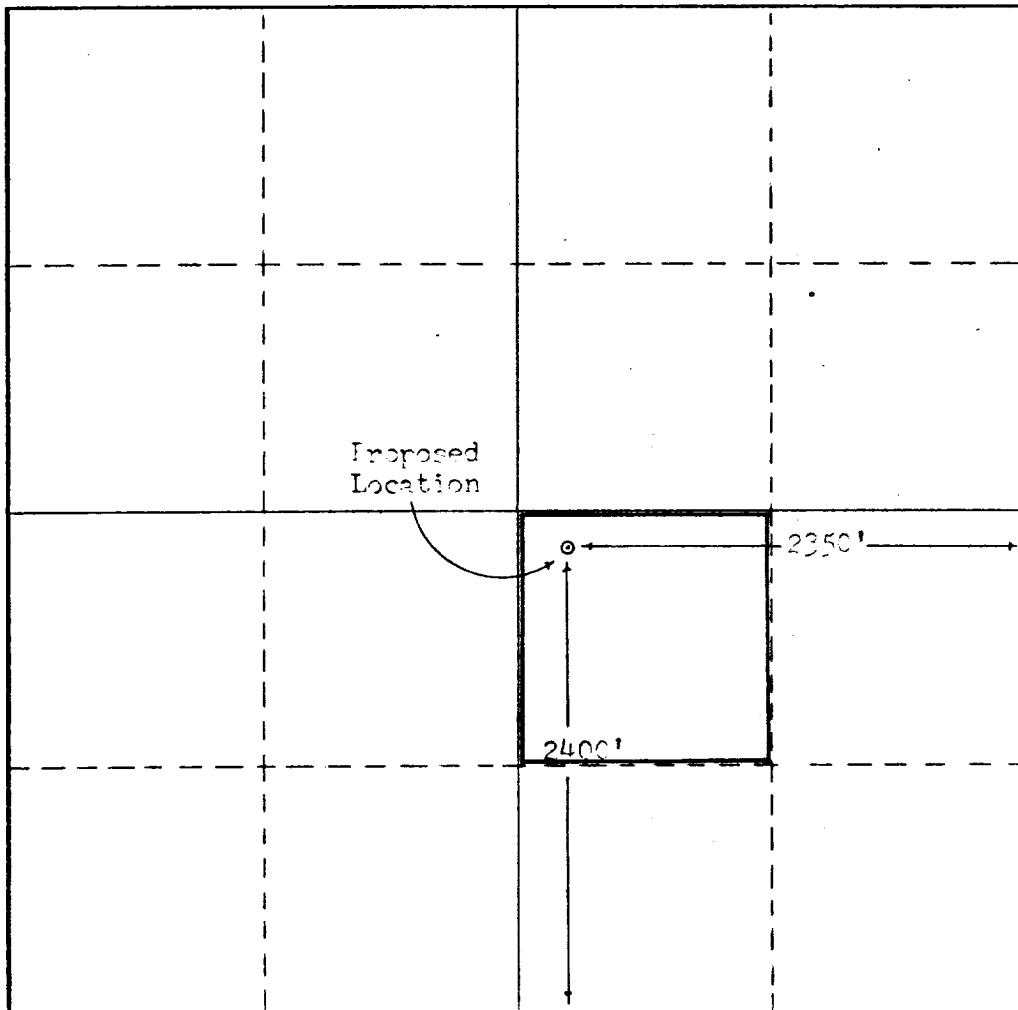

**CERTIFICATION**

*I hereby certify that the information contained herein is true and complete to the best of my knowledge and belief.*

**Original signed by T. A. Dugan**

Name <b>Thomas A. Dugan</b>
Position <b>Petroleum Engineer</b>
Company <b>Walter Duncan</b>
Date <b>1-2-75</b>

*I hereby certify that the well location shown on this plat was plotted from field notes of actual surveys made by me or under my supervision, and that the same is true and correct to the best of my knowledge and belief.*

Date Surveyed <b>December 20, 1974</b>
<b>Frederick H. Reed</b> Registered Professional Engineer and Land Surveyor
<i>Frederick H. Reed</i>
Certificate No. <b>2775</b>