

30-045-21664

UNITED STATES  
DEPARTMENT OF THE INTERIOR  
GEOLOGICAL SURVEY

## APPLICATION FOR PERMIT TO DRILL, DEEPEN, OR PLUG BACK

## 1a. TYPE OF WORK

DRILL ☒DEEPEN ☐PLUG BACK ☐

## b. TYPE OF WELL

OIL  
WELL ☐GAS  
WELL ☒

OTHER

SINGLE  
ZONE ☒MULTIPLE  
ZONE ☐

## 2. NAME OF OPERATOR

El Paso Natural Gas Company

## 3. ADDRESS OF OPERATOR

PO Box 990, Farmington, NM 87401

## 4. LOCATION OF WELL (Report location clearly and in accordance with any State requirements.\*)

At surface

790'S, 790'E

At proposed prod. zone

## 14. DISTANCE IN MILES AND DIRECTION FROM NEAREST TOWN OR POST OFFICE\*

## 15. DISTANCE FROM PROPOSED\*

LOCATION TO NEAREST  
PROPERTY OR LEASE LINE, FT.  
(Also to nearest drlg. unit line, if any)

## 18. DISTANCE FROM PROPOSED LOCATION\*

TO NEAREST WELL, DRILLING, COMPLETED,  
OR APPLIED FOR, ON THIS LEASE, FT.

## 16. NO. OF ACRES IN LEASE

## 19. PROPOSED DEPTH

5530'

17. NO. OF ACRES ASSIGNED  
TO THIS WELL

284.20

## 20. ROTARY OR CABLE TOOLS

Rotary

## 21. ELEVATIONS (Show whether DF, RT, GR, etc.)

6098'GL

## 22. APPROX. DATE WORK WILL START\*

## 23. PROPOSED CASING AND CEMENTING PROGRAM

SIZE OF HOLE	SIZE OF CASING	WEIGHT PER FOOT	SETTING DEPTH	QUANTITY OF CEMENT
13 3/4"	9 5/8"	32.3#	200'	225 cu. ft. to circulate
8 3/4"	7"	20.0#	3285'	334 cu. ft. to cover Ojo Alamo
6 1/4"	4 1/2"	10.5#	3135-5530'	417 cu. ft. to circulate liner

Selectively perforate and sandwater fracture the Mesa Verde formation.

The E/2 of Section 14 is dedicated to this well.

IN ABOVE SPACE DESCRIBE PROPOSED PROGRAM: If proposal is to deepen or plug back, give data on present productive zone and proposed new productive zone. If proposal is to drill or deepen directionally, give pertinent data on subsurface locations and measured and true vertical depths. Give blowout preventer program, if any.

24.

SIGNED

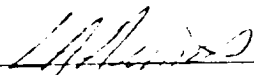

TITLE

Drilling Engineer

DATE January 9, 1975

(This space for Federal or State office use)

PERMIT NO.

APPROVAL DATE

APPROVED BY



TITLE

DATE

CONDITIONS OF APPROVAL, IF ANY:

\*See Instructions On Reverse Side

**NEW MEXICO OIL CONSERVATION COMMISSION  
WELL LOCATION AND ACREAGE DEDICATION PLAT**

Form C-102  
Supersedes C-128  
Effective 1-1-65

All distances must be from the outer boundaries of the Section.

Operator <b>El Paso Natural Gas Company</b>			Lease <b>Howell E (NM-012708)</b>		Well No. <b>20A</b>
Unit Letter <b>P</b>	Section <b>14</b>	Township <b>30N</b>	Range <b>8W</b>	County <b>San Juan</b>	

Actual Footage Location of Well:

<b>790</b>	feet from the	<b>South</b>	line and	<b>790</b>	feet from the	<b>East</b>	line
Ground Level Elev. <b>6098</b>	Producing Formation <b>Mesa Verde</b>		Pool <b>Blanco Mesa Verde</b>		Dedicated Acreage <b>284.20</b>		
						Acres	

1. Outline the acreage dedicated to the subject well by colored pencil or hachure marks on the plat below.
2. If more than one lease is dedicated to the well, outline each and identify the ownership thereof (both as to working interest and royalty).
3. If more than one lease of different ownership is dedicated to the well, have the interests of all owners been consolidated by communitization, unitization, force-pooling, etc?

☐ Yes ☐ No If answer is "yes," type of consolidation \_\_\_\_\_

If answer is "no," list the owners and tract descriptions which have actually been consolidated. (Use reverse side of this form if necessary.) \_\_\_\_\_

No allowable will be assigned to the well until all interests have been consolidated (by communitization, unitization, forced-pooling, or otherwise) or until a non-standard unit, eliminating such interests, has been approved by the Commission.

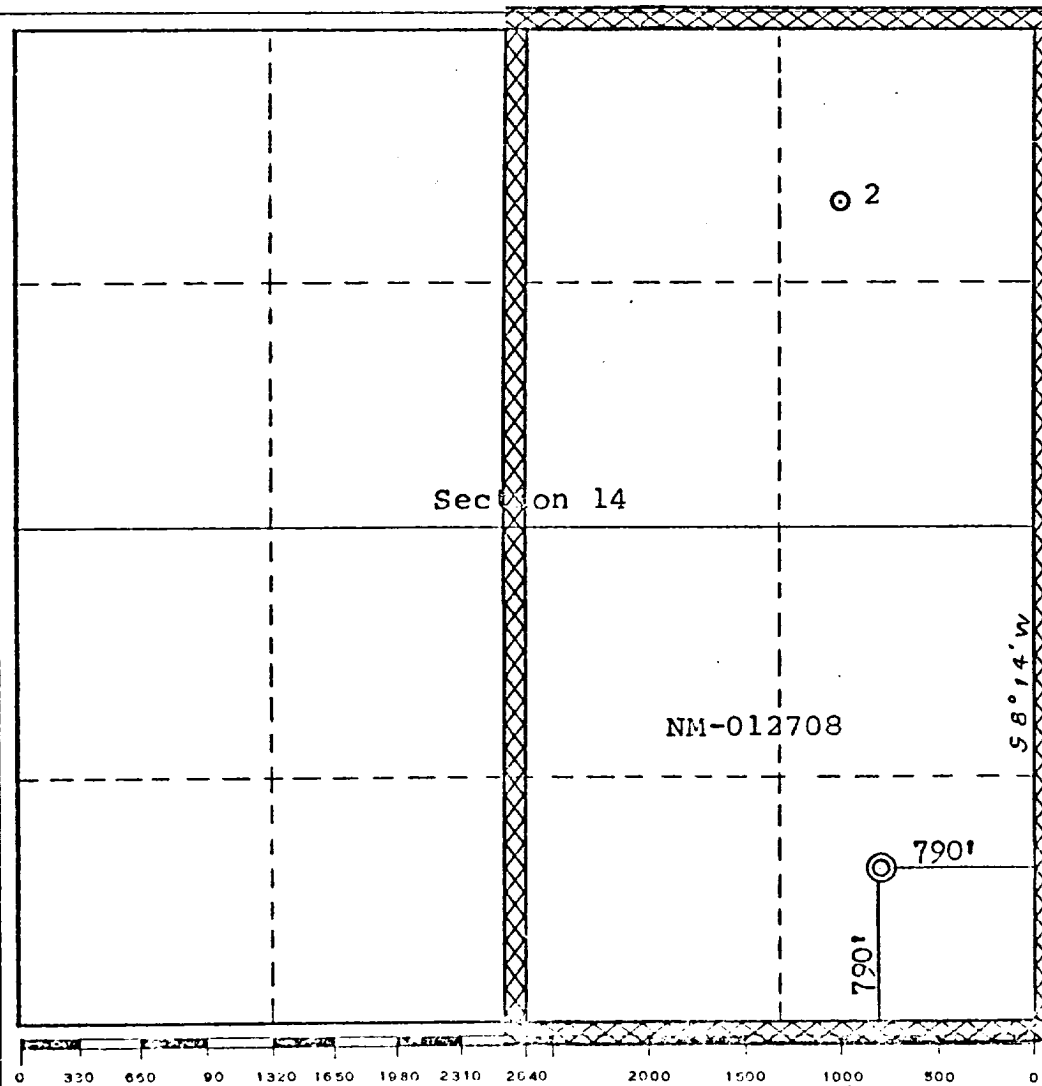

**CERTIFICATION**

I hereby certify that the information contained herein is true and complete to the best of my knowledge and belief.

*L.A. Alvarado*  
Name

**Drilling Engineer**  
Position

**El Paso Natural Gas Co.**  
Company

**January 9, 1975**  
Date

I hereby certify that the well location shown on this plat was plotted from field notes of actual surveys made by me or under my supervision, and that the same is true and correct to the best of my knowledge and belief.

Date Surveyed  
**December 17, 1974**

Registered Professional Engineer  
and/or Land Surveyor

*Fred B. Kerr, Jr.*  
**Fred B. Kerr, Jr.**

Certificate No.

**3950**

HOWELL E No 2A

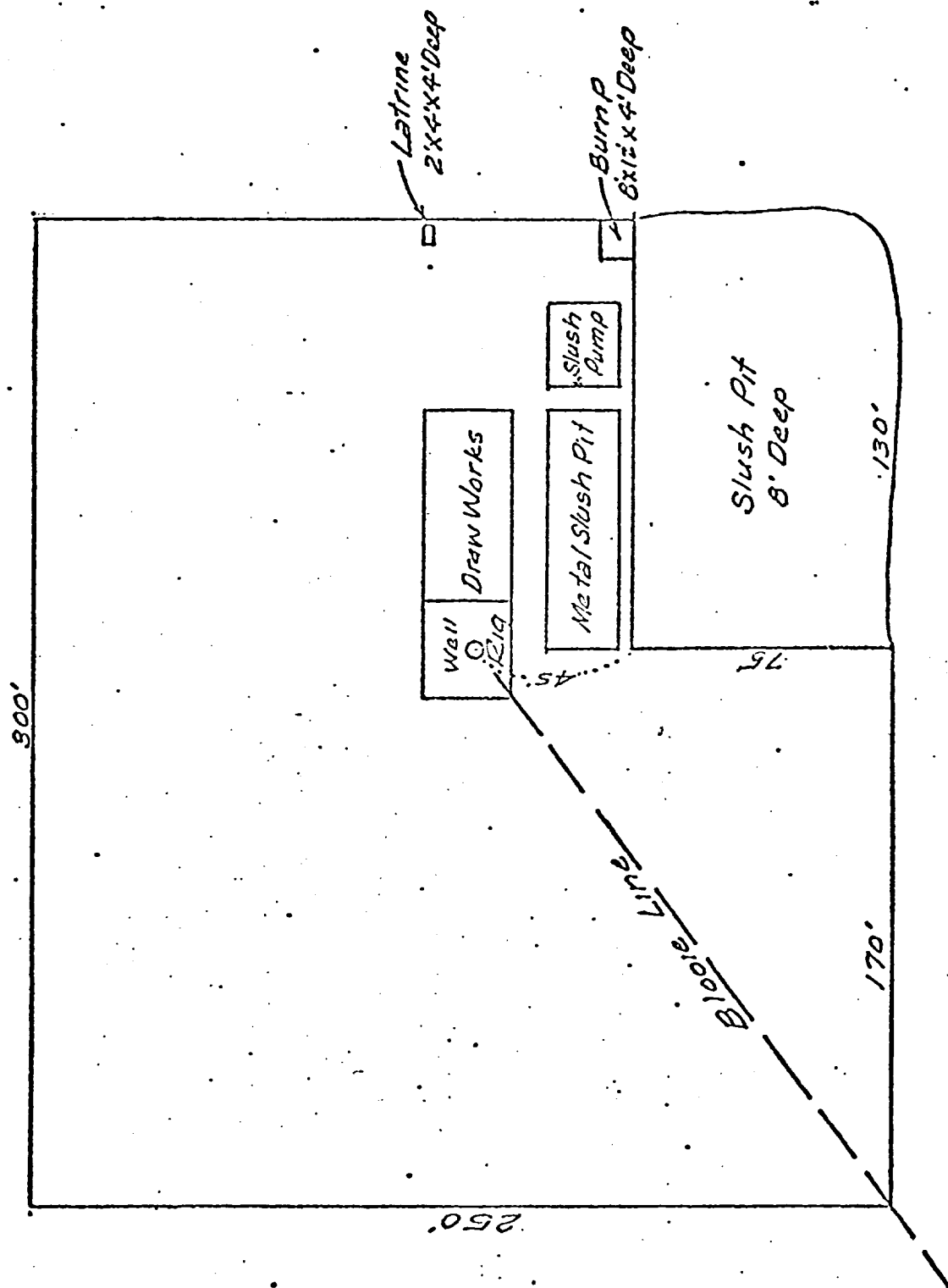

Hewell E # 2 ~~BA~~  
 AC SE/4 Sec. 11, T-30-N, R-8-W

R-8-W

T  
 30  
 N

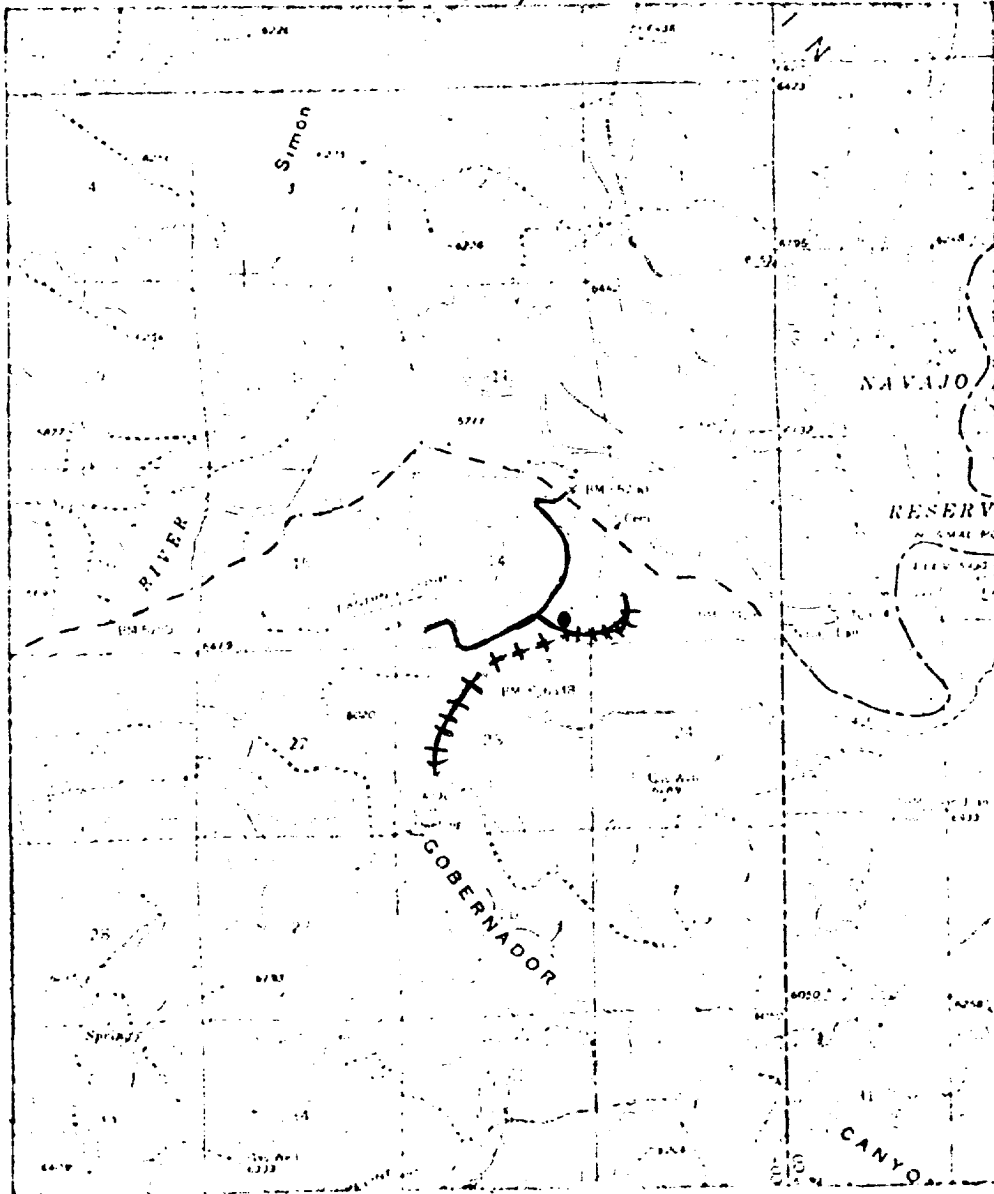

LEGEND OF RIGHT-OF-WAYS

EXISTING ROADS	—
EXISTING PIPELINES	— + — + —
EXISTING ROAD & PIPELINE	— + — + —
PROPOSED ROADS	—
PROPOSED PIPELINES	— + + + —
PROPOSED ROAD & PIPELINE	— + + + —

# El Paso Natural Gas Company

El Paso, Texas 79974

January 9, 1975

ADDRESS REPLY TO  
POST OFFICE BOX 959  
FARMINGTON NEW MEXICO 87401

JAN 9 1975

U. S. GEOLOGICAL SURVEY

Mr. P. T. McGrath  
U. S. Geological Survey  
Post Office Box 959  
Farmington, New Mexico 87401

Re: Application for Permit to Drill  
Howell E #2A  
SE/4 Section 14, T-30-N, R-8-W  
Blanco Mesa Verde

Dear Mr. McGrath:

Details regarding existing roads, pipelines, wells, etc. relative to the above well location are included on the previously submitted base maps, "Field Road Map" and "Composite Map No. 1".

The proposed new well location, new roads and new pipeline are shown on the attached plat along with connecting existing roads and pipelines in the vicinity of the proposed new well.

Water for drilling and completion operations will be obtained from the following location: Manzaneras Mesa Water Well #1, SESW 9-29-8.

Waste material will be disposed of by burial in the burn pit, latrine, or reserve pit as applicable. There will be no camp nor air strip associated with drilling this well. Upon completion or abandonment of this well, the location will be cleaned and leveled and a dry hole marker placed, if applicable.

Yours very truly,



D. G. Brisco  
Drilling Clerk

pb