

UNITED STATES
DEPARTMENT OF THE INTERIOR
GEOLOGICAL SURVEY

30-045-21677

5. LEASE DESIGNATION AND SERIAL NO.

NM 03486-A

6. IF INDIAN, ALLOTTEE OR TRIBE NAME

7. UNIT AGREEMENT NAME

8. FARM OR LEASE NAME

Lloyd A

9. WELL NO.

3

10. FIELD AND POOL, OR WILDCAT
Aztec Pictured Cliffs Ext.
Undesignated Chacra11. SEC., T., R., M., OR BLK.
AND SURVEY OR AREASec. 9, T-29-N, R-11-W
NMPM

12. COUNTY OR PARISH 13. STATE

San Juan

NM

APPLICATION FOR PERMIT TO DRILL, DEEPEN, OR PLUG BACK

1a. TYPE OF WORK

DRILL ☒DEEPEN ☐PLUG BACK ☐

b. TYPE OF WELL

OIL
WELL ☐GAS
WELL ☒

OTHER

SINGLE
ZONE ☐MULTIPLE
ZONE ☒

2. NAME OF OPERATOR

El Paso Natural Gas Company

3. ADDRESS OF OPERATOR

PO Box 990, Farmington, NM 87401

4. LOCATION OF WELL (Report location clearly and in accordance with any State requirements.)
At surface

1530'N, 1100'E

At proposed prod. zone

14. DISTANCE IN MILES AND DIRECTION FROM NEAREST TOWN OR POST OFFICE*

15. DISTANCE FROM PROPOSED*

LOCATION TO NEAREST
PROPERTY OR LEASE LINE, FT.
(Also to nearest drlg. unit line, if any)

16. NO. OF ACRES IN LEASE

17. NO. OF ACRES ASSIGNED
TO THIS WELL

160.00 \$ 160

18. DISTANCE FROM PROPOSED LOCATION*
TO NEAREST WELL, DRILLING, COMPLETED,
OR APPLIED FOR, ON THIS LEASE, FT.

19. PROPOSED DEPTH

3210'

20. ROTARY OR CABLE TOOLS

Rotary

21. ELEVATIONS (Show whether DF, RT, GR, etc.)

5805'GL

22. APPROX. DATE WORK WILL START*

23. PROPOSED CASING AND CEMENTING PROGRAM

SIZE OF HOLE	SIZE OF CASING	WEIGHT PER FOOT	SETTING DEPTH	QUANTITY OF CEMENT
13 3/4"	9 5/8"	32.3#	120'	120 cu. ft. to circulate
8 3/4"	2 7/8"	6.4#	2225'	760 cu. ft. to cover Ojo Alamo
6 3/4"		6.4#	3210'	290 cu. ft. to cover Lewis

Selectively perforate and sandwater fracture the Chacra and Pictured Cliffs formation.

The NE/4 of Section 9 is dedicated to this well.

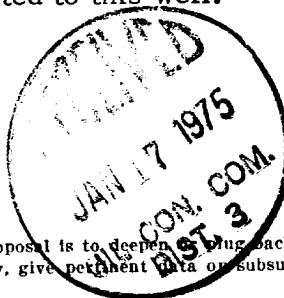

JAN 16 1975

U. S. GEOLOGICAL SURVEY

IN ABOVE SPACE DESCRIBE PROPOSED PROGRAM: If proposal is to deepen or plug back, give data on present productive zone and proposed new productive zone. If proposal is to drill or deepen directionally, give pertinent data on subsurface locations and measured and true vertical depths. Give blowout preventer program, if any.

24.

SIGNED

A. J. Suarez

TITLE

Drilling Clerk

DATE January 16, 1975

(This space for Federal or State office use)

PERMIT NO.

APPROVAL DATE

APPROVED BY

TITLE

DATE

CONDITIONS OF APPROVAL, IF ANY:

OK

*See Instructions On Reverse Side

NEW MEXICO OIL CONSERVATION COMMISSION
WELL LOCATION AND ACREAGE DEDICATION PLAT

Form C-102
Supersedes C-128
Effective 1-1-65

All distances must be from the outer boundaries of the Section.

Operator EL PASO NATURAL GAS COMPANY			Lease LLOYD A (NM-03486-A)		Well No. 3
Unit Letter H	Section 9	Township 29-N	Range 11-W	County SAN JUAN	
Actual Footage Location of Well: 1530 feet from the NORTH line and 1100 feet from the EAST line					
Ground Level Elev. 5805	Producing Formation PICTURED CLIFFS-CHACRA		Pool UNDESIGNATED CHACRA AZTEC PICTURED CLIFFS EXT.	Dedicated Acreage: <input checked="" type="checkbox"/> 160.0 & 160.0 Acres	

1. Outline the acreage dedicated to the subject well by colored pencil or hachure marks on the plat below.
2. If more than one lease is dedicated to the well, outline each and identify the ownership thereof as to working interest and royalty).
3. If more than one lease of different ownership is dedicated to the well, have the interests of the owners been consolidated by communitization, unitization, force-pooling, etc?
☐ Yes ☐ No If answer is "yes," type of consolidation _____

If answer is "no," list the owners and tract descriptions which have actually been consolidated. (Use reverse side of this form if necessary.) _____
 No allowable will be assigned to the well until all interests have been consolidated (by communitization, unitization, forced-pooling, or otherwise) or until a non-standard unit, eliminating such interests, has been approved by the Commission.

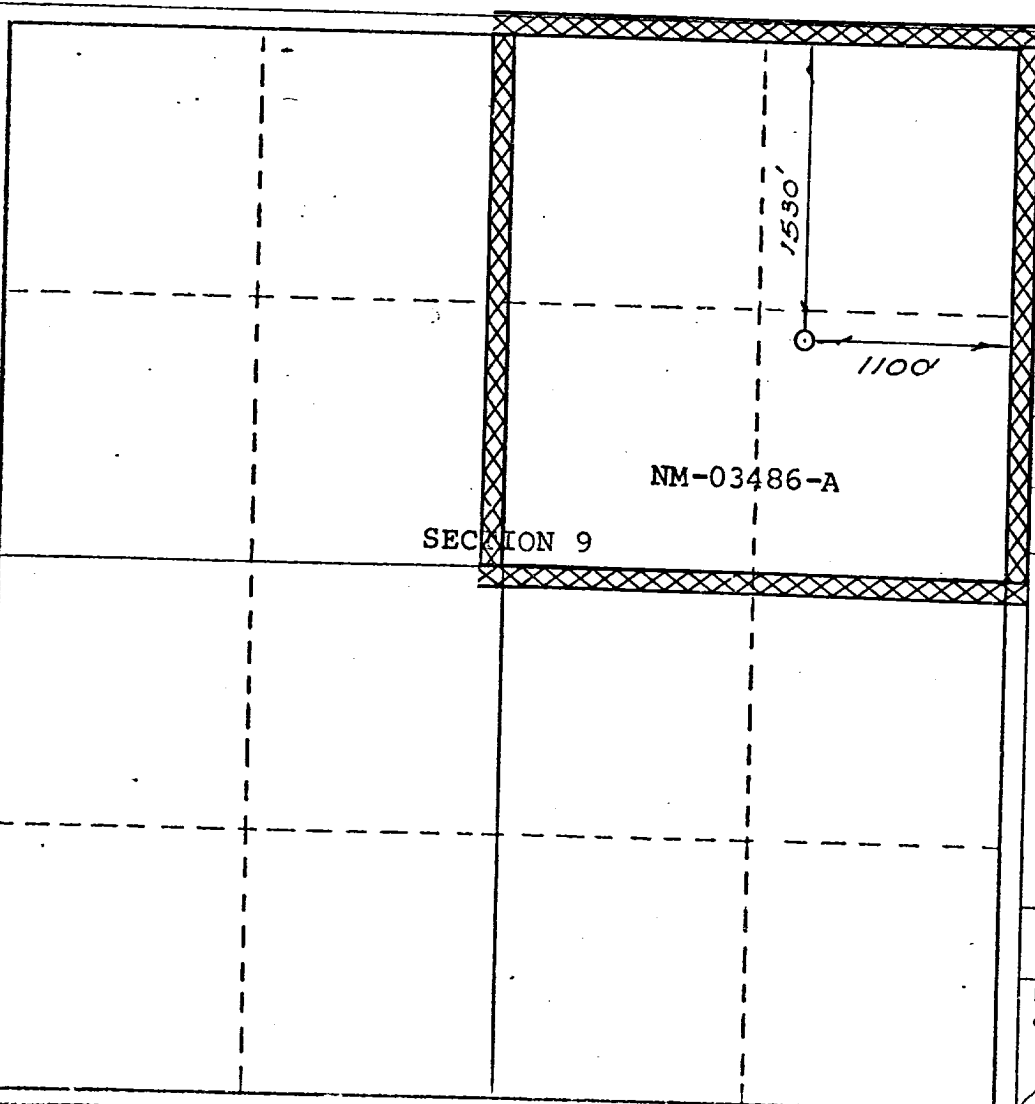
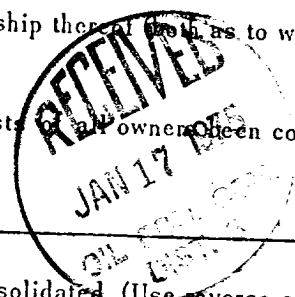

CERTIFICATION	
I hereby certify that the information contained herein is true and complete to the best of my knowledge and belief.	
Original Signed by D. G. Brisco	
Name	Drilling Clerk
Position	El Paso Natural Gas Co.
Company	January 10, 1975
Date	
I hereby certify that the well location shown on this plat was plotted from field notes of actual surveys made by me or under my supervision, and that the same is true and correct to the best of my knowledge and belief.	
Date Surveyed	OCTOBER 29, 1974
Registered Professional Engineer and/or Land Surveyor <i>[Signature]</i>	
Certificate No.	1760

