

UNITED STATES  
DEPARTMENT OF THE INTERIOR  
GEOLOGICAL SURVEY

30-045-21887

5. LEASE DESIGNATION AND SERIAL NO.

14-20-0603-10010

6. IF INDIAN, ALLOTTEE OR TRIBE NAME

Navajo

7. UNIT AGREEMENT NAME

8. FARM OR LEASE NAME

North Hogback 6

9. WELL NO.

11

10. FIELD AND FOOT, OR WILDCAT

Slickrock Dakota

11. SEC., T., R., M., OR BLK.  
AND SURVEY OR AREA

Sec 6, T29N, R16W

12. COUNTY OR PARISH 13. STATE

San Juan

NM

1a. TYPE OF WORK

DRILL ☒DEEPEN ☐PLUG BACK ☐

b. TYPE OF WELL

OIL  
WELL ☒GAS  
WELL ☐

OTHER

SINGLE  
ZONE ☐MULTIPLE  
ZONE ☐

2. NAME OF OPERATOR

Walter Duncan

3. ADDRESS OF OPERATOR

Box 234, Farmington, NM 87401

4. LOCATION OF WELL (Report location clearly and in accordance with any State requirements.\*)

At surface

50' FSL - 50' FWL

At proposed prod. zone

14. DISTANCE IN MILES AND DIRECTION FROM NEAREST TOWN OR POST OFFICE\*

8 miles east-southeast of Shiprock, NM

15. DISTANCE FROM PROPOSED\*

LOCATION TO NEAREST  
PROPERTY OR LEASE LINE, FT.

(Also to nearest drig. unit line, if any)

50'

16. NO. OF ACRES IN LEASE

640

17. NO. OF ACRES ASSIGNED  
TO THIS WELL

2-1/2

18. DISTANCE FROM PROPOSED LOCATION\*

TO NEAREST WELL, DRILLING, COMPLETED,  
OR APPLIED FOR, ON THIS LEASE, FT.

560'

19. PROPOSED DEPTH

690'

20. ROTARY OR CABLE TOOLS

Cable 0-20'

Rotary 20-690'

21. ELEVATIONS (Show whether DF, RT, GR, etc.)

4984' GR

22. APPROX. DATE WORK WILL START\*

9-20-75

23.

## PROPOSED CASING AND CEMENTING PROGRAM

SIZE OF HOLE	SIZE OF CASING	WEIGHT PER FOOT	SETTING DEPTH	QUANTITY OF CEMENT
	7"	20#	20'	5 SX
6-1/4"	4-1/2"	9.5#	675'	75 SX

1. Drive 7" csg thru boulders to approx 20'
2. Drill 6-1/4" hole to top of Dakota formation approx 675'
3. Set 4-1/2" csg cemented w/75 sx
4. Drill 3-7/8" hole to approx 690' w/air to test Dakota formation
5. If commercial oil production is indicated 2-3/8" tbg will be run and the well completed naturally in the open hole.

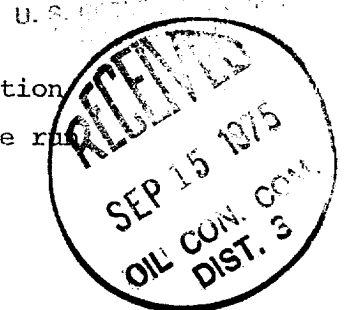

IN ABOVE SPACE DESCRIBE PROPOSED PROGRAM: If proposal is to deepen or plug back, give data on present productive zone and proposed new productive zone. If proposal is to drill or deepen directionally, give pertinent data on subsurface locations and measured and true vertical depths. Give blowout preventer program, if any.

24.

SIGNED

Jim L. Jacobs

TITLE

Agent

DATE

9-8-75

(This space for Federal or State office use)

PERMIT NO.

APPROVAL DATE

APPROVED BY

TITLE

DATE

CONDITIONS OF APPROVAL, IF ANY:

Okal

\*See Instructions On Reverse Side

NEW MEXICO OIL CONSERVATION COMMISSION  
WELL LOCATION AND ACREAGE DEDICATION PLAT

Form O-10,  
Superseded O-12B  
Effective 1-1-67

All distances must be from the outer boundaries of the Section.

Operator <b>Walter Duncan</b>		Lease <b>North Hogback</b>		Well No. <b>6-11</b>
Unit Letter <b>M</b>	Section <b>6</b>	Township <b>29 North</b>	Range <b>16 West</b>	County <b>San Juan</b>
Actual Footage Location of Well: <b>50</b> feet from the <b>South</b> line and <b>50</b> feet from the <b>West</b> line				
Ground Level Elev. <b>4084</b>	Producing Formation <b>Dakota</b>	Pool <b>Slickrock Dakota</b>	Dedicated Acreage Proration Unit: <b>40</b>	

- Outline the acreage dedicated to the subject well by colored pencil or hatchure marks on the plat below.
- If more than one lease is dedicated to the well, outline each and identify the ownership thereof (both as to working interest and royalty).
- If more than one lease of different ownership is dedicated to the well, have the interests of all owners been consolidated by communitization, unitization, force-pooling, etc?

☐ Yes ☐ No If answer is "yes," type of consolidation \_\_\_\_\_

If answer is "no," list the owners and tract descriptions which have actually been consolidated. (Use reverse side of this form if necessary.) \_\_\_\_\_

No allowable will be assigned to the well until all interests have been consolidated (by communitization, unitization, forced-pooling, or otherwise) or until a non-standard unit, eliminating such interests, has been approved by the Commission.

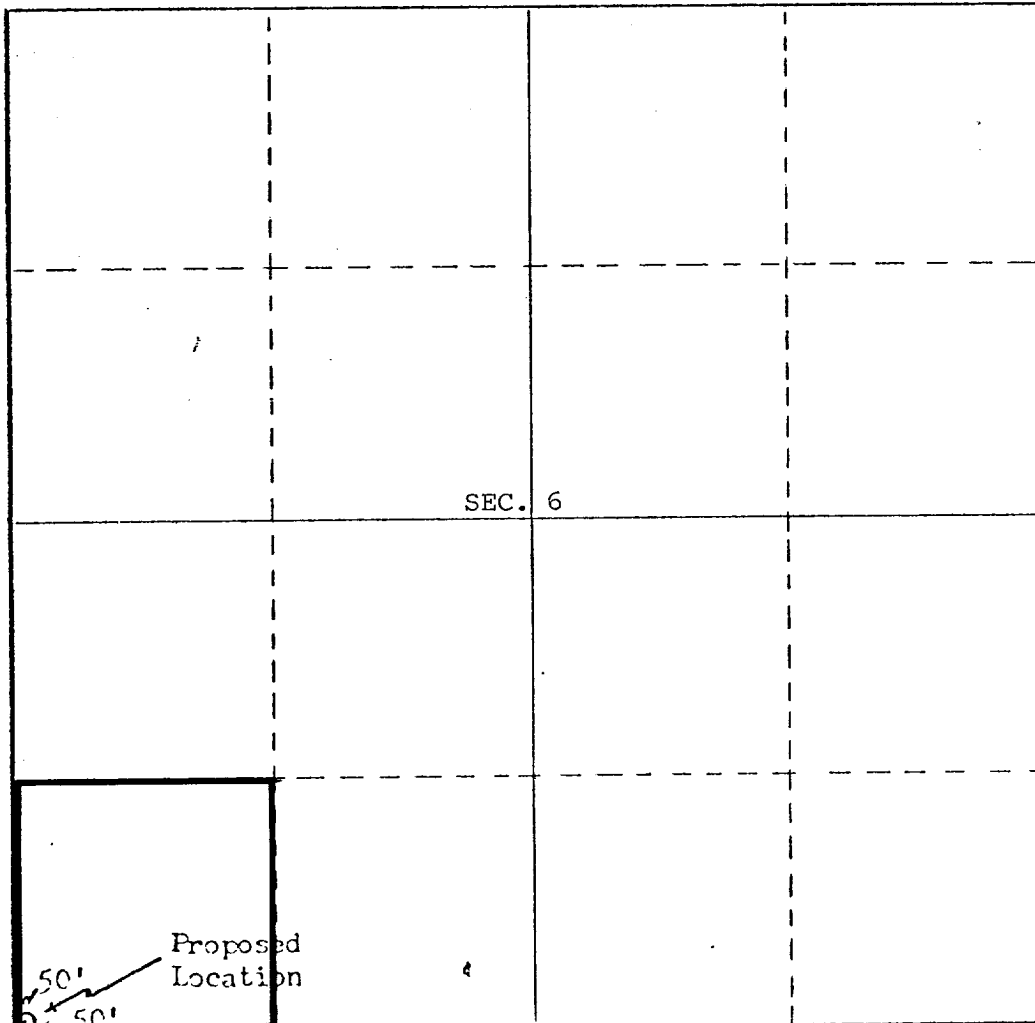

CERTIFICATION

I hereby certify that the information contained herein is true and complete to the best of my knowledge and belief.

*Jim L. Jacobs*  
Name  
**Jim L. Jacobs**  
Position  
**Agent**  
Company  
**Walter Duncan**  
Date  
**9-8-75**

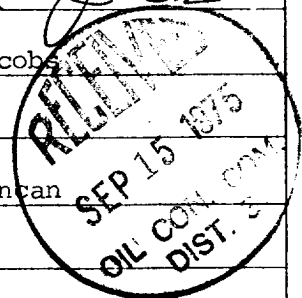

I hereby certify that the well location shown on this plat was plotted from field notes of actual surveys made by me or under my supervision, and that the same is true and correct to the best of my knowledge and belief.

**Sept. 2, 1975**  
Date surveyed  
**Frederick E. Reed**  
Registered Professional Engineer  
and Oil Well Surveyor  
*Frederick E. Reed*  
Certified by me:  
**3795**

