

NO. OF COPIES RECEIVED	5
DISTRIBUTION	
SANTA FE	1
FILE	1
U.S.G.S.	2
LAND OFFICE	
OPERATOR	

NEW MEXICO OIL CONSERVATION COMMISSION

30-045-21946

Form C-101
Revised 1-1-65

5A. Indicate Type of Lease	
STATE <input type="checkbox"/>	FEE <input checked="" type="checkbox"/>
5. State Oil & Gas Lease No.	
--	
7. Unit Agreement Name	
--	
8. Farm or Lease Name	
McKay	
9. Well No.	
1	
10. Field and Pool, or Wildcat	
Aztec Pictured Cliff	
12. County	
San Juan	
19. Proposed Depth	19A. Formation
1800	Pictured Cliff
20. Rotary or C.T.	
Rotary	
21. Elevations (Show whether DF, RT, etc.)	22. Approx. Date Work will start
5450 GL	12-10-75

APPLICATION FOR PERMIT TO DRILL, DEEPEN, OR PLUG BACK	
1a. Type of Work	
DRILL <input type="checkbox"/>	DEEPEN <input type="checkbox"/>
PLUG BACK <input type="checkbox"/>	
b. Type of Well	
OIL WELL <input type="checkbox"/>	GAS WELL <input checked="" type="checkbox"/>
OTHER <input type="checkbox"/>	
2. Name of Operator	
Horace F. McKay, Jr.	
3. Address of Operator	
P.O. Box 14738 (5900 Tramway Blvd. N.E.) Albuquerque, N.M. 87111	
4. Location of Well	
UNIT LETTER K	LOCATED 1800 FEET FROM THE south LINE
AND 1810 FEET FROM THE west	LINE OF SEC. 19 TWP. 29N RGE. 10W NMPM
19. Proposed Depth	
1800	
19A. Formation	
Pictured Cliff	
20. Rotary or C.T.	
Rotary	
21. Elevations (Show whether DF, RT, etc.)	
5450 GL	
21A. Kind & Status Plug. Bond	
Blanket O&G	
21B. Drilling Contractor	
L. E. Wilson	
22. Approx. Date Work will start	
12-10-75	

23.

PROPOSED CASING AND CEMENT PROGRAM

SIZE OF HOLE	SIZE OF CASING	WEIGHT PER FOOT	SETTING DEPTH	SACKS OF CEMENT	EST. TOP
8 5/8	7"	20#	100'	100	circ. to surface
6 3/4	2 7/8"	6.50#	1800'	400	circ. to surface

Selective zones in the Picture Cliffs will be perforated and sandwater fractured.

APPROVAL VALID
FOR 30 DAYS UNLESS
DRILLING COMMENCED,

3-1-76

IN ABOVE SPACE DESCRIBE PROPOSED PROGRAM; IF PROPOSAL IS TO DEEPEN OR PLUG BACK, GIVE DATA ON PRESENT PRODUCTIVE ZONE AND PROPOSED NEW PRODUCTIVE ZONE. GIVE BLOWOUT PREVENTER PROGRAM, IF ANY.

I hereby certify that the information above is true and complete to the best of my knowledge and belief.

Signed Horace F. McKay, Jr. Title Operator/Owner Date November 26, 1975

(This space for State Use)

APPROVED BY AK Kendrick TITLE State Engineer DATE DEC 1 1975

CONDITIONS OF APPROVAL, IF ANY:

**MEXICO OIL CONSERVATION COMMISSION
WELL LOCATION AND ACREAGE DEDICATION PLAT**

Form 1-1-1
Supersedes C-128
Effective 1-1-65

All distances must be from the outer boundaries of the Section.

Operator HORACE F. MCKAY, Jr. XXXXXX & CO. INC.			Lease MCKAY		Well No. 1
Unit Letter K	Section 19	Township 29 NORTH	Range 10 WEST	County SAN JUAN	
Actual Surface Location of Well:					
1800 feet from the SOUTH line and		1810 feet from the WEST line			
Ground Level Elev. 5450.0	Producing Formation Picture Cliff	Pool Aztec Pictured Cliff	Dedicated Acreage: 158.50		

1. Outline the acreage dedicated to the subject well by colored pencil or hachure marks on the plat below.
2. If more than one lease is dedicated to the well, outline each and identify the ownership thereof (both as to working interest and royalty).
3. If more than one lease of different ownership is dedicated to the well, have the interests of all owners been consolidated by communitization, unitization, force-pooling, etc?

☒ Yes ☐ No If answer is "yes," type of consolidation **Communitization**

If answer is "no," list the owners and tract descriptions which have actually been consolidated. (Use reverse side of this form if necessary.) _____

No allowable will be assigned to the well until all interests have been consolidated (by communitization, unitization, forced-pooling, or otherwise) or until a non-standard unit, eliminating such interests, has been approved by the Commission.

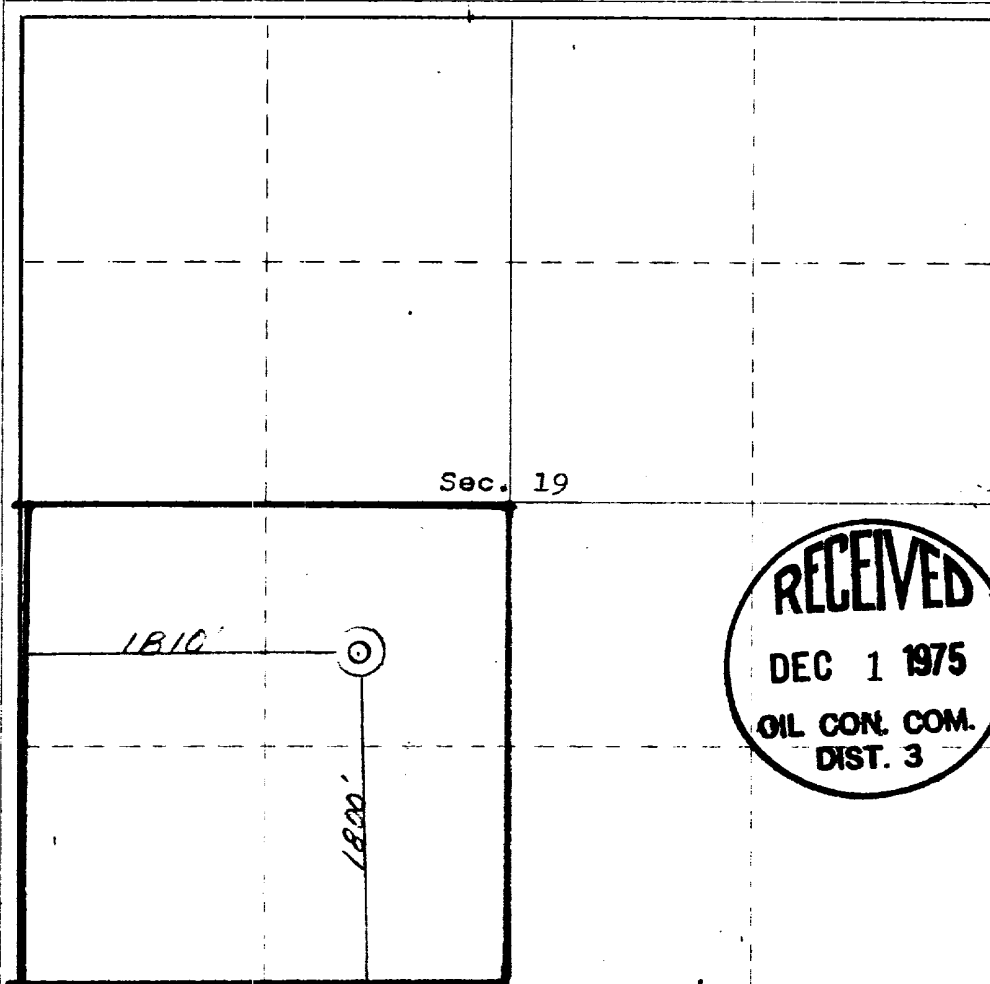

CERTIFICATION

I hereby certify that the information contained herein is true and complete to the best of my knowledge and belief.

Horace F. McKay, Jr.

Name **Horace F. McKay, Jr.**

Position **Operator/Owner**

Company **Horace F. McKay, Jr.**

Date **November 26, 1975**

I hereby certify that the well location shown on the plat was plotted from field notes and/or surveys made by me or under my supervision, and that the same is true and correct to the best of my knowledge and belief.

James P. Leese

Date Surveyed **1 October, 1975**

Registered Professional Engineer and/or Land Surveyor

JAMES P. LEESE

Certificate No.

1463

1

A black and white photograph of a large, multi-story building with a prominent central tower and many windows, likely a government or institutional building.