

30-045-22130

NO. OF COPIES RECEIVED	5
DISTRIBUTION	
SANTA FE	1
FILE	1
U.S.G.S.	2
LAND OFFICE	
OPERATOR	1

NEW MEXICO OIL CONSERVATION COMMISSION

Form C-101
Revised 1-4-65

5A. Indicate Type of Lease	
STATE <input type="checkbox"/>	FEE <input checked="" type="checkbox"/>
5. State Oil & Gas Lease No.	
7. Unit Agreement Name	
8. Farm or Lease Name Florance	
9. Well No. 45-A	
10. Field and Pool, or Wildcat Blanco Mesa Verde	
12. County San Juan	
19. Proposed Depth 5200'	19A. Formation Blanco Mesa Verde
20. Rotary or C.T. Rotary	
21. Elevations (Show whether DF, RT, etc.) 5853' GL	22. Approx. Date Work will start Upon Approval

APPLICATION FOR PERMIT TO DRILL, DEEPEN, OR PLUG BACK

1a. Type of Work	
b. Type of Well DRILL <input checked="" type="checkbox"/> DEEPEN <input type="checkbox"/> PLUG BACK <input type="checkbox"/> OIL WELL <input type="checkbox"/> GAS WELL <input checked="" type="checkbox"/> OTHER <input type="checkbox"/> SINGLE ZONE <input type="checkbox"/> MULTIPLE ZONE <input type="checkbox"/>	
2. Name of Operator Tenneco Oil Company	
3. Address of Operator 1860 Lincoln Street, Suite 1200, Denver, Colorado 80203	
4. Location of Well UNIT LETTER P LOCATED 815 FEET FROM THE South LINE AND 805 FEET FROM THE East LINE OF SEC. 22 TWP. 30N RGE. 8W NMPM	
21. Elevations (Show whether DF, RT, etc.) 5853' GL	
21A. Kind & Status Plug. Bond Blanket	
21B. Drilling Contractor Coleman	

23.

PROPOSED CASING AND CEMENT PROGRAM

SIZE OF HOLE	SIZE OF CASING	WEIGHT PER FOOT	SETTING DEPTH	SACKS OF CEMENT	EST. TOP
12 1/4"	9 5/8"	36#	+200'	Suff. to circulate to surf.	
8 3/4"	7"	23#	+2930'	Suff. to cement back to surf. csg.	
6 1/8"	4 1/2"	10.5#	+2680' - 5200'	Suff. to cement back to 7" csg.	

Plan to drill well as follows:

1. MIRURT, drill 12 1/4" hole to +200'.
2. Set and cement 9 5/8" csg. to +200' & cement with suff. cement to circ. to surface.
3. Drill out 8 3/4" bit to +2930'.
4. Run 7" csg. and cement back to surface csg.
5. Drill out of 7" using gas as the circulating fluid, do not drill more than 10' below the 7" csg. shoe until the hole has dried up completely and is dusting.
6. Drill the hole to T.D., log the hole dry as requested by drill site geologist.
7. Run 4 1/2" liner to T.D., load hole with mud and cement liner back to top of 4 1/2". Set liner hanger and POH w/drill pipe.
8. This well will be completed through casing perforations and stimulated as necessary to establish commercial production.
9. Clean up area.

FOR 90 DAYS
DRILLING

EXPIRES 9-28-76

IN ABOVE SPACE DESCRIBE PROPOSED PROGRAM; IF PROPOSAL IS TO DEEPEN OR PLUG BACK, GIVE DATA ON PRESENT PRODUCTIVE ZONE AND PROPOSED NEW PRODUCTIVE ZONE. GIVE BLOWOUT PREVENTER PROGRAM, IF ANY.

I hereby certify that the information above is true and complete to the best of my knowledge and belief.

Signed A.D. Myers Title Div. Prod. Manager

(This space for State Use)

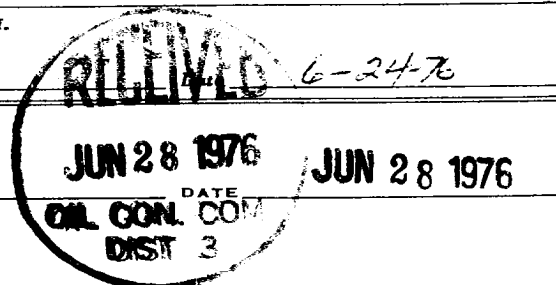
APPROVED BY AR Hendrick TITLE SUPERVISOR DIST. #3
CONDITIONS OF APPROVAL, IF ANY:

NEW MEXICO OIL CONSERVATION COMMISSION WELL LOCATION AND AVERAGE DEDICATION PLAT

All distances must be given the exact bearings of the Section

Owner TENNECO OIL COMPANY			Lease FLORANGE		Well No. 45- A
Section 22	Township 30 NORTH	Range 8 WEST	County SAN JUAN		
Actual Surface Location of Well: 815 feet from the SOUTH line and 805 feet from the EAST line					
Surface Elev. 5853	Producing Formation Blanco Mesaverde	Pool Blanco Mesaverde	Dedicated Average: E/2 320 Acres		

- Outline the acreage dedicated to the subject well by colored pencil or hatchure marks on the plat below.
- If more than one lease is dedicated to the well, outline each and identify the ownership thereof (both as to working interest and royalty).
- If more than one lease of different ownership is dedicated to the well, have the interests of all owners been consolidated by communitization, unitization, force-pooling, etc?

Yes ☐ No ☒ If answer is "yes," type of consolidation Communitization
If answer is "no," list the owners and tract descriptions which have actually consolidated. (Use reverse side of this form if necessary.)

No allowable will be assigned to the well until all interests have been consolidated (by communitization, unitization, forced-pooling, or otherwise) or until a non-standard unit, eliminating such interests, has been approved by the Commission.

CERTIFICATION

I hereby certify that the information contained herein is true and complete to the best of my knowledge and belief.

Name Ted P. Drake
Position Production Clerk
Company Tenneco Oil Company
Date June 14, 1976

I hereby certify that the location shown on this plat was plotted from field notes of actual surveys made by me or under my supervision, and that the same is true and correct to the best of my knowledge and belief.

4 June 1976

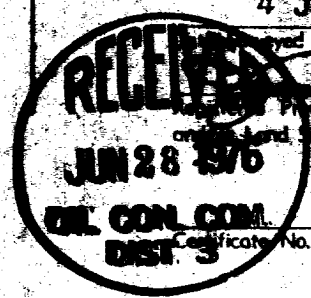
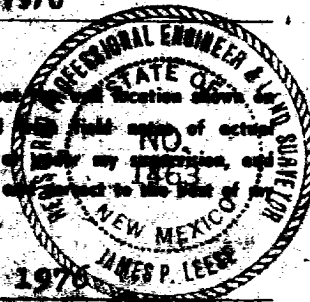

1463

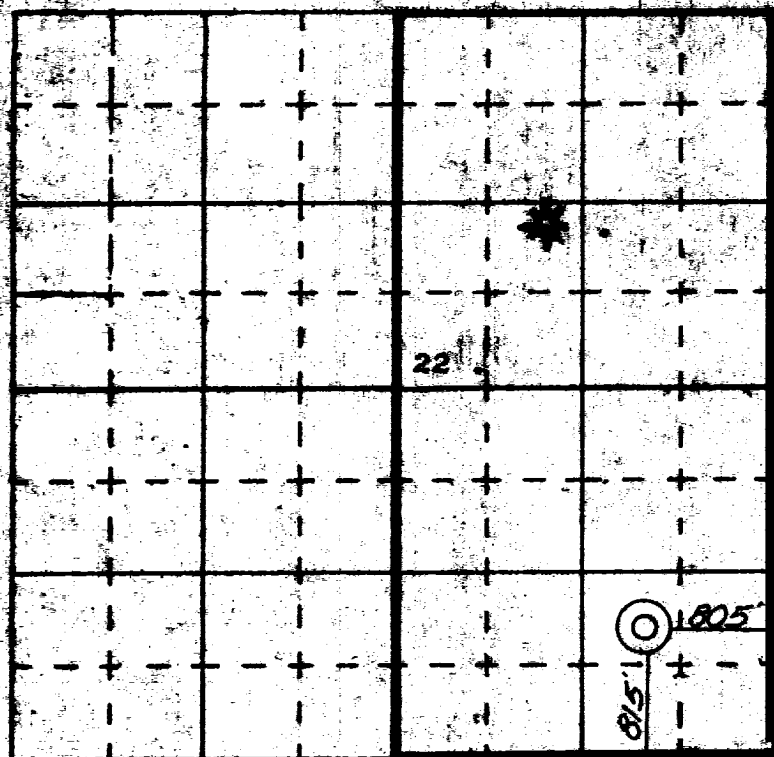

Florance 45A
7 POINT WELL CONTROL PLAN

1. Surface casing: 9 5/8", 24#, approximately 200, grade K-55, new condition.
2. Casinghead will be 10", 900 Series, 3,000 psi rating.
3. Intermediate casing - 7", 20#, K-55, will be set at \pm 2930' and cemented to surface casing.
4. Blowout preventors: Hydraulic, double ram, 10". One set of rams will be provided for each size drill pipe in the hole. One set of blind rams at all times. Fill line will be 2", kill line will be 2", choke relief line will be 2" with variable choke.
5. Auxiliary equipment:
 - (1) Kelly cock will be in use at all times.
 - (2) Stabbing valve to fit drill pipe will be present on floor at all times.
 - (3) Mud monitoring will be visual, no abnormal pressures are anticipated in this area.
 - (4) Rotating head will be used when drilling with gas.
6. Anticipated bottom-hole pressure:

This is an area of known pressure. Maximum anticipated pressure at 5700' T.D. is 1200 psi.
7. Drilling Fluids:
 - 0 - 200' Spud mud
 - 200'- 2930' Gel water - low solids as needed to maintain good conditions.
 - 2930'- T.D. Compressed gas

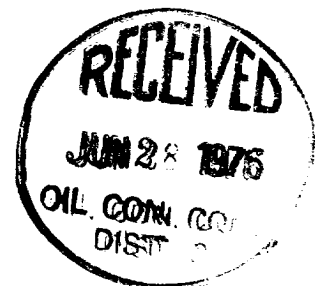

Florance #45A
SURFACE USE PLAN

1. Shown on attached map.
2. Shown on attached map. Approximately 0 of 0 wide road will be required.
3. Shown on attached map.
4. Shown on attached map.
5. This is expected to be a dry gas well, therefore, a tank battery will not be required.
6. Water will be hauled from the San Juan River or nearest wash.
7. All waste material will be buried in reserve pit at time of location clean up.
8. No camps will be associated with this operation.
9. No airstrip will be built for this operation.
10. Shown on attached diagram.
11. Upon completion or abandonment of this well, the location will be cleaned and levelled and a dry hole marker placed, if applicable.
12. The location is sandy, rocky, typical for the area. Vegetation is sage brush.

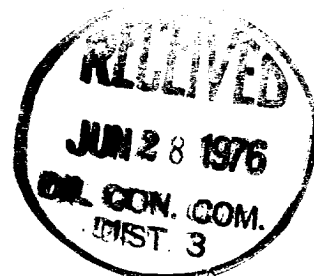

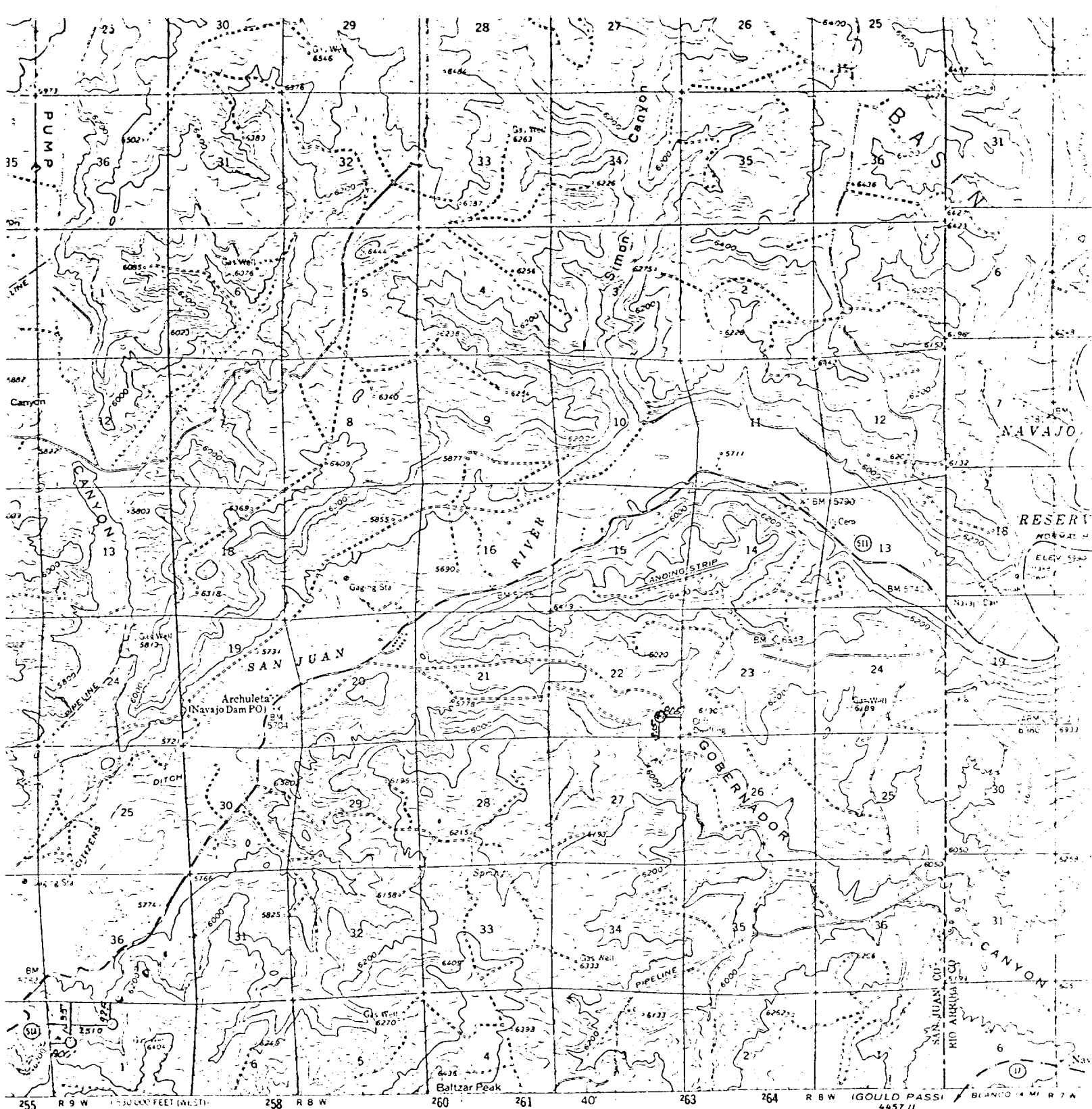

ed, edited, and published by the Geological Survey
 by USGS and USC & GS
 st compiled in 1959 from 1:24,000-scale maps
 1954. West half topography by photogrammetric
 from aerial photographs taken 1955
 revised 1959
 nic projection 1927 North American datum
 2-foot grid based on New Mexico coordinate system,
 and central zones
 meter Universal Transverse Mercator grid ticks,
 3, shown in blue
 icking indicates area to be submerged by Navajo
 at elevation 5990 feet
 covered by dashed light blue pattern is subject
 to inundation to 6101 feet

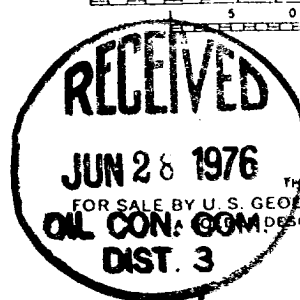
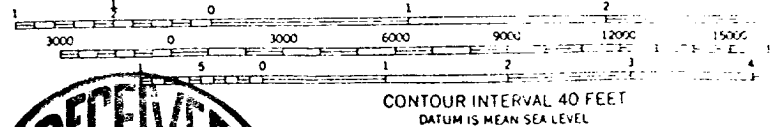
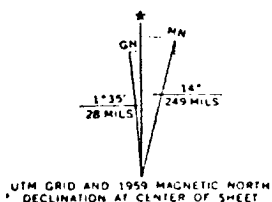

THIS MAP COMPLIES WITH NATIONAL MAP ACCURACY STANDARDS
 FOR SALE BY U. S. GEOLOGICAL SURVEY, DENVER, COLORADO 80225 OR WASH
 DESCRIBING TOPOGRAPHIC MAPS AND SYMBOLS IS AVAILABLE ON

Rig Layout- Florence 45A

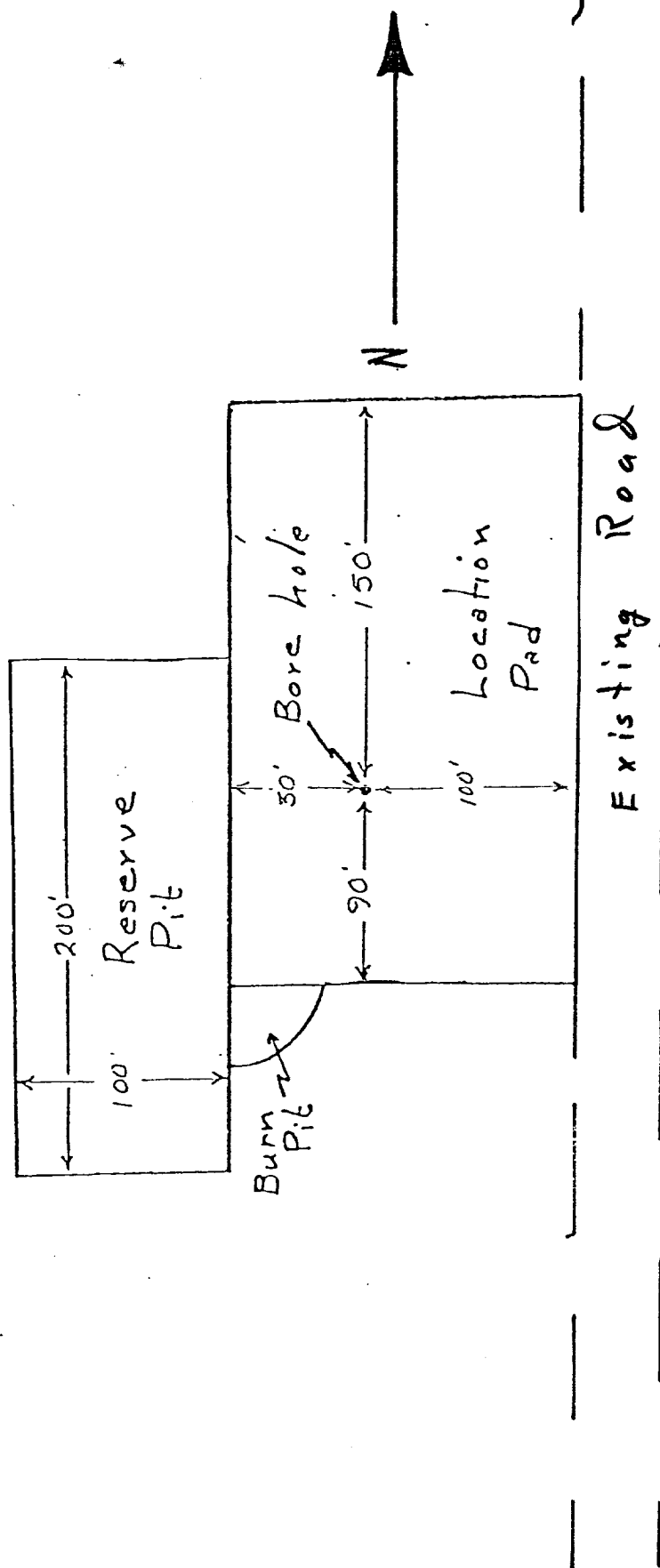

Tenneco Oil
A Tenneco Company

Suite 1200
Lincoln Tower Building
Denver, Colorado 80203
(303) 292-9920



June 23, 1976

State of New Mexico
Oil & Gas Conservation Commission
1000 Rio Brazos Road
Aztec, New Mexico 87401

Re: Application for Permit to Drill,
Florance 45-A,
San Juan County,
New Mexico

Gentlemen:

Attached are five copies each of the Application for Permit to Drill, Surveyor's Plat, Vicinity Map, Location Access Map, 12 Point Surface Use Plan, and 7 Point Well Control Plan for the above captioned well.

We are planning to commence drilling operations as soon as permits are approved.

Yours very truly,

TENNECO OIL COMPANY

A handwritten signature in cursive script, appearing to read "D. D. Myers".

D. D. Myers
Division Production Manager

TFD:df

Attachments

