

30-045-22163

UNITED STATES
DEPARTMENT OF THE INTERIOR
GEOLOGICAL SURVEY

APPLICATION FOR PERMIT TO DRILL, DEEPEN, OR PLUG BACK

1a. TYPE OF WORK DRILL <input checked="" type="checkbox"/> DEEPEN <input type="checkbox"/> PLUG BACK <input type="checkbox"/>		5. LEASE DESIGNATION AND SERIAL NO. NM-014378
b. TYPE OF WELL OIL WELL <input type="checkbox"/> GAS WELL <input checked="" type="checkbox"/> OTHER <input type="checkbox"/> SINGLE ZONE <input type="checkbox"/> MULTIPLE ZONE <input type="checkbox"/>		6. IF INDIAN, ALLOTTEE OR TRIBE NAME
2. NAME OF OPERATOR Texaco Inc. Attention: G. L. Eaton		7. UNIT AGREEMENT NAME
3. ADDRESS OF OPERATOR P.O. Box 2100, Denver, Colorado 80201		8. FARM OR LEASE NAME H. J. Loe Federal
4. LOCATION OF WELL (Report location clearly and in accordance with any State requirements.)* At surface SW $\frac{1}{4}$ NE $\frac{1}{4}$ Sec. 23 At proposed prod. zone 1650' FNL & 2210' FEL Sec. 23		9. WELL NO. 2-R
14. DISTANCE IN MILES AND DIRECTION FROM NEAREST TOWN OR POST OFFICE* 10 miles East of Farmington		10. FIELD AND POOL, OR WILDCAT Basin Dakota
16. NO. OF ACRES IN LEASE 990'		11. SEC., T., E., M., OR BLK. AND SURVEY OR AREA Sec. 23 T29N R12W
17. NO. OF ACRES ASSIGNED TO THIS WELL 320		12. COUNTY OR PARISH San Juan
18. DISTANCE FROM PROPOSED LOCATION* TO NEAREST WELL, DRILLING, COMPLETED, OR APPLIED FOR, ON THIS LEASE, FT. 100'		13. STATE N. Mexico
20. ROTARY OR CABLE TOOLS Rotary		22. APPROX. DATE WORK WILL START* 9-1-76
21. ELEVATIONS (Show whether DF, RT, GR, etc.) 5657 GR ungraded		

PROPOSED CASING AND CEMENTING PROGRAM

SIZE OF HOLE	SIZE OF CASING	WEIGHT PER FOOT	SETTING DEPTH	QUANTITY OF CEMENT
11	8 5/8	24	300	Cmt to Surface
7 7/8	5 1/2	14 & 15.5	6400	Cmt from bottom of csg to bottom of surface csg with 2 DV collars.

Propose to drill this well as a replacement for H. J. Loe Federal "B" No. 2. Samples will be taken at 10' intervals from 5700' to TD. No cores or DST's are planned. Electric logs will be run from surface to TD. Surface formation is the Kirkland shale. Primary geologic formations are Picture Cliffs at 1698' Mancos at 4410' and the Dakota at 6170'. Prospective zones in the Dakota formation will be perforated and treated as necessary. Blowout preventer equipment will be as indicated on the attached exhibit and will be tested at regular intervals. Necessary steps will be taken to protect the environment.

Gas is dedicated

IN ABOVE SPACE DESCRIBE PROPOSED PROGRAM: If proposal is to deepen or plug back, give data on present productive zone and proposed new productive zone. If proposal is to drill or deepen directionally, give pertinent data on subsurface locations and measured and true vertical depths. Give blowout preventer program, if any.

24. SIGNED G. L. Eaton TITLE District Superintendent DATE 8/9/76

(This space for Federal or State office use)

PERMIT NO. _____ APPROVAL DATE _____

APPROVED BY _____ TITLE _____ DATE _____

CONDITIONS OF APPROVAL, IF ANY:

USGS (3) OGCC (2) GLE ARM (2)

Farm.

Aztec

*See Instructions On Reverse Side

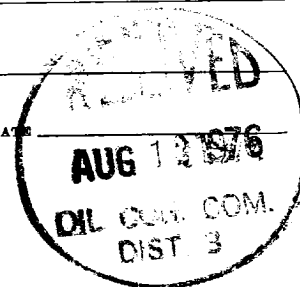

Instructions

General: This form is designed for submitting proposals to perform certain well operations, as indicated, on all types of lands and leases for appropriate action by either a Federal or a State agency or both, pursuant to applicable Federal and/or State laws and regulations. Any necessary special instructions concerning the use of this form and the number of copies to be submitted, particularly with regard to local, area, or regional procedures and practices, either are shown below or will be issued by, or may be obtained from, the local Federal and/or State office.

Item 1: If the proposal is to redrill to the same reservoir at a different subsurface location or to a new reservoir, use this form with appropriate notations. Consult applicable State or Federal regulations concerning subsequent work proposals or reports on the well.

Item 4: If there are no applicable State requirements, locations on Federal or Indian land should be described in accordance with Federal requirements. Consult local State or Federal office for specific instructions.

Item 14: Needed only when location of well cannot readily be found by road from the land or lease description. A plat, or plat, separate or on this reverse side, showing the roads to, and the surveyed location of, the well, and any other required information, should be furnished when required by Federal or State agency offices.

Items 15 and 18: If well is to be, or has been directionally drilled, give distances for subsurface location of hole in any present or objective production zone.

Item 22: Consult applicable Federal or State regulations, or appropriate officials, concerning approval of the proposal before operations are started.

NEW MEXICO OIL CONSERVATION COMMISSION
WELL LOCATION AND ACREAGE DEDICATION PLAT

Form C-102
Supersedes C-128
Effective 1-1-65

All distances must be from the outer boundaries of the Section.

Operator Texaco Inc.			Lease H. J. Loe "B" Federal		Well No. 2 R
Unit Letter G	Section 23	Township 29 North	Range 12 West	County San Juan	
Actual Footage Location of Wells: 1650 feet from the North line and 2210 feet from the East line					
Ground Level Elev: 5657	Producing Formation DAKOTA		Pool BASIN DAKOTA		Dedicated Acreage: 320 Acres

1. Outline the acreage dedicated to the subject well by colored pencil or hatchure marks on the plat below.
2. If more than one lease is dedicated to the well, outline each and identify the ownership thereof (both as to working interest and royalty).
3. If more than one lease of different ownership is dedicated to the well, have the interests of all owners been consolidated by communitization, unitization, force-pooling, etc?

☐ Yes ☐ No If answer is "yes," type of consolidation _____

If answer is "no," list the owners and tract descriptions which have actually been consolidated (Use reverse side of this form if necessary.) _____

No allowable will be assigned to the well until all interests have been consolidated (by communitization, unitization, forced-pooling, or otherwise) or until a non-standard unit, eliminating such interests, has been approved by the Commission.

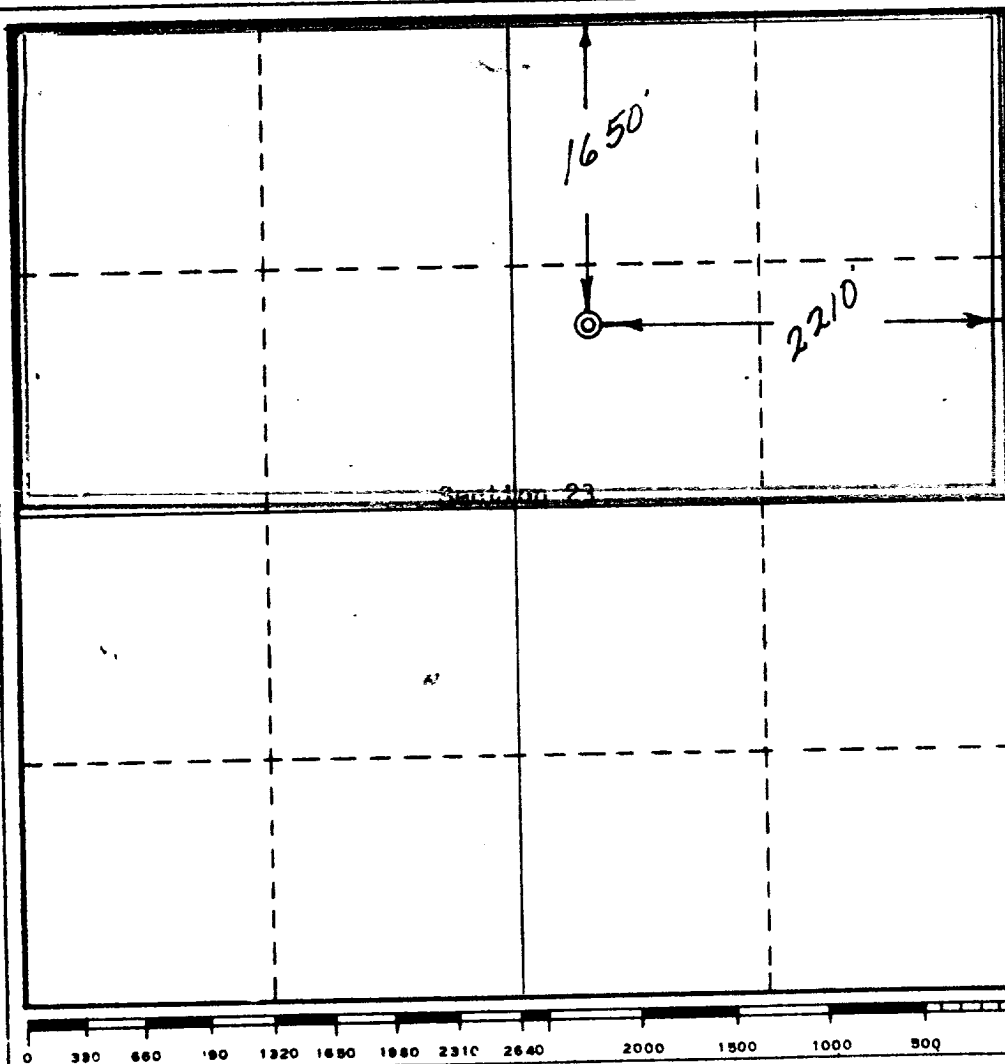
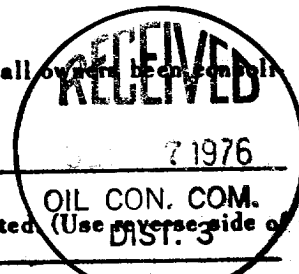

CERTIFICATION

I hereby certify that the information contained herein is true and complete to the best of my knowledge and belief.

Name
Gordon L. Eaton
Position
District Superintendent
Company
TEXACO, INC.
Date
8-3-76

I hereby certify that the well location shown on this plat was plotted from field notes of actual surveys made by me or under my supervision, and that the same is true and correct to the best of my knowledge and belief.

Date Surveyed
AUG 5 1976
Registered Professional Engineer and Land Surveyor
E. L. POTEET
Certificate No.
3084

