



PETROLEUM PRODUCTS

PRODUCING DEPARTMENT  
ROCKY MOUNTAINS-U.S.  
DENVER DIVISION

August 9, 1976

TEXACO INC.  
P.O. Box 2100  
Denver, CO 80201

SURFACE USE DEVELOPMENT PLAN  
H. J. LOE FEDERAL B NO. 2-X  
SW $\frac{1}{4}$  NE $\frac{1}{4}$  SEC. 23 T29N R12W  
SAN JUAN COUNTY, NEW MEXICO  
6.34

Mr. P. T. McGrath (3)  
District Engineer  
U. S. Geological Survey  
P. O. Box 959  
Farmington, New Mexico 87401

Dear Mr. McGrath:

As requested by your office, the Surface Use Development plan for H. J. Loe Federal B No. 2-X, San Juan County, New Mexico, is as follows:

1. Existing roads and exit to the location are shown on the attached plats.
2. No new access road will be required since the well location adjoins an existing road and location.
3. Offset wells to the proposed well are shown on the attached plat.
4. The flowline for subject well will run approximately 150' south to an existing battery at the edge of the location.
5. Water for drilling operations will be trucked from an existing canal located 2 miles east of the location. Water will be transported over existing roads as shown on the attached plats.
6. No additional construction material will be required.
7. All waste material will be contained by earthen and steel pits. Earthen pits will be subsequently backfilled and buried. A portable chemical toilet will be furnished for drilling personnel.

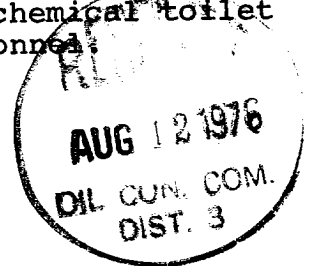

5'

761

FLORIDA (FLORA VISTA) A T E C I M

763

R. 12 W. 2'30"

R. 11 W.

765



# EXISTING BATTERY

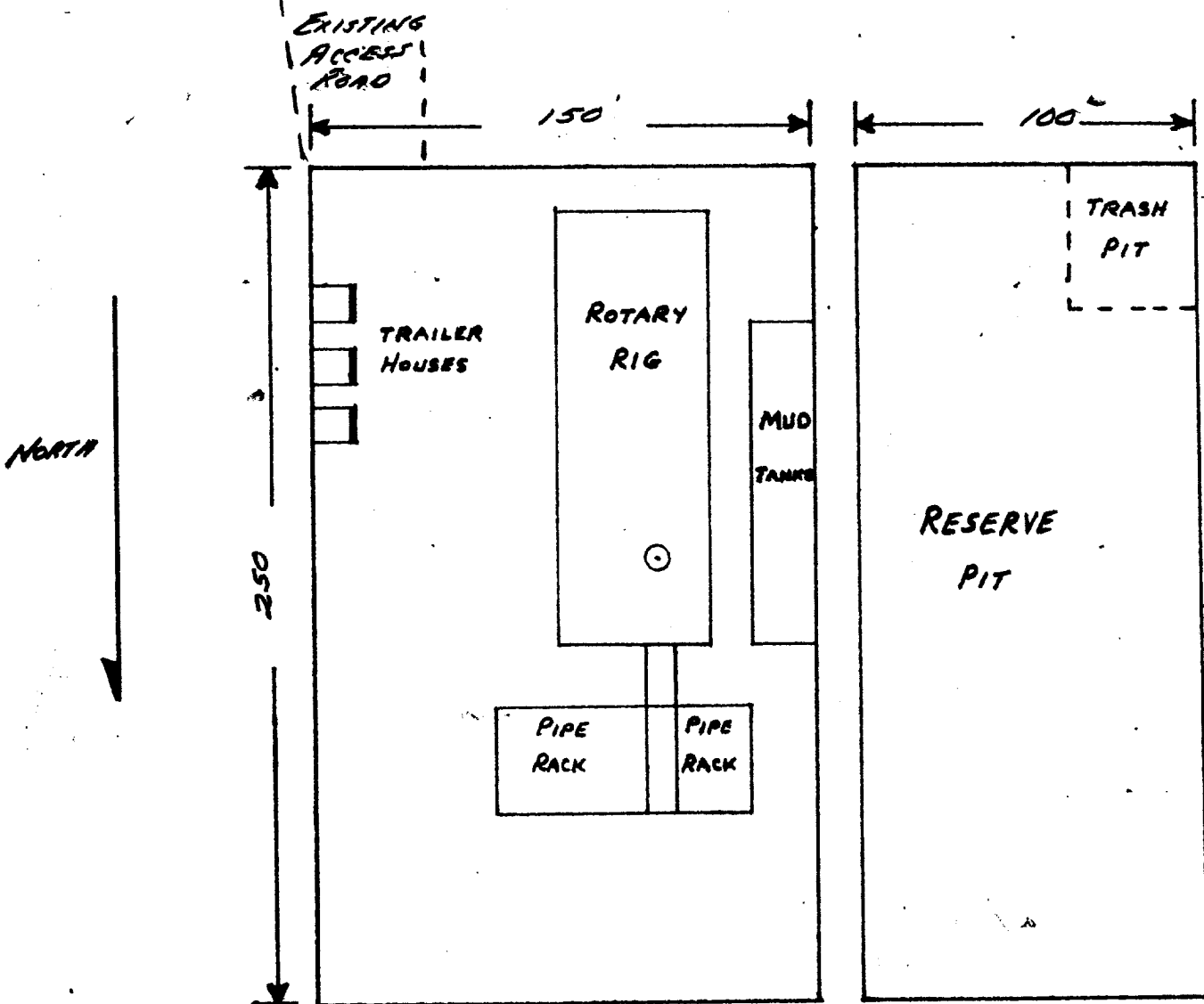

- A. Drilling pad will be compacted soil.
- B. Surface is gentle sloping sandy gravel with sparsely scattered grass weeds and brush.

Rig Layout  
H. J. Loe Federal "B" No.2-  
San Juan Co., New Mexico

