

UNITED STATES
DEPARTMENT OF THE INTERIOR
GEOLOGICAL SURVEY

APPLICATION FOR PERMIT TO DRILL, DEEPEN, OR PLUG BACK

1a. TYPE OF WORK

DRILL ☒DEEPEN ☐PLUG BACK ☐

b. TYPE OF WELL

OIL
WELL ☐GAS
WELL ☒

OTHER

SINGLE
ZONE ☐MULTIPLE
ZONE ☐

2. NAME OF OPERATOR

R & G DRILLING CO.

3. ADDRESS OF OPERATOR

c/o Walsh Engineering & Prod. Corp.
P.O. Box 254, Farmington, N.M. 87401

4. LOCATION OF WELL (Report location clearly and in accordance with any State requirements.)*

At surface

935'FSL, 1010'FEL

At proposed prod. zone

Same

14. DISTANCE IN MILES AND DIRECTION FROM NEAREST TOWN OR POST OFFICE*

15. DISTANCE FROM PROPOSED*

LOCATION TO NEAREST

PROPERTY OR LEASE LINE, FT.

(Also to nearest drig. unit line, if any)

935'

16. NO. OF ACRES IN LEASE

320 Ac.

17. NO. OF ACRES ASSIGNED

TO THIS WELL

160 Ac.

18. DISTANCE FROM PROPOSED LOCATION*

TO NEAREST WELL, DRILLING, COMPLETED,
OR APPLIED FOR, ON THIS LEASE, FT.

920'

19. PROPOSED DEPTH

1970

20. ROTARY OR CABLE TOOLS

Rotary

21. ELEVATIONS (Show whether DF, RT, GR, etc.)

5715'GR

22. APPROX. DATE WORK WILL START*

12-31-76

23.

PROPOSED CASING AND CEMENTING PROGRAM

SIZE OF HOLE	SIZE OF CASING	WEIGHT PER FOOT	SETTING DEPTH	QUANTITY OF CEMENT
12-1/4	8-5/8	24.0	90	100 SXS
7-7/8	4-1/2	10.50	1970	150 SXS

It is proposed to drill this well using drilling mud as a circulating medium. All possible intervals in the Pictured Cliffs formation will be completed.

Estimated Formation Tops

Ojo Alamo	480'	Pictured Cliffs	1770'
Farmington	890'	Lewis	1920'
Fruitland	1220'		

The SE/4 Sec. 14-T29N-R12W, 160 acres, is dedicated to this well.

The gas from this well is dedicated to a gas purchaser.

DEC 30 1976

IN ABOVE SPACE DESCRIBE PROPOSED PROGRAM: If proposal is to deepen or plug back, give data on present productive zone and proposed new productive zone. If proposal is to drill or deepen directionally, give pertinent data on subsurface locations and measured and true vertical depths. Give blowout preventer program, if any.

24.

SIGNATURE

Ewell N. Walsh, P. E.

(This space for Federal or State office use)

President, Walsh Engineering &

TITLE Production Corporation DATE Dec. 29, 1976

PERMIT NO.

APPROVAL DATE

APPROVED BY

TITLE

CONDITIONS OF APPROVAL, IF ANY:

*See Instructions On Reverse Side



**NEW MEXICO OIL CONSERVATION COMMISSION
WELL LOCATION AND ACERAGE DEDICATION PLAT**

All distances must be from the outer boundaries of the Section

Operator R AND G DRILLING COMPANY			Lease HARDIE		Well No. 62
Unit Letter P	Section 14	Township 29 NORTH	Range 12 WEST	County SAN JUAN	
Actual Footage Location of Well: 935 feet from the SOUTH line and 1010 feet from the EAST line					
Ground Level Elev. 5715	Producing Formation Pictured Cliffs	Pool Fulcher Kutz P. C.		Dedicated Acreage: 160 Acres	

1. Outline the acreage dedicated to the subject well by colored pencil or hachure marks on the plat below.
2. If more than one lease is dedicated to the well, outline each and identify the ownership thereof (both as to working interest and royalty),
3. If more than one lease of different ownership is dedicated to the well, have the interests of all owners been consolidated by communitization, unitization, force-pooling, etc?

() Yes () No If answer is "yes," type of consolidation

If answer is "no," list the owners and tract descriptions which have actually consolidated. (Use reverse side of this form if necessary.)

No allowable will be assigned to the well until all interests have been consolidated (by communitization, unitization, forced-pooling, or otherwise) or until a non standard unit, eliminating such interests, has been approved by the Commission.

CERTIFICATION

I hereby certify that the information contained herein is true and complete to the best of my knowledge and belief.

Forster Drilling Co.
Name **Kevin M. Walsh, P.E.,**
President, Walsh
Position **Engineering & Prod.**
Corp.
Company
Date **Dec. 29, 1976**

I hereby certify that the well location shown on this plat was plotted from notes of actual surveys made by me or under my supervision, and that the same is true and correct to the best of my knowledge and belief.

27 December 1976
Date Surveyed
James P. Leese
Registered Professional Engineer
and/or Land Surveyor **James P. Leese**

1463
Certificate No.

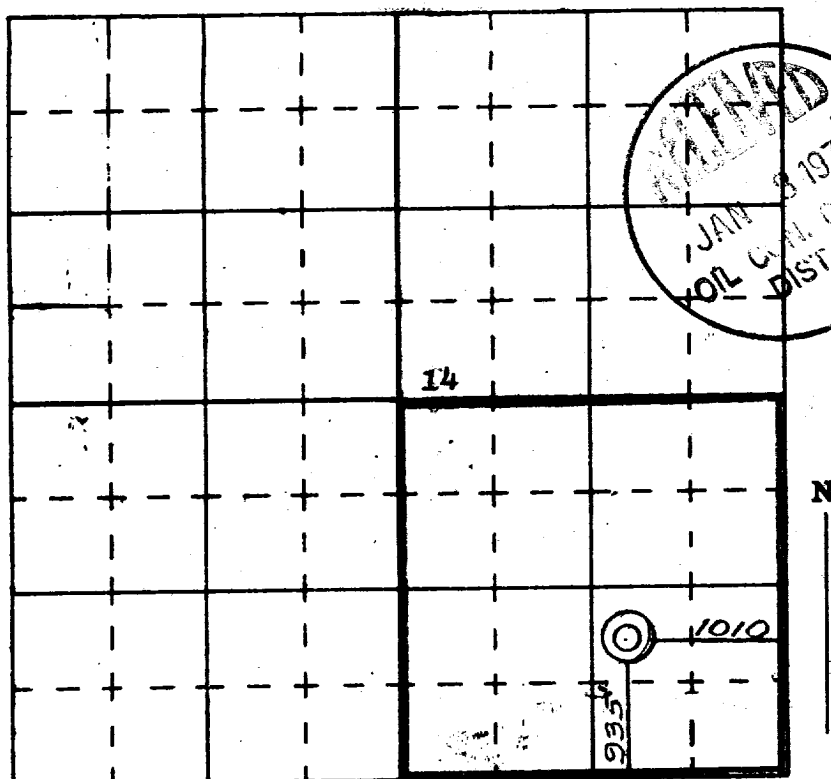

R & G DRILLING CO.
HARDIE NO. 62
SE/4 Sec. 14-T29N-R12W
San Juan County, N. M.

Seven Point Well Control Program

1. Surface Casing.
See Application for Permit to Drill.
2. Spools and Flanges.
 - A. Surface Casing - scwd., Series 600, 2000 psi W.P.
 - B. Production, scwd., Series 600, 2000 psi W.P.
 - C. Tubing Head - Series 600, 2000 psi. W.P.
3. Intermediate Casing.
None
4. Blowout Preventers
Production Hole - 8", 3000 psi
Fill, kill and choke manifold - 5000 psi. W. P.
5. Additional Equipment (If necessary)
 - A. Kelly Cock
 - B. Bit Float
 - C. Degasser
 - D. Pit Level Indicator
 - E. Sub with Valve for drill pipe.
6. Anticipated Bottom Hole Pressure.
700 psi. Current mud program is for 9.2 lb./gal mud with hydrostatic head of 850 psi at 1800 feet. Mud weight will be increased if necessary for higher pressures.
7. Drilling Fluid.
Native mud with gel-chemical for logging.

DEVELOPMENT PLAN

Page 1 of 2

R & G DRILLING CO.
HARDIE NO. 62

1. Existing roads shown on attached plat.
2. Planned access from existing road is approximately -0- to new location.
3. Location - Hardie No. 62
935' FSL, 1010' FEL
Sec. 14-T29N-R12W
San Juan County, New Mexico
4. No additional well is planned on this lease at this time.
5. Production equipment or storage facilities proposed for the well will be installed on location.
6. Water will be obtained from San Juan River
SE/4 Section 28-T29N-R12W.
7. Waste materials will be buried on location or in reserve pit.
8. No permanent camp is planned. A trailer house will be used on location during drilling process.
9. No airstrip proposed.
10. See attached plat for layout.
11. Pits will be filled, location cleaned up, and area not in use for producing well will be reseeded using broadcast method of planting with seed as per attached for seed mixture No. 2.

DEVELOPMENT PLAN

Page 2 of 2

12. Lessee's or operator's representative.

Ewell N. Walsh: 325-8203; Radio Dispatch 325-1873, Car 620.
Address: P. O. Box 254, Farmington, New Mexico 87401

13. CERTIFICATION:

I hereby certify that I, or persons under my direct supervision, have inspected the proposed drillsite and access route; that I am familiar with the conditions which presently exist; that the statements made in this plan are, to the best of my knowledge, true and correct; and, that the work associated with the operations proposed herein will be performed by: _____

R & G DRILLING CO.

and its contractors and subcontractors in conformity with this plan and the terms and conditions under which it is approved.



Ewell N. Walsh, P.E., President,
Walsh Engineering & Production
Corporation

BLM SEEDING REQUIREMENTS
IN THE FARMINGTON RESOURCE AREA

1. SEED MIXTURE 2

2. TIME:

All seeding will take place between July 1 and September 15.

3. EQUIPMENT:

Seeding will be done with a disc-type drill with two boxes for various seed sizes. The drill rows will be eight to ten inches apart. The seed will be planted not less than one-half inch deep or more than one inch deep. The seeder will be followed with a drag, packer, or roller to insure uniform coverage of the seed, and adequate compaction. Drilling will be done on the contour where possible, not up and down the slope. Where slopes are too steep for contour drilling, a "cyclone" hand seeder or similar broadcast seeder will be used. Seed will then be covered to the depth described above by whatever means is practical.

4. SPECIES TO BE PLANTED IN POUNDS PURE-LIVE-SEED PER ACRE:

CRESTED WHEATGRASS (Agropyron desertorum) - $3\frac{1}{4}$ lbs.

FOURWING SALTBUSH (dewinged) (Atriplex canescens) - $\frac{1}{2}$ lb.

SAND DROPSEED (Sporobolus cryptandrus) - $\frac{3}{4}$ lb.

WINTERFAT (Eurotia lanata) - $\frac{1}{2}$ lb.

ALKALI SACATON (Sporobolus airoides) - $\frac{3}{4}$ lb.

R & G DRILLING CO.
HARDIE NO. 62
935'FSL, 1010'FEL
Sec. 14-T29N-R14W
San Juan County, N. M.

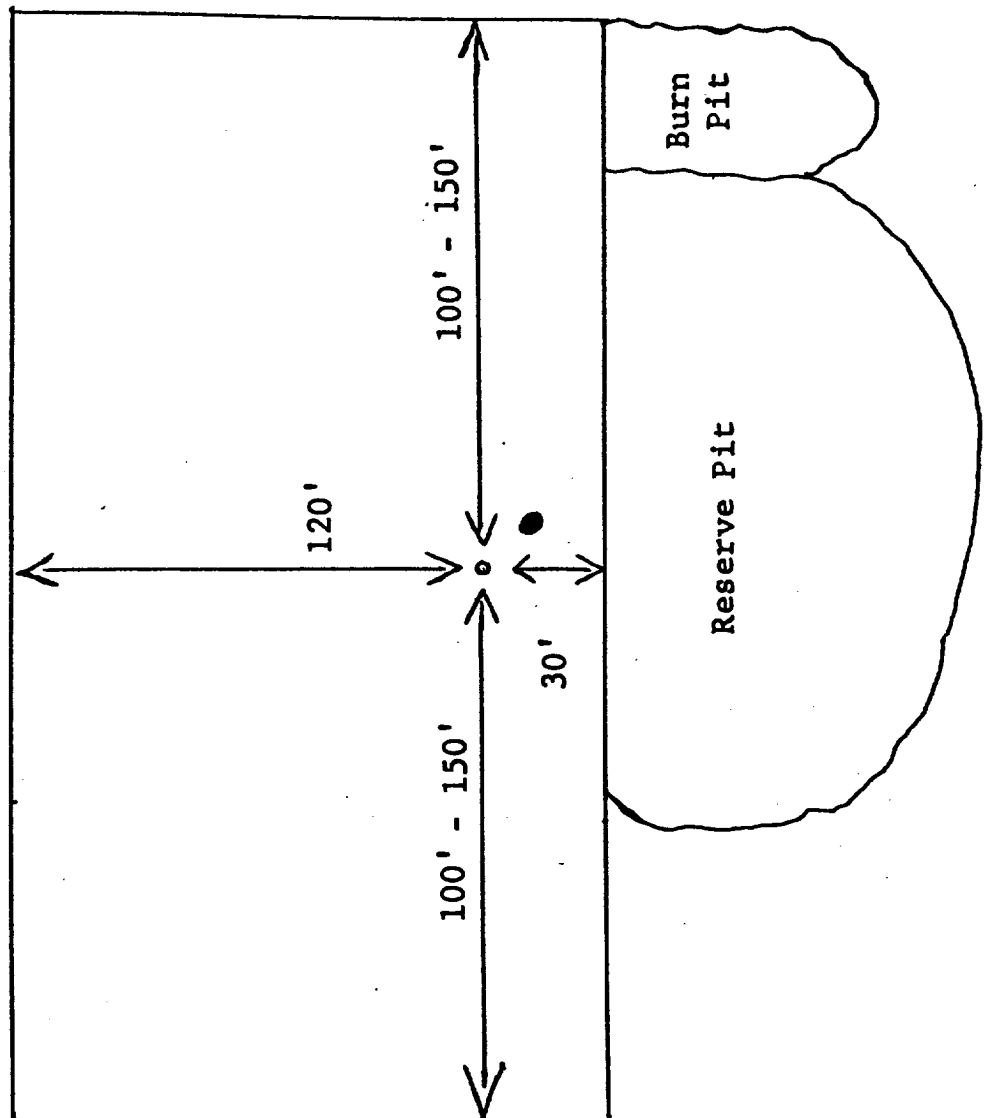

R & G DRILLING CO.
HARDIE NO. 62
935'FSL, 1010'FEL
Sec. 14-T29N-R12W
SAN JUAN COUNTY, N. M.

