

| | |
|------------------------|---|
| NO. OF COPIES RECEIVED | 5 |
| DISTRIBUTION | |
| SANTA FE | 1 |
| FILE | 1 |
| U.S.G.S. | 2 |
| LAND OFFICE | |
| OPERATOR | 1 |

NEW MEXICO OIL CONSERVATION COMMISSION

30-045-22364
Form C-101
Revised 1-4-65

APPLICATION FOR PERMIT TO DRILL, DEEPEN, OR PLUG BACK

| | | |
|--|-------------------------------|--|
| 1a. Type of Work DRILL <input checked="" type="checkbox"/> DEEPEN <input type="checkbox"/> PLUG BACK <input type="checkbox"/> | | 5A. Indicate Type of Lease STATE <input type="checkbox"/> FEE <input checked="" type="checkbox"/> |
| b. Type of Well OIL WELL <input type="checkbox"/> GAS WELL <input checked="" type="checkbox"/> OTHER <input type="checkbox"/> | | 5. State Oil & Gas Lease No. |
| 2. Name of Operator Union Texas Petroleum, A Division of Allied Chemical Corporation | | 7. Unit Agreement Name |
| 3. Address of Operator Suite 1122, 1860 Lincoln Street, Denver, Colorado 80295 | | 8. Farm or Lease Name Maddox Com |
| 4. Location of Well UNIT LETTER I LOCATED 2050 FEET FROM THE south LINE AND 790 FEET FROM THE east LINE OF SEC. 17 TWP. 30N RGE. 8W NMPM | | 9. Well No. 1 A |
| | | 10. Field and Pool, or Wildcat Blanco Mesaverde Pool |
| | | 12. County San Juan |
| 19. Proposed Depth 5000' | | 19A. Formation Mesaverde |
| 20. Rotary or C.T. Rotary | | |
| 21. Elevations (Show whether DF, RT, etc.) 5677 GL | 21A. Kind & Status Plug. Bond | 21B. Drilling Contractor Cactus |
| | | 22. Approx. Date Work will start 5-1-77 |

23.

PROPOSED CASING AND CEMENT PROGRAM

| SIZE OF HOLE | SIZE OF CASING | WEIGHT PER FOOT | SETTING DEPTH | SACKS OF CEMENT | EST. TOP |
|--------------|----------------|-----------------|---------------|-----------------|-----------|
| 12-1/4 | 9-5/8 | 36 | 275 | 275 | Circulate |
| 8-3/4 | 7 | 20 | 2700 | 500 | Circulate |
| 6-1/2 | 4-1/2 (liner) | 10.5 | 2500-5000 | 200 | 2500 |

1. MIRU rotary tools, drill 12-1/4" hole to 275' and set 9-5/8" casing. Circulate cement.
2. Drill out with 8-3/4" bit to 2700' and set 7" casing. circulate cement.
3. Drill 6-1/8" hole, using gas as drilling fluid through Mesaverde to total depth of approximately 5000'.
4. Log hole.
5. Run 4-1/2" liner. Cement back into 7".
6. Perforate and treat Mesaverde section as determined by log analysis.
7. Clean up location and pits.
8. During drilling operations, dual ram hydraulic BOP will be used.

IN ABOVE SPACE DESCRIBE PROPOSED PROGRAM: IF PROPOSAL IS TO DEEPEN OR PLUG BACK, GIVE DATA ON PRESENT PRODUCTIVE ZONE AND PROPOSED NEW PRODUCTIVE ZONE. GIVE BLOWOUT PREVENTER PROGRAM, IF ANY.

I hereby certify that the information above is true and complete to the best of my knowledge and belief.

Signed [Signature] Title Assistant District Production Mgr Date March 2, 1977

(This space for State Use)

APPROVED BY [Signature] TITLE [Signature] DATE [Signature]

CONDITIONS OF APPROVAL, IF ANY:

approval of the non standard location must be obtained prior to production

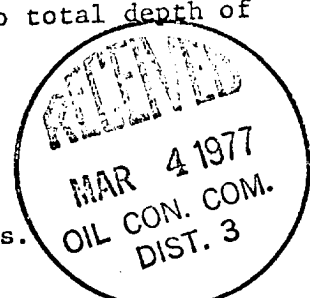

NEW MEXICO OIL CONSERVATION COMMISSION
WELL LOCATION AND ACREAGE DEDICATION PLAT

Supersedes C-128
Effective 1-1-65

All distances must be from the outer boundaries of the Section.

| | | | | | |
|---|---|-----------------------------|---------------------------------|---------------------------|--|
| Operator Union Texas Petroleum Corporation | | | Lease Maddox Com | | Well No. 1-A |
| Unit Letter 1 | Section 17 | Township 30 North | Range 8 West | County San Juan | |
| Actual Footage Location of Well: 2050 feet from the South line and 790 feet from the East line | | | | | |
| Ground Level Elev. 5677 | Producing Formation Mesaverde | | Pool Blanco Mesaverde | | Dedicated Acreage: S/320 Acres |

1. Outline the acreage dedicated to the subject well by colored pencil or hachure marks on the plat below.
2. If more than one lease is dedicated to the well, outline each and identify the ownership thereof (both as to working interest and royalty).
3. If more than one lease of different ownership is dedicated to the well, have the interests of all owners been consolidated by communitization, unitization, force-pooling, etc?

☒ Yes ☐ No If answer is "yes," type of consolidation Communitization

If answer is "no," list the owners and tract descriptions which have actually been consolidated. (Use reverse side of this form if necessary.)

No allowable will be assigned to the well until all interests have been consolidated (by communitization, unitization, forced-pooling, or otherwise) or until a non-standard unit, eliminating such interests, has been approved by the Commission.

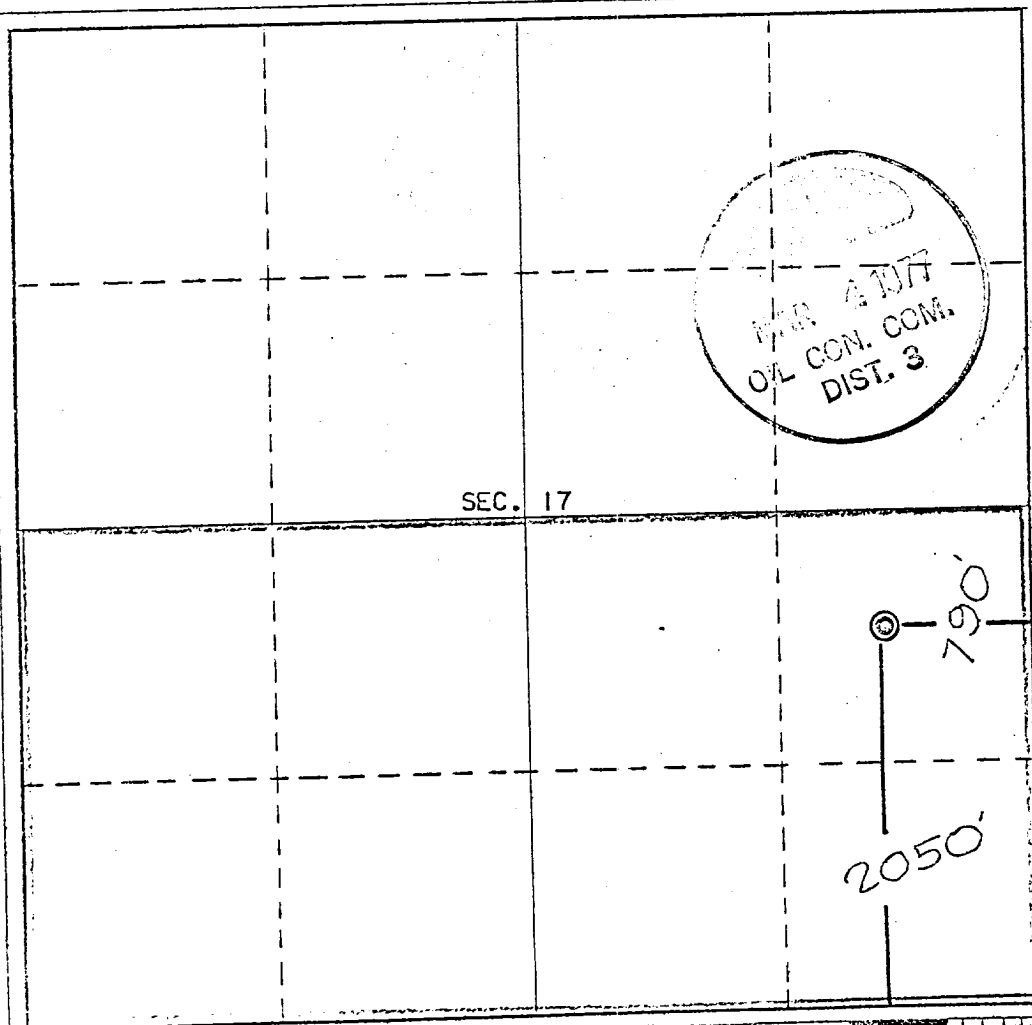

CERTIFICATION

I hereby certify that the information contained herein is true and complete to the best of my knowledge and belief.

Name

Assistant Dist. Prod. Mgr.

Position

Union Texas Petroleum

Company

March 2, 1977

Date

I hereby certify that the well location shown on this plat was plotted from field notes of actual surveys made by me or under my supervision and that the same is true and correct to the best of my knowledge and belief.

Date Surveyed

February 11, 1977

Registered Professional Engineer and/or Land Surveyor

E. V. Echohawk

Certificate No. 3602

E.V. Echohawk LS