

UNITED STATES
DEPARTMENT OF THE INTERIOR
GEOLOGICAL SURVEY

30-039-22708

APPLICATION FOR PERMIT TO DRILL, DEEPEN, OR PLUG BACK

1a. TYPE OF WORK

DRILL ☒DEEPEN ☐PLUG BACK ☐

b. TYPE OF WELL

OIL
WELL ☐GAS
WELL ☒

OTHER

SINGLE
ZONE ☒MULTIPLE
ZONE ☐

2. NAME OF OPERATOR

Northwest Pipeline Corporation

3. ADDRESS OF OPERATOR

P.O. Box 90, Farmington, N.M. 87401

4. LOCATION OF WELL (Report location clearly and in accordance with any State requirements.)

At surface

1100' FWL & 1620' FSL Sec 21, T30N, R5W

At proposed prod. zone

Same as above

14. DISTANCE IN MILES AND DIRECTION FROM NEAREST TOWN OR POST OFFICE*

25 miles East of Navajo Dam

15. DISTANCE FROM PROPOSED*

LOCATION TO NEAREST
PROPERTY OR LEASE LINE, FT.
(Also to nearest drilz. unit line, if any)

1100'

16. NO. OF ACRES IN LEASE

N/A

17. NO. OF ACRES ASSIGNED

TO THIS WELL

w/320

18. DISTANCE FROM PROPOSED LOCATION*
TO NEAREST WELL, DRILLING COMPLETED,
OR APPLIED FOR, ON THIS LEASE, FT.

500'

19. PROPOSED DEPTH

8010'

20. ROTARY OR CABLE TOOLS

Rotary

21. ELEVATIONS (Show whether DF, RT, GR, etc.)

6527' GR

22. APPROX. DATE WORK WILL START*

April 1, 1981

23.

PROPOSED CASING AND CEMENTING PROGRAM

SIZE OF HOLE	SIZE OF CASING	WEIGHT PER FOOT	SETTING DEPTH	QUANTITY OF CEMENT
12-1/4"	9-5/8"	36#	350'	220 cu.ft
8-3/4"	7"	20#	3810'	378 cu.ft
6-1/4"	4-1/2"	10.5# & 11.6#	8010	660 cu.ft

Selectively perforate and stimulate the Dakota Formation.
Completion plans will be determined at Total Depth

A BOP will be installed after the surface casing is set and cemented. All subsequent work will be conducted through the BOP's

The West half of Section 21 is dedicated to this well.

Gas is dedicated

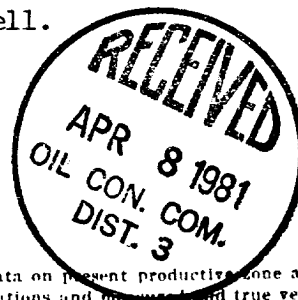

IN ABOVE SPACE DESCRIBE PROPOSED PROGRAM: If proposal is to deepen or plug back, give data on present productive zone and proposed new productive zone. If proposal is to drill or deepen directionally, give pertinent data on subsurface locations and measured and true vertical depths. Give blowout preventer program, if any.

24.

SIGNED

Paul C. Thompson
Paul C. ThompsonTITLE Drilling EngineerDATE 2-19-81

(This space for Federal or State office use)

PERMIT NO. _____

APPROVAL DATE _____

APPROVED BY _____

TITLE _____

CONDITIONS OF APPROVAL, IF ANY:

*See Instructions On Reverse Side

APPROVED
AS AMENDED

MAR 23 1981

James F. Sims
JAMES F. SIMS
DISTRICT ENGINEER

OIL CONSERVATION DIVISION

STATE OF NEW MEXICO
ENERGY AND MINERALS DEPARTMENTP. O. BOX 2083
SANTA FE, NEW MEXICO 87501Form C-107
Revised 10-1-78

All distances must be from the outer boundaries of the Section.

Operator NORTHWEST PIPELINE CORPORATION		Lease SAN JUAN 30-5 UNIT		Well No. 75
Unit Letter L	Section 21	Township 30N	Range 5W	County Rio Arriba
Actual Footage Location of Well: 1620 feet from the South line and 1100 feet from the West line				
Ground Level Elev. 6527	Producing Formation Dakota		Pool Basin Dakota	Dedicated Acreage: 320 Acres

1. Outline the acreage dedicated to the subject well by colored pencil or hatchure marks on the plat below.
2. If more than one lease is dedicated to the well, outline each and identify the ownership thereof (both as to working interest and royalty).
3. If more than one lease of different ownership is dedicated to the well, have the interests of all owners been consolidated by communitization, unitization, force-pooling, etc?

☒ Yes ☐ No If answer is "yes," type of consolidation Unitization

If answer is "no," list the owners and tract descriptions which have actually been consolidated. (Use reverse side of this form if necessary.)

No allowable will be assigned to the well until all interests have been consolidated (by communitization, unitization, forced-pooling, or otherwise) or until a non-standard unit, eliminating such interests, has been approved by the Commission.

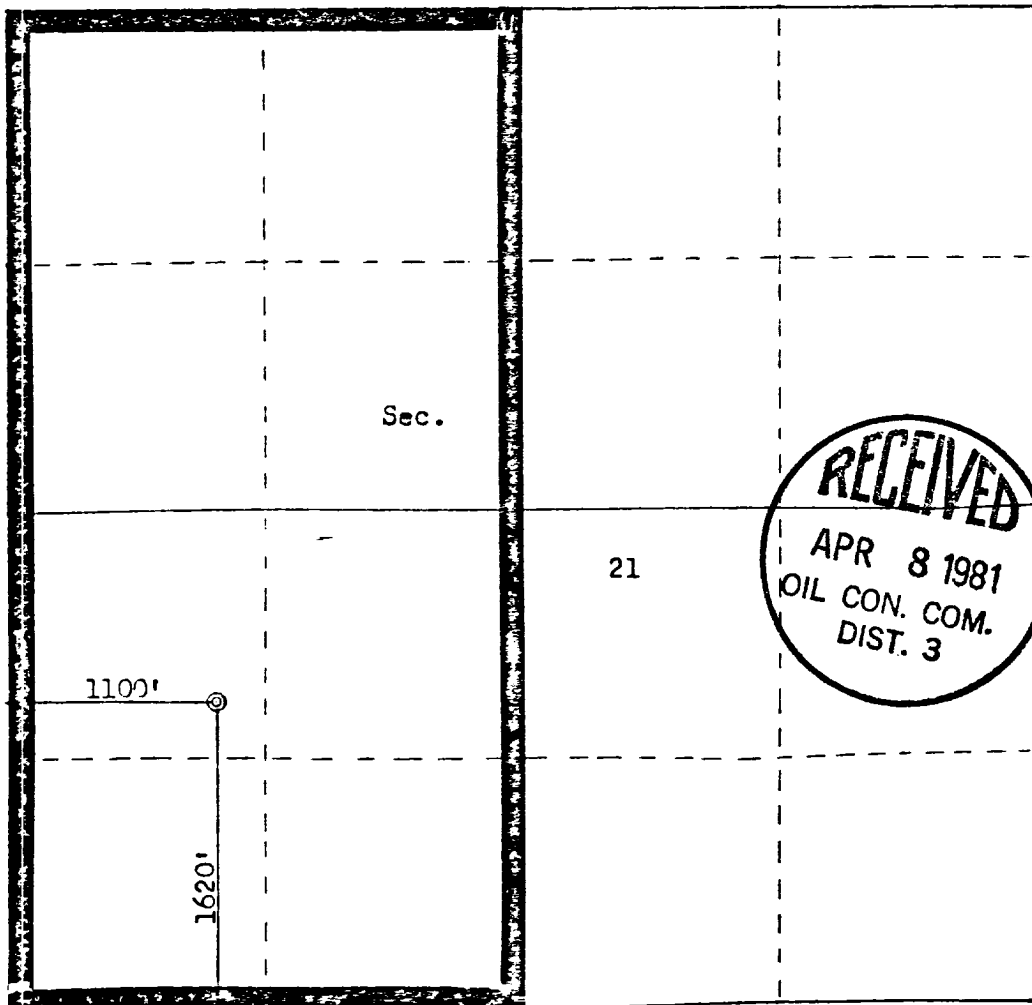

CERTIFICATION

I hereby certify that the information contained herein is true and complete to the best of my knowledge and belief.

Paul C. Thompson
Name

Paul C. Thompson

Position

Drilling Engineer

Company

Northwest Pipeline Corp

Date

February 11, 1981

I hereby certify that the well location shown on this plat was plotted from field notes of actual surveys made by me or under my supervision, and that the same is true and correct to the best of my knowledge and belief.

Date Surveyed

February 5, 1981

Registered Professional Engineer
and Land Surveyor

Fred B. Kerr Jr.
Fred B. Kerr Jr.

Certificate No.

NORTHWEST PIPELINE CORP

DAKOTA & MESA VERDE LOCATION LAYOUT

SAN JUAN 30-5 CLUT # 75

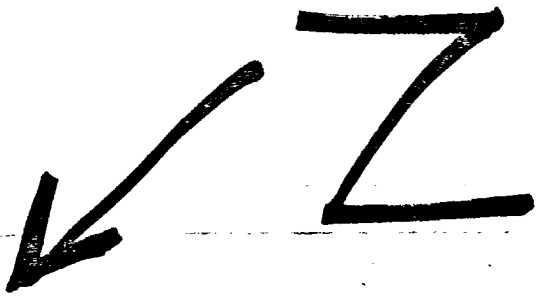
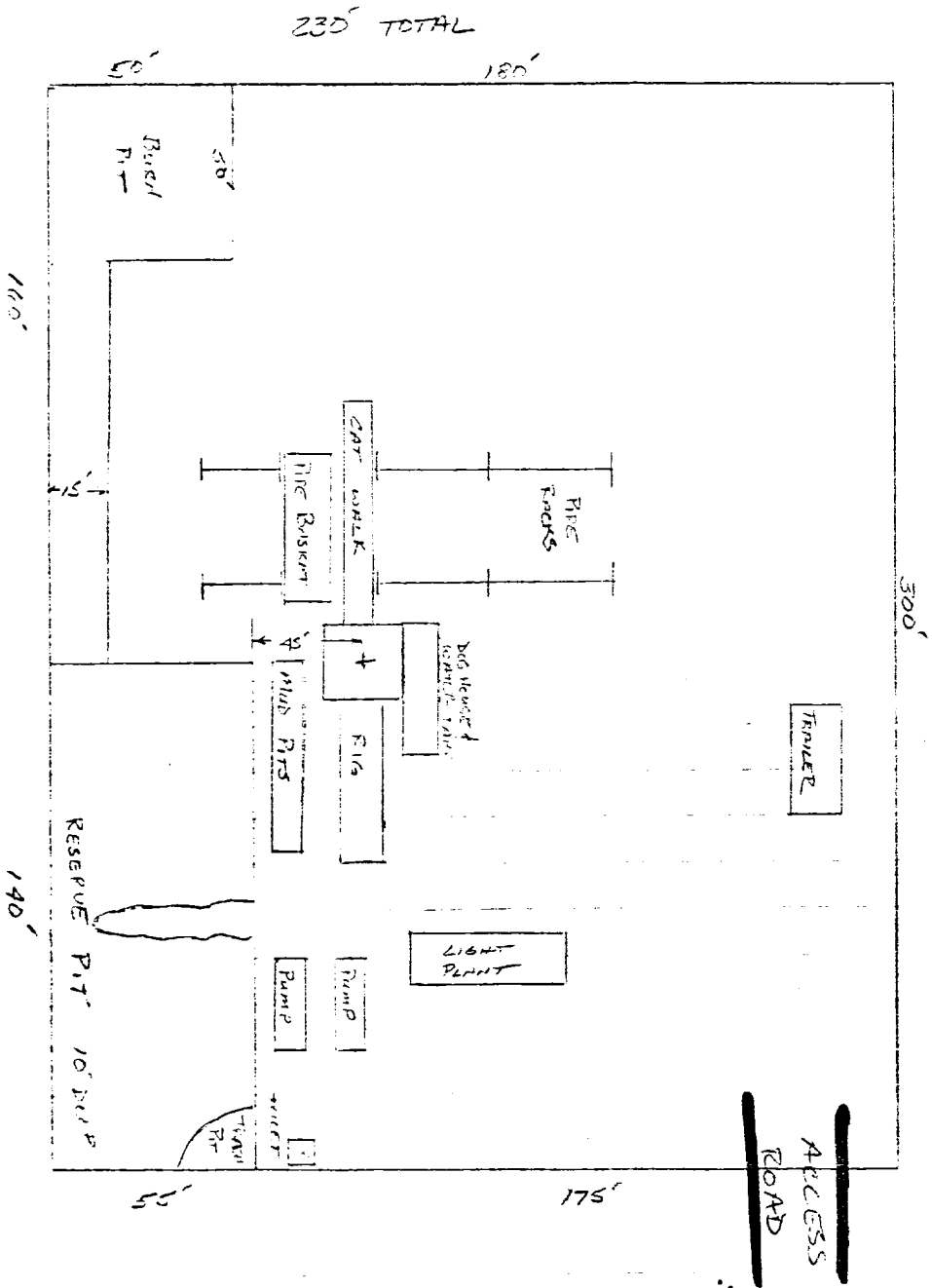

8' CUT & FILL
0' NEW ROAD

SCALE: 1 cm = 20 ft

RET