

NO. OF COPIES RECEIVED	6
DISTRIBUTION	
SANTA FE	1
FILE	1
U.S.G.S.	2
LAND OFFICE	1
OPERATOR	1

# NEW MEXICO OIL CONSERVATION COMMISSION

30 049-22963  
Form C-101  
Revised 1-1-65

EXPIRES 3-19-78

5A. Indicate Type of Lease	
STATE <input checked="" type="checkbox"/>	FEE <input type="checkbox"/>
5. State Oil & Gas Lease No.	
E 5184 - 12	

## APPLICATION FOR PERMIT TO DRILL, DEEPEN, OR PLUG BACK

1a. Type of Work		7. Unit Agreement Name	
b. Type of Well OIL WELL <input type="checkbox"/> GAS WELL <input checked="" type="checkbox"/> OTHER <input type="checkbox"/>		8. Farm or Lease Name State Com W	
2. Name of Operator Mesa Petroleum Co.		9. Well No. 19A	
3. Address of Operator Box 2009; Amarillo, Texas 79105		10. Field and Pool, or Wildcat Blanco Mesa Verde	
4. Location of Well UNIT LETTER C LOCATED 1070 FEET FROM THE North LINE AND 1650 FEET FROM THE West LINE OF SEC. 2 TWP. 30N RGE. 8W NMPM		12. County San Juan	
19. Proposed Depth 5900		19A. Formation Mesa Verde	20. Rotary or C.T. Rotary
21. Elevations (Show whether DF, RT, etc.) 6334' G.L.	21A. Kind & Status Plug. Bond State wide	21B. Drilling Contractor Young Drilling	22. Approx. Date Work will start April 1, 1978

### 23. PROPOSED CASING AND CEMENT PROGRAM

SIZE OF HOLE	SIZE OF CASING	WEIGHT PER FOOT	SETTING DEPTH	SACKS OF CEMENT	EST. TOP
17"	10 3/4	40.5#	200	300	Surf.
8 3/4"	7"	23#	3475	450	1800
6 1/4"	4 1/2	10.5#	5900	350	3475

MI and RU rotary tools. Drill 17" hole to 200' and set 10 3/4 surface csg as above. Install and test 10" 900 series blow out preventer prior to drlg. from under surface.

Dr1. 8 3/4" hole using mud with following properties: wt. 9.0, vis. 35, w.l. 15<sup>+</sup>, run and set 7" as above.

Dr1. 6 1/4" hole to 5900' using natural gas. Run open hole logs to determine if well is commercial. If commercial, run 4 1/2" liner and set as above. If noncommercial, well will be plugged according to state regulations.

No abnormal pressures, temperatures or hazardous gases are expected. Gas under this lease is dedicated.

IN ABOVE SPACE DESCRIBE PROPOSED PROGRAM: IF PROPOSAL IS TO DEEPEN OR PLUG BACK, GIVE DATA ON PRESENT PRODUCTIVE ZONE AND PROPOSED NEW PRODUCTIVE ZONE. GIVE BLOWOUT PREVENTER PROGRAM, IF ANY.

I hereby certify that the information above is true and complete to the best of my knowledge and belief.

Signed John Alexander Title Agent Date March 20, 1978  
(This space for State Use)

APPROVED BY AR Kendrick TITLE SUPERVISOR DATE March 20, 1978  
CONDITIONS OF APPROVAL, IF ANY:

NEW MEXICO OIL CONSERVATION COMMISSION  
WELL LOCATION AND ACREAGE DEDICATION PLAT

Form C-102  
Supersedes C-128  
Effective 1-1-65

All distances must be from the outer boundaries of the Section.

Operator <b>Mesa Petroleum Company</b>			Lease <b>State Com "W"</b>		Well No. <b>19A</b>
Unit Letter <b>C</b>	Section <b>2</b>	Township <b>30N</b>	Range <b>8W</b>	County <b>San Juan</b>	
Actual Footage Location of Well: <b>1070</b> feet from the <b>North</b> line and <b>1650</b> feet from the <b>West</b> line					
Ground Level Elev. <b>6334</b>	Producing Formation <b>Mesa Verde</b>		Pool <b>Blanco Mesa Verde</b>	Dedicated Acreage: <b>328.4</b> <del>320</del> Acres	

1. Outline the acreage dedicated to the subject well by colored pencil or hachure marks on the plat below.
2. If more than one lease is dedicated to the well, outline each and identify the ownership thereof (both as to working interest and royalty).
3. If more than one lease of different ownership is dedicated to the well, have the interests of all owners been consolidated by communitization, unitization, force-pooling, etc?

☐ Yes ☐ No If answer is "yes," type of consolidation \_\_\_\_\_

If answer is "no," list the owners and tract descriptions which have actually been consolidated. (Use reverse side of this form if necessary.) \_\_\_\_\_

No allowable will be assigned to the well until all interests have been consolidated (by communitization, unitization, forced-pooling, or otherwise) or until a non-standard unit, eliminating such interests, has been approved by the Commission.

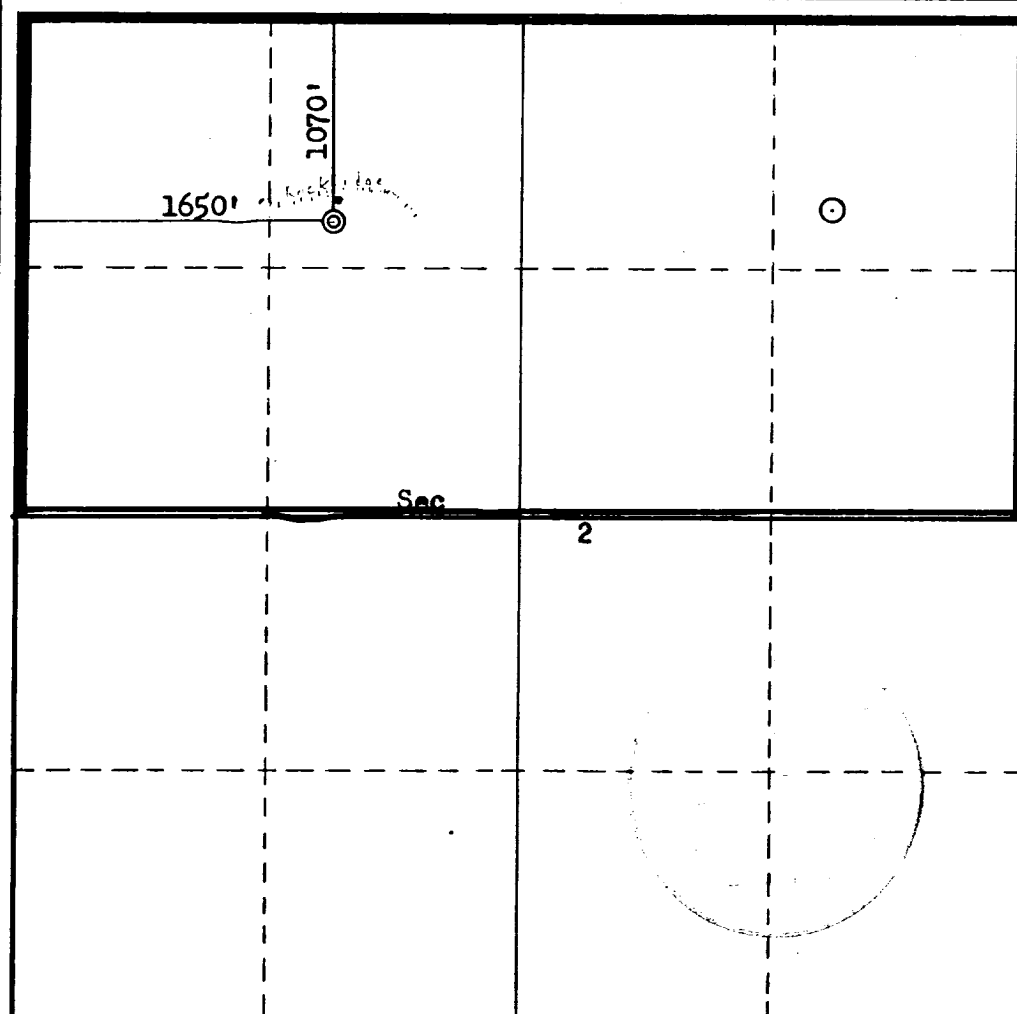

CERTIFICATION

I hereby certify that the information contained herein is true and complete to the best of my knowledge and belief.

*John Alexander*  
Name **John Alexander**  
Agent

Position  
**Mesa Petroleum Co.**

Company  
**March 20, 1978**

Date

I hereby certify that the well location shown on this plat was plotted from field notes of actual surveys made by me or under my supervision, and that the same is true and correct to the best of my knowledge and belief.

Date Surveyed  
**March 8, 1978**

Registered Professional Engineer and/or Land Surveyor

*Fred B. Kerr Jr.*  
**Fred B. Kerr Jr.**

Certificate No.

**3950**

0 330 660 990 1320 1650 1980 2310 2640 2000 1500 1000 500 0

