

**NEW MEXICO OIL CONSERVATION COMMISSION
WELL LOCATION AND ACREAGE DEDICATION PLAT**

Form C-102
Supersedes C-128
Effective 1-4-65

All distances must be from the outer boundaries of the Section.

| | | | | | |
|---|----------------------|------------------------|------------------------|---------------------------|------------------------|
| Operator PETROLEUM CORPORATION OF TEXAS | | | Lease HANLEY | | Well No. 2-A |
| Unit Letter F | Section 18 | Township 29N | Range 10W | County San Juan | |

Actual Footage Location of Well:

| | | | | | |
|-----------------------------------|---|----------|--------------------------------|---|------|
| 1780 | feet from the North | line and | 1700 | feet from the West | line |
| Ground Level Elev. 5603 | Producing Formation Fruitland | | Pool Aztec Fruitland | Dedicated Acreage: 151.41 Acres | |

1. Outline the acreage dedicated to the subject well by colored pencil or hachure marks on the plat below.
2. If more than one lease is dedicated to the well, outline each and identify the ownership thereof (both as to working interest and royalty). See Attached Schedule "A"
3. If more than one lease of different ownership is dedicated to the well, have the interests of all owners been consolidated by communitization, unitization, force-pooling, etc?

☒ Yes ☐ No If answer is "yes," type of consolidation Approved Communitization Agreement

If answer is "no," list the owners and tract descriptions which have actually been consolidated. (Use reverse side of this form if necessary.) _____

No allowable will be assigned to the well until all interests have been consolidated (by communitization, unitization, forced-pooling, or otherwise) or until a non-standard unit, eliminating such interests, has been approved by the Commission.

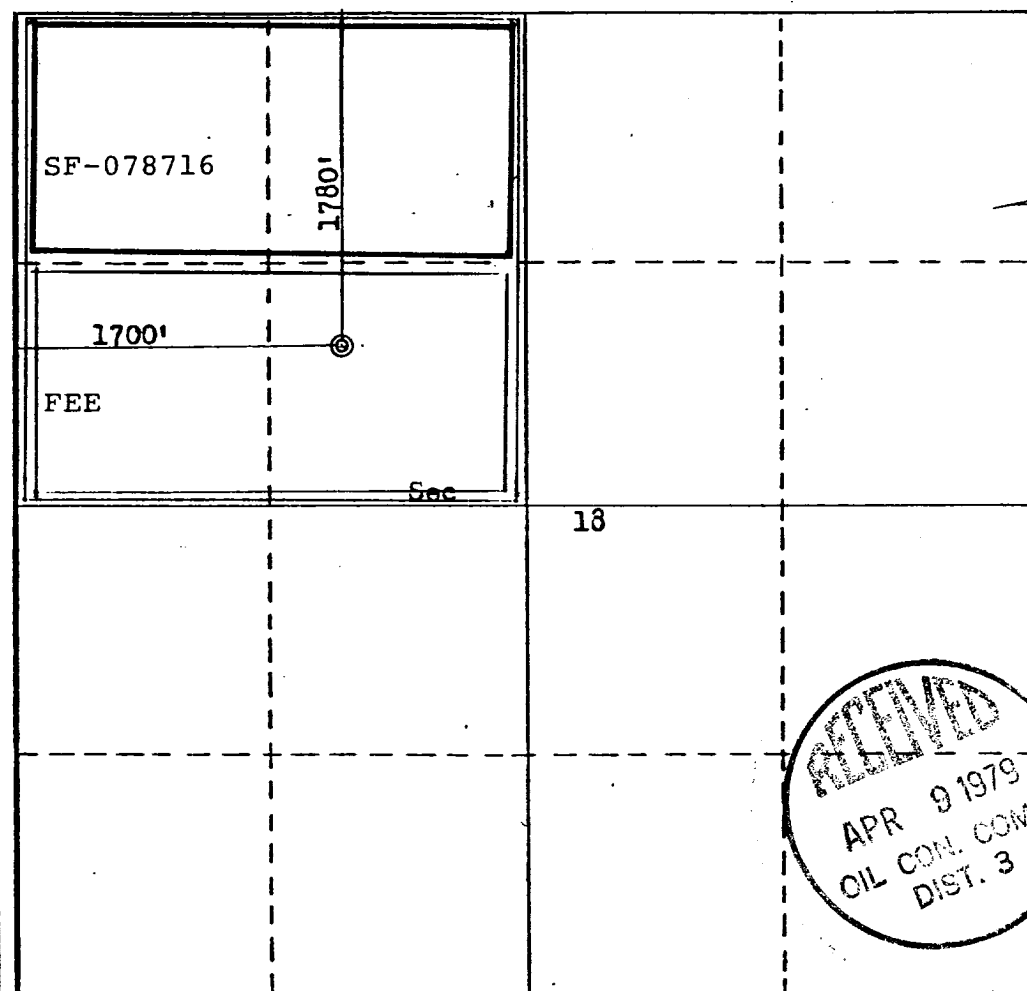

CERTIFICATION

I hereby certify that the information contained herein is true and complete to the best of my knowledge and belief.

For: Petro. Corp. of Texas

Name
Ewell N. Walsh
Position
President

Company **Walsh Engineering & Production Corp.**

Date
April 6, 1979

I hereby certify that the well location shown on this plat was plotted from field notes of actual surveys made by me or under my supervision, and that the same is true and correct to the best of my knowledge and belief.

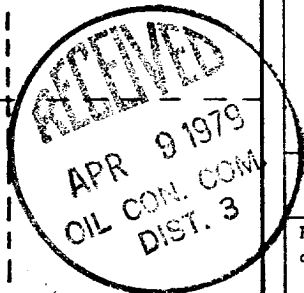

Date Surveyed
September 29, 1978
Registered Commissioner, Engineer and/or Land Surveyor
2 3950
FRANK KERR, JR.
Certification No. **3950**

PETROLEUM CORPORATION OF TEXAS
HANLEY NO. 2-A
Unit F, Section 18-T29N-R10W
San Juan County, New Mexico

SCHEDULE "A"

N/2 NW/4, Section 18-T29N-R10W

Royalty: United States of America
Working Interest: Petroleum Corporation of Texas

S/2 NW/4, Section 18-T29N-R10W

Royalty: Wilbur M. Hanley
Working Interest: Petroleum Corporation of Texas

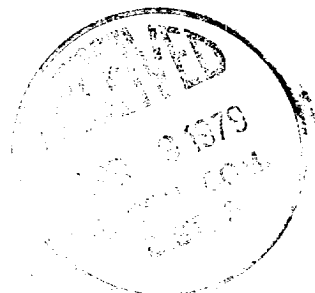

Walsh ENGINEERING & PRODUCTION CORP.

STATE OF NEW MEXICO
OIL CONSERVATION COMMISSION
1000 Rio Brazos Road
Aztec, New Mexico 87410

November 28, 1973

Petroleum Corp. of Texas
c/o Walsh Engineering & Production Corp.
PO Box 254
Farmington, New Mexico 87401

Attention: Ewell Walsh

SUBJECT: NON-STANDARD GAS PRORATION UNIT CONSISTING OF 151.41 ACRES
IN THE Aztec PC GAS POOL DESCRIBED AS
FOLLOWS:

TOWNSHIP , 29 NORTH, RANGE 10 WEST, NMPM

SECTION: 18

NW/Quarter

By authority granted me by Rule 5(B) of Order No. R-1670, as amended, the
above-described acreage has been approved as a non-standard gas proration
unit to be dedicated to the Hanley

Well No. 2, located 790/N; 1530/W of said
Section 18.

cc: Oil Conservation Commission
Santa Fe, New Mexico

Ewell C. Walsh
District Supervisor
District #3

