

NO. OF COPIES RECEIVED	5
DISTRIBUTION	
SANTA FE	1
FILE	1
U.S.G.S.	2
LAND OFFICE	
OPERATOR	1

# NEW MEXICO OIL CONSERVATION COMMISSION

30-045-23082  
Form C-101  
Revised 1-1-65

5A. Indicate Type of Lease	
STATE <input type="checkbox"/>	FEE <input checked="" type="checkbox"/>

5. State Oil & Gas Lease No.

## APPLICATION FOR PERMIT TO DRILL, DEEPEN, OR PLUG BACK

1a. Type of Work		7. Unit Agreement Name	
b. Type of Well DRILL <input checked="" type="checkbox"/> DEEPEN <input type="checkbox"/> PLUG BACK <input type="checkbox"/> OIL WELL <input type="checkbox"/> GAS WELL <input checked="" type="checkbox"/> OTHER <input type="checkbox"/> SINGLE ZONE <input type="checkbox"/> MULTIPLE ZONE <input checked="" type="checkbox"/>		8. Farm or Lease Name Sullivan	
2. Name of Operator ElPamCo, Inc.		9. Well No. #64	
3. Address of Operator P.O. Box 14738 Albuquerque, New Mexico 87111		10. Field and Pool, or Wildcat Aztec Fruitland Aztec Pictured Cliffs	
4. Location of Well UNIT LETTER G LOCATED 1640 FEET FROM THE North LINE AND 1580 FEET FROM THE East LINE OF SEC. 25 TWP. 29N RGE. 11W NMPM		12. County San Juan	
19. Proposed Depth 1900'		19A. Formation Pictured Cliffs	
20. Rotary or C.T. Rotary		21. Elevations (Show whether DF, RT, etc.) 5466 Gr.	
21A. Kind & Status Plug. Bond Blanket		21B. Drilling Contractor Wilson	
22. Approx. Date Work will start 11-19-1978			

23.

## PROPOSED CASING AND CEMENT PROGRAM

SIZE OF HOLE	SIZE OF CASING	WEIGHT PER FOOT	SETTING DEPTH	SACKS OF CEMENT	EST. TOP
10-3/4	7	24	86	100	Circ
6-1/4	4 1/2	9.5	1900	200	Circ

Drill, case, frac, and prepare well for commingle production and pipeline connection.

It is understood by the operator that a hearing and approved order from N.M.O.C.C. to authorize commingled production will be required prior to first delivery.

UNIT GAS PRODUCTION is dedicated to EPNG.

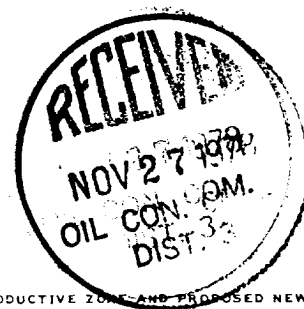

IN ABOVE SPACE DESCRIBE PROPOSED PROGRAM: IF PROPOSAL IS TO DEEPEN OR PLUG BACK, GIVE DATA ON PRESENT PRODUCTIVE ZONE AND PROPOSED NEW PRODUCTIVE ZONE. GIVE BLOWOUT PREVENTER PROGRAM, IF ANY.

I hereby certify that the information above is true and complete to the best of my knowledge and belief.

Signed Claude C. Kennedy Title Agent Date 11-21-1978

(This space for State Use)

APPROVED BY Frank E. Carg TITLE DEPUTY OIL & GAS INSPECTOR, DIST. #3 DATE NOV 27 1978

CONDITIONS OF APPROVAL, IF ANY:

NEW MEXICO OIL CONSERVATION COMMISSION  
WELL LOCATION AND ACREAGE DEDICATION PLAT

Form C-102  
Supersedes C-124  
Effective 1-1-65

All distances must be from the outer boundaries of the Section.

Operator <b>ElPamCo, Inc.</b>		Lease <b>Sullivan</b>		Well No. <b>#6A</b>
Unit Letter <b>G</b>	Section <b>25</b>	Township <b>29 North</b>	Range <b>11 West</b>	County <b>San Juan</b>
Actual Footage Location of Well: <b>1640</b> feet from the <b>North</b> line and <b>1580</b> feet from the <b>East</b> line				
Ground Level Elev. <b>5466</b>	Producing Formation <b>Fruitland-Pictured Cliffs</b>	Pool <b>Aztec Fruitland Aztec Pictured Cliffs</b>	Dedicated Acreage: <b>160</b> Acres	

1. Outline the acreage dedicated to the subject well by colored pencil or hachure marks on the plat below.
2. If more than one lease is dedicated to the well, outline each and identify the ownership thereof (both as to working interest and royalty).
3. If more than one lease of different ownership is dedicated to the well, have the interests of all owners been consolidated by communitization, unitization, force-pooling, etc?

☐ Yes ☐ No If answer is "yes," type of consolidation \_\_\_\_\_

If answer is "no," list the owners and tract descriptions which have actually been consolidated. (Use reverse side of this form if necessary.) \_\_\_\_\_

No allowable will be assigned to the well until all interests have been consolidated (by communitization, unitization, forced-pooling, or otherwise) or until a non-standard unit, eliminating such interests, has been approved by the Commission.

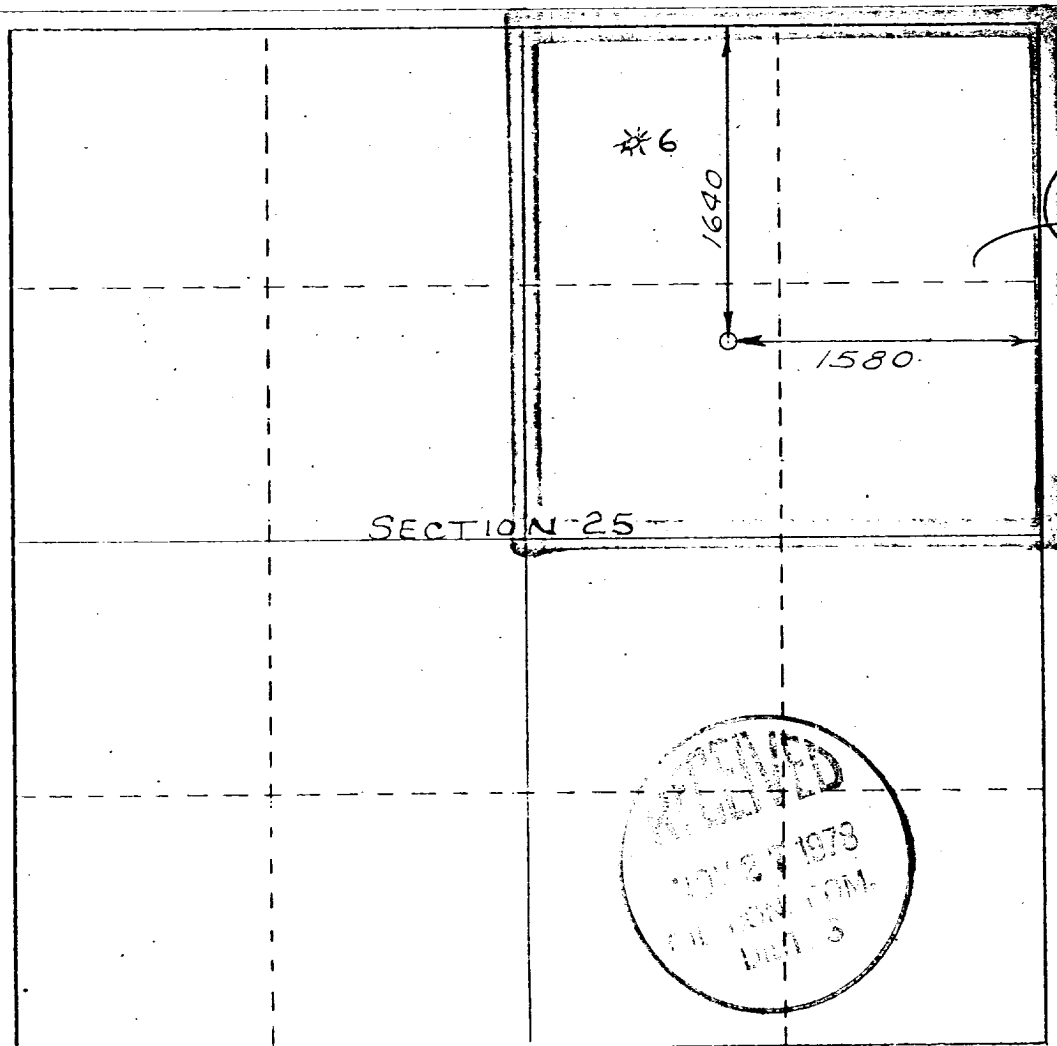

CERTIFICATION

I hereby certify that the information contained herein is true and complete to the best of my knowledge and belief.

Name  
**Claude C. Kennedy**

Position  
**Agent**

Company  
**ElPamCo, Inc.**

Date  
**Nov. 21, 1978**

I hereby certify that the well location shown on this plat was plotted from field notes of actual surveys made by me or under my supervision, and that the same is true and correct to the best of my knowledge and belief.

Date Surveyed  
**November 17, 1978**  
Registered Professional Engineer  
and of the State of New Mexico  
**Russell H. H. H. H.**  
Certificate No. **1500**

0 330 660 990 1320 1650 1980 2310 2640 2970 3300 3630 3960 4290 4620 4950 5280 5610 5940 6270 6600