

Risk-behoef

Unit: G

Sec: 19
Land Type: BLM
Pit Closure Date: 05/11/94

C:\Documents and Settings\lxs6441\Local Settings\Temporary Internet Files\OLK3\9440394404.doc

1100

ORIGINAL PIT LOCATION

ORIGINAL PIT LOCATION

Original Pit : a) Degrees from North 58° Footage from Wellhead 106'
b) Length : 29' Width : 27' Depth : 4'

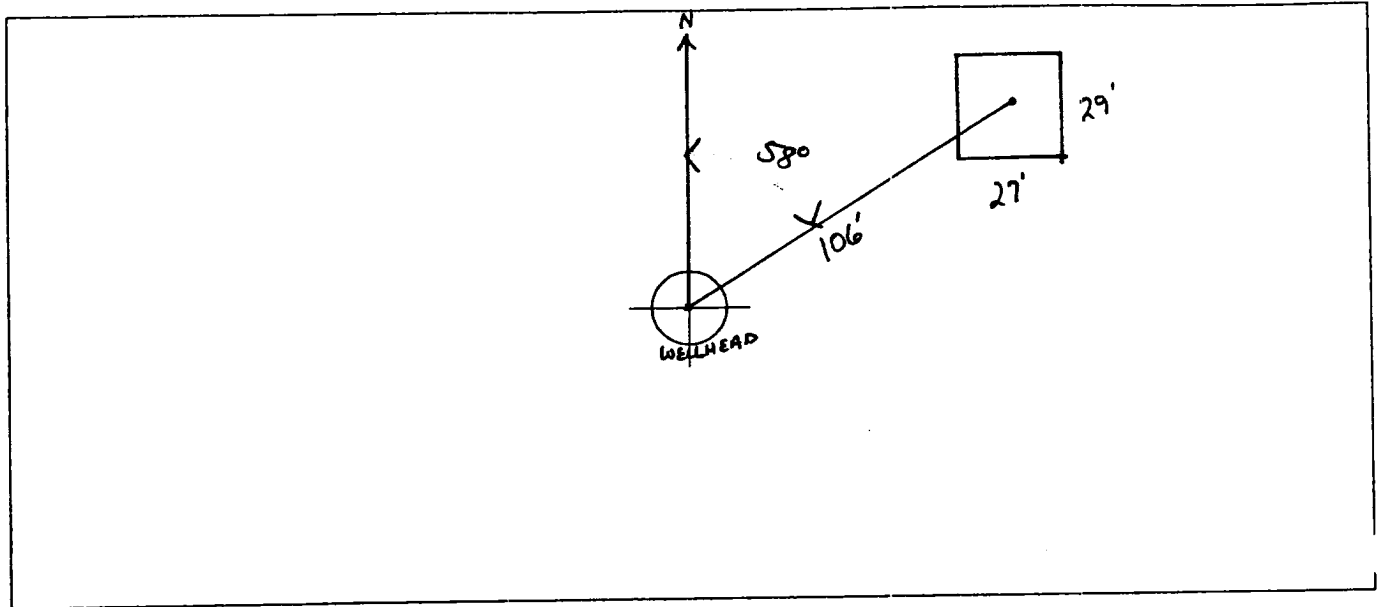

REMARKS

Remarks :

TOOK PICTURES AT 1:24 P.M.

END DUMP

Completed By:

Ed Thompson

Signature

4-27-94

Date



20

FIELD SERVICES LABORATORY
ANALYTICAL REPORT
PIT CLOSURE PROJECT - Soil

SAMPLE IDENTIFICATION

	Field ID	Lab ID
SAMPLE NUMBER:	KD 52	945124
MTR CODE SITE NAME:	94404 / 94403	N/A
SAMPLE DATE TIME (Hrs):	5-11-94	1400
SAMPLED BY:	N/A	
DATE OF TPH EXT. ANAL.:	5-12-94	5-12-94
DATE OF BTEX EXT. ANAL.:	5/17/94	5/18/94
TYPE DESCRIPTION:	VC	Black Sand

REMARKS:

RESULTS

PARAMETER	RESULT	UNITS	QUALIFIERS			
			DF	Q	M(g)	V(ml)
BENZENE	60.50	MG/KG	20			
TOLUENE	4.1	MG/KG	20			
ETHYL BENZENE	10	MG/KG	20			
TOTAL XYLENES	140	MG/KG	20			
TOTAL BTEX	155	MG/KG				
TPH (418.1) 19,600	19590 19590	MG/KG			55	28
HEADSPACE PID	594	PPM				
PERCENT SOLIDS	93.8	%				

- TPH is by EPA Method 418.1 and BTEX is by EPA Method 8020 -

The Surrogate Recovery was at 182 % for this sample All QA/QC was acceptable.

Nive:

HTI results attached. Surrogate recovery was outside
ATI QC limits due to matrix interference.

DF = Dilution Factor Used

Approved By:

John Fard

Date:

7/14/94



Analytical Technologies, Inc.

GAS CHROMATOGRAPHY RESULTS

TEST : BTEX (EPA 8020)
CLIENT : EL PASO NATURAL GAS CO. ATI I.D.: 405359
PROJECT # : 24324
PROJECT NAME : PIT CLOSURE

SAMPLE ID. #	CLIENT I.D.	MATRIX	DATE SAMPLED	DATE EXTRACTED	DATE ANALYZED	DIL. FACTOR
07	945124	NON-AQ	05/11/94	05/17/94	05/18/94	20
08	945125	NON-AQ	05/11/94	05/17/94	05/18/94	50
09	945126	NON-AQ	05/11/94	05/17/94	05/18/94	1

PARAMETER	UNITS	07	08	09
BENZENE	MG/KG	<0.50	5.7	<0.025
TOLUENE	MG/KG	4.1	130	<0.025
ETHYLBENZENE	MG/KG	10	57	<0.025
TOTAL XYLENES	MG/KG	140	780	0.057

SURROGATE:

BROMOFLUOROBENZENE (%)	182*	NA**	96
------------------------	------	------	----

*OUTSIDE ATI QUALITY CONTROL LIMITS DUE TO MATRIX INTERFERENCE

**SURROGATE RECOVERY NOT OBTAINABLE DUE TO SAMPLE DILUTION



Analytical **Technologies**, Inc.

2709-D Pan American Freeway, NE Albuquerque, NM 87107
Phone (505) 344-3777 FAX (505) 344-4413

ATI I.D. 405359

May 25, 1994

El Paso Natural Gas Company
P.O. Box 4990
Farmington, NM 87499

Project Name/Number: PIT CLOSURE 24324

Attention: John Lambdin

On 05/13/94, Analytical Technologies, Inc., (ADHS License No. AZ0015), received a request to analyze **non-aqueous** samples. The samples were analyzed with EPA methodology or equivalent methods. The results of these analyses and the quality control data, which follow each set of analyses, are enclosed.

EPA Method 418.1 analysis was added for sample 945125 on 05/17/94.

If you have any questions or comments, please do not hesitate to contact us at (505) 344-3777.

Letitia Krakowski, Ph.D.
Project Manager

H. Mitchell Rubenstein, Ph.D.
Laboratory Manager

MR:jd

Enclosure



FIELD PIT REMEDIATION/CLOSURE FORM

GENERAL	<p>Meter: <u>94404</u> <u>94403</u> Location: <u>Florance #111 DK & PC</u></p> <p>Coordinates: Letter: <u>6</u> Section <u>19</u> Township: <u>30</u> Range: <u>8</u></p> <p>Or Latitude _____ Longitude _____</p> <p>Date Started : <u>5-11-94</u> Area: <u>10</u> Run: <u>22</u></p>
OBSERVATIONS	<p>Sample Number(s): <u>KD52</u></p> <p>Sample Depth: <u>12'</u> Feet</p> <p>Final PID Reading <u>594 PPM</u> PID Reading Depth <u>12'</u> Feet</p> <p>Yes No</p> <p>Groundwater Encountered <input type="checkbox"/> (1) <input checked="" type="checkbox"/> (2) Approximate Depth _____ Feet</p>
CLOSURE	<p>Remediation Method :</p> <p>Excavation <input checked="" type="checkbox"/> (1) Approx. Cubic Yrds <u>95</u></p> <p>Onsite Bioremediation <input type="checkbox"/> (2)</p> <p>Backfill Pit Without Excavation <input type="checkbox"/> (3)</p> <p>Soil Disposition:</p> <p>Envirotech <input type="checkbox"/> (1) <input checked="" type="checkbox"/> (3) Tierrc</p> <p>Other Facility <input type="checkbox"/> (2) Name: _____</p> <p>Pit Closure Date: <u>5-11-94</u> Pit Closed By: <u>BET</u></p>
REMARKS	<p>Remarks : <u>Very Large Pit - Cobble Layer started At About 4ft. Took Excavation to 12' Took PID Sample, Closed Pit</u></p>

Remediation



CHAIN OF CUSTODY RECORD

Page 1 of 1

PROJECT NUMBER		PROJECT NAME		CONTACT LABORATORY P. O. NUMBER	
Pit Closure Project # 24324 <td colspan="2">DATE: 5-11-94<td colspan="2"></td></td>		DATE: 5-11-94 <td colspan="2"></td>			
SAMPLERS: (Signature) <i>Kenny Deaver</i>		SAMPLE NUMBER		REMARKS	
LAB ID	DATE	TIME	MATRIX	SAMPLE TYPE	TPH EPA 418.1
5123	5-11-94	0920	Soil	VC	X
5124	5-11-94	1600	Soil	VC	X
[The following rows are crossed out with a diagonal line]					
REQUESTED ANALYSIS					
EPA 8020 BTEX					
EPA 418.1 TPH					
TOTAL NUMBERS OF CONTAINERS					
DATE/TIME RECEIVED BY: (Signature) <i>Kenny Deaver</i> 1800 5-11-94					
DATE/TIME RELINQUISHED BY: (Signature) <i>John T. Dore</i> 3209					
DATE/TIME RECEIVED BY: (Signature) <i>John T. Dore</i> 5/12/94 1245					
DATE/TIME RELINQUISHED BY: (Signature) <i>John T. Dore</i>					
REQUESTED TURNAROUND TIME: <input type="checkbox"/> ROUTINE <input type="checkbox"/> RUSH					
CARRIER CO.					
SAMPLE RECEIPT REMARKS					
RESULTS & INVOICES TO:					
FIELD SERVICES LABORATORY					
EL PASO NATURAL GAS COMPANY					
P. O. BOX 4990					
FARMINGTON, NEW MEXICO 87499					
FAX: 505-599-2261					
BILL NO.:					
CHARGE CODE					

RECORD OF SUBSURFACE EXPLORATION

Philip Environmental Services Corp.

4000 Monroe Road

Farmington, New Mexico 87401

(505) 326-2262 FAX (505) 326-2388

Borehole #

BH-1

Well #

Page

1 of 1

Project Name

EPNG Pits

Project Number

14509

Phase

601

Project Location

Elevation

Borehole Location

GWL Depth

Logged By

S.Kelly

Drilled By

M. Donohue

Date/Time Started

6/15/95, 0925

Date/Time Completed

6/16/95, 0950

Well Logged By

S.Kelly

Personnel On-Site

M. Donohue, J. O'Keefe

Contractors On-Site

Client Personnel On-Site

Drilling Method

4 1/4" HSA ID

Air Monitoring Method

CGI, PID

Depth (Feet)	Sample Number	Sample Interval	Sample Type & Recovery (inches)	Sample Description Classification System: USCS	USCS Symbol	Depth Lithology Change (feet)	Air Monitoring Units: NDUS/HS BZ BH S			Drilling Conditions & Blow Counts
0				Backfill to 12'						
5										
10	1	10-12.5'	.5'	cobble at 9'						
15	2	12.5-14.5'	.4'	SAND, dk grey, med. to coarse, with fine to med. gravel 15-20% subangular, loose dry.		OK 6/15/95	0	0	175 1611	at 0940
20				BoH - 14.5			03	3	174	at 0950 not enough sample
25										
30										
35										
40										

Comments:

Auger refusal at 12.5. No sample taken due to high
hardness readings at refusal. BH grouted to
surface.

Geologist Signature

Paul Kelly

RECORD OF SUBSURFACE EXPLORATION

Philip Environmental Services Corp.

4000 Monroe Road

Farmington, New Mexico 87401

(505) 328-2282 FAX (505) 326-2388

Borehole # BH-1
Well # 1
Page 1 of 1

Project Name EPNG Pits
Project Number 14509 Phase 601
Project Location Florence #111DKa PC, 94403, 94404

Well Logged By S. Kelly
Personnel On-Site M. Donohue, J. O'Keefe
Contractors On-Site
Client Personnel On-Site

Elevation
Borehole Location
GWL Depth
Logged By S. Kelly
Drilled By M. Donohue
Date/Time Started 6/15/95, 0925
Date/Time Completed 6/15/95, 0950

Drilling Method 4 1/4" HSP ID
Air Monitoring Method CGI, PID

Depth (Feet)	Sample Number	Sample Interval	Sample Type & Recovery (inches)	Sample Description Classification System: USCS	USCS Symbol	Depth Lithology Change (feet)	Air Monitoring Units: NDUs <u>5/15</u> BZ BH S			Drilling Conditions & Blow Counts
0				Backfill to 12'						
5										
10	1	10-12.5'		cobble at 9'						
12.5	2	12.5-14.5'		SAND, dk grey, med. to coarse, with fine to med. gravel 15-20% subangular, loose dry.			0	0	175	at 0940
15							03	3	174	at 0950
20				BoH - 14.5						not enough sample
25				NEEDS A LOCATION PLEASE!						
30										
35										
40										

Comments:

Ruger refusal at 12.5. No sample taken due to high headspace readings at refusal. BH grouted to surface.

Geologist Signature

Sarah Kelly

ILLEGIBLE



Page _____ of _____

White - Testing Laboratory Canary - EPNG Lab Pink - Field Sampler



FIELD SERVICES LABORATORY
ANALYTICAL REPORT

PIT CLOSURE PROJECT - Soil Samples Inside the GWV Zone

SAMPLE IDENTIFICATION

	Field ID	Lab ID
SAMPLE NUMBER:	JP99	947830
MTR CODE SITE NAME:	94403/94404	Florange #111 DK? PC
SAMPLE DATE TIME (Hrs):	12-4-95	1130
PROJECT:	Phase III Excavation	
DATE OF TPH EXT. ANAL.:	12/6/95	
DATE OF BTEX EXT. ANAL.:	12/6/95	12/6/95
TYPE DESCRIPTION:	VC	Light brown sand

Field Remarks: (N-03)(S-01)(E-21)(W-13)

RESULTS

PARAMETER	RESULT	UNITS	QUALIFIERS			
			DF	Q	M(g)	V(ml)
BENZENE	< 0.5	MG/KG				
TOLUENE	0.6	MG/KG				
ETHYL BENZENE	0.7	MG/KG				
TOTAL XYLENES	7.9	MG/KG				
TOTAL BTEX	8.2	MG/KG				
TPH (418.1)	1120	MG/KG			1.97	28
HEADSPACE PID	1433	PPM				?
PERCENT SOLIDS	96.0	%				

- TPH is by EPA Method 418.1 and BTEX is by EPA Method 8020 -

The Surrogate Recovery was at
Narrative:

91% for this sample All QA/QC was acceptable.

DF = Dilution Factor Used

Approved By:

Date:

12/7/95

BTEX SOIL SAMPLE WORKSHEET

File	:	947830	Date Printed	:	12/7/95
Soil Mass (g)	:	5.06	Multiplier (L/g)	:	0.00099
Extraction vol. (mL)	:	10	CAL FACTOR (Analytical):		200
Shot Volume (uL)	:	50	CAL FACTOR (Report):		0.19763
			DILUTION FACTOR:	1	Det. Limit
Benzene (ug/L)	:	0.00	Benzene (mg/Kg):	0.000	0.494
Toluene (ug/L)	:	2.88	Toluene (mg/Kg):	0.569	0.494
Ethylbenzene (ug/L)	:	3.40	Ethylbenzene (mg/Kg):	0.672	0.494
p & m-xylene (ug/L)	:	30.79	p & m-xylene (mg/Kg):	6.085	0.988
o-xylene (ug/L)	:	8.93	o-xylene (mg/Kg):	1.765	0.494
			Total xylenes (mg/Kg):	7.850	1.482
			Total BTEX (mg/Kg):	9.091	