

District I
P O Box 1980, Hobbs, NM

District II
P O Drawer DD, Artesia, NM 88221

District III
1000 Rio Brazos Rd, Aztec, NM 87410

State of New Mexico
Energy, Minerals and Natural Resources Department

OIL CONSERVATION DIVISION

2040 South Pacheco Street
Santa Fe, New Mexico 87505

SUBMIT COPY TO
DISTRICT OFFICE
SANTA FE OFFICE

RECEIVED
NOV - 1 1999
OIL CON. DIV.
DIST. 3

PIT REMEDIATION AND CLOSURE REPORT

Operator: PNM Gas Services (Burlington)		Telephone: 324-3764	
Address: 603 W. Elm Street Farmington, NM 87401			
Facility or Well Name: Hare #22A			
Location:	Unit <u>I</u>	Sec <u>14</u>	T <u>29 N</u> R <u>10 W</u> County <u>San Juan</u>
Pit Type:	Separator <input type="checkbox"/>	Dehydrator <input checked="" type="checkbox"/>	Other _____
Land Type:	BLM <input checked="" type="checkbox"/>	State <input type="checkbox"/>	Fee <input type="checkbox"/> Other _____
Pit Location:	Pit dimensions: length <u>12</u> ' width <u>12</u> ' depth <u>3</u> '		
(Attach diagram)	Reference: wellhead <input checked="" type="checkbox"/> other _____		
	Footage from reference: <u>93</u> ' _____		
	Direction from reference: <u>90</u> Degrees <input type="checkbox"/> East <input checked="" type="checkbox"/> North <input checked="" type="checkbox"/> West <input type="checkbox"/> South _____		
Depth to Ground Water:			
(Vertical distance from contaminants to seasonal high water elevation of ground water)			
Less than 50 feet (20 points)			
50 feet to 99 feet (10 points)			
Greater than 100 feet (0 points) <u>0</u>			
Wellhead Protection Area:			
(Less than 200 feet from a private domestic water source, or; less than 1,000 feet from all other water sources)			
Yes (20 points)			
No (0 points) <u>0</u>			
Distance to Surface Water:			
(Horizontal distance to perennial lakes, ponds, rivers, streams, creeks, irrigation canals and ditches)			
Less than 200 feet (20 points)			
200 feet to 1,000 feet (10 points)			
Greater than 1,000 feet (0 points) <u>0</u>			
RANKING SCORE (TOTAL POINTS): <u>0</u>			

Harc #22A

Date Remediation Started: 07/06/1999

Date Completed: 07/06/1999

Remediation Method:

Excavation ☒

Approx. Cubic Yard 223

(Check all appropriate sections)

Landfarmed ☒

Amount Landfarmed (cubic yds) 200

Other 23 cu yds overburden.

Remediation Location:

Onsite ☒Offsite ☐

(i.e., landfarmed onsite, name and location of offsite facility)

Backfill Material Location:

General Description of Remedial Action:

Excavated contaminated soil to a pit size of 18.5' X 25' X 13' and landfarmed soil onsite within a bermed area at a depth of 6" to 12". Soil was aerated by disking/plowing until soil met regulatory levels.

Ground Water Encountered:

No ☒Yes ☐

Depth

Final Pit Closure Sampling:

Sample Location

5 pt. composite - bottom.

(if multiple samples, attach sample result and diagram of sample locations and depths.)

Sample depth

13'

Sample date

07/06/1999

Sample time

12:50:00 PM

Sample Results

Benzene (ppm) < 0.025

Total BTEX (ppm) 1.731

Field headspace (ppm)

TPH (ppm)

65.00

Method

8015B

Vertical Extent (ft)

Risk Analysis form attached Yes ☐ No ☒

Ground Water Sample:

Yes ☐No ☒

(If yes, see attached Groundwater Site Summary Report)

I HEREBY CERTIFY THAT THE INFORMATION ABOVE IS TRUE AND COMPLETE TO THE BEST OF MY KNOWLEDGE AND MY BELIEF

DATE October 28, 1999

SIGNATURE

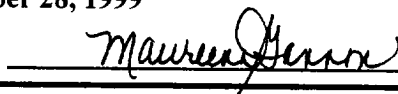

PRINTED NAME Maureen Gannon
AND TITLE Project Manager

11

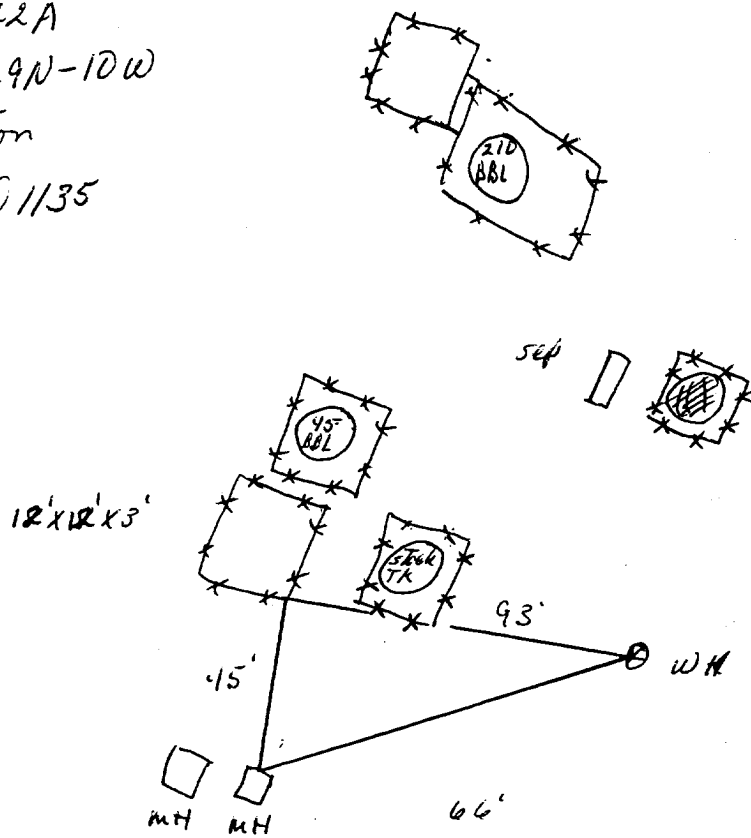
$$18.5(N+S) \times 25'(E+W) \times 13'(D)$$

5' - 1523 ppm
10' - 2999 ppm
15' - 2999 ppm

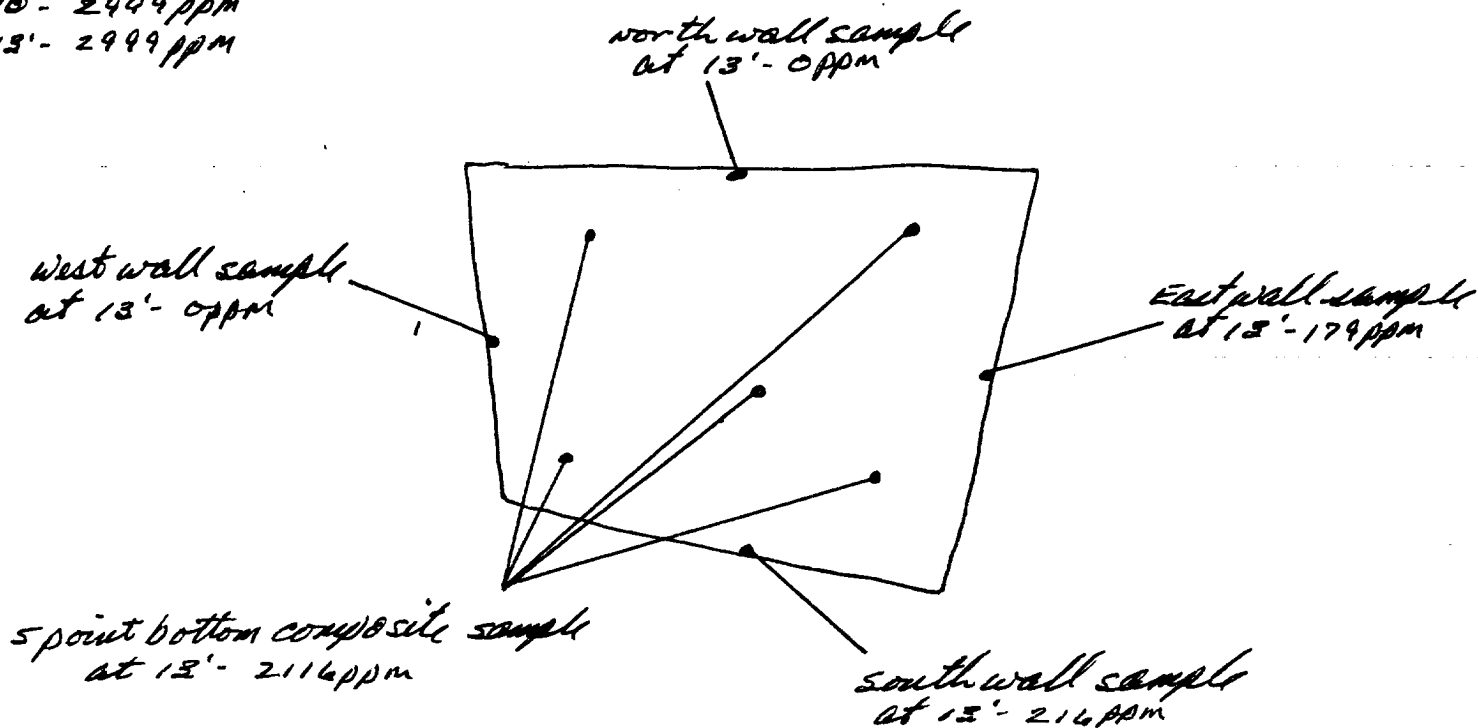

not to scale

OFF: (505) 325-5667



LAB: (505) 325-1556

On Site Technologies, LTD.

Date: 20-Jul-99

CLIENT: PNM - Public Service Company of NM
Project: PNM Pit Remediation
Lab Order: 9907009

CASE NARRATIVE

Samples were analyzed using the methods outlined in the following references:

Test Methods for Evaluating Solid Waste, Physical/Chemical Methods, SW846, 3rd Edition

All method blanks, laboratory spikes, and/or matrix spikes met quality assurance objectives.

KAY

OFF: (505) 325-5667



LAB: (505) 325-1556

ANALYTICAL REPORT

Date: 20-Jul-99

Client:	PNM - Public Service Company of NM	Client Sample Info:	Hare #22A
Work Order:	9907009	Client Sample ID:	9907061250; 5pt. Bottom Comp
Lab ID:	9907009-03A	Matrix:	SOIL
Project:	PNM Pit Remediation	Collection Date:	7/6/99 12:50:00 PM
		COC Record:	7644

Parameter	Result	PQL	Qual	Units	DF	Date Analyzed
DIESEL RANGE ORGANICS		SW8015B				Analyst: DC
T/R Hydrocarbons: C10-C28	65	25		mg/Kg	1	7/16/99
AROMATIC VOLATILES BY GC/PID		SW8021B				Analyst: DC
Benzene	ND	25		µg/Kg	25	7/12/99
Toluene	61	50		µg/Kg	25	7/12/99
Ethylbenzene	150	25		µg/Kg	25	7/12/99
m,p-Xylene	1200	50		µg/Kg	25	7/12/99
o-Xylene	320	25		µg/Kg	25	7/12/99

1731
1.731 ppm

Qualifiers:

- PQL - Practical Quantitation Limit
- ND - Not Detected at Practical Quantitation Limit
- J - Analyte detected below Practical Quantitation Limit
- B - Analyte detected in the associated Method Blank

- S - Spike Recovery outside accepted recovery limits
- R - RPD outside accepted recovery limits
- E - Value above quantitation range
- Surr: - Surrogate

1 of 1

P.O. BOX 2606 • FARMINGTON, NM 87499

OFF: (505) 325-5667



LAB: (505) 325-1556

ANALYTICAL REPORT

Date: 20-Jul-99

Client:	PNM - Public Service Company of NM	Client Sample Info:	Hare #22A
Work Order:	9907009	Client Sample ID:	9907061255; 4pt. Wall Comp
Lab ID:	9907009-04A	Matrix:	SOIL
Project:	PNM Pit Remediation	Collection Date:	7/6/99 12:55:00 PM
		COC Record:	7644

Parameter	Result	PQL	Qual	Units	DF	Date Analyzed
DIESEL RANGE ORGANICS		SW8015B				
T/R Hydrocarbons: C10-C28	ND	25		mg/Kg	1	Analyst: DC 7/16/99

Qualifiers:

PQL - Practical Quantitation Limit
ND - Not Detected at Practical Quantitation Limit
J - Analyte detected below Practical Quantitation Limit
B - Analyte detected in the associated Method Blank

S - Spike Recovery outside accepted recovery limits
R - RPD outside accepted recovery limits
E - Value above quantitation range
Surr: - Surrogate

1 of 1

P.O. BOX 2606 • FARMINGTON, NM 87499

Sec. 14 T29N R10W Unit I
Burlington

Land farm Drawing

App 200 cu.yds

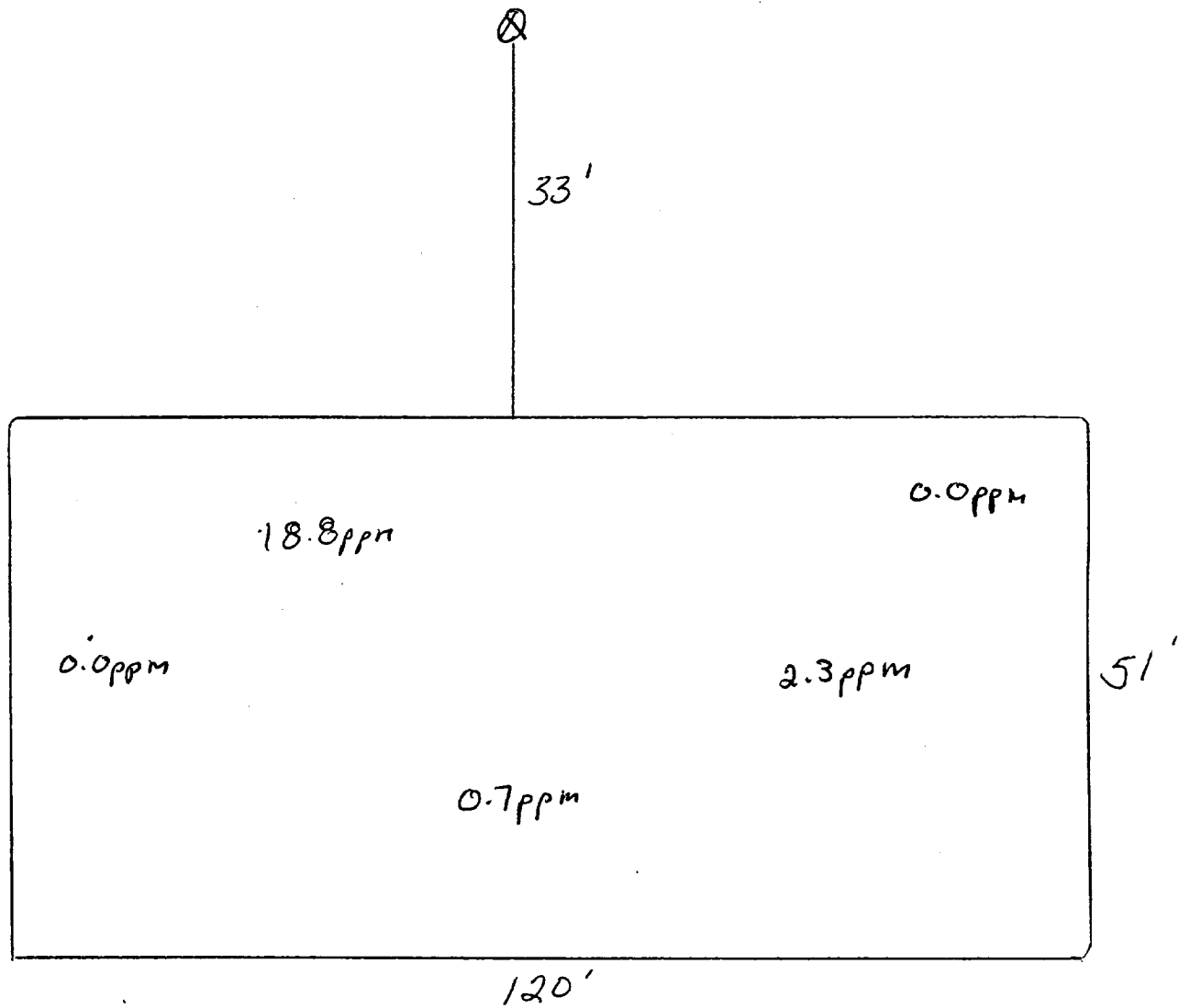

2" to 12" Depth
Headspace 7.5ppm
Sample # 9907191735

Not to scale

OFF: (505) 325-5667



LAB: (505) 325-1556

On Site Technologies, LTD.

Date: 04-Aug-99

CLIENT: PNM - Public Service Company of NM

Project: PNM Pit Remediation Landfarms

Lab Order: 9907047

CASE NARRATIVE

Samples were analyzed using the methods outlined in the following references:

Test Methods for Evaluating Solid Waste, Physical/Chemical Methods, SW846, 3rd Edition

All method blanks, laboratory spikes, and/or matrix spikes met quality assurance objectives.

OFF: (505) 325-5667



LAB: (505) 325-1556

ANALYTICAL REPORT

Date: 04-Aug-99

Client:	PNM - Public Service Company of NM	Client Sample Info:	Hare 22A LF
Work Order:	9907047	Client Sample ID:	9907191735; 5pt Composite
Lab ID:	9907047-02A	Matrix:	SOIL
Project:	PNM Pit Remediation Landfarms	Collection Date:	7/19/99 5:35:00 PM
		COC Record:	7493

Parameter	Result	PQL	Qual	Units	DF	Date Analyzed
DIESEL RANGE ORGANICS		SW8015B				Analyst: DC
T/R Hydrocarbons: C10-C28	290	25		mg/Kg	1	7/30/99

Qualifiers:

PQL - Practical Quantitation Limit
ND - Not Detected at Practical Quantitation Limit
J - Analyte detected below Practical Quantitation Limit
B - Analyte detected in the associated Method Blank

S - Spike Recovery outside accepted recovery limits
R - RPD outside accepted recovery limits
E - Value above quantitation range
Surr: - Surrogate

1 of 1

P.O. BOX 2606 • FARMINGTON, NM 87499

- TECHNICAL SOLUTIONS PROVIDING WITH THE ENVIRONMENT -