

NO. OF COPIES RECEIVED	6
DISTRIBUTION	
SANTA FE	1
FILE	
U.S.G.S.	2
LAND OFFICE	
OPERATOR	1

NEW MEXICO OIL CONSERVATION COMMISSION

30-095-23661  
Form C-101  
Revised 1-1-65

5A. Indicate Type of Lease
STATE <input checked="" type="checkbox"/> FEE <input type="checkbox"/>
5. State Oil & Gas Lease No.
<b>E-1686</b>

APPLICATION FOR PERMIT TO DRILL, DEEPEN, OR PLUG BACK

1a. Type of Work	7. Unit Agreement Name		
b. Type of Well OIL WELL <input type="checkbox"/> GAS WELL <input checked="" type="checkbox"/> OTHER <input type="checkbox"/>	8. Farm or Lease Name		
DRILL <input checked="" type="checkbox"/> DEEPEN <input type="checkbox"/> PLUG BACK <input type="checkbox"/>	<b>State Gas Com "BR"</b>		
2. Name of Operator	9. Well No.		
<b>AMOCO PRODUCTION COMPANY</b>	<b>1</b>		
3. Address of Operator	10. Field and Pool, or Wildcat		
<b>501 Airport Drive, Farmington, New Mexico 87401</b>	<b>San Juan Basin Dakota</b>		
4. Location of Well UNIT LETTER <b>E</b> LOCATED <b>1450</b> FEET FROM THE <b>North</b> LINE AND <b>1170</b> FEET FROM THE <b>West</b> LINE OF SEC. <b>2</b> TWP. <b>29-N</b> RGE. <b>10-W</b> NMPM	12. County		
	<b>San Juan</b>		
19. Proposed Depth	19A. Formation	20. Rotary or C.T.	
<b>7100'</b>	<b>Dakota</b>	<b>Rotary</b>	
21. Elevations (Show whether DF, RT, etc.)	21A. Kind & Status Plug. Bond	21B. Drilling Contractor	22. Approx. Date Work will start
<b>5924' GL</b>	<b>Statewide</b>	<b>Unknown</b>	<b>Within 90 days</b>

PROPOSED CASING AND CEMENT PROGRAM

SIZE OF HOLE	SIZE OF CASING	WEIGHT PER FOOT	SETTING DEPTH	SACKS OF CEMENT	EST. TOP
12-1/4"	8-5/8"	32#	300'	320 sx	Circ.
7-7/8"	4-1/2"	10.5#	7100'	1780 sx	Circ.

The above well is being drilled to further develop the Basin Dakota Field. The well will be drilled with a low solids non-dispersed mud system. Completion design will be based on open hole logs. Copy of all logs will be filed upon completion. Amoco's standard blowout prevention will be employed; see attached drawing for blowout preventer design.

Upon completion, the well location will be cleaned up and the reserve pit filled and leveled.

Gas produced from this well is dedicated to El Paso Natural Gas Company.

APPROVAL VALID  
FOR 90 DAYS UNLESS  
DRILLING COMMENCED,

EXPIRES 10-10-79



IN ABOVE SPACE DESCRIBE PROPOSED PROGRAM: IF PROPOSAL IS TO DEEPEN OR PLUG BACK, GIVE DATA ON PRESENT PRODUCTIVE ZONE AND PROPOSED NEW PRODUCTIVE ZONE. GIVE BLOWOUT PREVENTER PROGRAM, IF ANY.

I hereby certify that the information above is true and complete to the best of my knowledge and belief.

Original Signed By

Signed B. E. FACKRELL Title District Engineer Date July 11, 1979

(This space for State Use)

APPROVED BY Frank S. Chang TITLE DEPUTY OIL & GAS INSPECTOR, DIST. #3 DATE JUL 12 1979

CONDITIONS OF APPROVAL, IF ANY:

write now

## OIL CONSERVATION DIVISION

STATE OF NEW MEXICO  
ENERGY AND MINERALS DEPARTMENT  
P. O. BOX 2088  
SANTA FE, NEW MEXICO 87501Form C-102  
Revised 10-1-78

All distances must be from the outer boundaries of the Section.

Operator <b>AMOCO PRODUCTION COMPANY</b>			Lease <b>STATE GAS COM "BR"</b>			Well No. <b>1</b>
Unit Letter <b>E</b>	Section <b>2</b>	Township <b>29N</b>	Range <b>10W</b>	County <b>San Juan</b>		
Actual Footage Location of Well: <b>1450</b> feet from the <b>North</b> line and <b>1170</b> feet from the <b>West</b> line						
Ground Level Elev. <b>5924</b>	Producing Formation <b>Dakota</b>		Pool <b>Basin Dakota</b>		Dedicated Acreage <b>320.328.24</b> acres	

1. Outline the acreage dedicated to the subject well by colored pencil or hachure marks on the plat below.
2. If more than one lease is dedicated to the well, outline each and identify the ownership thereof (both as to working interest and royalty).
3. If more than one lease of different ownership is dedicated to the well, have the interests of all owners been consolidated by communitization, unitization, force-pooling, etc?

☒ Yes ☐ No If answer is "yes," type of consolidation Communitization has been filed

If answer is "no," list the owners and tract descriptions which have actually been consolidated. (Use reverse side of this form if necessary.)

No allowable will be assigned to the well until all interests have been consolidated (by communitization, unitization, forced-pooling, or otherwise) or until a non-standard unit, eliminating such interests, has been approved by the Division.

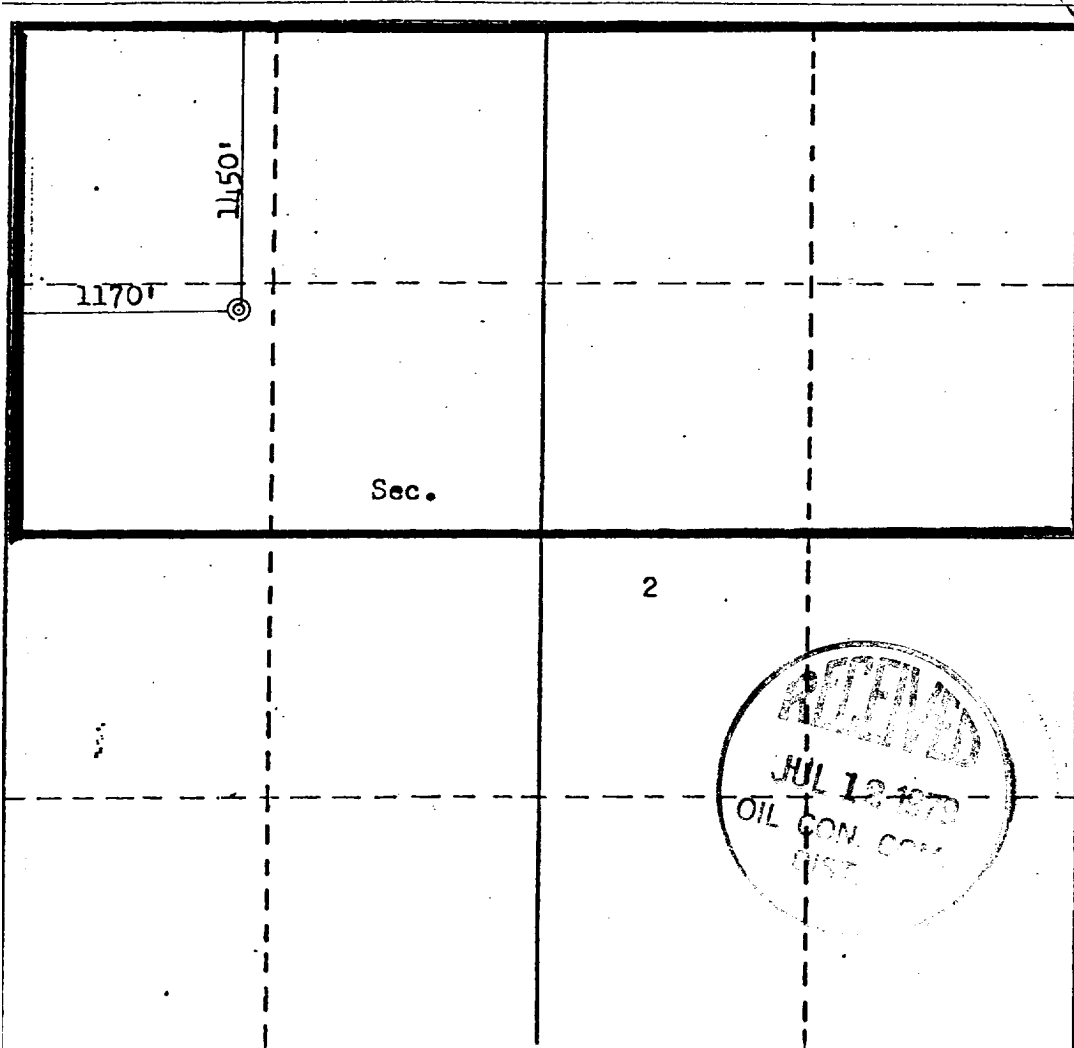

## CERTIFICATION

I hereby certify that the information contained herein is true and complete to the best of my knowledge and belief.

*B. E. Fackrell*

Name  
**B. E. FACKRELL**  
Position  
**DISTRICT ENGINEER**  
Company  
**AMOCO PRODUCTION COMPANY**  
Date  
**JULY 7, 1979**

I hereby certify that the well location shown on this plat was plotted from field notes of actual surveys made by me or under my supervision, and that the same is true and correct to the best of my knowledge and belief.

Date Surveyed  
**June 27, 1979**  
Registered Professional Engineer  
and/or Licensed Surveyor  
*Fred B. Kerr, Jr.*  
**Fred B. Kerr, Jr.**  
Certificate No. **3950**

THIS PORTION, OR ANY PART THEREOF, MAY BE PLACED OUTSIDE OF SUB-STRUCTURE IF DESIRED. USE LONG RADIUS BENDS. PIPE USED FOR EXTENSION SHOULD BE SHOP MADE WITH NO SCREWED CONNECTIONS AND PRESSURE TESTED INITIALLY TO SAME TEST PRESSURE AS THE CHOKE MANIFOLD.

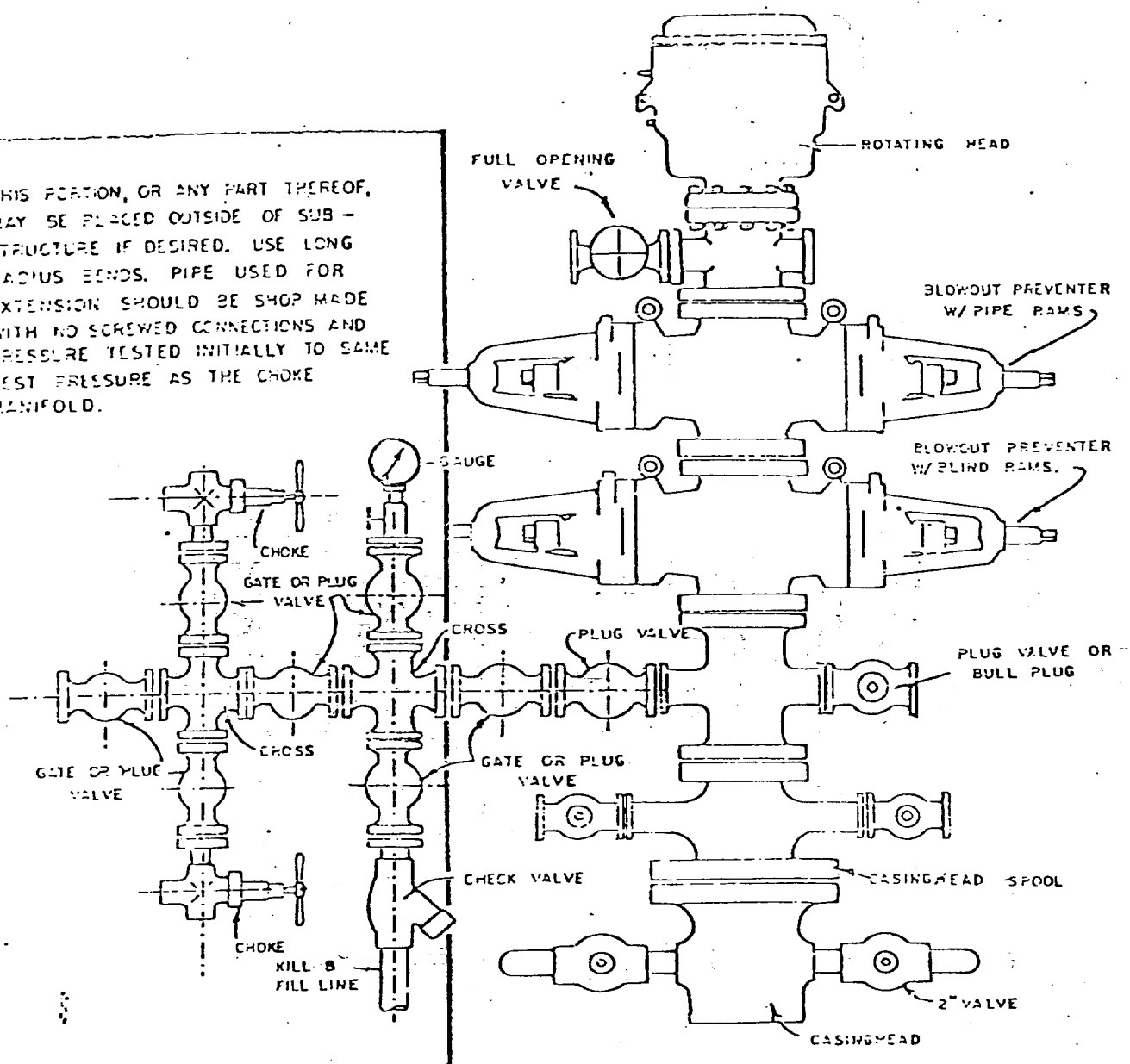

BLOWOUT PREVENTER HOOKUP