

**FIELD PIT SITE ASSESSMENT FORM**

**GENERAL**

Meter: 94200 Location: STATE GAS com BR # 54-94 RT A1  
 Operator #: 0203 Operator Name: Amoco P/L District: Bloomfield  
 Coordinates: Letter: E Section 2 Township: 29 Range: 10  
 Or Latitude \_\_\_\_\_ Longitude \_\_\_\_\_  
 Pit Type: Dehydrator  Location Drip: \_\_\_\_\_ Line Drip: \_\_\_\_\_ Other: \_\_\_\_\_  
 Site Assessment Date: 5-4-94 Area: 10 Run: 73

**SITE ASSESSMENT**

**NMOCD Zone:** (From NMOCD Maps) Inside  (1) Outside  (2)

**Land Type:** BLM  (1) State  (2) Fee  (3) Indian Trust

**Depth to Groundwater**  
 Less Than 50 Feet (20 points)  (1)  
 50 Ft to 99 Ft (10 points)  (2)  
 Greater Than 100 Ft (0 points)  (3)

**Wellhead Protection Area :**  
 Is it less than 1000 ft from wells, springs, or other sources of fresh water extraction? , or ; Is it less than 200 ft from a private domestic water source?  (1) YES (20 points)  (2) NO (0 points)

**Horizontal Distance to Surface Water Body**  
 Less Than 200 Ft (20 points)  (1)  
 200 Ft to 1000 Ft (10 points)  (2)  
 Greater Than 1000 Ft (0 points)  (3)

Name of Surface Water Body \_\_\_\_\_  
 (Surface Water Body : Perennial Rivers, Major Wash, Streams, Creeks, Irrigation Canals, Ditches, Lakes, Ponds)  
 Distance to Nearest Ephemeral Stream  (1) < 100' (Navajo Pits Only)  
 (2) > 100'

**TOTAL HAZARD RANKING SCORE:** 10 POINTS

*Benny L. Faust*  
 DEPUTY OIL & GAS INSPECTOR

SEP 11 0 1996

*Approved*

**RECEIVED**  
 APR - 4 1996

**OIL CON. DIV.**  
 DIST. 3

**REMARKS**

Remarks : THREE PITS ON LOCATION. WILL CLOSE ONLY ONE. PIT IS DRY. REDLINE AND TOPO CONFIRMED LOCATION TO BE INSIDE THE U.Z.

ORIGINAL PIT LOCATION

Original Pit : a) Degrees from North 96° Footage from Wellhead 137'  
b) Length : 17' Width : 16' Depth : 3'

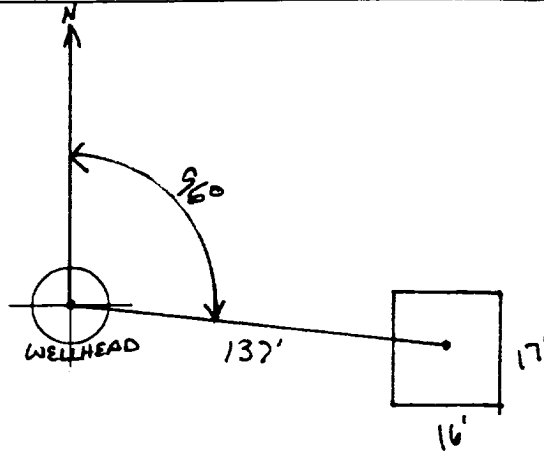

ORIGINAL PIT LOCATION

REMARKS :

TOOK PICTURES AT 9:10 A.M.  
END DUMP

REMARKS

Completed By:

Paul Thompson  
Signature

5.4.94  
Date

## FIELD PIT REMEDIATION/CLOSURE FORM

<b>GENERAL</b>	Meter: <u>94200</u> Location: <u>Stake Gas Com BR #1</u> Coordinates: Letter: <u>E</u> Section <u>2</u> Township: <u>29</u> Range: <u>10</u> Or Latitude _____ Longitude _____ Date Started : <u>5-13-94</u> Area: <u>10</u> Run: <u>73</u>
<b>OBSERVATIONS</b>	Sample Number(s): <u>KD58</u> Sample Depth: <u>8</u> Feet Final PID Reading <u>294 ppm</u> PID Reading Depth <u>8</u> Feet Groundwater Encountered <input type="checkbox"/> (1) <input checked="" type="checkbox"/> (2) Approximate Depth _____ Feet <div style="margin-left: 150px;">                     Yes      No                 </div>
<b>CLOSURE</b>	Remediation Method : Excavation <input checked="" type="checkbox"/> (1) Approx. Cubic Yards <u>40</u> <div style="margin-left: 150px;"><u>5-13-94</u></div> <div style="margin-left: 150px;"><u>25 35</u></div> Onsite Bioremediation <input type="checkbox"/> (2) Backfill Pit Without Excavation <input type="checkbox"/> (3) Soil Disposition: Envirotech <input type="checkbox"/> (1) <input checked="" type="checkbox"/> (3) Tierra Other Facility <input type="checkbox"/> (2) Name: _____ Pit Closure Date: <u>5-13-94</u> Pit Closed By: <u>BEI</u>
<b>REMARKS</b>	Remarks : <u>Excavated pit to 8', hit hard layer of shale,</u> <u>Took PID Reading, closed pit.</u>
	Signature of Specialist: <u>Kenny Leaver</u>



**FIELD SERVICES LABORATORY  
ANALYTICAL REPORT  
PIT CLOSURE PROJECT - Soil**

**SAMPLE IDENTIFICATION**

	Field ID	Lab ID
SAMPLE NUMBER:	KDS8	945170
MTR CODE   SITE NAME:	94200	N/A
SAMPLE DATE   TIME (Hrs):	5-13-94	1225
SAMPLED BY:	N/A	
DATE OF TPH EXT.   ANAL.:	5-17-94	5/17/94
DATE OF BTEX EXT.   ANAL.:	5/19/94	5/20/94
TYPE   DESCRIPTION:	VC	Grey Sand & sand Stone

REMARKS: \_\_\_\_\_

**RESULTS**

PARAMETER	RESULT	UNITS	QUALIFIERS			
			DF	Q	M(g)	V(ml)
BENZENE	20.12	MG/KG	5			
TOLUENE	0.56	MG/KG	5			
ETHYL BENZENE	0.42	MG/KG	5			
TOTAL XYLENES	7.9	MG/KG	5			
TOTAL BTEX	9.0	MG/KG				
TPH (418.1)	<del>100</del> <10	MG/KG 5/16/94			2.1	28
HEADSPACE PID	29.4	PPM				
PERCENT SOLIDS	89.4	%				

-- TPH is by EPA Method 418.1 and BTEX is by EPA Method 8020 --

The Surrogate Recovery was at 138 % for this sample All QA/QC was acceptable.

Narrative: ATI results attached. Surrogate recovery was outside ATI QC limits due to matrix interference.

DF = Dilution Factor Used

Approved By: John Lardi

Date: 7/14/94



Analytical **Technologies**, Inc.

2709-D Pan American Freeway, NE Albuquerque, NM 87107  
Phone (505) 344-3777 FAX (505) 344-4413

ATI I.D. 405378

June 2, 1994

El Paso Natural Gas Company  
P.O. Box 4990  
Farmington, NM 87499

Project Name/Number: PIT CLOSURE 24324

Attention: John Lambdin

On 05/18/94, Analytical Technologies, Inc., (ADHS License No. AZ0015), received a request to analyze **non-aqueous** samples. The samples were analyzed with EPA methodology or equivalent methods. The results of these analyses and the quality control data, which follow each set of analyses, are enclosed.

Client samples 945004 and 945007 were submitted to Analytical Technologies' Albuquerque laboratory past the recommended EPA holding time.

NOTED  
J  
6/6/94

If you have any questions or comments, please do not hesitate to contact us at (505) 344-3777.

Letitia Krakowski, Ph.D.  
Project Manager

H. Mitchell Rubenstein, Ph.D.  
Laboratory Manager

MR:jd

Enclosure

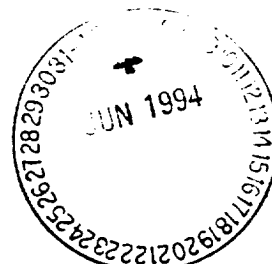

## GAS CHROMATOGRAPHY RESULTS

TEST : BTEX (EPA 8020)  
 CLIENT : EL PASO NATURAL GAS CO.      ATI I.D.: 405378  
 PROJECT # : 24324  
 PROJECT NAME : PIT CLOSURE

SAMPLE ID. #	CLIENT I.D.	MATRIX	DATE SAMPLED	DATE EXTRACTED	DATE ANALYZED	DIL. FACTOR
10	945169	NON-AQ	05/13/94	05/19/94	05/20/94	10
11	945170	NON-AQ	05/13/94	05/19/94	05/20/94	5
12	945171	NON-AQ	05/13/94	05/19/94	05/21/94	5

PARAMETER	UNITS	10	11	12
BENZENE	MG/KG	<0.25	<0.12	<0.12
TOLUENE	MG/KG	0.43	0.56	<0.12
ETHYLBENZENE	MG/KG	1.5	0.42	0.81
TOTAL XYLENES	MG/KG	17	7.9	9.1

## SURROGATE:

BROMOFLUOROBENZENE (%)      43\*      138\*      184\*

\*OUTSIDE ATI QUALITY CONTROL LIMITS DUE TO MATRIX INTERFERENCE