

Denny S. Faust
DEPUTY OIL & GAS INSPECTOR

State of New Mexico
 Energy, Minerals and Natural Resources Department

SUBMIT 1 COPY TO
 APPROPRIATE
 DISTRICT OFFICE
 AND 1 COPY TO
 SANTA FE OFFICE

Tract I)
) Box
 Tract II)
) Drawer DD, Artesia, NM 88220
 Tract III)
) Rio Brazos Rd. Aztec, NM 87410

OIL CONSERVATION DIVISION

2040 South Pacheco Street
 Santa Fe, New Mexico 87505

RECEIVED
 JUL 22 1998

Approved

PIT REMEDIATION AND CLOSURE REPORT

OIL CON. DIV.
DIST. 3

Operator: PNM Gas Services (Burlington) **Telephone:** 324-3764

Address: 603 W. Elm Street Farmington, NM 87401

Facility or Well Name: Mangum #5E

Location: Unit G Sec 29 T 29N R 11W County San Juan

Pit Type: Separator Dehydrator Other None

Land Type: BLM State Fee Other No

Pit Location: Pit dimensions: length 20 width 20 depth 3

(Attach diagram) Reference: wellhead other

Footage from reference: 135'

Direction from reference: 45 Degrees East North
 West South

Depth to Ground Water:

Less than 50 feet	(20 points)	
50 feet to 99 feet	(10 points)	
Greater than 100 feet	(0 points)	<u>20</u>

(Vertical distance from contaminants to seasonal high water elevation of ground water)

Wellhead Protection Area:

Yes	(20 points)	
No	(0 points)	<u>0</u>

(Less than 200 feet from a private domestic water source, or, less than 1,000 feet from all other water sources)

Distance to Surface Water:

Less than 200 feet	(20 points)	
200 feet to 1,000 feet	(10 points)	
Greater than 1,000 feet	(0 points)	<u>10</u>

(Horizontal distance to perennial lakes, ponds, rivers, streams, creeks, irrigation canals and ditches)

RANKING SCORE (TOTAL POINTS): 30

Date Remediation Started: _____ Date Completed: _____

Remediation Method: Excavation _____ Approx. Cubic Yard _____

(Check all appropriate sections) Landfarmed _____ Amount Landfarmed (cubic yds) _____

Other _____

Remediation Location: Onsite _____ Offsite _____
(i.e., landfarmed onsite, name and location of offsite facility)

Backfill Material Location: _____

General Description of Remedial Action:

No remedial action necessary; lab analysis below BLM/OCD standards.

Ground Water Encountered: No Yes Depth _____

Final Pit Closure Sampling:

Sample Location Middle of pit.

(if multiple samples, attach sample result and diagram of sample locations and depths.)

Sample depth 3'

Sample date 11/14/95 Sample time 1:30:00 PM

Sample Results

Benzene (ppm) < 0.0002

Total BTEX (ppm) 0.0053

Field headspace (ppm) 1.0

TPH (ppm) _____ Method 8020

Vertical Extent (ft) _____ Risk Analysis form attached Yes No

Ground Water Sample: Yes No (If yes, see attached Groundwater Site Summary Report)

I HEREBY CERTIFY THAT THE INFORMATION ABOVE IS TRUE AND COMPLETE TO THE BEST OF MY KNOWLEDGE AND MY BELIEF

DATE April 29, 1998

PRINTED NAME AND TITLE **Maureen Gannon Project Manager**

SIGNATURE Maureen Gannon

by Kathy Jackson

Site Map:

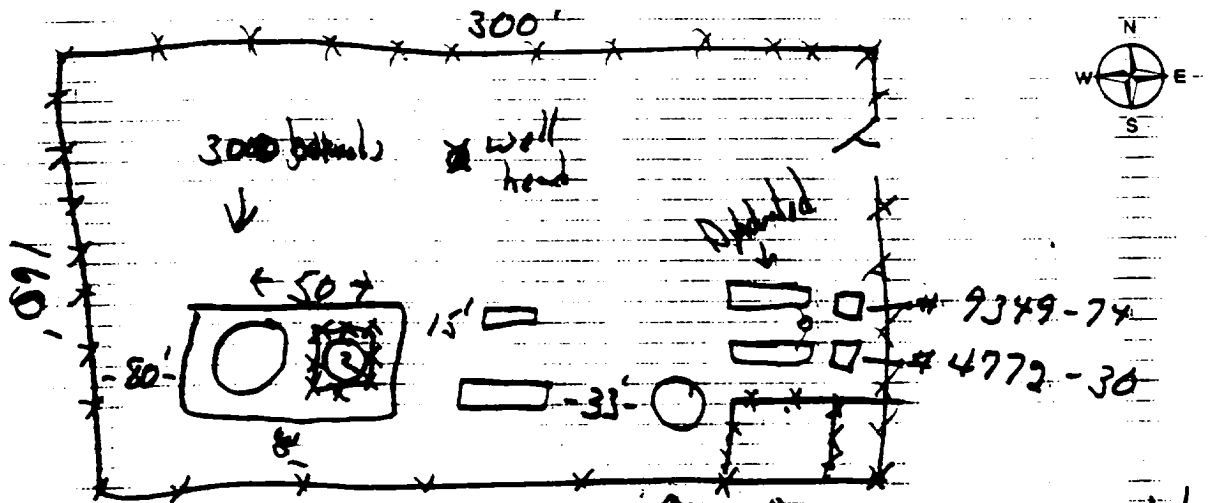

Southland Royalty Co.

Manpam SE

860' FNL + 825' FEL

NE/NE Sec. 29, T-29-N, R-11-W

1000 gal Tank
30x30 Pit

3 test hole
Composite
Sample Grabber

Assessor's Signature:

Handwritten signature

Date:

11/14/95



OFF: (505) 325-8786

LAB: (505) 325-5667

TOTAL PETROLEUM HYDROCARBONS

Attn: *Denver Bearden*
Company: *PNM Gas Services*
Address: *603 W. Elm*
City, State: *Farmington, NM 87401*

Date: 15-Nov-95
COC No.: 3659
Sample No. 9222
Job No. 2-1000

Project Name: *PNM Gas Services - Mangum 5E*
Project Location: *3pt. Composite 3' BS - 9511141330*
Sampled by: RD/MS Date: 14-Nov-95 Time: 13:30
Analyzed by: DC Date: 15-Nov-95
Type of Sample: *Soil*

Laboratory Analysis

Laboratory Identification	Sample Identification	Total Petroleum Hydrocarbons
9222-3659	<i>PNM Gas Services - Mangum 5E</i> <i>3pt. Composite 3' BS - 9511141330</i>	54 mg/kg

Quality Assurance Report

Laboratory Identification	Analyzed Value	Acceptable Range	Units of Measure
<i>Laboratory Fortified Blank Soil - QCBS1</i>	39	22 - 46	mg/kg
<i>Laboratory Fortified Spike Soil - QCSS1</i>	880	828 - 1024	mg/kg

Method - EPA Method 418.1 Total Petroleum Hydrocarbons

Approved by: *[Signature]*
Date: *11/15/95*

P. O. BOX 2606 • FARMINGTON, NM 87499

OFF: (505) 325-8786



LAB: (505) 325-5667

AROMATIC VOLATILE ORGANICS

Attn: *Denver Bearden*
 Company: *PNMGS*
 Address: *603 W. Elm*
 City, State: *Farmington, NM 87401*

Date: *15-Nov-95*
 COC No.: *3659*
 Sample No. *9222*
 Job No. *2-1000*

Project Name: *PNM Gas Services - Mangum 5E*
 Project Location: *3pt. Composite 3' BS - 9511141330*
 Sampled by: *RD/MS* Date: *14-Nov-95* Time: *13:30*
 Analyzed by: *DC* Date: *14-Nov-95*
 Type of Sample: *Soil*

Aromatic Volatile Organics

<i>Component</i>	<i>Result</i>	<i>Units of Measure</i>	<i>Detection Limit</i>	<i>Units of Measure</i>
<i>Benzene</i>	<i><0.2</i>	<i>ug/kg</i>	<i>0.2</i>	<i>ug/kg</i>
<i>Toluene</i>	<i>3.4</i>	<i>ug/kg</i>	<i>0.2</i>	<i>ug/kg</i>
<i>Ethylbenzene</i>	<i><0.2</i>	<i>ug/kg</i>	<i>0.2</i>	<i>ug/kg</i>
<i>m,p-Xylene</i>	<i>1.9</i>	<i>ug/kg</i>	<i>0.2</i>	<i>ug/kg</i>
<i>o-Xylene</i>	<i><0.2</i>	<i>ug/kg</i>	<i>0.2</i>	<i>ug/kg</i>
	<i>TOTAL</i>	<i>5.3</i>		<i>ug/kg</i>

Method - SW-846 EPA Method 8020 Aromatic Volatile Organics by Gas Chromatography

Approved by: *[Signature]*
 Date: *11/15/95*

P. O. BOX 2606 • FARMINGTON, NM 87499