

UNITED STATES
DEPARTMENT OF THE INTERIOR
GEOLOGICAL SURVEY

30-094-23673

APPLICATION FOR PERMIT TO DRILL, DEEPEN, OR PLUG BACK

1a. TYPE OF WORK
DRILL ☒ DEEPEN ☐ PLUG BACK ☐

b. TYPE OF WELL
OIL WELL ☐ GAS WELL ☒ OTHER ☐ SINGLE ZONE ☒ MULTIPLE ZONE ☐

2. NAME OF OPERATOR
Southland Royalty Company

3. ADDRESS OF OPERATOR
P. O. Drawer 570, Farmington, New Mexico

4. LOCATION OF WELL (Report location clearly and in accordance with any State requirements.)
At surface
1500' FNL & 1030' FWL
At proposed prod. zone

14. DISTANCE IN MILES AND DIRECTION FROM NEAREST TOWN OR POST OFFICE*
4 miles southeast of Farmington, New Mexico

15. DISTANCE FROM PROPOSED* LOCATION TO NEAREST PROPERTY OR LEASE LINE, FT.
(Also to nearest drlg. unit line, if any)

18. DISTANCE FROM PROPOSED LOCATION* TO NEAREST WELL, DRILLING, COMPLETED, OR APPLIED FOR, ON THIS LEASE, FT.

21. ELEVATIONS (Show whether DF, RT, GR, etc.)
5819' GR

23. PROPOSED CASING AND CEMENTING PROGRAM

SIZE OF HOLE	SIZE OF CASING	WEIGHT PER FOOT	SETTING DEPTH	QUANTITY OF CEMENT
12-1/2"	9-5/8"	32.30#	200'	110 sxs <i>circulate to surface</i>
7-7/8"	4-1/2"	10.50#	6600'	278 sxs - 1st Stage
	2-3/8"	4.7#	6600'	262 sxs - 2nd Stage
				294 sxs - 3rd Stage

Surface formation is Nacimiento.
Top of Ojo Alamo sand is at 981'.
Top of Pictured Cliffs sand is at 2001'.
Fresh water mud will be used to drill from surface to total depth.
It is anticipated that an IES, GR-Density and Spectra log will be run at total depth.
No abnormal pressures or poisonous gases are anticipated in this well.
It is expected that this well will be drilled before October 15, 1979. This depends on time required for approvals, rig availability and the weather.
Gas is dedicated.

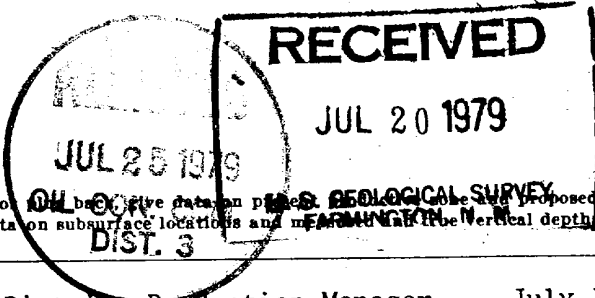

IN ABOVE SPACE DESCRIBE PROPOSED PROGRAM: If proposal is to deepen or plug back, give data on place, depth, and proposed new productive zone. If proposal is to drill or deepen directionally, give pertinent data on subsurface locations and measurements in vertical depth. Give blowout preventer program, if any.

24. SIGNED [Signature] TITLE District Production Manager DATE July 18, 1979

(This space for Federal or State office use)

PERMIT NO. _____ APPROVAL DATE _____

APPROVED BY _____ TITLE _____ DATE _____

CONDITIONS OF APPROVAL, IF ANY:

oh Frank

*See Instructions On Reverse Side

NMOEC

OIL CONSERVATION DIVISION

STATE OF NEW MEXICO
ENERGY AND MINERALS DEPARTMENTP. O. BOX 2088
SANTA FE, NEW MEXICO 87501Form C-107
Revised 10-1-78

All distances must be from the outer boundaries of the Section.

Operator SOUTHLAND ROYALTY COMPANY			Lease REID PRI		Well No. 1E
Unit Letter E	Section 13	Township 29N	Range 12W	County San Juan	
Actual Footage Location of Well: 1500 feet from the North line and 1030 feet from the West line					
Ground Level Elev. 5819	Producing Formation Dakota		Pool Basin	Dedicated Acreage: 320 Acres	

1. Outline the acreage dedicated to the subject well by colored pencil or hachure marks on the plat below.
2. If more than one lease is dedicated to the well, outline each and identify the ownership thereof (both as to working interest and royalty).
3. If more than one lease of different ownership is dedicated to the well, have the interests of all owners been consolidated by communitization, unitization, force-pooling, etc?

☒ Yes ☐ No If answer is "yes," type of consolidation Communitization

If answer is "no," list the owners and tract descriptions which have actually been consolidated. (Use reverse side of this form if necessary.)

No allowable will be assigned to the well until all interests have been consolidated (by communitization, unitization, forced-pooling, or otherwise) or until a non-standard unit, eliminating such interests, has been approved by the Commission.

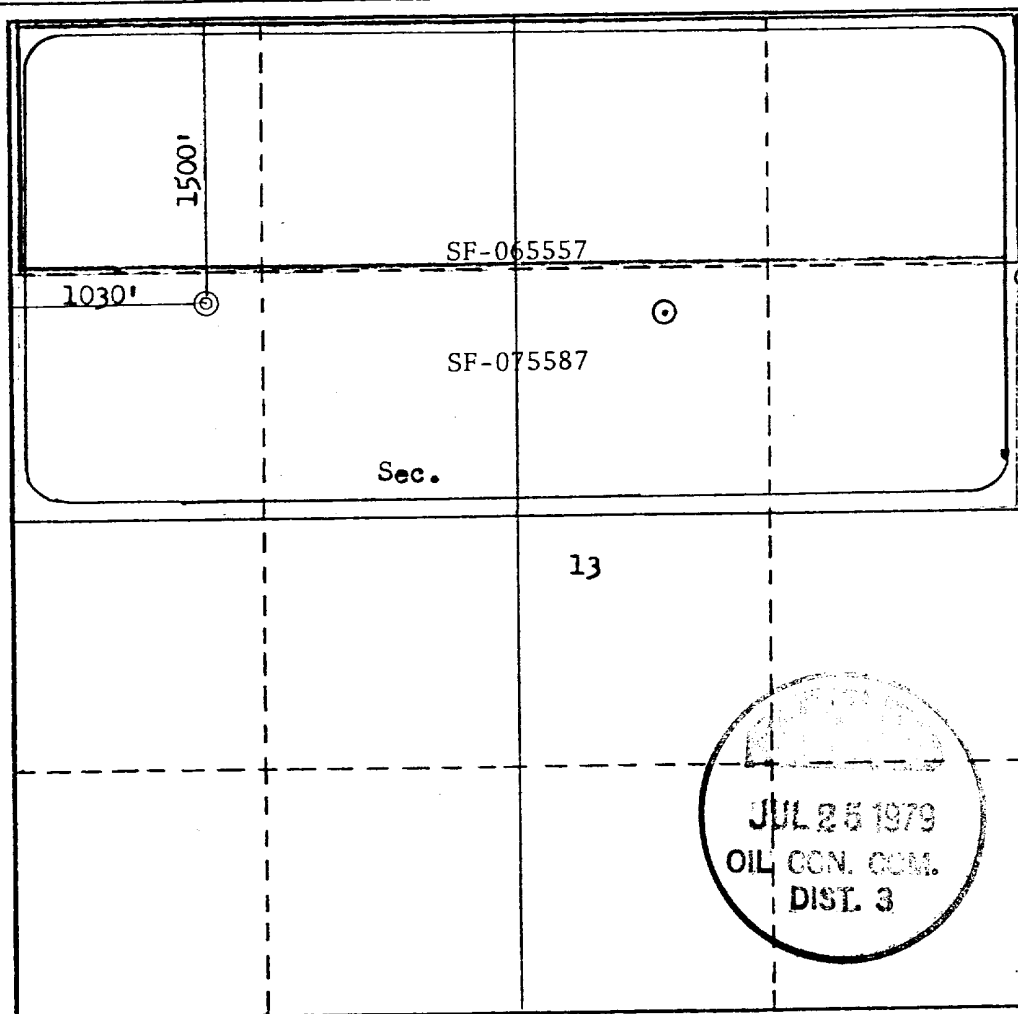

CERTIFICATION

I hereby certify that the information contained herein is true and complete to the best of my knowledge and belief.

Name [Signature]
Position
District Production Manager
Company
Southland Royalty Company
Date
July 18, 1979

I hereby certify that the well location shown on this plat was plotted from field notes of actual surveys made by me or under my supervision, and that the same is true and correct to the best of my knowledge and belief.

Date Surveyed
July 18, 1979
Registered Professional Engineer
and/or Land Surveyor
No. 3350
Fred H. Kerr, Jr.
Certificate No. B. KERR, Jr.
3950

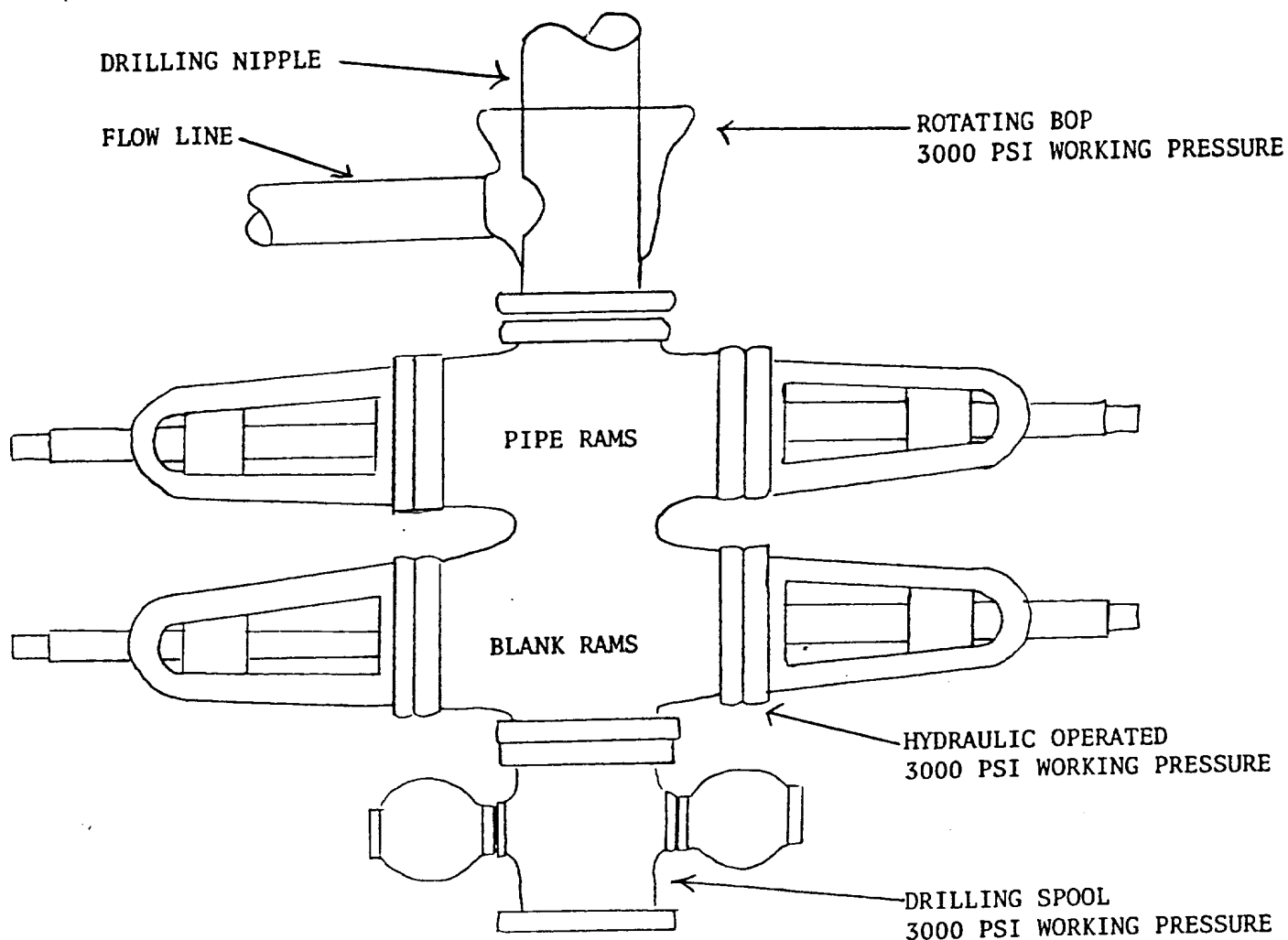

PREVENTERS AND SPOOLS ARE TO HAVE
THROUGH BORE OF 6" - 3000 PSI OR LARGER



Southland Royalty Company

July 18, 1979

United States Geological Survey
P. O. Box 959
Farmington, New Mexico

Attention:

Dear Sir:

Enclosed please find a map showing existing roads and planned access roads to Southland Royalty Company's Reid PRI #1E well. The locations of tank batteries and flow lines will be on location with well. A burn pit will be provided for disposal of trash. Cuttings, drilling fluid and produced fluids will be put into the reserve pit and properly disposed of depending on amount and type of fluids.

Contractor will furnish restroom facilities on location.

There will be no air strips or camps.

Also, enclosed is a location layout showing approximate location of rig, pits and pipe racks and cut required to build this location.

Water supply will be Citizens Ditch.

The location will be restored according to Bureau of Land Management standards. This work will begin when all related construction is finished.

Mr. Ross Lankford will be Southland Royalty Company's field representative supervising these operations.

Yours truly,

L. O. Van Ryan
District Production Manager

LOVR/dg



Southland Royalty Company

United States Geological Survey
P. O. Box 959
Farmington, New Mexico 87401

Attention: District Engineer

Dear Sir:

I hereby certify that I, or persons under my direct supervision, have inspected the proposed drillsite and access route; that I am familiar with the conditions which presently exist; that the statements made in this plan are, to the best of my knowledge, true and correct; and, that the work associated with the operations proposed herein be performed by Southland Royalty Company and its contractors and subcontractors in conformity with this plan and the terms and conditions under which it is approved.

Date: July 18, 1979

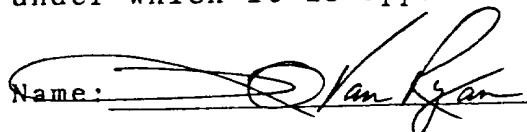
Name: 

Title: District Production Manager



Southland Royalty Company

July 18, 1979

United States Geological Survey
P. O. Box 959
Farmington, New Mexico

Attention: District Engineer

Re: Blowout Preventer Plan :

Dear Sir:

All drilling and completion rigs will be equipped with 6" or larger double hydraulic blowout preventers and a hydraulic closing unit with steel lines.

The preventer is 3000# working pressure and 6000# test.

All crews will be thoroughly trained in the operation of this preventer. The preventer will be tested frequently enough to insure proper operation.

Yours truly,

L. O. Van Ryan
District Production Manager

LOVR/dg

LOCATION TROILLE 107
 SOUTHLAND ROYALTY COMPANY #1-E Reid PRI
 1500' FNL 1030' FWL Sec 13-129N-R12W San Juan County, New Mexico

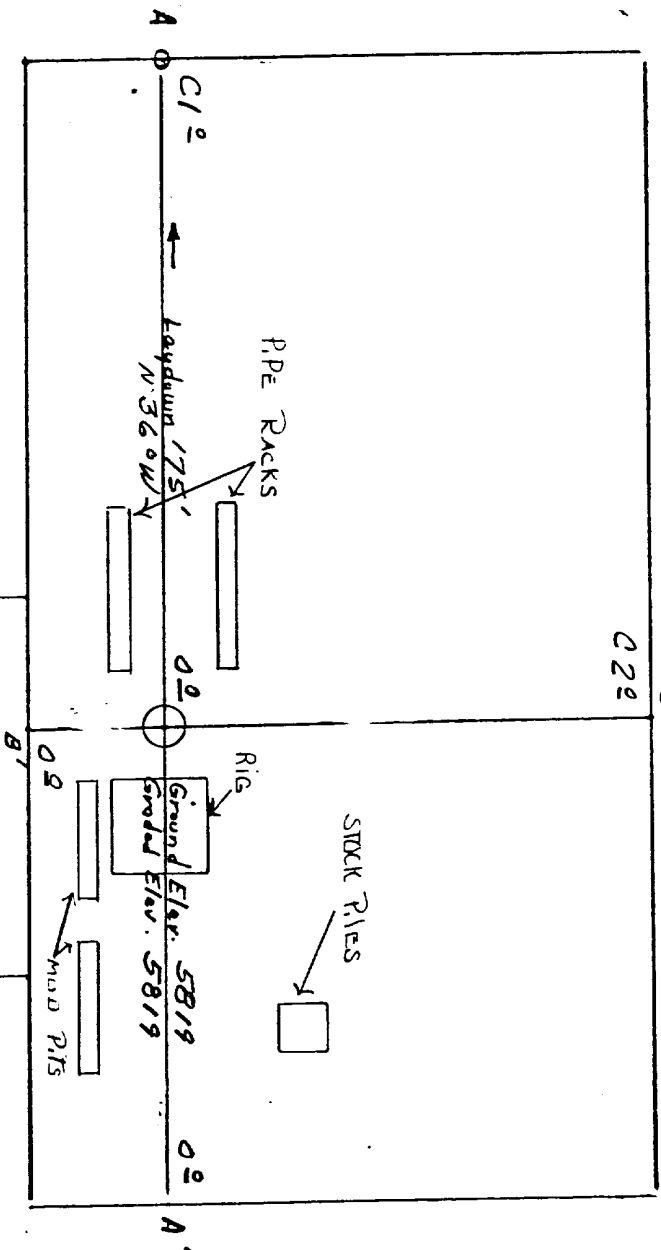

Vert. 1"=40' A-A' Horiz. 1"=100'

5830				
5820				
5810				

B-B' E

5830				
5820				
5810				

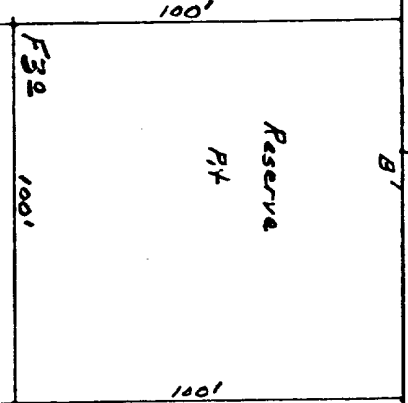

Vert. 1"=40' C-C' Horiz. 1"=100'

D-D' E

KERR LAND SURVEYING
 Date: July 16, 1979

DRILLING SCHEDULE: REID PRI #1E

Location: 1500' FNL & 1030' FWL, Section 13, T29N, R12W, San Juan County, New Mexico

Field: Basin Dakota

Elevation: 5819' GL

Geology:

Formation Tops:	Ojo Alamo	981	Gallup	5531
	Fruitland	1661	Graneros	6331
	Pictured Cliffs	2001	Dakota	6451
	Cliff House	3491	TD	6601
	Point Lookout	4266		

Logging Program: IES from T.D. to surface, GR-Density from T.D. to top of Pictured Cliffs.
Run Spectra from T.D. to Gallup

Coring Program: None

Natural Gauges: None

Drilling:

Contractor:

Tool Pusher:

SRC Representative:

SRC Answering Service: 323-7391

Mud Program: Fresh water mud from surface to T.D.

Materials:

Casing Program:	Hole Size	Depth	Casing Size	Wt. & Grade
	12-1/4"	200'	9-5/8"	32.3# H-40
	7-7/8"	6601'	4-1/2"	10.5# K-55

Float Equipment:

9-5/8" Surface Casing: Pathfinder Type A guide shoe

4-1/2" Production String: Pathfinder type "AP" guide shoe. Pathfinder self-fill insert float valve. Run 5 Pathfinder rigid centralizers every other joint above shoe. Run 2 Dowell stage tools at 4500' and 2200'. Run cement basket below and 5 centralizers above each tool.

Tubing: 6600' of 2-3/8", 4.7#, J-55, 8rd, EUE

Wellhead Equipment: 9-5/8" X 10", 2000# casing head
10", 2000# X 6" 2000# tubing head

Cementing:

9-5/8" surface casing (9.625") - .110 sxs or 130 cu. ft. of Class B with 1/4# gel flake/sx and 3% calcium chloride. WOC for 12 hrs, Test to 600# prior to drilling out. (volume is 100 percent excess)

4-1/2" Production String (4.500") - Stage 1 - 278 sxs or 414 cu. ft. of 50/50 Poz with 6% gel, 1/4# gel flake/sx and 0.6% Halad 9 or equivalent. (70% Excess)

Stage 2 - 262 sxs or 391 cu. ft. of the same cement as above (70% Excess)

Stage 3 - 224 sxs or 334 cu. ft. of 50/50 poz with 6% gel (50% excess) followed by 70 sxs Class B with 2% calcium chloride. If lost circulation occurred, add 1/4# celloflakes per sx.

WOC and circulate between stages as required by well conditions.

