

UNITED STATES
DEPARTMENT OF THE INTERIOR
GEOLOGICAL SURVEY

30-045-23754

5. LEASE DESIGNATION AND SERIAL NO.
SF 077092-B

6. IF INDIAN, ALLOTTEE OR TRIBE NAME

7. UNIT AGREEMENT NAME

8. FARM OR LEASE NAME

Lackey C

9. WELL NO.

1A

10. FIELD AND POOL, OR WILDCAT

Aztec PC Mesa Verde
Blanco

11. SEC., T., R., M., OR BLK.

AND SURVEY OR AREA
Sec. 11, T-29-N, R-10-W
NMPM

12. COUNTY OR PARISH

San Juan

13. STATE

NM

1a. TYPE OF WORK

DRILL ☒DEEPEN ☐PLUG BACK ☐

b. TYPE OF WELL

OIL
WELL ☐GAS
WELL ☒

OTHER

SINGLE
ZONE ☐MULTIPLE
ZONE ☒

2. NAME OF OPERATOR

El Paso Natural Gas Company

3. ADDRESS OF OPERATOR

PO Box 289, Farmington, NM 87401

4. LOCATION OF WELL (Report location clearly and in accordance with any State requirements.)*

At surface

1160' N, 1170' W
1120' 1120'

At proposed prod. zone

same

14. DISTANCE IN MILES AND DIRECTION FROM NEAREST TOWN OR POST OFFICE*

2.5 miles northwest of Blanco, NM

15. DISTANCE FROM PROPOSED*

LOCATION TO NEAREST
PROPERTY OR LEASE LINE, FT.
(Also to nearest drlg. unit line, if any)

1160'

16. NO. OF ACRES IN LEASE

316.8

17. NO. OF ACRES ASSIGNED

TO THIS WELL

316.80 & 159.12

18. DISTANCE FROM PROPOSED LOCATION*
TO NEAREST WELL, DRILLING, COMPLETED,
OR APPLIED FOR, ON THIS LEASE, FT.

.5mile

19. PROPOSED DEPTH

5015'

20. ROTARY OR CABLE TOOLS

Rotary

21. ELEVATIONS (Show whether DF, RT, GR, etc.)

5784' GL

22. APPROX. DATE WORK WILL START*

23.

PROPOSED CASING AND CEMENTING PROGRAM

| SIZE OF HOLE | SIZE OF CASING | WEIGHT PER FOOT | SETTING DEPTH | QUANTITY OF CEMENT |
|--------------|----------------|-----------------|---------------|------------------------------|
| 13 3/4" | 9 5/8" | 36.0# | 200' | 224 cu.ft. to circulate |
| 8 3/4" | 7" | 20.0# | 2654' | 345 cu.ft. to cover Ojo Alam |
| 6 1/4" | 4 1/2" liner | 10.5# | 2504-5015' | 438 cu.ft. to circ. liner |

Selectively perforate and sandwater fracture the Pictured Cliffs and Mesa Verde formation.

A 3000 psi WP and 6000 psi test double gate preventer equipped with blind and pipe rams will be used for blow out prevention on this well.

This gas is dedicated.

The N/2 of Section 11 is dedicated to this well.

IN ABOVE SPACE DESCRIBE PROPOSED PROGRAM: If proposal is to deepen or plug back, give data on present productive zone and proposed new productive zone. If proposal is to drill or deepen directionally, give pertinent data on subsurface locations and measured and true vertical depths. Give blowout preventer program, if any.

24.

SIGNED

TITLE

Drilling Clerk

DATE 8-13-79

(This space for Federal or State office use)

PERMIT NO.

APPROVAL DATE

APPROVED BY

TITLE

DATE

CONDITIONS OF APPROVAL, IF ANY:

oh & rah
Gymack
*See Instructions On Reverse Side

All distances must be from the outer boundaries of the Section.

| | | | | | |
|--|---|-----------------|---|--------------------|---|
| Operator EL PASO NATURAL GAS COMPANY | | | Lease LACKEY "C" (SF-077092-B) | | Well No. 1A |
| Unit Letter D | Section 11 | Township 29N | Range 10W | County San Juan | |
| Actual Footage Location of Well: 1120 feet from the North line and 1120 feet from the West line | | | | | |
| Ground Level Elev. 5784 | Producing Formation Pictured Mesa Verde - Cliffs | | Pool Aztec Pictured Cliffs Blanco Mesa Verde | | Dedicated Acreage: 316.80 & 159.12 Acres |

1. Outline the acreage dedicated to the subject well by colored pencil or hachure marks on the plat below.
2. If more than one lease is dedicated to the well, outline each and identify the ownership thereof (both as to working interest and royalty).
3. If more than one lease of different ownership is dedicated to the well, have the interests of all owners been consolidated by communitization, unitization, force-pooling, etc?

☐ Yes ☐ No If answer is "yes," type of consolidation _____

If answer is "no," list the owners and tract descriptions which have actually been consolidated. (Use reverse side of this form if necessary.) _____

No allowable will be assigned to the well until all interests have been consolidated (by communitization, unitization, forced-pooling, or otherwise) or until a non-standard unit, eliminating such interests, has been approved by the Commission. NOTE: THIS PLAT REISSUED TO REFLECT DUAL COMPLETION. 8-7-79

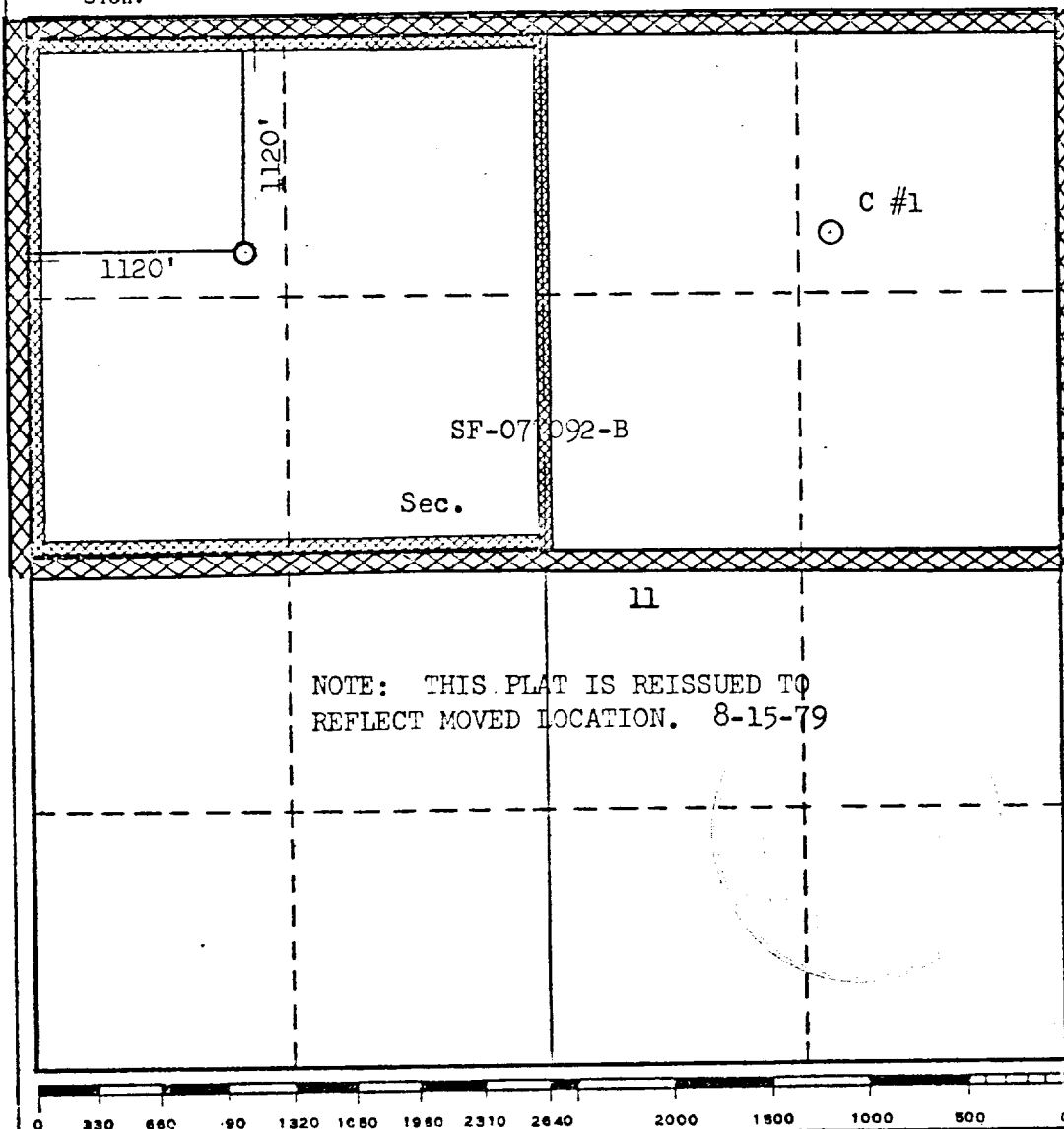

CERTIFICATION

I hereby certify that the information contained herein is true and complete to the best of my knowledge and belief.

Name
Drilling Clerk

Position
El Paso Natural Gas Co.

Date
August 20, 1979

Date

I hereby certify that the well location shown on this plat was plotted from field notes of actual surveys made by me or under my supervision, and that the same is true and correct to the best of my knowledge and belief.

Date Surveyed

July 25, 1979
Registered Professional Engineer
and/or Land Surveyor

Fred B. Kerr Jr.

Certificate No. 3950

Multi-Point Surface Use Plan

Lackey C #1A

1. Existing Road - Please refer to Map No. 1 which shows the existing roads. New roads which will be required have been marked on this map. All existing and new roads will be properly maintained during the duration of this project.
2. Planned Access Roads - Please refer to Map No. 1. The grade of the access roads will be consistent with that of the local terrain. The road surface will not exceed twenty feet (20') in width. Upon completion of the project, the access road will be adequately drained to control soil erosion. Drainage facilities may include ditches, water bars, culverts or any other measure deemed necessary by trained Company personnel to insure proper drainage. Gates and/or cattleguards will be installed if necessary.
3. Location of Existing Wells - Please refer to Map No. 2.
4. Location of Tank Batteries, Production Facilities, and Production Gathering and Service Lines - Please refer to Maps No. 1 and No. 2. Map No. 2 shows the existing gas gathering lines. Map No. 1 shows the existing roads and new proposed access roads. All known production facilities are shown on these two maps.
5. Location and Type of Water Supply - Water for the proposed project will be obtained from Bloomfield Ditch.
6. Source of Construction Materials - No additional materials will be required to build either the access road or the proposed location.
7. Methods of Handling Waste Materials - All garbage and trash materials will be put into a burn pit shown on the attached Location Plat No. 1. When clean-up operations are begun on the proposed project, the burn pit with its refuse will be buried to a depth of at least three feet (3'). A latrine, the location of which is also shown on Plat No. 1,

7. cont'd. will be provided for human waste. If large amounts of liquids are left in the reserve pit after completion of the project, the pit will be fenced until the liquids have had adequate time to dry. The location clean-up will not take place until such time as the reserve pit can be properly covered over to prevent run-off from carrying any of these materials into the watershed. No earthen pit will be located on natural drainages; all earthen pits will be so constructed as to prevent leakage from occurring.
8. Ancillary Facilities - No camps or airstrips will be associated with this project.
9. Wellsite Layout - Please refer to the attached Plat No. 1.
10. Plans for Restoration of the Surface - After completion of the proposed project, the location will be cleaned and leveled. The location will be left in such a condition that will enable reseeding operations to be carried out. Seed mixture as designated by the responsible government agency will be used. The reseeding operation will be performed during the time period set forth by the regulatory body. The location production equipment will be painted as designated by the responsible government agency.
11. Other Information - The terrain is sagebrush flats with sagebrush and cedar growing. Cattle are occasionally seen on the proposed project site.
12. Operator's Representative - W.D. Dawson, PO Box 990, Farmington, NM
13. Certification - I hereby certify that I, or persons under my direct supervision, have inspected the proposed drillsite and access route; that I am familiar with the conditions which presently exist; that the statements made in this plan are, to the best of my knowledge, true and correct; and that the work associated with the operations proposed herein will be performed by El Paso Natural Gas Company and its contractors and sub-contractors in conformity with this plan and the terms and conditions under which it is approved.



L. A. Aimes
Project Drilling Engineer

August 10, 1979

Operations Plan
Lackey C #1A

I. Location: ^{1120'}~~1160'~~N, ^{1120'}~~1170'~~W, Section 11, T-29-N, R-10-W, San Juan County, NM

Field: Aztec PC & Blanco MV

Elevation: 5784'GR

II. Geology:

| | | | | |
|--------------------|------------|--------|---------------|-------|
| A. Formation Tops: | Surface | Animas | Lewis | 2454' |
| | Ojo Alamo | 1124' | Mesa Verde | 3983' |
| | Kirtland | 1242' | Menefee | 4068' |
| | Fruitland | 2061' | Point Lookout | 4564' |
| | Pic.Cliffs | 2319' | Total Depth | 5015' |

B. Logging Program: I-ES and GR-Density at 2654'.
GR-Ind. and GR-Density at Total Depth.

C. Coring Program: none

D. Natural Gauges: 3975', 4060', 4555' and at Total Depth.
Also gauge any noticeable increase in gas. Record all gauges in daily drilling report and on morning report.

III. Drilling:

A. Mud Program: mud from surface to 2654'. Gas from intermediate casing to Total Depth.

IV. Materials:

| | | | | |
|--------------------|------------------|--------------|--------------------|----------------------|
| A. Casing Program: | <u>Hole Size</u> | <u>Depth</u> | <u>Casing Size</u> | <u>Wt.&Grade</u> |
| | 13 3/4" | 200' | 9 5/8" | 36.0# K-55 |
| | 8 3/4" | 2654' | 7" | 20.0# K-55 |
| | 6 1/4" | 2504-5015' | 4 1/2" | 10.5# K-55 |

B. Float Equipment: 9 5/8" surface casing - B & W guide shoe
(Prod. No. FC 06-09611-0200)

7" intermediate casing - Pathfinder guide shoe (Part #1003-1-007) and Howco self-fill insert float valve (Price Ref.36A&37), 5 Pathfinder stabilizers (Part #107-10) every other joint above shoe. Run float two joints above shoe.

4 1/2" liner - 4 1/2" liner hanger with neoprene packoff. Larkin geyser shoe (Fig.222) and Larkin flapper type float collar(fig.404 M&F).

C. Tubing: 5015' of 2 3/8", 4.7#, J-55 8rd EUE tubing with a common pump seating nipple one joint above bottom. Tubing will be open ended.
2654' of 1 1/4", 2.33#, J-55, IJ tubing with a common pump seating nipple above a perforated joint plugged on bottom. Isolate producing formations with a packer.

D. Wellhead Equipment: 10" 900 x 9 5/8" casing head. 10" x 7 1/2" casing hanger, 10" 2000 x 6" 2000 dual tubing head.

Operations Plan - Lackey C #1A

V. Cementing:

9 5/8" surface casing - use 190 sks. of Class "B" cement with 1/4# gel-flake per sack and 3% calcium chloride (224 cu.ft. of slurry, 100% excess to circulate to surface). WOC 12 hours. Test casing to 600#/30 minutes.

7" intermediate casing - use 140 sks. of 65/35 Class "B" Poz with 6% gel and 2% calcium chloride (8.3 gallons of water per sack) followed by 100 sks. of Class "B" with 2% calcium chloride (345 cu.ft. of slurry, 50% excess to cover Ojo Alamo). Run temperature survey at 8 hours. WOC 12 hours. Test casing to 1200#/30 minutes.

4 1/2" liner - precede cement with 20 barrels of gel water (2 sks. gel) Cement with 315 sks. of 50/50 Class "B" Poz with 2% gel, 0.6% Halad-9, 6.25# gilsonite plus 1/4# Flocele per sack (438 cu.ft. of slurry, 70% excess to circulate liner). WOC 18 hours.

FOR MEGA-VENTURE WELLS

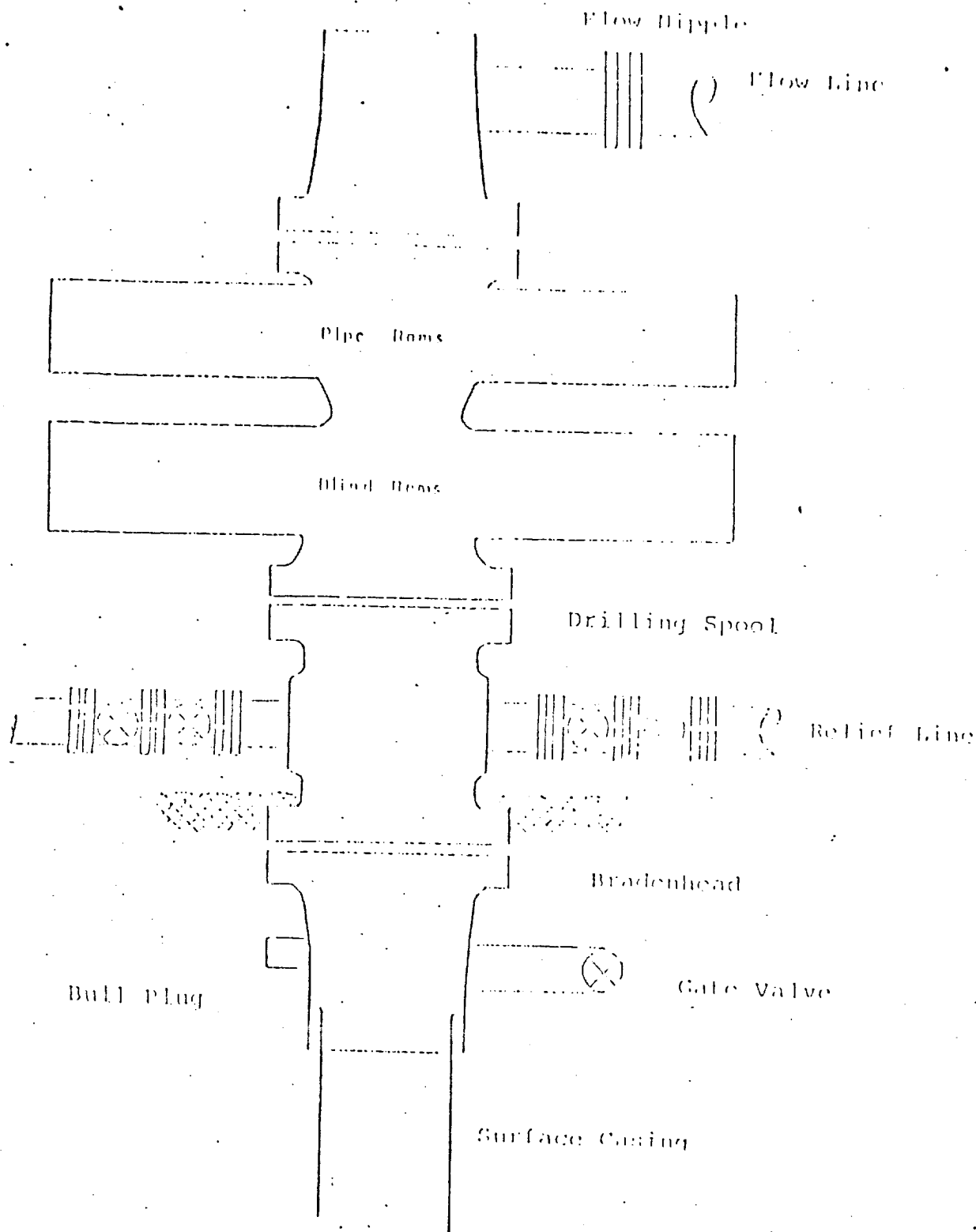

Series 900 Double Gate ROP, rated
at 3000 psi Working Pressure
When gas drilling operations begin a Shaffer type 50
or equivalent rotating head is installed on top of the
flow nipple and the flow line is converted into a blowie line

4' F, 11

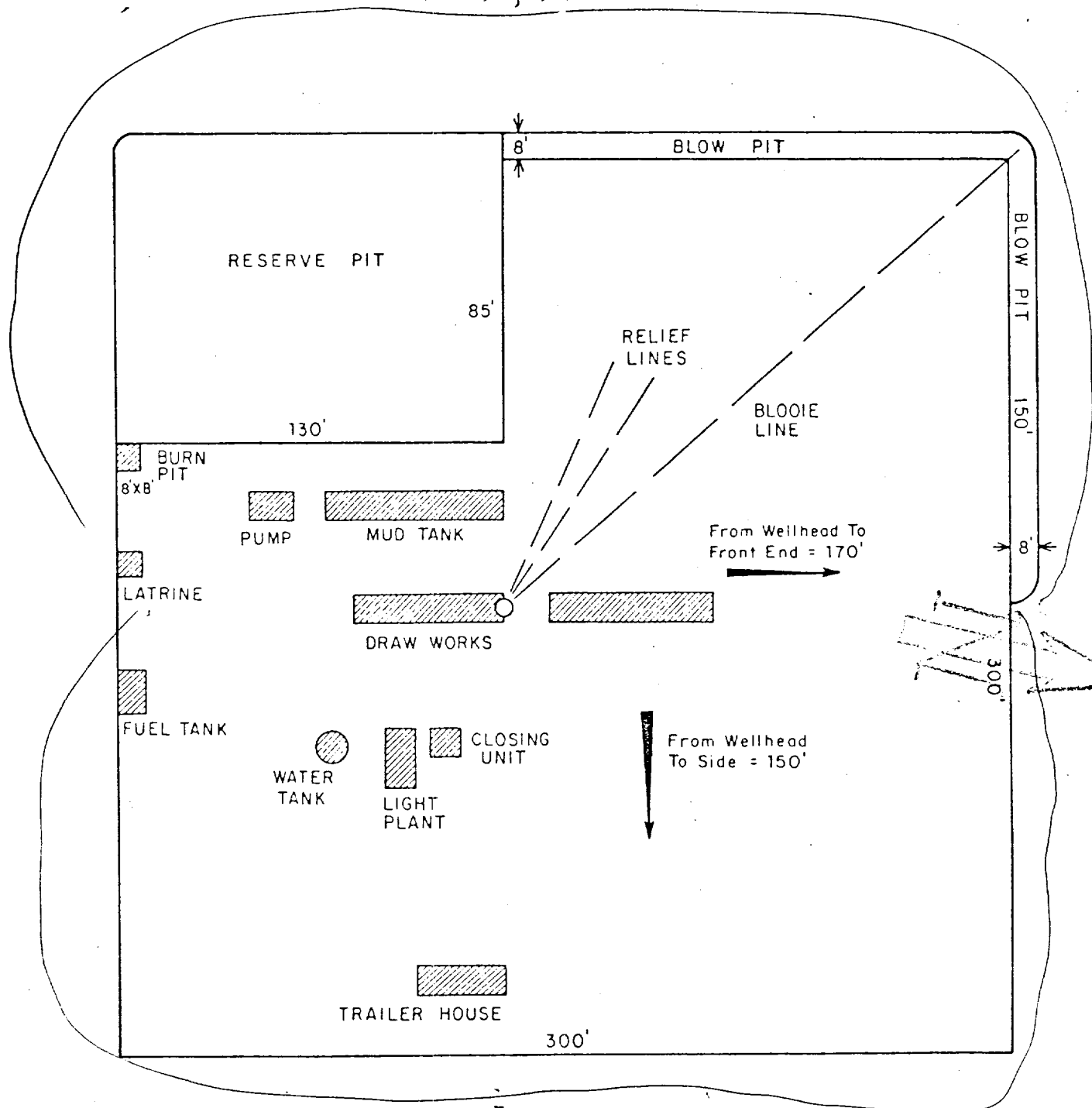

4' cut

| | | | | | | | | | | | | |
|--------------|------|------|----|------|--|--|------------------------|--|---|--|-----|--|
| | | | | | ENG. REC. DRAWN J.L.H. 8-16-78 CHECKED CHECKED PROJ. APP. DESIGN W.O. | | DATE 8-16-78 | | El Paso Natural Gas Company TYPICAL LOCATION PLAT FOR MESAVERDE OR DAKOTA DRILL SITE | | | |
| PRT. | SEP. | DATE | TO | W.O. | SCALE: 1" = 50' | | | | DWG. NO. | | REV | |
| PRINT RECORD | | | | | | | | | | | | |

El Paso Natural Gas Company
Lackey C #1A
NW 11-29-10

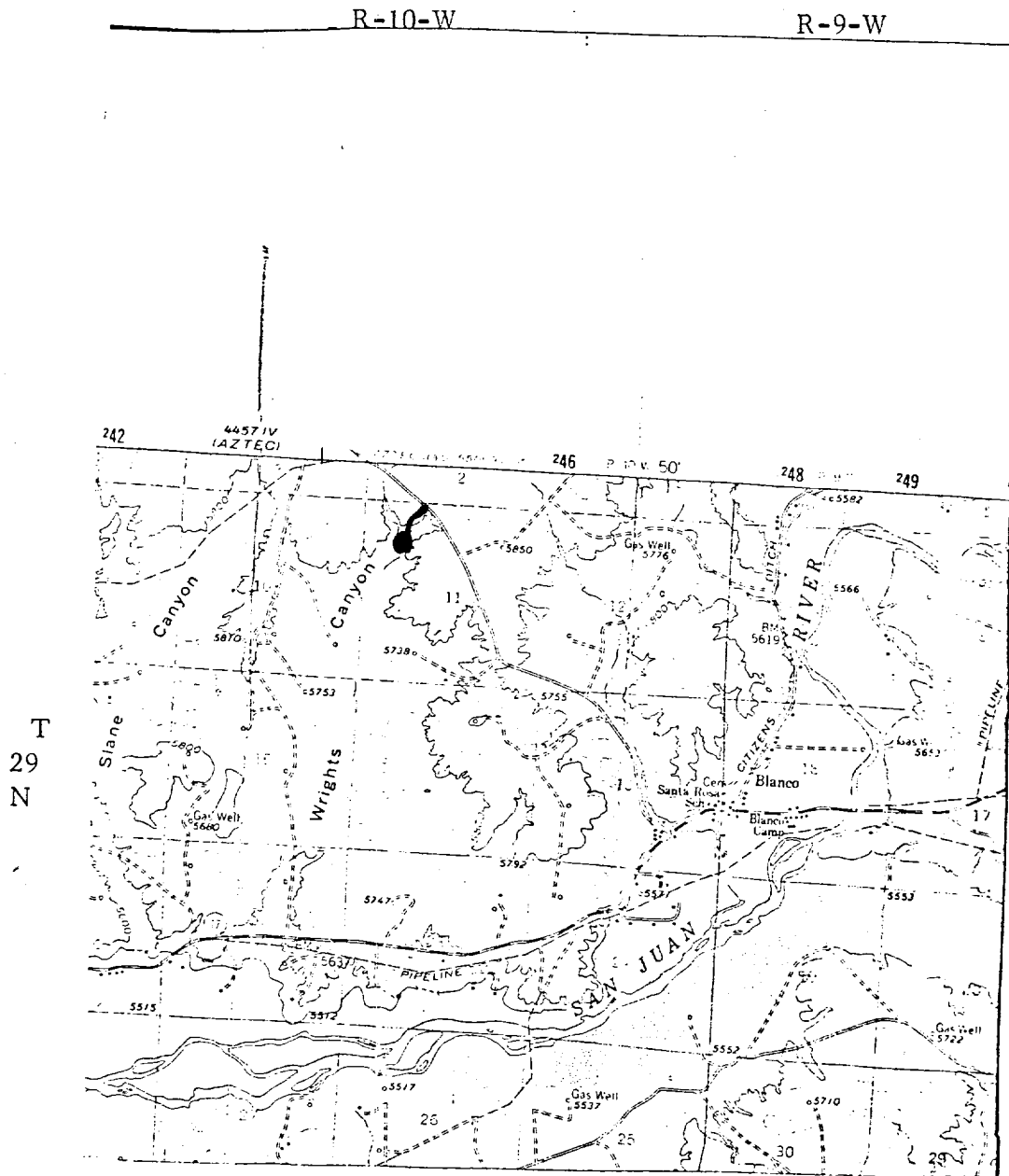

MAP 1

LEGEND OF RIGHT-OF-WAYS

- EXISTING ROADS
- EXISTING PIPELINES + + +
- EXISTING ROAD & PIPELINE + + + +
- PROPOSED ROADS
- PROPOSED PIPELINES + + + +
- PROPOSED ROAD & PIPELINE + + + + +

El Paso Natural Gas Company
Lackey C #1A
NW 11-29-10

R-10-W

T
29
N

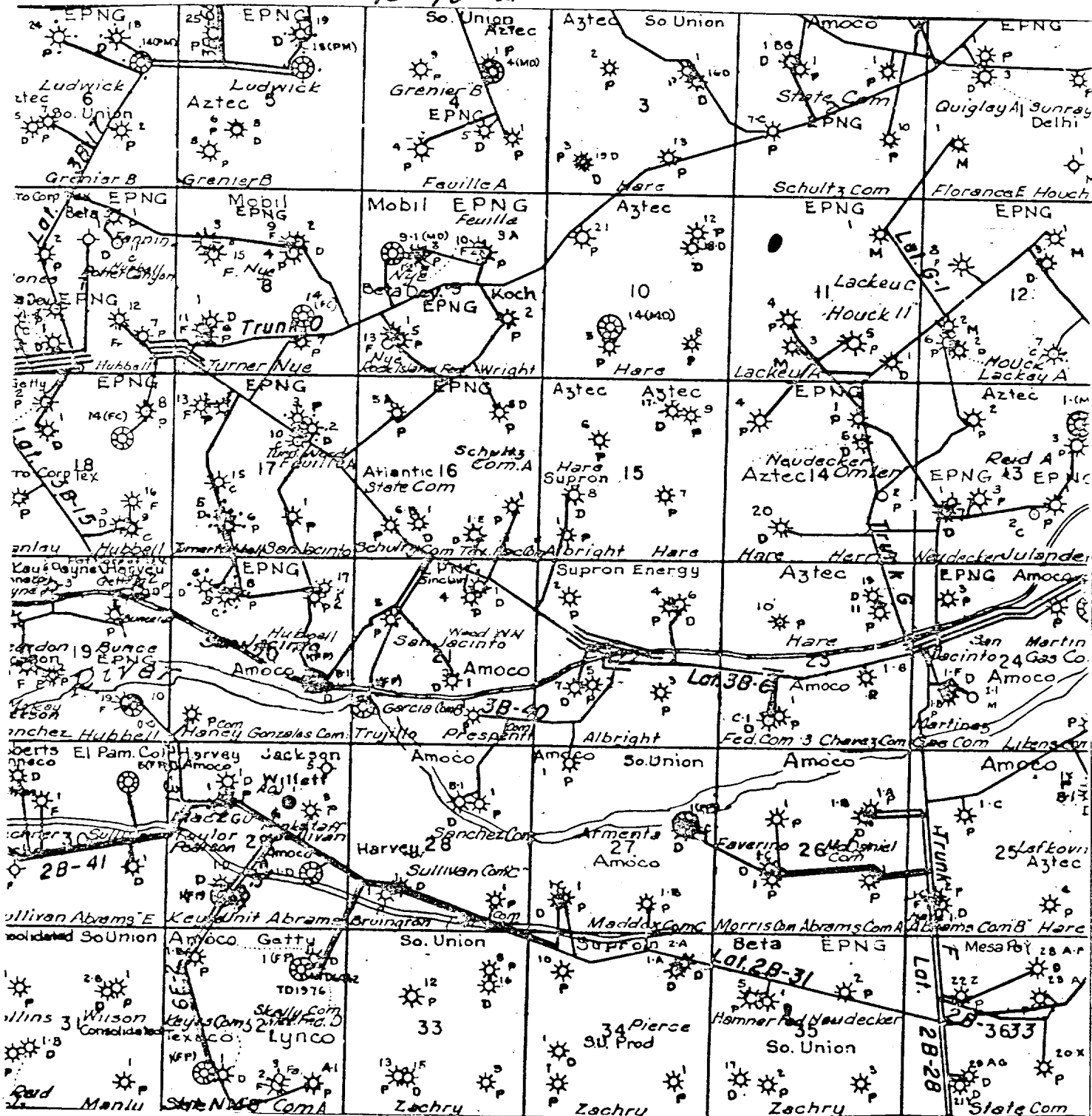

UNITED STATES
DEPARTMENT OF THE INTERIOR
GEOLOGICAL SURVEY

SUNDRY NOTICES AND REPORTS ON WELLS

(Do not use this form for proposals to drill or to deepen or plug back to a different reservoir. Use Form 9-331-C for such proposals.)

1. oil ☐ gas ☒ other ☐
2. NAME OF OPERATOR
El Paso Natural Gas Company
3. ADDRESS OF OPERATOR
PO Box 289, Farmington, NM
4. LOCATION OF WELL (REPORT LOCATION CLEARLY. See space 17 below.)
AT SURFACE: 1120'N, 1120'W
AT TOP PROD. INTERVAL:
AT TOTAL DEPTH:

16. CHECK APPROPRIATE BOX TO INDICATE NATURE OF NOTICE, REPORT, OR OTHER DATA

| REQUEST FOR APPROVAL TO: | SUBSEQUENT REPORT OF: |
|---|--------------------------|
| TEST WATER SHUT-OFF <input type="checkbox"/> | <input type="checkbox"/> |
| FRACTURE TREAT <input type="checkbox"/> | <input type="checkbox"/> |
| SHOOT OR ACIDIZE <input type="checkbox"/> | <input type="checkbox"/> |
| REPAIR WELL <input type="checkbox"/> | <input type="checkbox"/> |
| PULL OR ALTER CASING <input type="checkbox"/> | <input type="checkbox"/> |
| MULTIPLE COMPLETE <input type="checkbox"/> | <input type="checkbox"/> |
| CHANGE ZONES <input type="checkbox"/> | <input type="checkbox"/> |
| ABANDON* <input type="checkbox"/> | <input type="checkbox"/> |
| (other) Change Plans <input type="checkbox"/> | |

5. LEASE
SF 077092-B
6. IF INDIAN, ALLOTTEE OR TRIBE NAME
7. UNIT AGREEMENT NAME
8. FARM OR LEASE NAME
Lackey C
9. WELL NO.
1A
10. FIELD OR WILDCAT NAME
Blanco MV - Aztec PC
11. SEC., T., R., M., OR BLK. AND SURVEY OR AREA
Sec. 11, T-29-N, R-10-W
NMPM
12. COUNTY OR PARISH
San Juan
13. STATE
NM
14. API NO.
15. ELEVATIONS (SHOW DF, KDB, AND WD)
5784' GL

(NOTE: Report results of multiple completion or zone change on Form 9-330.)

17. DESCRIBE PROPOSED OR COMPLETED OPERATIONS (Clearly state all pertinent details, and give pertinent dates, including estimated date of starting any proposed work. If well is directionally drilled, give subsurface locations and measured and true vertical depths for all markers and zones pertinent to this work.)*

It is intended to change the location of the subject well from 1160'N, 1170'W of Section 11, T-29-N, R-10-W, to 1120'N, 1120'W, of Section 11, T-29-N, R-10-W.

Subsurface Safety Valve: Manu. and Type _____

18. I hereby certify that the foregoing is true and correct

SIGNED John Bradford TITLE Drilling Clerk DATE August 20, 1979

(This space for Federal or State office use)

APPROVED BY _____ TITLE _____ DATE _____
CONDITIONS OF APPROVAL, IF ANY: