

NO. OF COPIES RECEIVED	5
DISTRIBUTION	
SANTA FE	1
FILE	2
U.S.G.S.	2
LAND OFFICE	
OPERATOR	1

NEW MEXICO OIL CONSERVATION COMMISSION

20-045-2 3757
Form C-101
Revised 1-1-65

5A. Indicate Type of Lease
Fed. ☒ 50% FEE ☒ 50%

5. State Oil & Gas Lease No.

APPLICATION FOR PERMIT TO DRILL, DEEPEN, OR PLUG BACK

1a. Type of Work b. Type of Well OIL WELL <input type="checkbox"/> GAS WELL <input checked="" type="checkbox"/> OTHER <input type="checkbox"/> DRILL <input checked="" type="checkbox"/> DEEPEN <input type="checkbox"/> PLUG BACK <input type="checkbox"/> SINGLE ZONE <input type="checkbox"/> MULTIPLE ZONE <input type="checkbox"/>		7. Unit Agreement Name
2. Name of Operator MANANA GAS, INC.		8. Farm or Lease Name AUNT MAGGIE
3. Address of Operator P. O. Box 145, Farmington, New Mexico 87401		9. Well No. # 1
4. Location of Well UNIT LETTER I LOCATED 790 FEET FROM THE East LINE AND 1675 FEET FROM THE South LINE OF SEC. 25 TWP. 29-N RGE. 11-W NMPM		10. Field and Pool, or Wildcat Aztec Pictured Cliffs
		12. County San Juan
		19. Proposed Depth 1900
		19A. Formation Pictured Cliff
		20. Rotary or C.T. Rotary
21. Elevations (Show whether DF, RT, etc.) 5521 GL	21A. Kind & Status Plug. Bond Blanket	21B. Drilling Contractor Lee Wilson Drilling
		22. Approx. Date Work will start 9/5/79

23.

PROPOSED CASING AND CEMENT PROGRAM

SIZE OF HOLE	SIZE OF CASING	WEIGHT PER FOOT	SETTING DEPTH	SACKS OF CEMENT	EST. TOP
11"	7"	20.0	125	75	
5"	2 7/8"	6.4	1850	300	

This well will be logged and if productive new casing will be run, cemented, perforated and fractured. BOP equipment will be operational at all times during drilling and completion.

Gas is dedicated to El Paso Natural Gas Company.

Well is to be drilled on fee acreage.

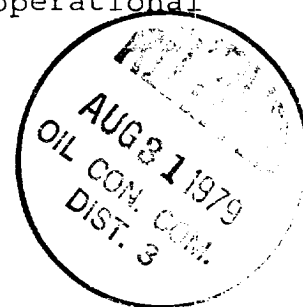

11-29-79
EXPIRED

IN ABOVE SPACE DESCRIBE PROPOSED PROGRAM: IF PROPOSAL IS TO DEEPEN OR PLUG BACK, GIVE DATA ON PRESENT PRODUCTIVE ZONE AND PROPOSED NEW PRODUCTIVE ZONE. GIVE BLOWOUT PREVENTER PROGRAM, IF ANY.

I hereby certify that the information above is true and complete to the best of my knowledge and belief.

Signed Ed Hartman Title President Date 8/30/79

(This space for State Use)

APPROVED BY Frank S. Chang TITLE DEPUTY OIL & GAS INSPECTOR, DIST. #3 DATE AUG 31 1979

CONDITIONS OF APPROVAL, IF ANY:

NEW MEXICO OIL CONSERVATION COMMISSION
WELL LOCATION AND ACREAGE DEDICATION PLAT

Form C-102
Supersedes C-128
Effective 1-1-65

All distances must be from the outer boundaries of the Section.

Operator MANANA GAS, INCORPORATED			Lease AUNT MAGGIE		Well No. #1
Unit Letter I	Section 25	Township 29 NORTH	Range 11 WEST	County SAN JUAN	
Actual Footage Location of Well: 1675 feet from the SOUTH line and 790 feet from the EAST line					
Ground Level Elev. 5521 UNGRADED	Producing Formation Pictured Cliff	Pool Aztec Pictured Cliff		Dedicated Acreage: 160 Acres	

1. Outline the acreage dedicated to the subject well by colored pencil or hachure marks on the plat below.
2. If more than one lease is dedicated to the well, outline each and identify the ownership thereof (both as to working interest and royalty).
3. If more than one lease of different ownership is dedicated to the well, have the interests of all owners been consolidated by communitization, unitization, force-pooling, etc?

☒ Yes ☐ No If answer is "yes," type of consolidation Communitization

If answer is "no," list the owners and tract descriptions which have actually been consolidated. (Use reverse side of this form if necessary.)

No allowable will be assigned to the well until all interests have been consolidated (by communitization, unitization, forced-pooling, or otherwise) or until a non-standard unit, eliminating such interests, has been approved by the Commission.

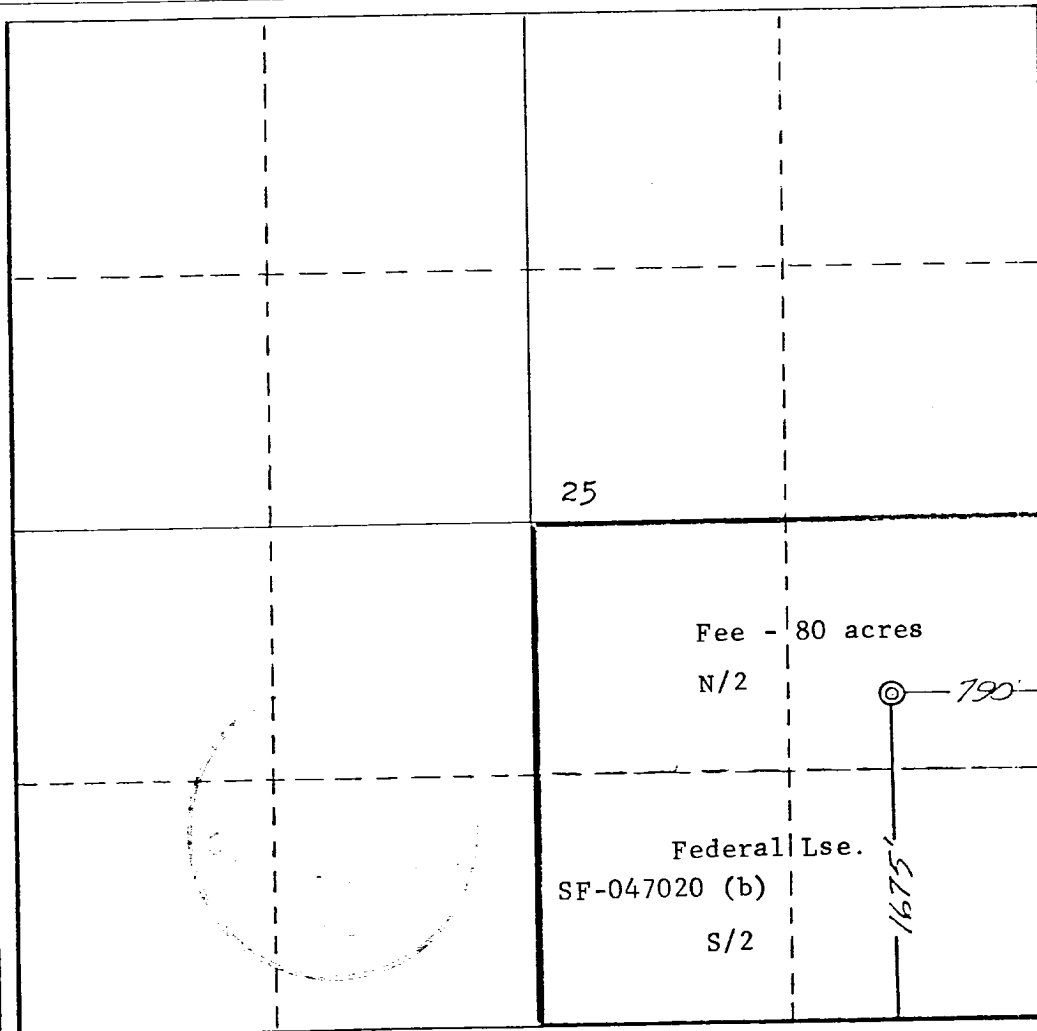

CERTIFICATION

I hereby certify that the information contained herein is true and complete to the best of my knowledge and belief.

Ed Hartman

Name **President**

Position
Manana Gas, Inc.

Company
August 30, 1979

Date

I hereby certify that the well location shown on this plat was plotted from field notes of actual surveys made by me or under my supervision and that the same is true and correct to the best of my knowledge.

JAMES P. LEESE

July 18, 1979

Date Surveyed
JAMES P. LEESE

Registered Professional Engineer
and/or Land Surveyor

James P. Leese

Certificate No.

1463