

UNITED STATES  
DEPARTMENT OF THE INTERIOR  
GEOLOGICAL SURVEY

30-045-24006  
5. LEASE DESIGNATION AND SERIAL NO.  
SF 075587  
6. IF INDIAN, ALLOTTEE OR TRIBE NAME  
7. UNIT AGREEMENT NAME  
8. FARM OR LEASE NAME  
Reid  
9. WELL NO.  
#1E  
10. FIELD AND POOL, OR WILDCAT  
Basin Dakota  
11. SEC., T., R., M., OR BLK.  
AND SURVEY OR AREA  
Sec 13 T29N R12W  
12. COUNTY OR PARISH  
San Juan  
13. STATE  
NM

APPLICATION FOR PERMIT TO DRILL, DEEPEN, OR PLUG BACK

1a. TYPE OF WORK  
DRILL ☒ DEEPEN ☐ PLUG BACK ☐

b. TYPE OF WELL  
OIL WELL ☐ GAS WELL ☒ OTHER ☐  
SINGLE ZONE ☐ MULTIPLE ZONE ☐

2. NAME OF OPERATOR  
Pioneer Production Corp.

3. ADDRESS OF OPERATOR  
Box 208, Farmington, NM 87401

4. LOCATION OF WELL (Report location clearly and in accordance with any State requirements.)\*  
At surface 1650' FSL - 1850' FEL  
At proposed prod. zone

14. DISTANCE IN MILES AND DIRECTION FROM NEAREST TOWN OR POST OFFICE\*  
2-1/2 miles west of Bloomfield

15. DISTANCE FROM PROPOSED\*  
LOCATION TO NEAREST  
PROPERTY OR LEASE LINE, FT.  
(Also to nearest drig. unit line, if any) 1650'

16. NO. OF ACRES IN LEASE  
480

17. NO. OF ACRES ASSIGNED  
TO THIS WELL  
5/320

18. DISTANCE FROM PROPOSED LOCATION\*  
TO NEAREST WELL, DRILLING, COMPLETED,  
OR APPLIED FOR, ON THIS LEASE, FT.

19. PROPOSED DEPTH  
6590'

20. ROTARY OR CABLE TOOLS  
Rotary

21. ELEVATIONS (Show whether DF, RT, GR, etc.)  
5584' GR

22. APPROX. DATE WORK WILL START\*  
Dec. 15, 1979

23. PROPOSED CASING AND CEMENTING PROGRAM

SIZE OF HOLE	SIZE OF CASING	WEIGHT PER FOOT	SETTING DEPTH	QUANTITY OF CEMENT
12-1/4"	8-5/8"	24#	211'	140 sx
7-7/8"	4-1/2"	10.5#	6590'	150 sx 1st stage
				620 sx 2nd stage

Plan to drill with mud to test Basin Dakota formation. Plan to run IES log to TD.  
If productive, will set 4-1/2" casing, cement in two stages, selectively  
perforate, frac, clean out after frac, run 1-1/2" tbg and complete well.

Plan to use BOP furnished by rig while drilling (10" 3000 psi hydraulic)

Plan to use BOP rental while completing well. (6" 3000 psi double gate manual)

Gas dedicated to El Paso Natural Gas Co.

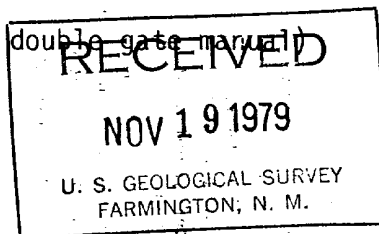

IN ABOVE SPACE DESCRIBE PROPOSED PROGRAM: If proposal is to deepen or plug back, give data on present productive zone and proposed new productive zone. If proposal is to drill or deepen directionally, give pertinent data on subsurface locations and measured and true vertical depths. Give blowout preventer program, if any.

24. SIGNED Jim L. Jacobs TITLE Agent DATE 11-16-79

(This space for Federal or State office use)

PERMIT NO. APPROVAL DATE

APPROVED BY TITLE

CONDITIONS OF APPROVAL, IF ANY:

ok Frank

NMOCC

\*See Instructions On Reverse Side

**NEW MEXICO OIL CONSERVATION COMMISSION  
WELL LOCATION AND ACREAGE DEDICATION PLAT**

Form C-102  
Supersedes C-128  
Effective 1-1-65

All distances must be from the outer boundaries of the Section.

Operator <b>Pioneer Production Corporation</b>			Lease <b>Reid</b>		Well No. <b>1E</b>
Unit Letter <b>J</b>	Section <b>13</b>	Township <b>29 North</b>	Range <b>12 West</b>	County <b>San Juan</b>	
Actual Footage Location of Well: <div style="display: flex; justify-content: space-between;"> <span>1650 feet from the South line and</span> <span>1850 feet from the East line</span> </div>					
Ground Level Elev. <b>5584</b>	Producing Formation <b>Dakota</b>	Pool <b>Basin</b>	Dedicated Acreage: <b>320</b> Acres		

- Outline the acreage dedicated to the subject well by colored pencil or hachure marks on the plat below.
- If more than one lease is dedicated to the well, outline each and identify the ownership thereof (both as to working interest and royalty).
- If more than one lease of different ownership is dedicated to the well, have the interests of all owners been consolidated by communitization, unitization, force-pooling, etc?

☐ Yes   ☐ No   If answer is "yes," type of consolidation \_\_\_\_\_

If answer is "no," list the owners and tract descriptions which have actually been consolidated. (Use reverse side of this form if necessary.) \_\_\_\_\_

No allowable will be assigned to the well until all interests have been consolidated (by communitization, unitization, forced-pooling, or otherwise) or until a non-standard unit, eliminating such interests, has been approved by the Commission.

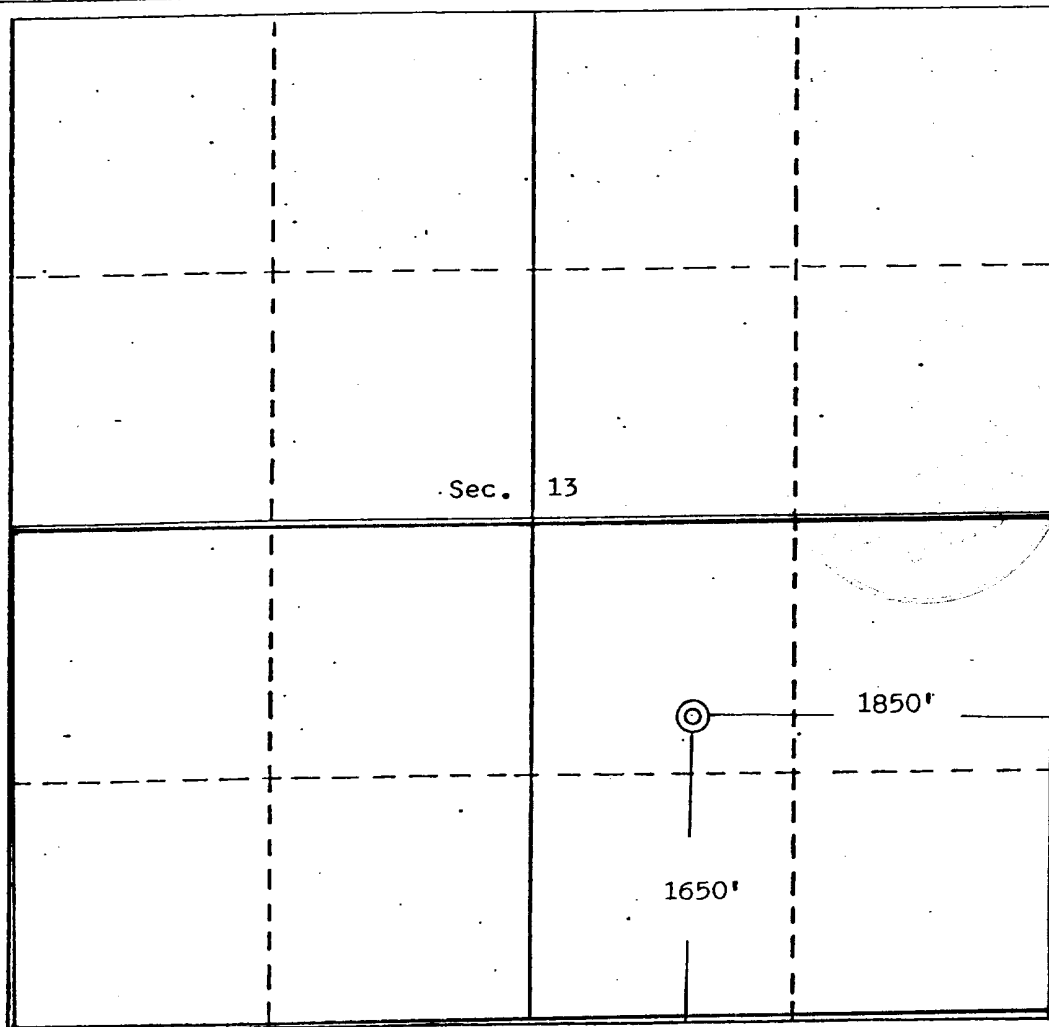

**CERTIFICATION**

I hereby certify that the information contained herein is true and complete to the best of my knowledge and belief.

Name Jim L. Jacobs  
Position Agent  
Company Pioneer Production Corp.  
Date 11-16-79

I hereby certify that the well location shown on this plat was plotted from field notes of actual surveys made by me or under my supervision, and that the same is true and correct to the best of my knowledge and belief.

Date Surveyed  
**November 7, 1979**  
Registered Professional Engineer  
and/or Land Surveyor

Edgar L. Risenhoover  
Certificate No. **5979**  
**Edgar L. Risenhoover, L.S.**

Pioneer Production Corp.  
Reid #1E  
PROPOSED LOCATION LAYOUT

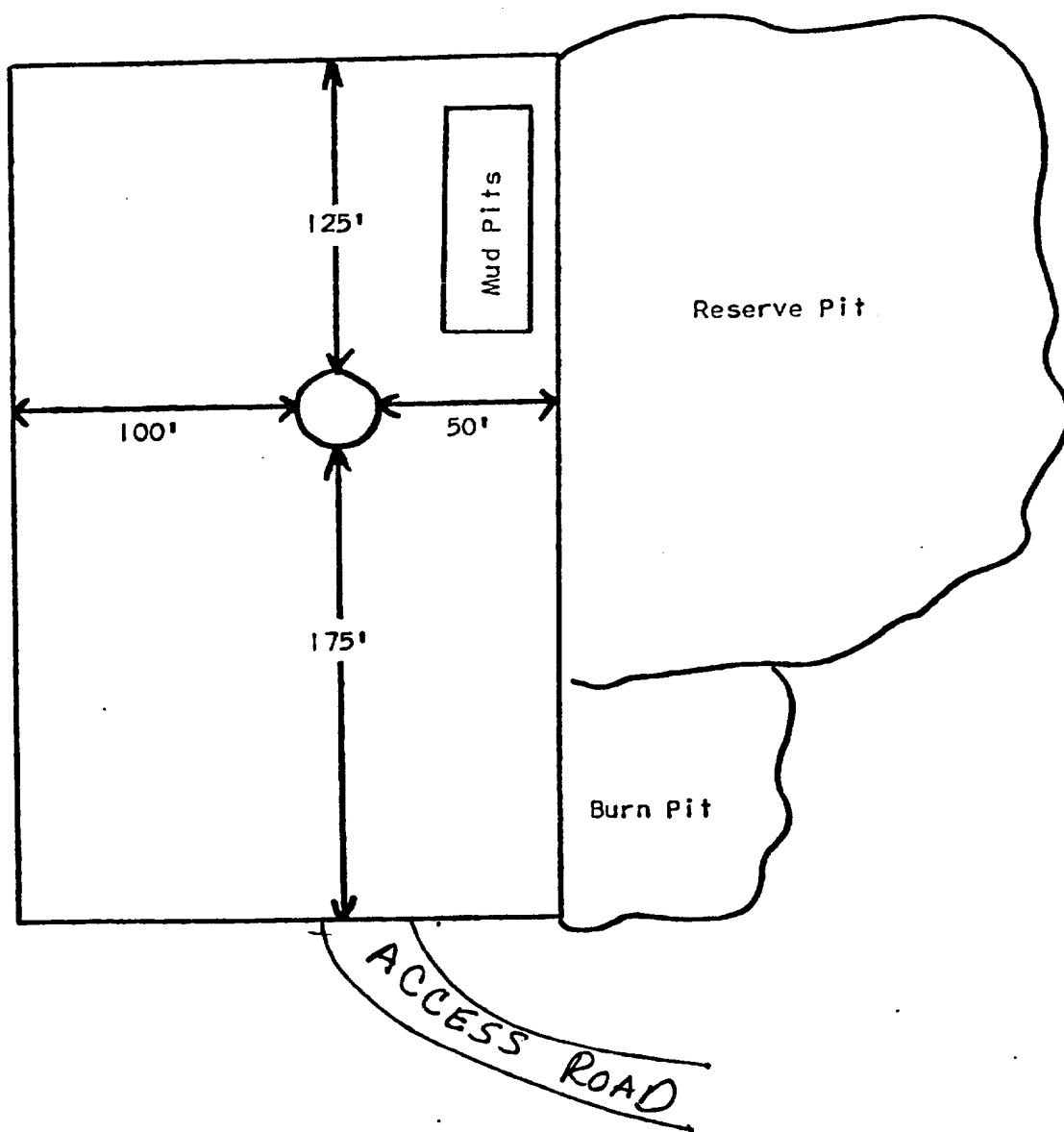

# TYPICAL BOP INSTALLATION

FOR DAKOTA WELL

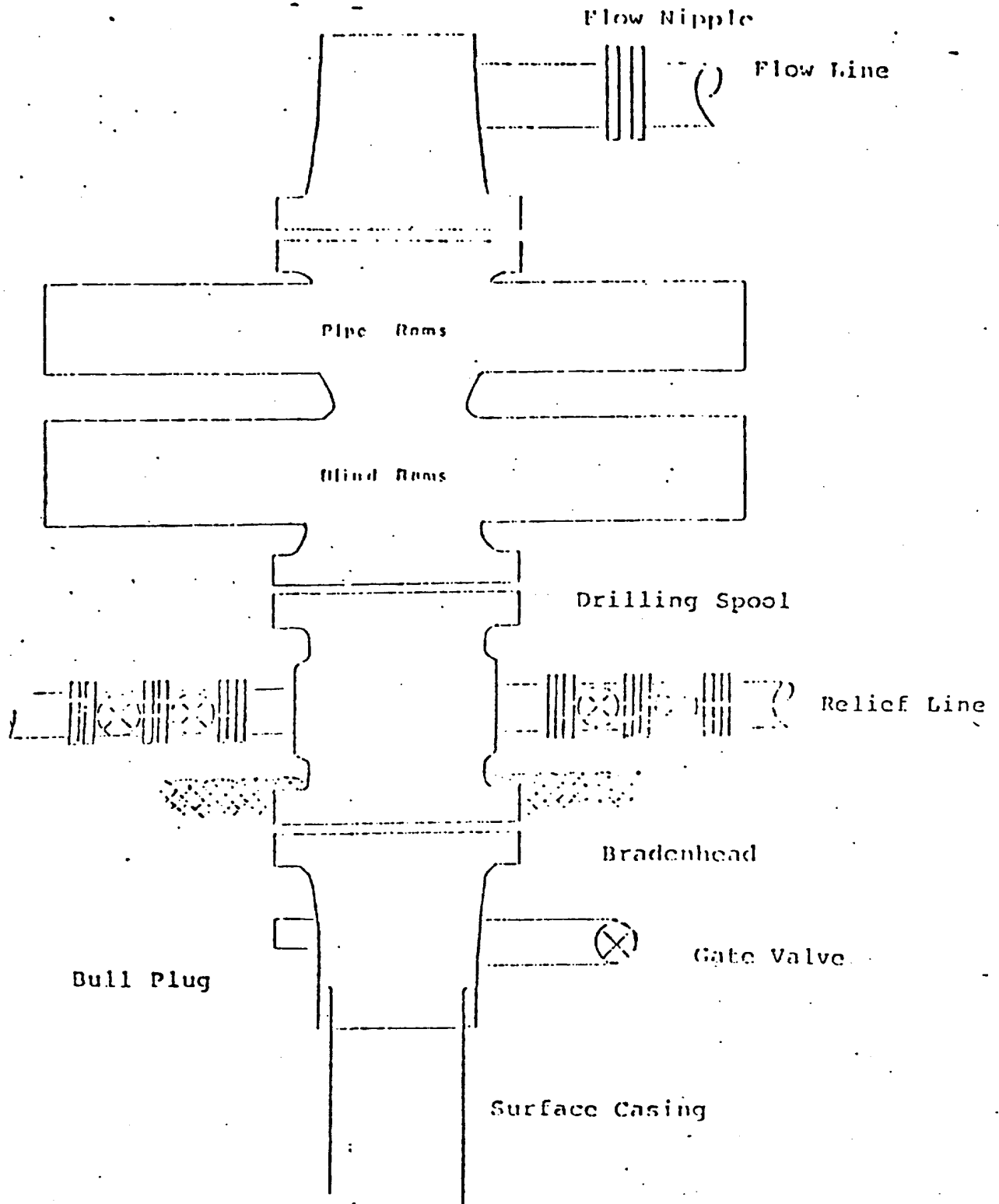

Series 900 Double Gate BOP, rated  
at 3000 psi Working Pressure

When gas drilling operations begin a Shaffer type  
50 or equivalent rotating head is installed on top of  
the flow nipple and the flow line is converted into  
a blowie line.

DEVELOPMENT PLAN

Pioneer Production Corp.

Reid #1E

1. Existing roads and existing wells are shown on attached plat.
2. Planned access from existing road approximately 300' to new location. Will leave natural grass and small vegetation on roadway. Will remove large brush or trees from road. Do not plan to make road grade or bar ditches. Will bottom-out any arroyo we cross and not install culverts.
3. Location of well: 1650' FSL - 1850' FFL  
Sec 13 T29N R12W  
San Juan County, NM
4. No additional well(s) planned on this lease at this time.
5. Separator and flow line will be located within 50' of wellhead.
6. Water will be secured from San Juan River.
7. Waste materials will be buried on location or in reserve pit.
8. No permanent camp is planned; trailer house will be used on location while drilling.
9. Do not plan to build airstrip.
10. See attached plat for proposed location layout.
11. A general description of the topography, soil characteristics, geologic features, flora and fauna; other surface-use activities and surface ownership of involved lands, proximity of water, occupied dwellings, archeological, historical or cultural sites can be found in the archeologist's report.
12. Geologic name of surface formation: Undifferentiated Tertiary
13. Estimated tops of important geologic markers: See Operations Plan
14. Estimated depths of anticipated water, oil, gas, or other mineral bearing formations which are expected to be encountered: Ojo Alamo - 400' water  
gas - FR 586' PC 1707' Pt. Lookout 4062' GA 5321' DK 6240' No oil expected
15. We do not anticipate to encounter any abnormal pressures or temperatures or any potential hazards such as those associated with hydrogen sulfide.
16. Will clean up location, fill and level pits, level ruts in road, reseed location and road with Seed Mixture #2 and paint equipment with Sandstone Brown.
17. Operator's Representative:  
Jim L. Jacobs  
Box 208  
Farmington, NM 87401
18. Certification: The following statement must be signed by the lessee's or operator's field representative who is identified in Item #17 of the Plan:

I hereby certify that I, or persons under my direct supervision, have inspected the proposed drillsite and access route; that I am familiar with the conditions which presently exist; that the statements made in this Plan are, to the best of my knowledge, true and correct; and, that the work associated with the operations proposed herein will be performed by Pioneer Production Corp. and its contractors and subcontractors in conformity with this Plan and the terms and conditions under which it is approved.

Date: 11-16-79

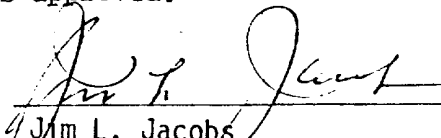
  
Jim L. Jacobs  
Agent

## OPERATIONS PLAN

OPERATOR: Pioneer Production Corp.  
WELL NAME: Reid #1E  
FIELD: Basin Dakota  
LOCATION: 1650' FSL - 1850' FEL Sec 13 T29N R12W San Juan County, NM  
ELEVATION: 5584' GR

EXPECTED FORMATION TOPS:

Ojo Alamo	400'	Point Lookout	4062'
Kirtland	550'	Mancos	4250'
Fruitland	586'	Gallup	5321'
Pictured Cliffs	1707'	Greenhorn	6122'
Lewis	1745'	Graneros	6169'
Cliff House	3264'	Dakota	6240'
Menefee	3424'	Total Depth	6590'

LOGGING PROGRAM:

SAMPLES:

### CASING PROGRAM

<u>Hole Size</u>	<u>Depth</u>	<u>Csg Size, Wt, Grade, &amp; Condition</u>				<u>Cementing Program</u>
12-1/4"	211'	8-5/8"	24#	J-55	New	Cement surface w/140 sx of class "B" w/2% CaCl
7-7/8"	6590'	4-1/2"	10.5#	K-55	New	Cement 1st stage w/200 sx 65-35 plus 12% gel and 150 sx class "B" all w/1/4# flocele per sx. Total slurry 650 cu ft.  Cement 2nd stage through stage tool @ 4100' w/500 sx 65-35 plus 12% gel and 120 sx w/4% gel. Total slurry 1453 cu ft  TOTAL SLURRY 2103 cu ft

### WELLHEAD EQUIPMENT

8-5/8" x 10" 600 series bradenhead  
10" x 600 x 6" series Christmas tree

Office - 325-0238  
Tom Dugan 325-5694  
Jim Jacobs 325-8353  
Kurt Fagrelus 334-3381  
Bill Donovan 325-5692  
Hazen

