

UNITED STATES  
DEPARTMENT OF THE INTERIOR  
GEOLOGICAL SURVEY

## APPLICATION FOR PERMIT TO DRILL, DEEPEN, OR PLUG BACK

1a. TYPE OF WORK DRILL <input checked="" type="checkbox"/> DEEPEN <input type="checkbox"/> PLUG BACK <input type="checkbox"/>			5. LEASE DESIGNATION AND SERIAL NO. 30-045-24010 NM 013885	
b. TYPE OF WELL OIL WELL <input type="checkbox"/> GAS WELL <input checked="" type="checkbox"/> OTHER <input type="checkbox"/> SINGLE ZONE <input type="checkbox"/> MULTIPLE ZONE <input type="checkbox"/>			6. IF INDIAN, ALLOTTEE OR TRIBE NAME	
2. NAME OF OPERATOR Pioneer Production Corp.			7. UNIT AGREEMENT NAME	
3. ADDRESS OF OPERATOR Box 208, Farmington, NM 87401			8. FARM OR LEASE NAME Maxey	
4. LOCATION OF WELL (Report location clearly and in accordance with any State requirements.*) At surface 790' FNL - 1690' FWL At proposed prod. zone			9. WELL NO. #1E	
14. DISTANCE IN MILES AND DIRECTION FROM NEAREST TOWN OR POST OFFICE* 2-1/2 miles west of Bloomfield, NM			10. FIELD AND POOL, OR WILDCAT Basin Dakota	
15. DISTANCE FROM PROPOSED* LOCATION TO NEAREST PROPERTY OR LEASE LINE, FT. (Also to nearest drlg. unit line, if any) 790'			11. SEC., T., R., M., OR BLK. AND SURVEY OR AREA Sec 24 T29N R12W	
16. NO. OF ACRES IN LEASE 320			12. COUNTY OR PARISH San Juan	
17. NO. OF ACRES ASSIGNED TO THIS WELL 320			13. STATE NM	
18. DISTANCE FROM PROPOSED* LOCATION TO NEAREST WELL, DRILLING, COMPLETED, OR APPLIED FOR, ON THIS LEASE, FT. 6550'			20. ROTARY OR CABLE TOOLS Rotary	
21. ELEVATIONS (Show whether DF, RT, GR, etc.) 5544' GL			22. APPROX. DATE WORK WILL START* Dec. 15, 1979	

## 23. PROPOSED CASING AND CEMENTING PROGRAM

SIZE OF HOLE	SIZE OF CASING	WEIGHT PER FOOT	SETTING DEPTH	QUANTITY OF CEMENT
12-1/4"	8-5/8"	24#	215'	150 sx
7-7/8"	4-1/2"	10.5#	6550'	350 sx 1st stage
				600 sx 2nd stage

Plan to drill with mud to test Basin Dakota Formation. Plan to run IES log to TD. If productive, will set 4-1/2" casing, cement in two stages, selectively perforate, frac, clean out after frac, run 1-1/2" tbg and complete well.

Plan to use BOP furnished by rig while drilling (10" 3000 psi hydraulic)

Plan to use BOP rental while completing (7" 3000 psi double gate manual)

NMERB: Gas dedicated to El Paso Natural Gas Co.

IN ABOVE SPACE DESCRIBE PROPOSED PROGRAM: If proposal is to deepen or plug back, give data on present productive zone and proposed new productive zone. If proposal is to drill or deepen directionally, give pertinent data on subsurface locations and measured and true vertical depths. Give blowout preventer program, if any.

24. SIGNED Jim L. Jacobs TITLE Agent DATE 11-16-79  
(This space for Federal or State office use)

PERMIT NO. \_\_\_\_\_ APPROVAL DATE \_\_\_\_\_

APPROVED BY \_\_\_\_\_ TITLE \_\_\_\_\_ DATE \_\_\_\_\_  
CONDITIONS OF APPROVAL, IF ANY:

*ok Smith*

NMOCC

\*See Instructions On Reverse Side  
ADDITIONAL WELL NEEDED PURSUANT TO NEW MEXICO ORDER R-1670-V.  
U.S.G.S. RATIFICATION DATED JUNE 8, 1979.



# FOR DAKOTA WELL

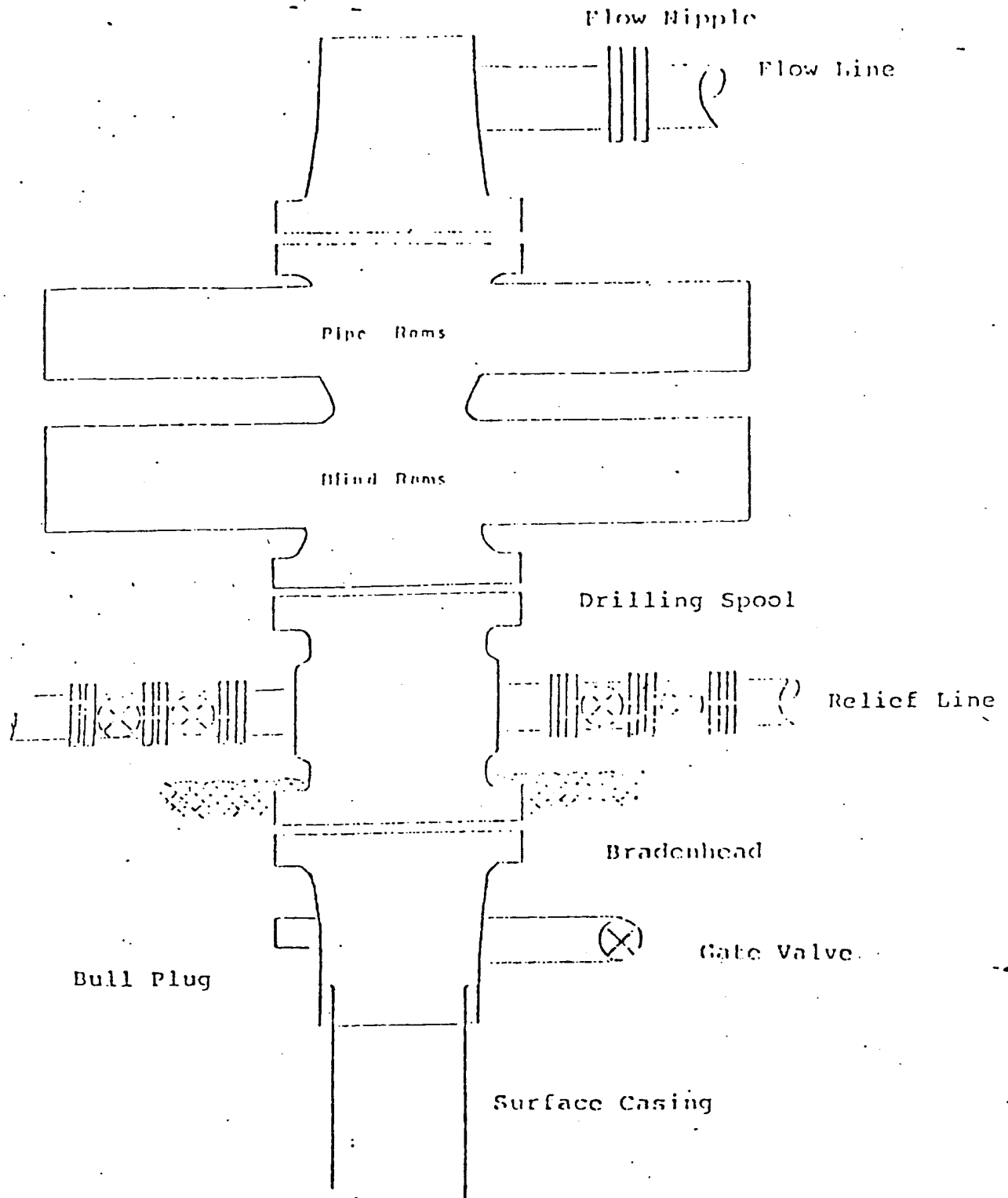

Series 900 Double Gate ROP, rated  
at 3000 psi Working Pressure

When gas drilling operations begin a Shaffer type  
50 or equivalent rotating head is installed on top of  
the flow nipple and the flow line is converted into  
a blowie line.



Pioneer Production Corp.  
Maxey #1E  
PROPOSED LOCATION LAYOUT

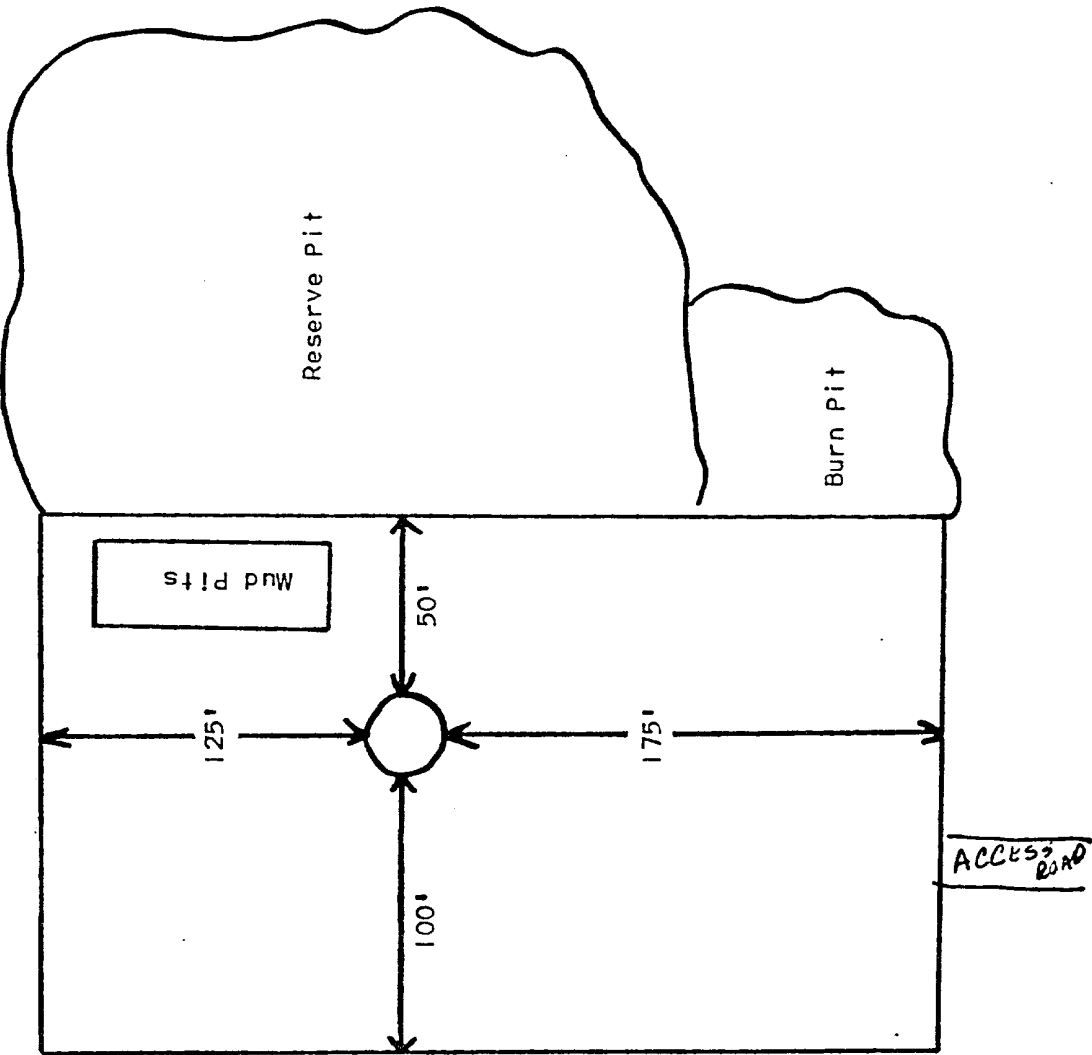

## OPERATIONS PLAN

OPERATOR: Pioneer Production Corp.  
WELL NAME: Maxey #1E  
FIELD: Basin Dakota  
LOCATION: 790' FNL - 1690' FWL    Sec 24 T29N R12W    San Juan County, NM  
ELEVATION: 5544' GL

EXPECTED FORMATION TOPS:	Ojo Alamo	400'	Point Lookout	3560'
	Kirtland	550'	Mancos	4487'
	Fruitland	1500'	Gallup	5394'
	Pictured Cliffs	1786'	Greenhorn	6132'
	Lewis	1809'	Graneros	6198'
	Cliff House	3345'	Dakota	6250'
	Menefee	3480'	Total Depth	6550'

LOGGING PROGRAM: IES

SAMPLES: Catch samples in 10' intervals at 6230'

### CASING PROGRAM

<u>Hole Size</u>	<u>Depth</u>	<u>Csg Size, Wt, Grade, &amp; Condition</u>	<u>Cementing Program</u>
12-1/4"	215'	8-5/8" 24# J-55 New	Cement w/150 sx class "B" neat plus 2% CaCl
7-7/8"	6550'	4-1/2" 10.5# K-55 8R	1st stage w/200 sx 65-35 plus 12% gel and 150 sx class "B" ne w/1/4# flocele per sx in all 350 sx. Total slurry 650 cu  2nd stage: Cement through stage tool at 3580' w/500 sx 65 plus 12% gel and 100 sx w/4T gel. Total slurry 1430 cu ft  TOTAL SLURRY 1430 cu ft

### WELLHEAD EQUIPMENT

8-5/8" x 10" 600 Bradenhead	New
10" 600 x 6" 600 Christmas Tree	New

Office	-	325-0238
Tom Dugan		325-5694
Jim Jacobs		325-8353
Kurt Fagrelus		334-3381
Bill Donovan		325-5692
James Hazen		

DEVELOPMENT PLAN

Pioneer Production Corp.

Maxey #1E

1. Existing roads and existing wells are shown on attached plat.
2. Planned access from existing road approximately 125' to new location. Will leave natural grass and small vegetation on roadway. Will remove large brush or trees from road. Do not plan to make road grade or bar ditches. Will bottom-out any arroyo we cross and not install culverts.
3. Location of well: 790' FNL - 1690' FWL  
Sec 24 T29N R12W  
San Juan County, NM
4. No additional well(s) planned on this lease at this time.
5. Separator and flow line will be located within 50' of wellhead.
6. Water will be secured from San Juan River.
7. Waste materials will be buried on location or in reserve pit.
8. No permanent camp is planned; trailer house will be used on location while drilling.
9. Do not plan to build airstrip.
10. See attached plat for proposed location layout.
11. A general description of the topography, soil characteristics, geologic features, flora and fauna; other surface-use activities and surface ownership of involved lands, proximity of water, occupied dwellings, archeological, historical or cultural sites can be found in the archeologist's report.
12. Geologic name of surface formation: Undifferentiated Tertiary
13. Estimated tops of important geologic markers:  
  
See Operations Plan
14. Estimated depths of anticipated water, oil, gas, or other mineral bearing formations which are expected to be encountered: water - Ojo Alamo no oil expected  
gas - 1500' Fruitland, Pictured Cliffs - 1786', 3560' - Pt. Lookout, 5394' - GA, 6250' DK
15. We do not anticipate to encounter any abnormal pressures or temperatures or any potential hazards such as those associated with hydrogen sulfide.
16. Will clean up location, fill and level pits, level ruts in road, reseed location and road with Seed Mixture #2 and paint equipment with Sandstone Brown.
17. Operator's Representative:  
Jim L. Jacobs  
Box 208  
Farmington, NM 87401
18. Certification: The following statement must be signed by the lessee's or operator's field representative who is identified in Item #17 of the Plan:

I hereby certify that I, or persons under my direct supervision, have inspected the proposed drillsite and access route; that I am familiar with the conditions which presently exist; that the statements made in this Plan are, to the best of my knowledge, true and correct; and, that the work associated with the operations proposed herein will be performed by Pioneer Production Corp. and its contractors and subcontractors in conformity with this Plan and the terms and conditions under which it is approved.

Date: 11-16-79

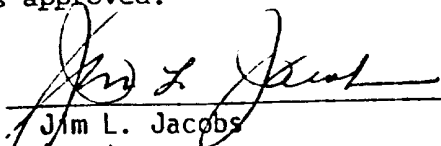
  
Jim L. Jacobs

