

OIL CONSERVATION DIVISION

STATE OF NEW MEXICO

ENERGY AND MINERALS DEPARTMENT

P. O. BOX 2088

SANTA FE, NEW MEXICO 87501

Form C-107
Revised 10-1-78

All distances must be from the outer boundaries of the Section.

Operator MESA PETROLEUM COMPANY			Lease FEDERAL		Well No. 6-E
Unit Letter E	Section 6	Township 29N	Range 11W	County San Juan	
Actual Footage Location of Well: 1750 feet from the North line and 805 feet from the West line					
Ground Level Elev. 5808	Producing Formation Dakota		Pool Basin Dakota		Dedicated Acreage: 320 Acres

1. Outline the acreage dedicated to the subject well by colored pencil or hachure marks on the plat below.
2. If more than one lease is dedicated to the well, outline each and identify the ownership thereof (both as to working interest and royalty).
3. If more than one lease of different ownership is dedicated to the well, have the interests of all owners been consolidated by communitization, unitization, force-pooling, etc?

☐ Yes ☐ No If answer is "yes," type of consolidation _____

If answer is "no," list the owners and tract descriptions which have actually been consolidated. (Use reverse side of this form if necessary.) _____

No allowable will be assigned to the well until all interests have been consolidated (by communitization, unitization, forced-pooling, or otherwise) or until a non-standard unit, eliminating such interests, has been approved by the Commission.

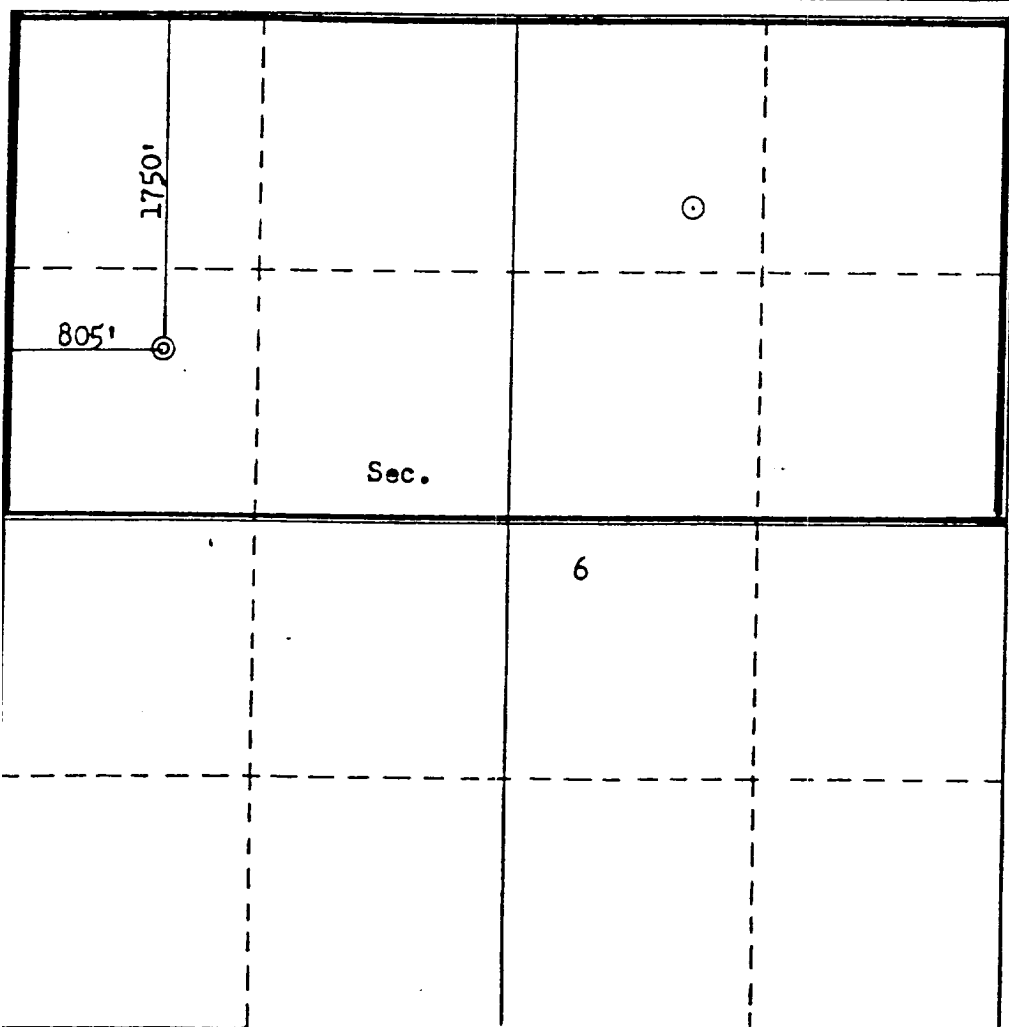

CERTIFICATION

I hereby certify that the information contained herein is true and complete to the best of my knowledge and belief.

John Alexander

Name
JOHN ALEXANDER

Position

AGENT

Company

MESA PETROLEUM CO.

Date

November 14, 1979

I hereby certify that the well location shown on this plat was plotted from field notes of actual surveys made by me or under my supervision, and that the same is true and correct to the best of my knowledge and belief.

Date Surveyed

November 5, 1979

Registered Professional Engineer
and/or Land Surveyor

Fred B. Kent
Fred B. Kent

Certificate No.

3950

